

Top view

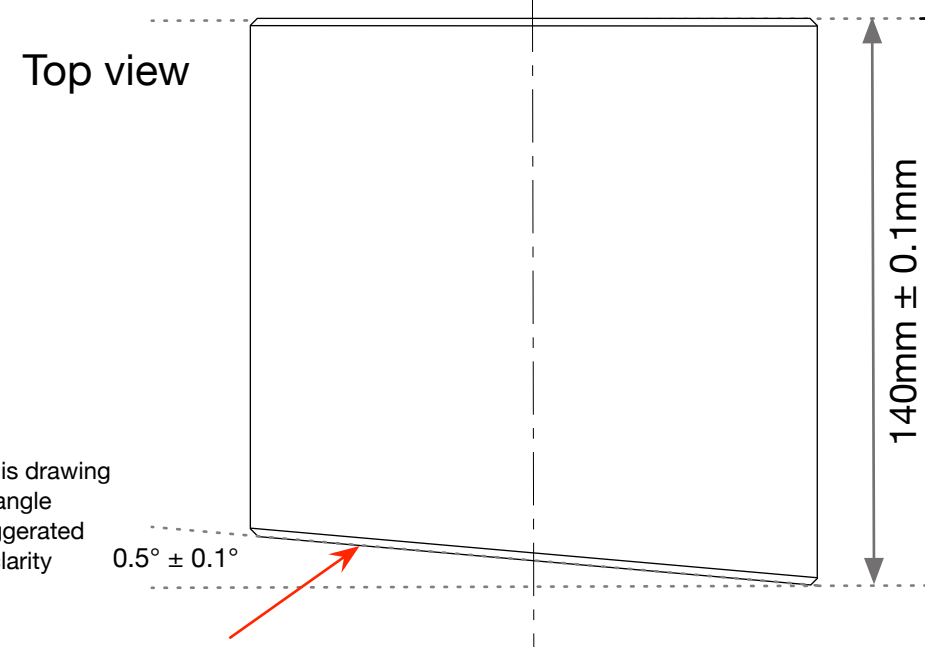

note: in this drawing the angle is exaggerated for clarity

$0.5^\circ \pm 0.1^\circ$

140mm ± 0.1mm

2x, 2mm ± 0.5mm thick chamfer, all round

Surface 1 (S1)

Right Side View (thin side view)

Surface 2 (S2)

Back view

Left Side View (thick side view)

Surface 1 (S1)

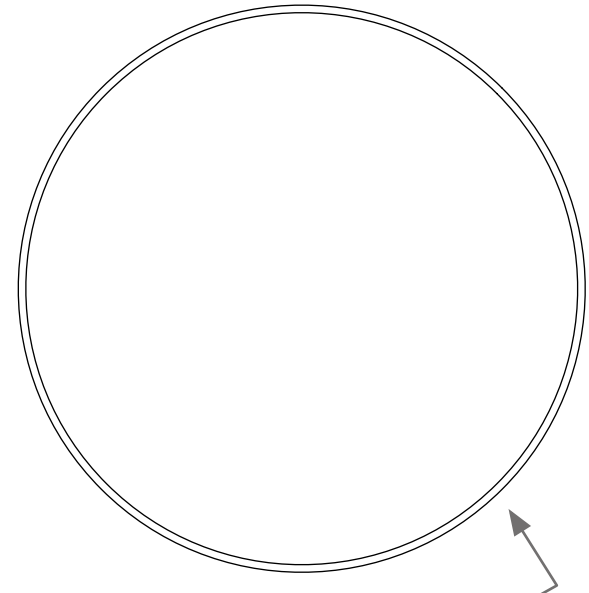
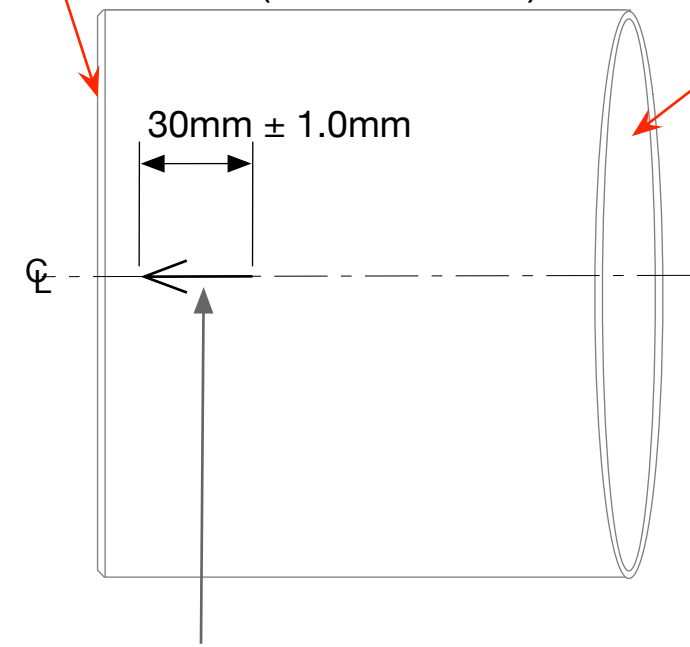

Surface 2 (S2)

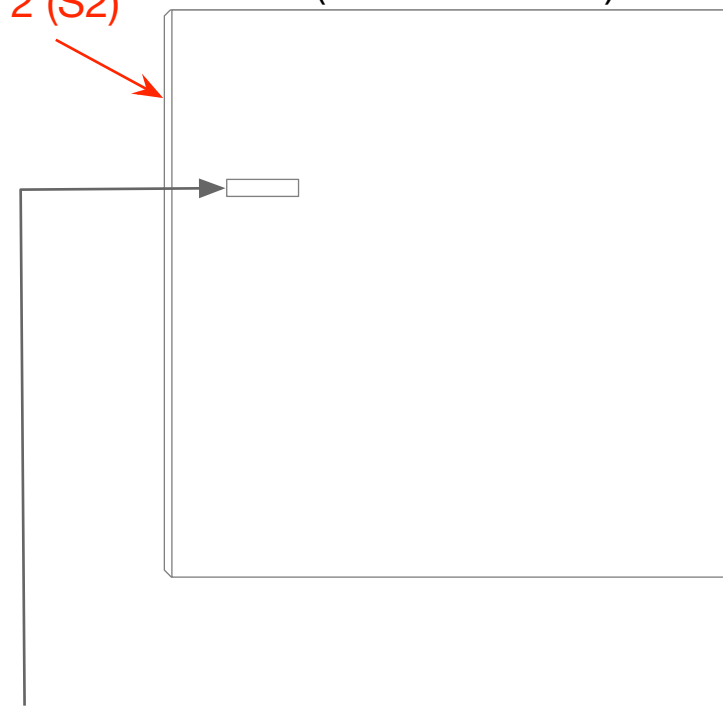

150mm ± 0.1mm diameter

ETCH OR GRIND LEGIBLE REFERENCE GROOVE (0.25mm 0.05mm WIDE) ALONG CL PARALLEL TO THE CYLINDRICAL AXIS WITH ARROW POINT TO SURFACE "S1". ARROW SHOULD BE 30mm in LENGTH STARTING APPROXIMATELY 10mm FROM SURFACE S1

ETCH OR GRIND SERIAL NUMBER, APPROX. WHERE SHOWN, LETTERING APPROX. 4mm HIGH. Each optic will have a serial Number. "ITMXX" or "ETMXX" shall be shall be etched, ground or sandblasted on the barrel of the optic where XX is incremental and the starting number is supplied with the contract

MANUFACTURE NOTES:

- 1. DO NOT SCALE FROM DRAWINGS
- 2. BARREL SIDE and BEVEL POLISH PER E2100299-V5, Section 2.6
- 3. TYPE 1 - FINISH SURFACES S1 AND S2 PER E2100299-V5
- 4. TYPE 2 - FINISH SURFACES S1 AND S2 PER E2100296-V5

PART NAME:

MARINER 40 - TM SUBSTRATE: Type1 - ITM (Float Zone), Type 2 - ETM (Magnetic Czochralski)

DRAWING NUMBER: D2100536-v6

NAME: Aidan Brooks

DATE: 13-Dec-2021