

8 7 6 5 4 3 2 1

NOTES (CONTINUED):

- ④ SCRIBE, ENGRAVE (A VIBRATORY TOOL MAY BE USED), LASER MARK OR MECHANICALLY STAMP (NO INKS OR DYES) DRAWING PART NUMBER, REVISION ON NOTED SURFACE OF PART FOLLOWED ON THE NEXT LINE WITH A THREE DIGIT SERIAL NUMBER. SERIAL NUMBERS START AT 001 FOR THE FIRST ARTICLE AND PROCEED CONSECUTIVELY. USE MINIMUM 0.12" HIGH CHARACTERS, UNLESS THE SIZE OF THE PART DICTATES SMALLER CHARACTERS. EXAMPLE: D1300691-v1, S/N 001
- 5. WEIGHT: 0.29 LB.
- ⑥ TUMBLE DEBURR.
- ⑦ BLACK ANODIZE PER MIL-A-8625F, TYPE II, CLASS 2.

REV.	DATE	DCN #	BOM #
v1	20 AUG 2013	E1300649-x0	-

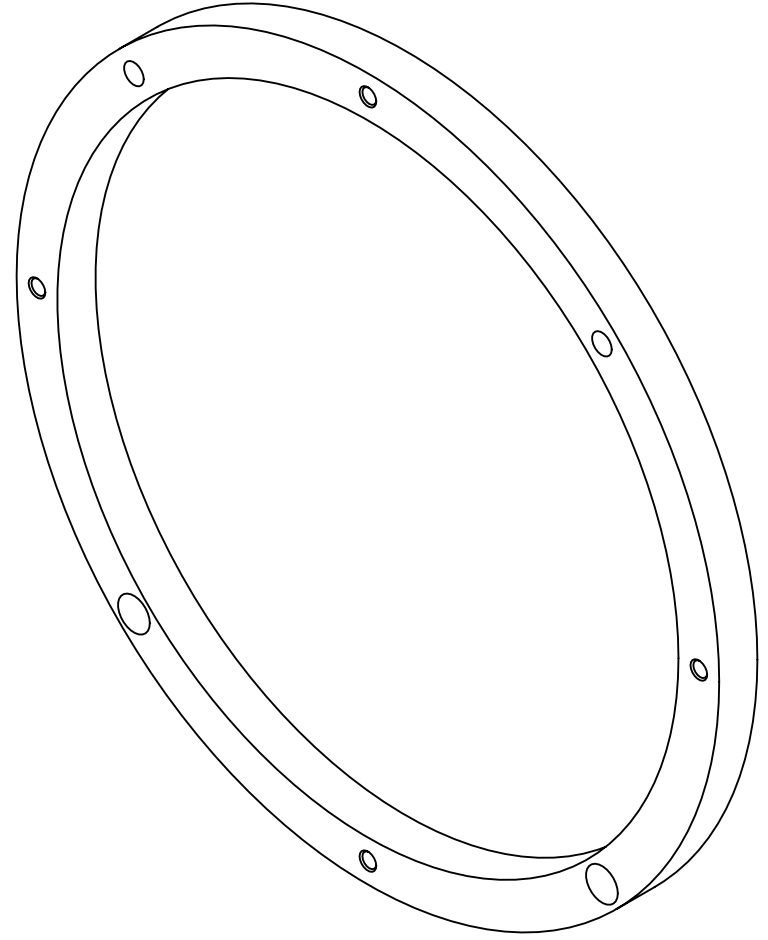
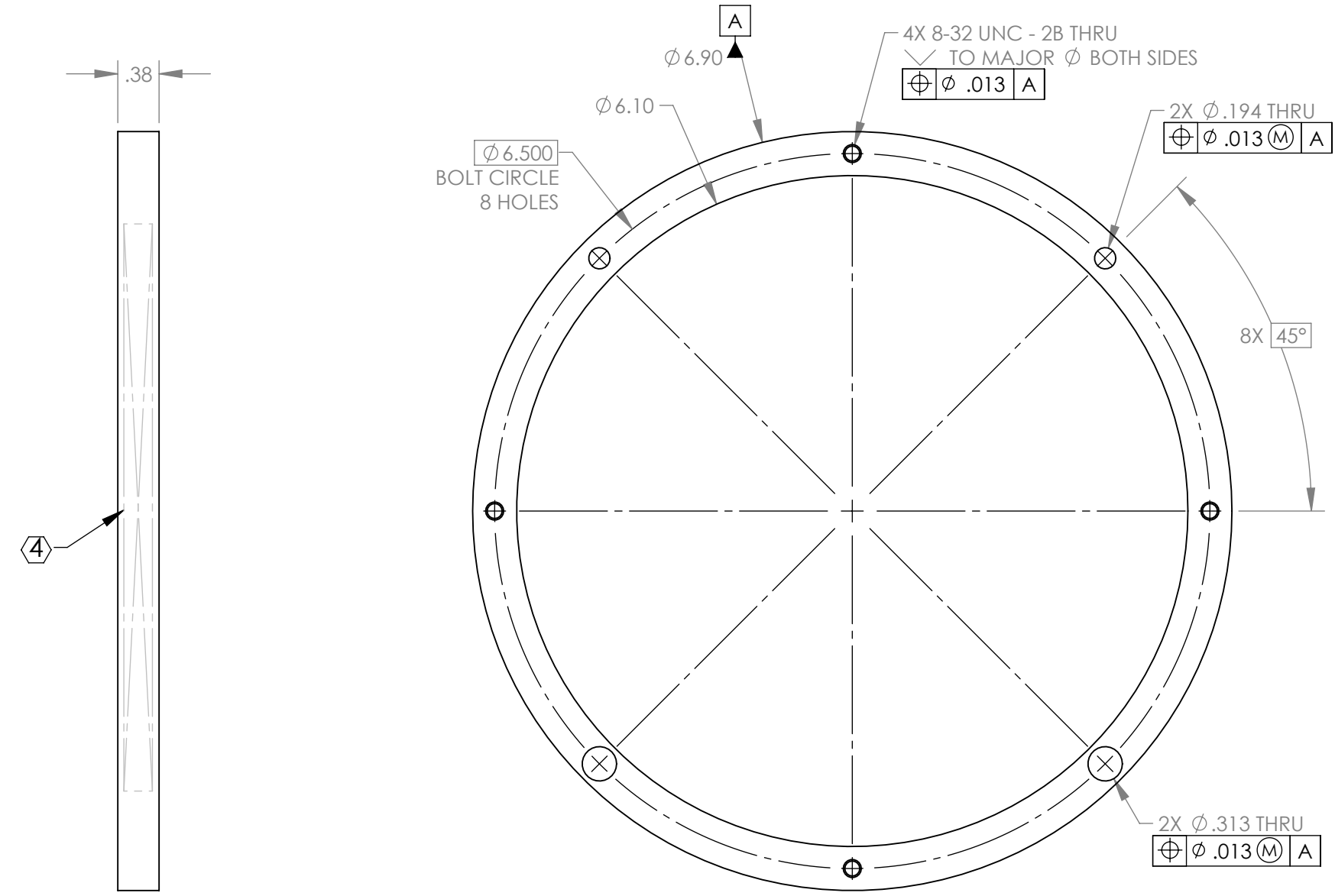

D1300691 aLIGO Pcal Bellows Adapter Ring, Inner, PART PDM REV: X-010, DRAWING PDM REV: X-005

**NOTES AND TOLERANCES: (UNLESS OTHERWISE SPECIFIED)**

DIMENSIONS ARE IN INCHES

TOLERANCES:  
 .XX ± .01  
 .XXX ± .005  
 ANGULAR ± 1.0°

MATERIAL	6061-T6 Al	FINISH	N/A μinch Ra MAX ⑥⑦
----------	------------	--------	---------------------

CALIFORNIA INSTITUTE OF TECHNOLOGY MASSACHUSETTS INSTITUTE OF TECHNOLOGY		PART NAME		aLIGO PCAL BELLWS ADAPTER RING, INNER	
SYSTEM	ADVANCED LIGO	SUB-SYSTEM	AOS	DESIGNER	C. CONLEY
NEXT ASSY	D1300693	DRFTER	C. CONLEY	DATE	20 AUG 2013
		CHECKER		SIZE	DWG. NO.
		APPROVAL		B	D1300691
				REV.	v1
				SCALE	NONE
				PROJECTION	
				SHEET 1 OF 1	