

*12 9058JA359 1/4-20 x 3/8 8.0oz FHS 316 SStL 2 2*

| ITEM NO. | PART NUMBER        | DESCRIPTION   | MATERIAL   | REQ | SPARE | TOTAL |
|----------|--------------------|---|------------|-----|-------|-------|
| 11       | D1002081           | OMC VIBRATION ABSORBER MOUNTING PLATE                 | 6061-T6 Al | 1   |       | 1     |
| 10       | 92200A537          | SCREW, SHC, 1/4-20 x 1/2, MS16995-48, MC #92200A537   | 300 SSSL   | 4   |       | 4     |
| 9        | MCMaster_90945A761 | Washer .47 od x .26 id x .06-.07 thk                  | 18-8 SSSL  | 4   |       | 4     |
| 8        | 92200A544          | SCREW, SHC, 1/4-20 x 1 1/4, MS16995-53, MC #92200A544 | 300 SSSL   | 4   |       | 4     |
| 7        | D100895            | Plate 2 for SEI Vibration absorber 5 Lb version       | 6063-T6    | 1   |       | 1     |
| 5        | MCMaster_90945A760 | Washer .47 od x .26 id x .02-.04 thk                  | 18-8 SSSL  | 4   |       | 4     |
| 4        | 92200A548          | SCREW, SHC, 1/4-20 x 1 3/4, MS16995-55, MC #92200A548 | 18-8 SSSL  | 4   |       | 0     |

OMC CONFIGURATION

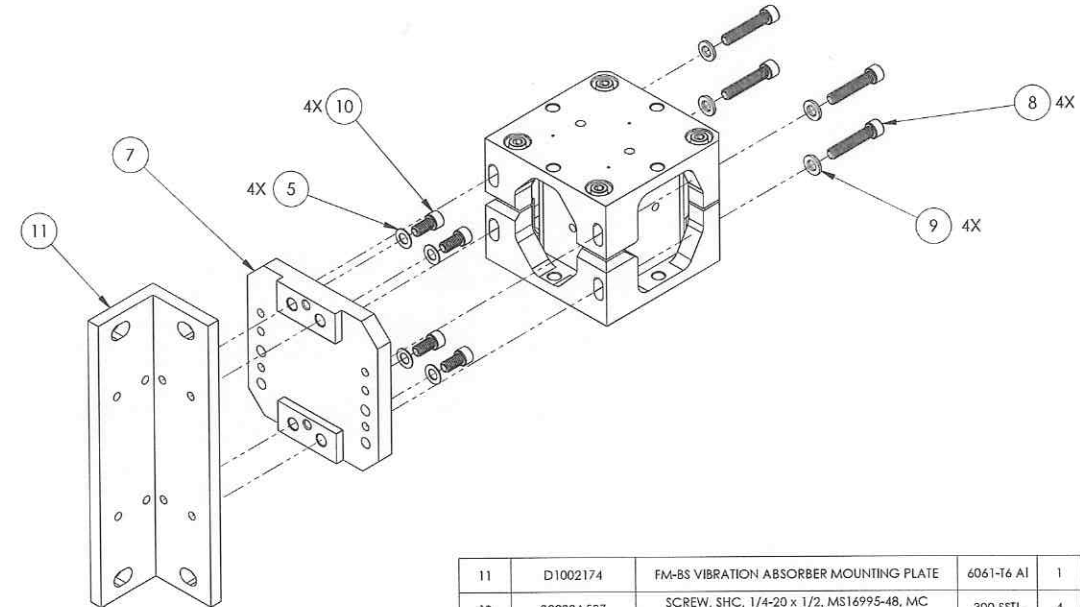

| ITEM NO. | PART NUMBER        | DESCRIPTION   | MATERIAL   | REQ | SPARE | TOTAL |
|----------|--------------------|---|------------|-----|-------|-------|
| 11       | D1002174           | FM-BS VIBRATION ABSORBER MOUNTING PLATE               | 6061-T6 Al | 1   |       | 1     |
| 10       | 92200A537          | SCREW, SHC, 1/4-20 x 1/2, MS16995-48, MC #92200A537   | 300 SSSL   | 4   |       | 4     |
| 9        | MCMaster_90945A761 | Washer .47 od x .26 id x .06-.07 thk                  | 18-8 SSSL  | 4   |       | 4     |
| 8        | 92200A544          | SCREW, SHC, 1/4-20 x 1 1/4, MS16995-53, MC #92200A544 | 300 SSSL   | 4   |       | 4     |
| 7        | D100895            | Plate 2 for SEI Vibration absorber 5 Lb version       | 6063-T6    | 1   |       | 1     |
| 5        | MCMaster_90945A760 | Washer .47 od x .26 id x .02-.04 thk                  | 18-8 SSSL  | 4   |       | 4     |
| 4        | 92200A548          | SCREW, SHC, 1/4-20 x 1 3/4, MS16995-55, MC #92200A548 | 18-8 SSSL  | 4   |       | 0     |

FM/BS CONFIGURATION

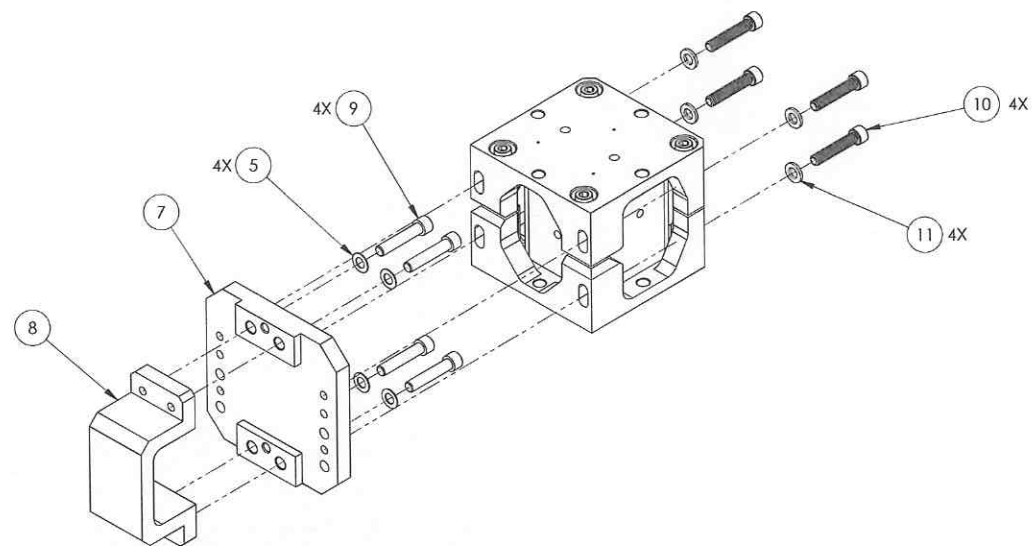

| ITEM NO. | PART NUMBER        | DESCRIPTION   | MATERIAL   | REQ | SPARE | TOTAL |
|----------|--------------------|---|------------|-----|-------|-------|
| 11       | MCMaster_90945A761 | Washer .47 od x .26 id x .06-.07 thk                  | 18-8 SSSL  | 4   |       | 4     |
| 10       | 92200A544          | SCREW, SHC, 1/4-20 x 1 1/4, MS16995-53, MC #92200A544 | 300 SSSL   | 4   |       | 4     |
| 9        | MCMaster_92196A540 | SHCS, 1/4-20 x 1.75" (1" to Fully Threaded)           | AISI 304   | 4   |       | 4     |
| 8        | D1001060           | CLAMP, VIBRATION ABSORBER, HLTS                       | 6061-T6 Al | 1   |       | 1     |
| 7        | D1000895           | Plate 2 for SEI Vibration absorber 5 Lb version       | 6063-T6    | 1   |       | 1     |
| 5        | MCMaster_90945A760 | Washer .47 od x .26 id x .02-.04 thk                  | 18-8 SSSL  | 4   |       | 4     |
| 4        | 92200A548          | SCREW, SHC, 1/4-20 x 1 3/4, MS16995-55, MC #92200A548 | 18-8 SSSL  | 4   |       | 0     |

HLTS CONFIGURATION

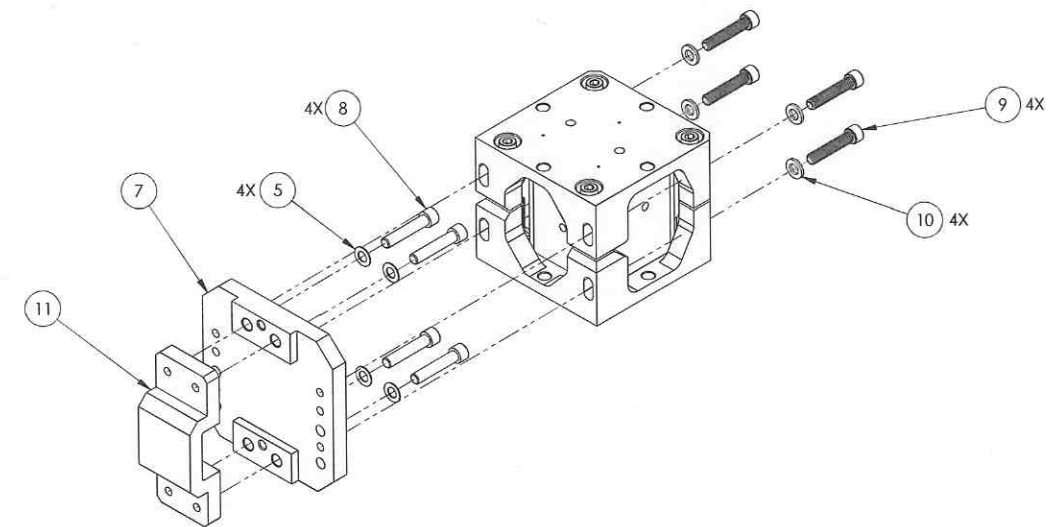

| ITEM NO. | PART NUMBER        | DESCRIPTION   | MATERIAL   | REQ | SPARE | TOTAL |
|----------|--------------------|---|------------|-----|-------|-------|
| 11       | D1001059           | CLAMP, VIBRATION ABSORBER, HSTS                       | 6061-T6 Al | 1   |       | 1     |
| 10       | MCMaster_90945A761 | Washer .47 od x .26 id x .06-.07 thk                  | 18-8 SSSL  | 4   |       | 4     |
| 9        | 92200A544          | SCREW, SHC, 1/4-20 x 1 1/4, MS16995-53, MC #92200A544 | 300 SSSL   | 4   |       | 4     |
| 8        | MCMaster_92196A540 | SHCS, 1/4-20 x 1.75" (1" to Fully Threaded)           | AISI 304   | 4   |       | 4     |
| 7        | D1000895           | Plate 2 for SEI Vibration absorber 5 Lb version       | 6063-T6    | 1   |       | 1     |
| 5        | MCMaster_90945A760 | Washer .47 od x .26 id x .02-.04 thk                  | 18-8 SSSL  | 4   |       | 4     |
| 4        | 92200A548          | SCREW, SHC, 1/4-20 x 1 3/4, MS16995-55, MC #92200A548 | 18-8 SSSL  | 4   |       | 0     |

HSTS CONFIGURATION