

D1300595 HALF WAVE PLATE MOUNT, HAM1, aLIGO, PART PDM REV: X-002, DRAWING PDM REV: X-003

NOTES CONTINUED:
⑤

REV.	DATE	DCN #	DRAWING TREE #
V1	26 JUN 2013		-
V2	9 JUL 2013	E1300570	-
-	-	-	-

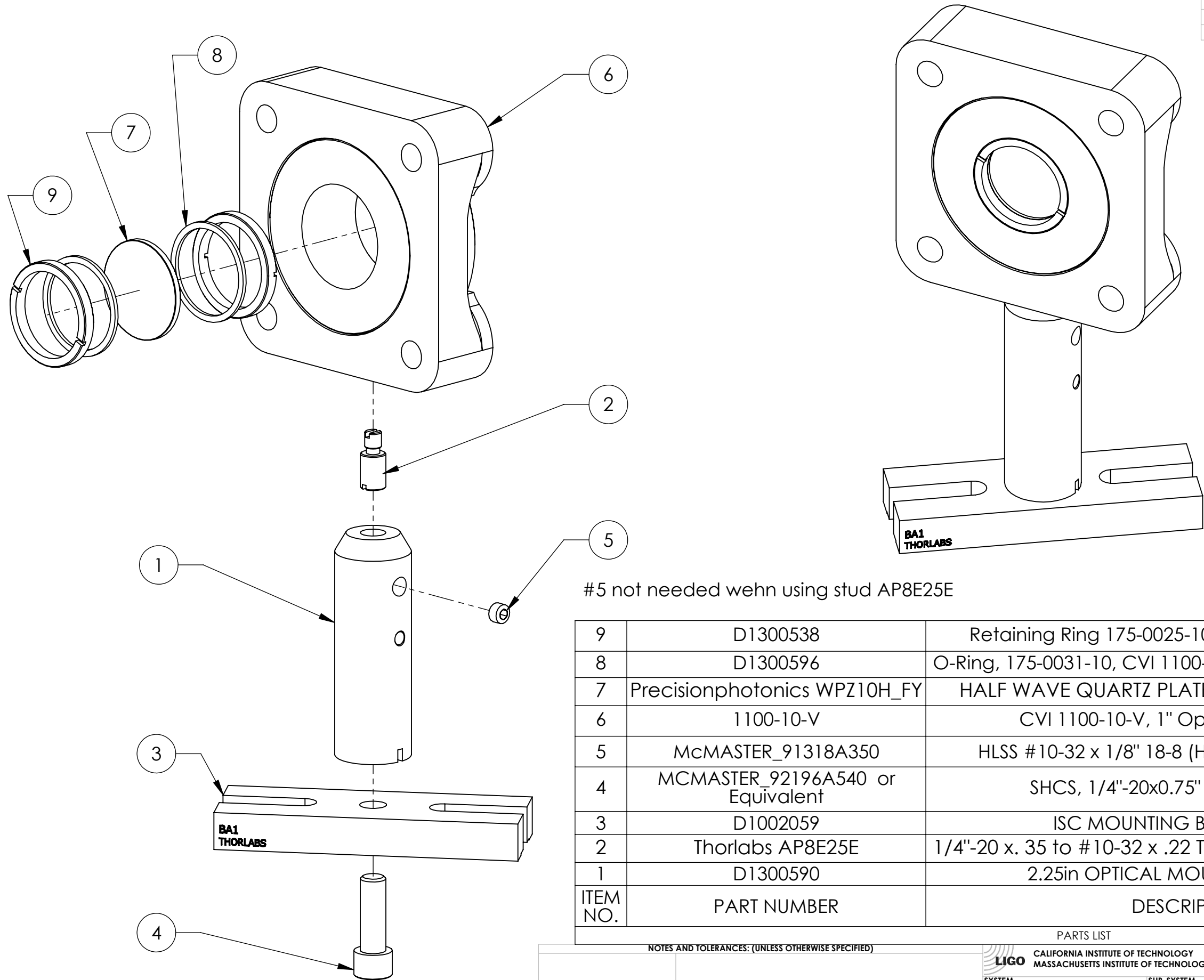

#5 not needed wehn using stud AP8E25E

ITEM NO.	PART NUMBER	DESCRIPTION	MATERIAL	RE Q
9	D1300538	Retaining Ring 175-0025-10, CVI 1100-10-V Mount	304 SSSL	2
8	D1300596	O-Ring, 175-0031-10, CVI 1100-10-V Mount (D040306-A-D)	PFA440	2
7	Precisionphotonics WPZ10H_FY	HALF WAVE QUARTZ PLATE ZERO ORDER 1064NM	Glass	1
6	1100-10-V	CVI 1100-10-V, 1" Optic, Rotary Mount		1
5	McMASTER_91318A350	HLSS #10-32 x 1/8" 18-8 (Hollow Lock Set Screw)	18-8 SSSL	1
4	MCMaster_92196A540 or Equivalent	SHCS, 1/4"-20x0.75" (Fully Threaded)	18-8 SSSL	1
3	D1002059	ISC MOUNTING BASE - DOUBLE	6061-T6 Al	1
2	Thorlabs AP8E25E	1/4"-20 x. 35 to #10-32 x .22 Thread Adapter Stud, 18-8	18-8 SSSL	1
1	D1300590	2.25in OPTICAL MOUNT POST, aLIGO	6061-T6 Al	1
PARTS LIST				

NOTES AND TOLERANCES: (UNLESS OTHERWISE SPECIFIED)

MATERIAL		FINISH		NEXT ASSY		PART NAME		REV.	
N/A		N/A μinch		D1000313		CALIFORNIA INSTITUTE OF TECHNOLOGY MASSACHUSETTS INSTITUTE OF TECHNOLOGY LIGO ADVANCED LIGO ISC HALF WAVE PLATE MOUNT, HAM1, aLIGO		v2	
						DESIGNER		SIZE DWG. NO.	
						DRAFTER		B	
						CHECKER		D1300595	
						APPROVAL		SCALE: 1:1	
						PFRITSCHEL		PROJECTION:	
						26 JUN 2013		SHEET 1 OF 1	