

D1300525 aLIGO Pcal Tooling, Receiver Mount Fixture, PART PDM REV: X-025, DRAWING PDM REV: X-009

**NOTES:**

- ① -01, USE FOR X-ARM  
-02, USE FOR Y-ARM
- ② -01 & -02 CONFIGURATIONS CAN BE MADE FROM THE IDENTICAL SET OF PARTS.

REV.	DATE	DCN #	DRAWING TREE #
v1	12 JUL 2013	E1300584-x0	-
-	-	-	-
-	-	-	-

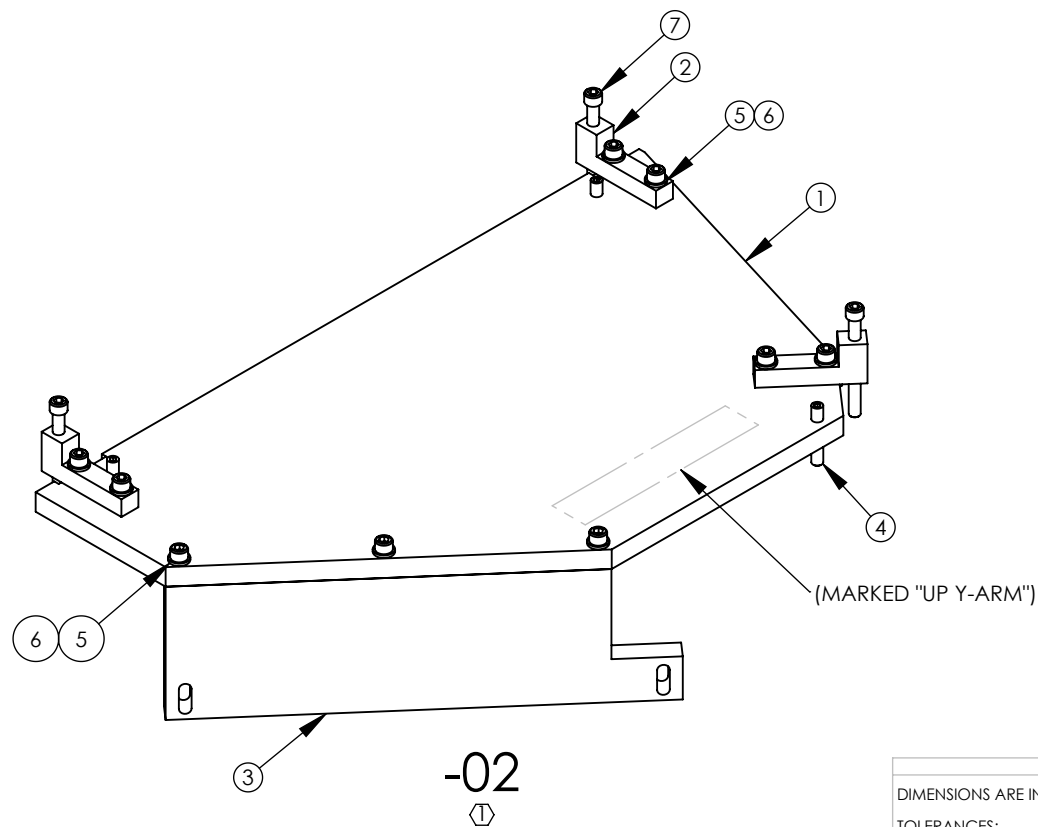
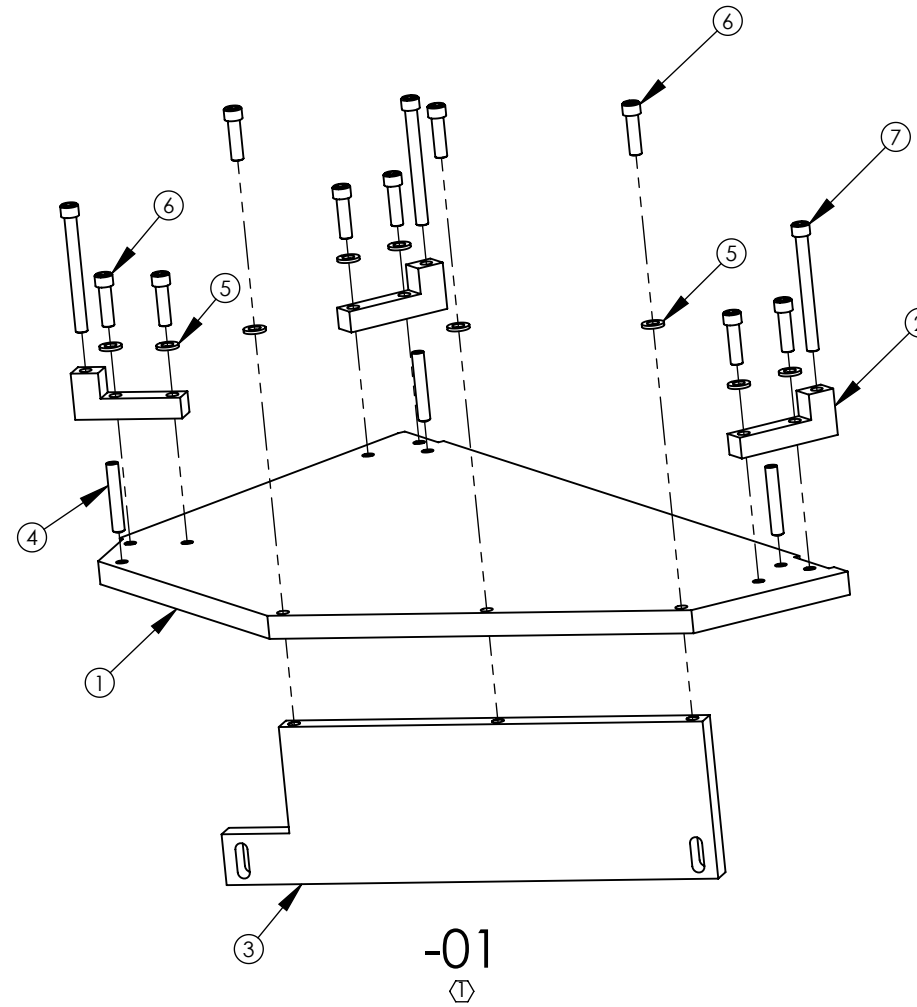
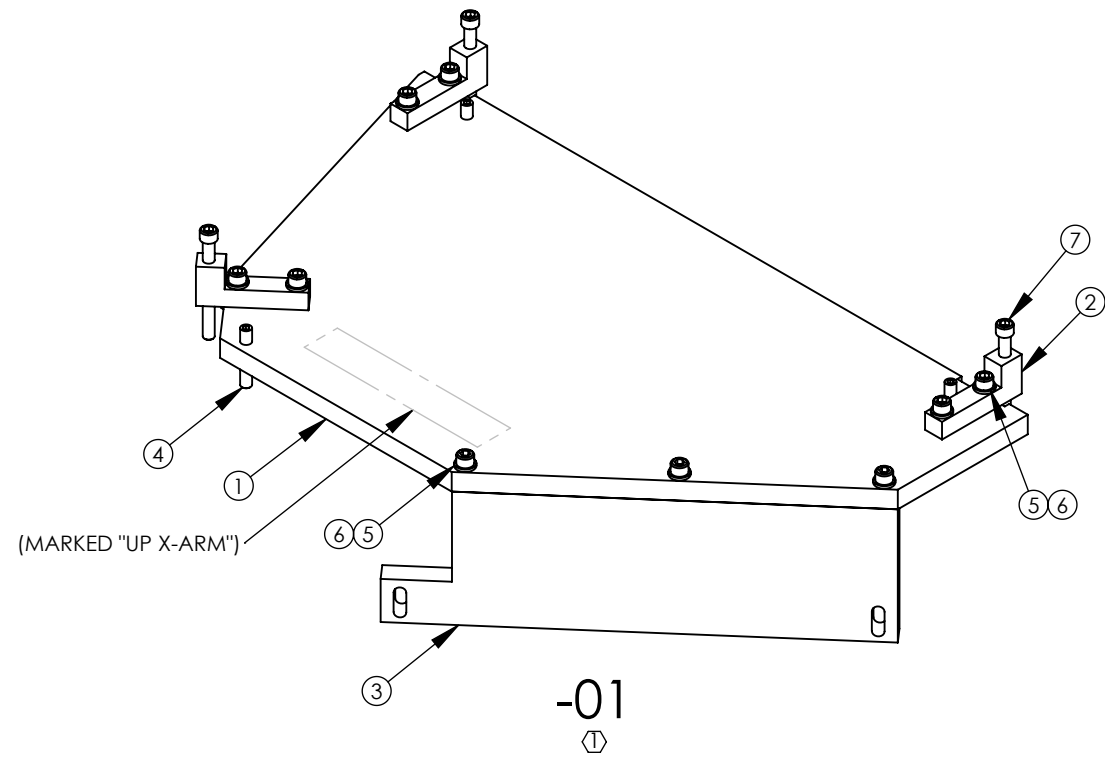

ITEM NO.	PART NUMBER	DESCRIPTION	REV	MATERIAL	-01/QTY.	-02/QTY.	SPARE	TOTAL
7	92196A552 (McM-Carr) or equiv	SCREW, SOCKET HEAD CAP, 1/4-20 UNC-2A X 2.5 LONG	-	300 SSSL	3	3		3
6	92196A541 (McM-Carr) or equiv	SCREW, SOCKET HEAD CAP, 1/4-20 UNC-2A X 0.875 LONG	-	300 SSSL	9	9		9
5	98017A655 (McM-Carr) or equiv PER NAS 620-C416	WASHER, FLAT, 1/4	-	300 SSSL	9	9		9
4	92765A317 (McM-Carr) or equiv	SCREW, SOCKET SET, OVAL POINT, 1/4-20 UNC X 1.5 LONG	-	ALLOY STEEL	3	3		3
3	D1300524	aLIGO PCAL TOOLING, RECEIVER MOUNT FIXTURE STOP	v1	6061-T6 Al	1	1		1
2	D1300523	aLIGO PCAL TOOLING, RECEIVER MOUNT FIXTURE BLOCK	v2	6061-T6 Al	3	3		3
1	D1300522	aLIGO PCAL TOOLING, RECEIVER MOUNT FIXTURE PLATE	v3	6061-T6 Al	1	1		1
PARTS LIST								

**NOTES AND TOLERANCES: (UNLESS OTHERWISE SPECIFIED)**

DIMENSIONS ARE IN INCHES  
 TOLERANCES:  
 .XX ±  
 .XXX ±  
 ANGULAR ± °

MATERIAL: N/A  
 FINISH: N/A μinch

**LIGO** CALIFORNIA INSTITUTE OF TECHNOLOGY  
 MASSACHUSETTS INSTITUTE OF TECHNOLOGY

SYSTEM: ADVANCED LIGO SUB-SYSTEM: AOS

PART NAME: aLIGO PCAL TOOLING, RECEIVER MOUNT FIXTURE

DESIGNER: R. SAVAGE  
 DRAFTER: C. CONLEY  
 CHECKER: SEE DCN  
 APPROVAL: SEE DCN

DATE: 07 JUN 2013  
 12 JUL 2013  
 SEE DCN  
 SEE DCN

SIZE: B DWG. NO.: D1300525

REV: v1

SCALE: NONE PROJECTION: SHEET 1 OF 1