

NOTES (CONTINUED):

④ SCRIBE, ENGRAVE (A VIBRATORY TOOL MAY BE USED), LASER MARK OR MECHANICALLY STAMP (NO INKS OR DYES) DRAWING PART NUMBER, REVISION ON NOTED SURFACE OF PART FOLLOWED ON THE NEXT LINE WITH A THREE DIGIT SERIAL NUMBER. SERIAL NUMBERS START AT 001 FOR THE FIRST ARTICLE AND PROCEED CONSECUTIVELY. USE MINIMUM 0.12" HIGH CHARACTERS, UNLESS THE SIZE OF THE PART DICTATES SMALLER CHARACTERS. EXAMPLE: D1300523-v2, S/N 001

5. WEIGHT: 0.06 LB.

⑥ OPTIONAL MATERIAL: ALUMINUM TOOLING PLATE.

REV.	DATE	DCN #	BOM #
v1	11 JUN 2013	-	-
v2	09 JUL 2013	-	-
-	-	-	-

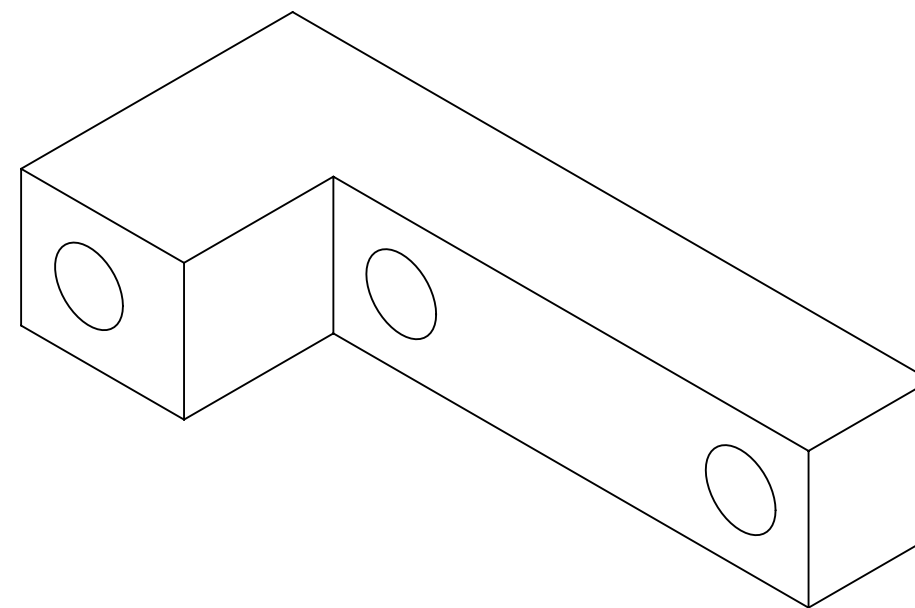
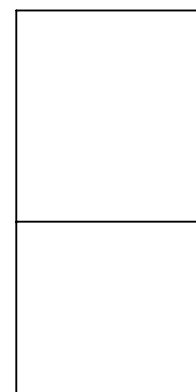
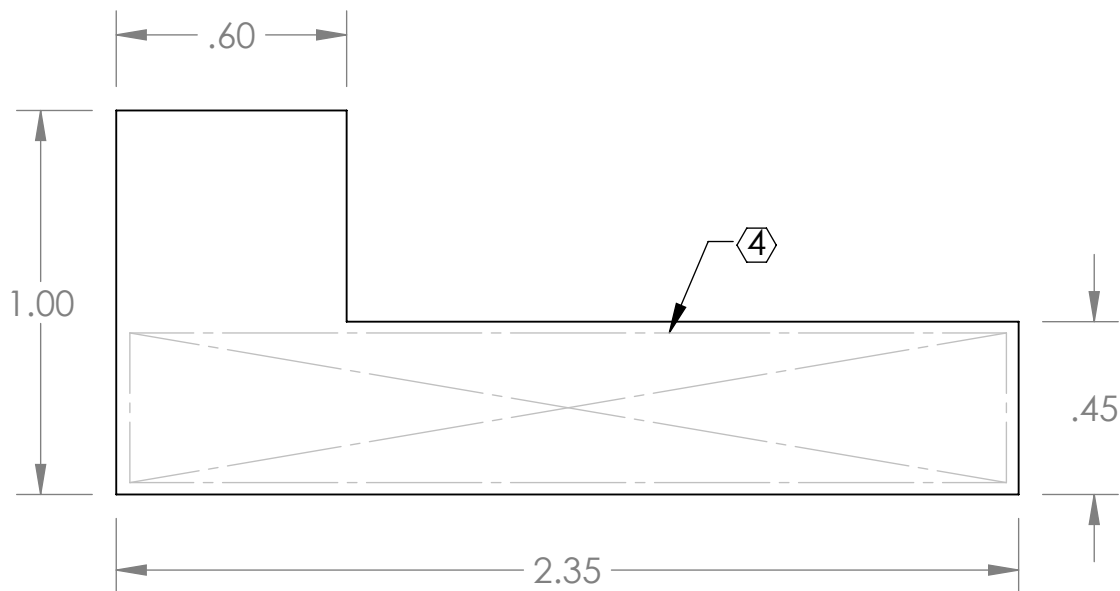
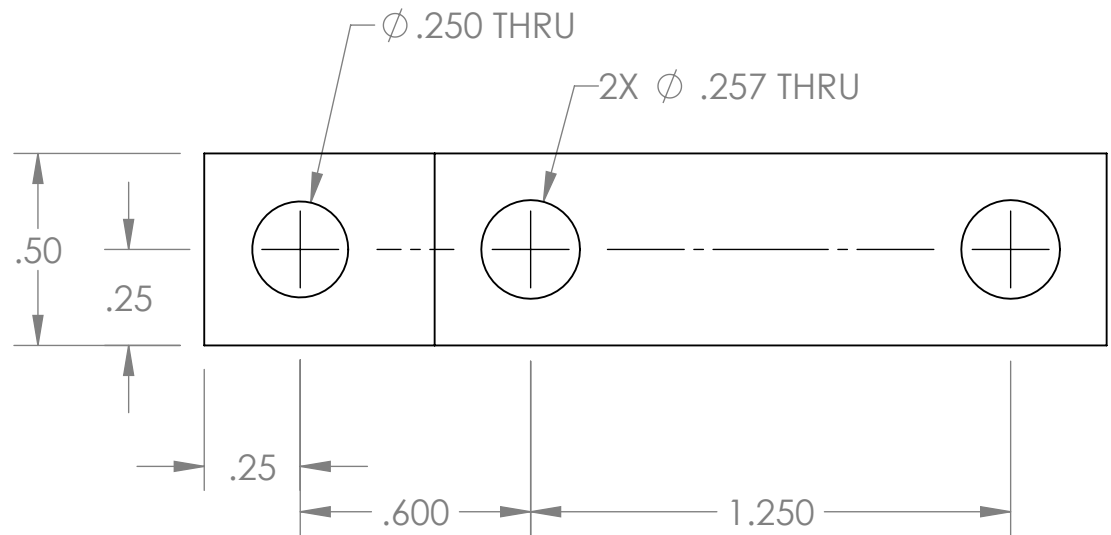

D1300523 aLIGO Pcal Tooling, Receiver Mount Fixture Block, PART PDM REV: X-005, DRAWING PDM REV: X-003

NOTES AND TOLERANCES: (UNLESS OTHERWISE SPECIFIED)

DIMENSIONS ARE IN INCHES
 TOLERANCES:
 .XX ± .01
 .XXX ± .005
 ANGULAR ± 1.0°

1. INTERPRET DRAWING PER ASME Y14.5-1994.
2. BREAK ALL SHARP EDGES, .02 MAX.
3. DO NOT SCALE FROM DRAWING.

MATERIAL 6061-T6 Al ⑥ FINISH 250 μ inch Ra MAX

LIGO CALIFORNIA INSTITUTE OF TECHNOLOGY
 MASSACHUSETTS INSTITUTE OF TECHNOLOGY
 SYSTEM ADVANCED LIGO SUB-SYSTEM AOS
 NEXT ASSY D1300525

PART NAME aLIGO PCAL TOOLING, RECEIVER MOUNT FIXTURE BLOCK
 DESIGNER R. SAVAGE
 DRAFTER C. CONLEY
 CHECKER C. CONLEY
 APPROVAL
 DATE 09 JUN 2013
 SIZE DWG. NO. B D1300523
 REV. v2
 SCALE: NONE PROJECTION: SHEET 1 OF 1