

8 7 6 5 4 3 2 1

REV.	DATE	DCN #	DRAWING TREE #
v1	04 APR 2013	E1300257	-
-	-	-	-
-	-	-	-

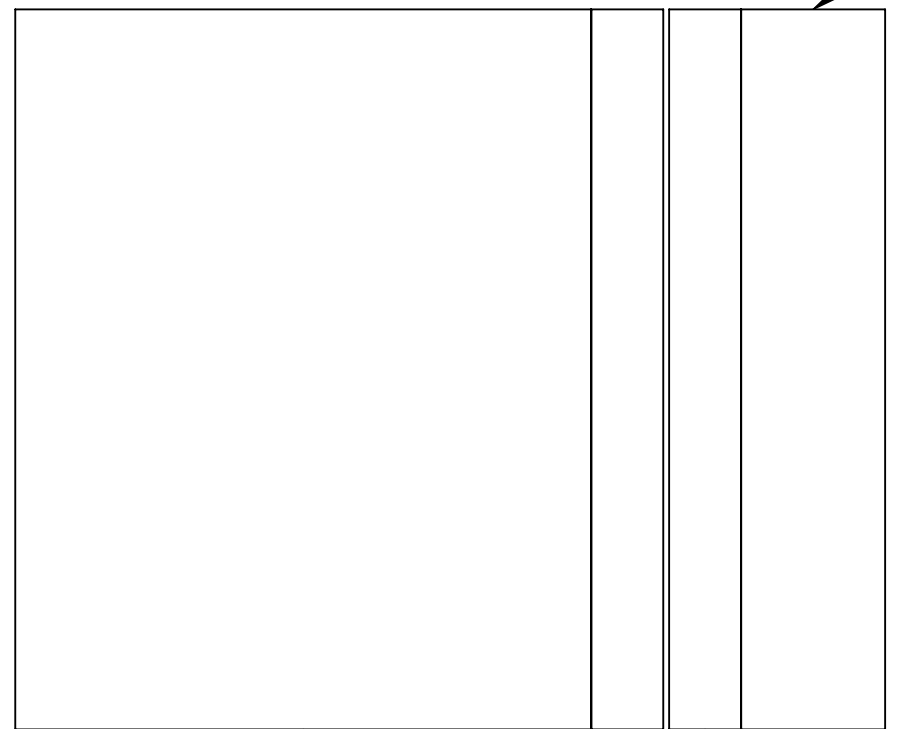
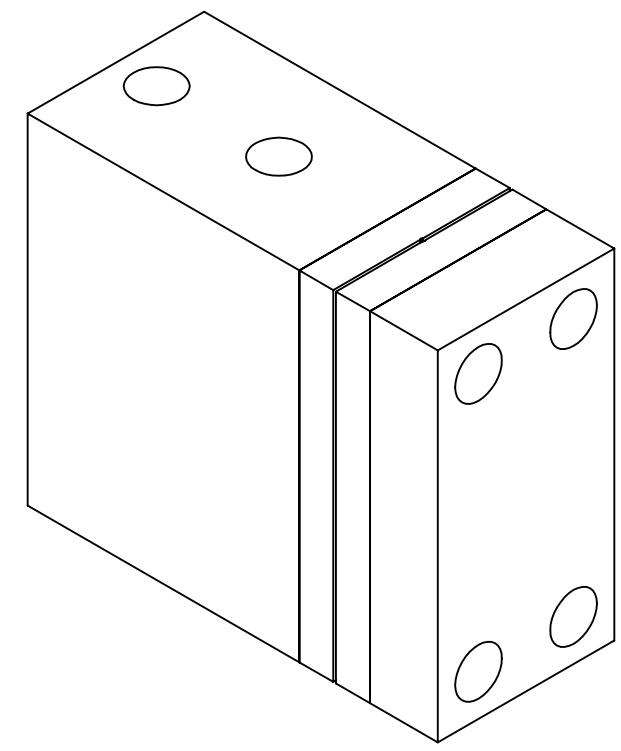
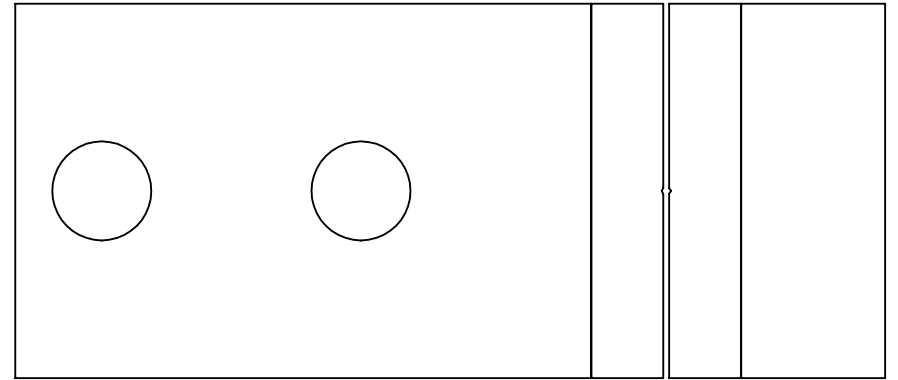

1

3

2

D1300315 - Wire clamp, PART PDM REV.: DRAWING PDM REV:

D C B A

D C B A

ITEM NO.	PART NUMBER	DESCRIPTION	MATERIAL	REQ
3	D1300316	Steel part for the clamp	AISI 304	2
2	D1300298	Wire clamp on the suspension part 2	6061 Alloy	1
1	D1300297	Wire clamp on the suspension part 1	6061 Alloy	1

PARTS LIST

NOTES AND TOLERANCES: (UNLESS OTHERWISE SPECIFIED)	
DIMENSIONS ARE IN INCHES	
TOLERANCES: .XX ± 0.01 .XXX ± 0.005 ANGULAR ± 0.5°	
1. INTERPRET DRAWING PER ASME Y14.5-1994.	2. REMOVE ALL SHARP EDGES, .005-.015, FOR MACHINED PARTS. ROUND ALL EDGES APPROXIMATELY R.02 FOR SHEET METAL PARTS.
3. DO NOT SCALE FROM DRAWING.	
4. ALL MACHINING FLUIDS MUST BE FULLY SYNTHETIC, FULLY WATER SOLUBLE AND FREE OF SULFUR, SILICONE, AND CHLORINE.	
MATERIAL	N/A
FINISH	N/A μinch

CALIFORNIA INSTITUTE OF TECHNOLOGY MASSACHUSETTS INSTITUTE OF TECHNOLOGY		PART NAME		Wire clamp on the suspension	
SYSTEM	ADVANCED LIGO	SUB-SYSTEM	SEI	DESIGNER	A.CARBAJO 04 APR 2013
NEXT ASSY	D1300293	CHECKER	F.MATICHARD 04 APR 2013	APPROVAL	F.MATICHARD 04 APR 2013
SIZE DWG. NO. B D1300315			REV.	v1	
SCALE: 1:1			PROJECTION:	SHEET 1 OF 1	

8 7 6 5 4 3 2 1