

REV.	DATE	DCN #	DRAWING TREE #
v1	8 MAR 2013	E1300168-x0	-
v2	08 APR 2013	E1300263-x0	-
v3	02 AUG 2014	E1400360-x0	-

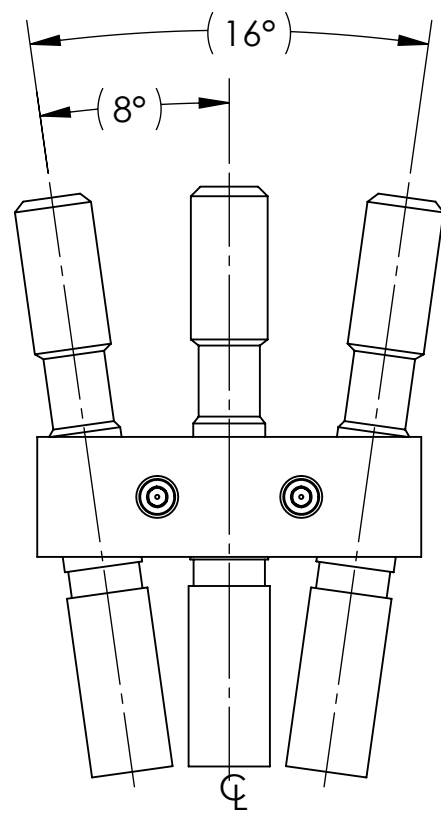

TOP

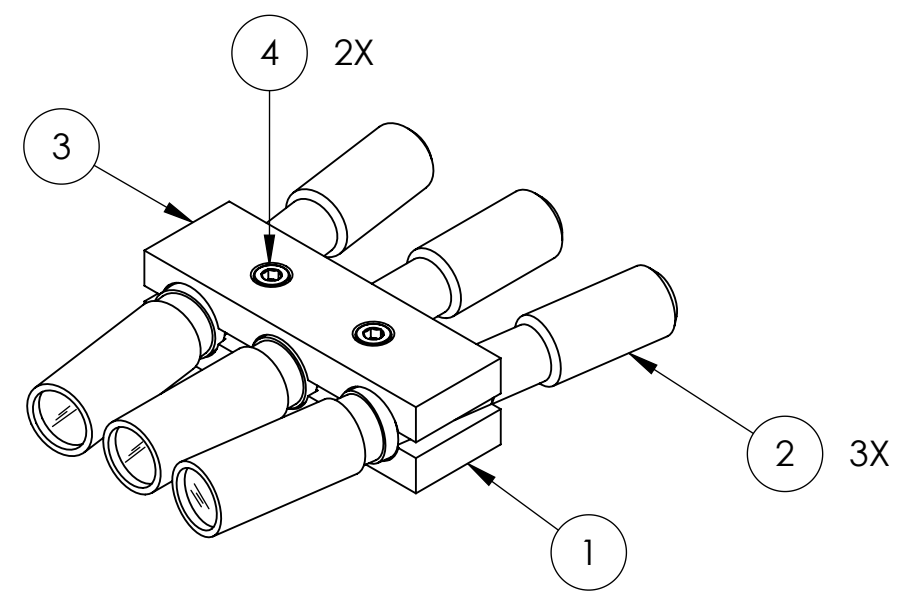

ISO VIEW

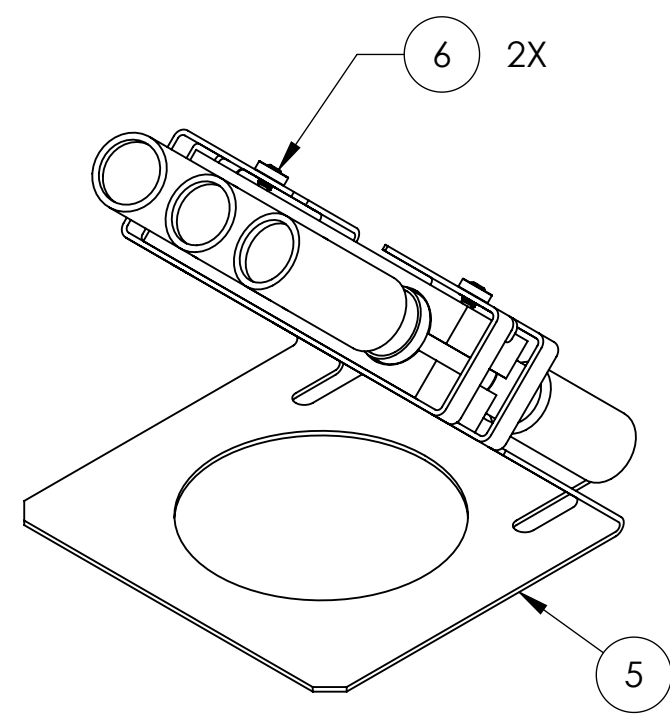

ISO VIEW
(SHOWN WITH OPTIONAL 45 DEGREE MT.)

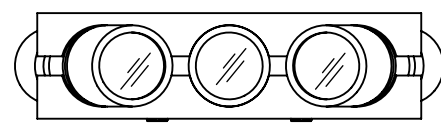

FRONT

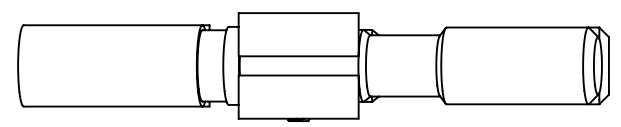

SIDE VIEW

6	94355A190	SET SCREW, 8 -32 X .25 LG.	2
5	D1400299	Aligo, SYS, Flashlight Holder, 45 Angle Mt.	1
4	92200A541	MCMMASTER 1/4-20 x 7/8 SHCS	2
3	D1300225 Upper, Flashlight Holder	UPPER, FLASHLIGHT HOLDER	1
2	Fenix LD22	LED FLASHLIGHT	3
1	D1300224 Base, Flashlight Holder	BASE, FLASHLIGHT HOLDER	1
ITEM NO.	PART NUMBER	DESCRIPTION	QTY.

NOTES AND TOLERANCES: (UNLESS OTHERWISE SPECIFIED)

MATERIAL		FINISH		NEXT ASSY		PART NAME	
N/A		N/A μinch		NA		FLASHLIGHT HOLDER	
LIGO CALIFORNIA INSTITUTE OF TECHNOLOGY MASSACHUSETTS INSTITUTE OF TECHNOLOGY				DESIGNER J.LEWIS 8 MAR 2013 DRAFTER J.LEWIS 8 MAR 2013 CHECKER APPROVAL		SIZE DWG. NO. B D1300223	
						REV. v3 SCALE: 1:2 PROJECTION: SHEET 1 OF 1	

D1300223 Flashlight Holder, PART PDM REV: X-004, DRAWING PDM REV: X-006