

D1201545\_BASE, LOWER PERISCOPE MIRROR MOUNT, dLIGO TCS CO2P, H1-L1, PART PDM REV: X-003, DRAWING PDM REV: X-005

**NOTES CONTINUED:**  
 5. SCRIBE, ENGRAVE (A VIBRATORY TOOL MAY BE USED), LASER MARK OR MECHANICALLY STAMP (NO INKS OR DYES) DRAWING PART NUMBER, REVISION (AND VARIANT OR "TYPE" IF APPLICABLE) ON NOTED SURFACE OF PART FOLLOWED ON THE NEXT LINE WITH A THREE DIGIT SERIAL NUMBER. SERIAL NUMBERS START AT 001 FOR THE FIRST ARTICLE AND PROCEED CONSECUTIVELY. USE MINIMUM 0.12" HIGH CHARACTERS, UNLESS THE SIZE OF THE PART DICTATES SMALLER CHARACTERS. EXAMPLE: DXXXXXX-VY, TYPE-XX, S/N XXX

- 6. APPROXIMATE WEIGHT = 0.46 LB
- 7. ALL PARTS SHALL BE MANUFACTURED IN ACCORDANCE WITH LIGO SPECIFICATION E0900364.
- 8. ALL MATERIAL IS TO BE VIRGIN MATERIAL (i.e. NO WELD REPAIRS, PLUGS OR RECYCLED MATERIAL). NO REPAIRS SHALL BE MADE UNLESS APPROVED IN ADVANCE, AND IN WRITING, BY LIGO LABORATORY. REFER TO LIGO-E0900364.
- 9. SURFACE FINISH TO BE AS-PROCESSED FROM MILL/SUPPLIER, FREE FROM SCRATCHES OR GOUGES.

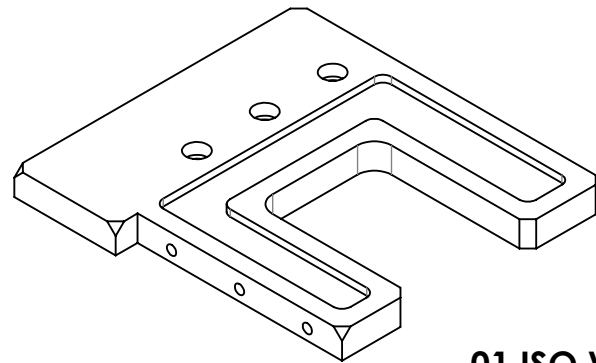

**-01 ISO VIEW  
SCALE 1:2**

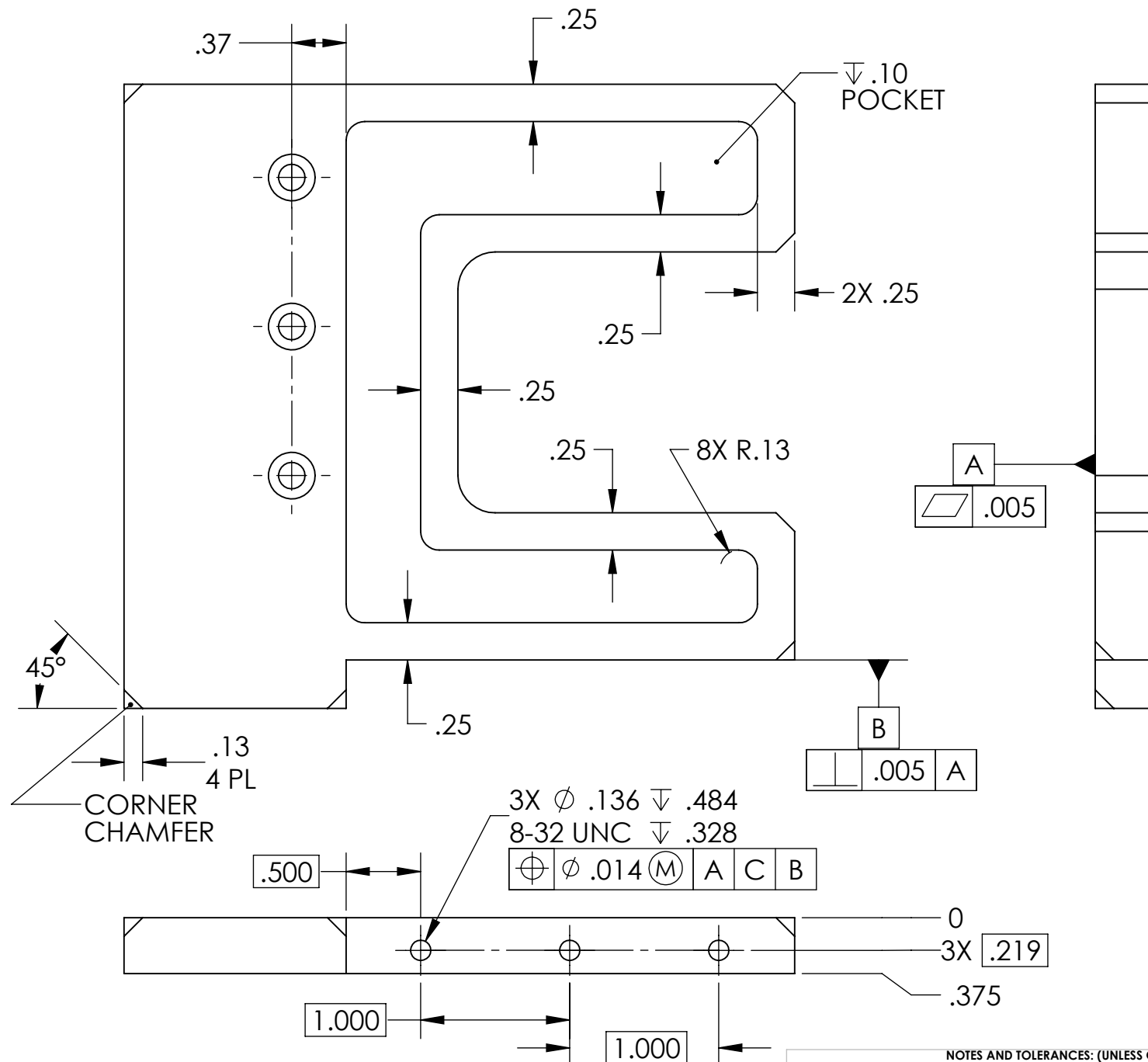

TYPE	DESCRIPTION
-01	X-ARM (SHEET 1)
-02	Y-ARM (SHEET 2)

REV.	DATE	DCN #	DRAWING TREE #
v1	12-DEC-2012	E1200891-x0	E1201007-v1
v2	09-OCT-2013	E1300729-x0	E1201007-v3
-	-	-	-

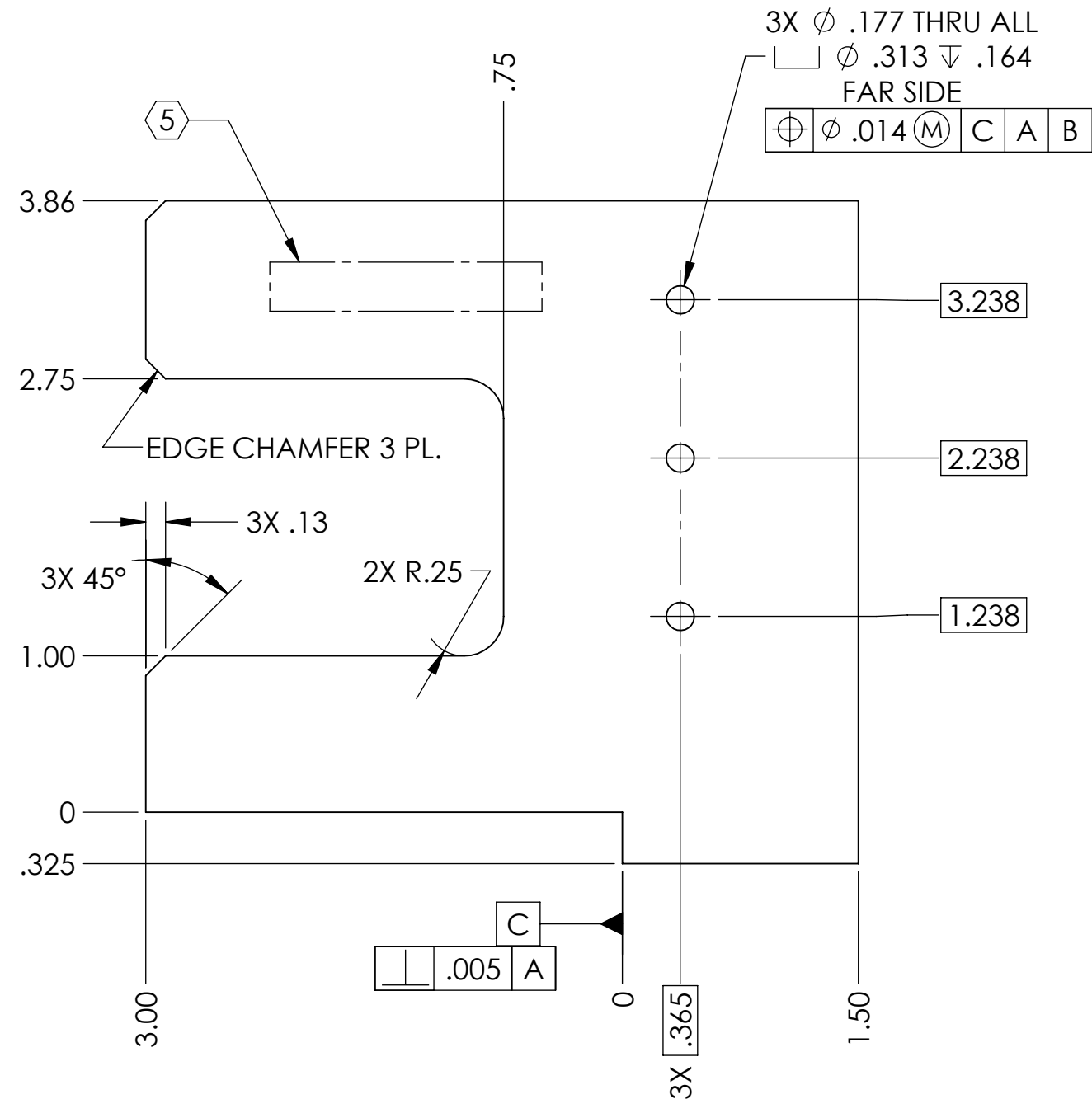

**-01 DETAIL**

**NOTES AND TOLERANCES: (UNLESS OTHERWISE SPECIFIED)**

DIMENSIONS ARE IN INCHES

TOLERANCES:  
 .XX ± .01  
 .XXX ± .006  
 ANGULAR ± 1.0°

1. INTERPRET DRAWING PER ASME Y14.5-1994.  
 2. REMOVE ALL SHARP EDGES, .005-.015, FOR MACHINED PARTS. ROUND ALL EDGES APPROXIMATELY R.02  
 3. DO NOT SCALE FROM DRAWING.  
 4. ALL MACHINING FLUIDS MUST BE FULLY SYNTHETIC, FULLY WATER SOLUBLE AND FREE OF SULFUR, SILICONE, AND CHLORINE.

**MATERIAL** 6061-T6 Al **FINISH** 63 μinch

CALIFORNIA INSTITUTE OF TECHNOLOGY MASSACHUSETTS INSTITUTE OF TECHNOLOGY		<b>PART NAME</b> BASE, LOWER PERISCOPE MIRROR MOUNT	
<b>SYSTEM</b> ADVANCED LIGO	<b>SUB-SYSTEM</b> AOS	<b>DESIGNER</b> M. JACOBSON 11-DEC-2012 <b>DRAFTER</b> M. JACOBSON 12-DEC-2012 <b>CHECKER</b> E. SANCHEZ 09-OCT-2013 <b>APPROVAL</b> HEPTONSTALL07-OCT-2013	<b>SIZE DWG. NO.</b> <b>B</b> D1201545 <b>SCALE:</b> 1:1 <b>PROJECTION:</b>
<b>NEXT ASSY</b> D1201400	<b>REV.</b> v2	SHEET 1 OF 2	

D1201545\_BASE, LOWER PERISCOPE MIRROR MOUNT, cLIGO TCS CO2P, HI-L1, PART PDM REV: X-002, DRAWING PDM REV: X-005

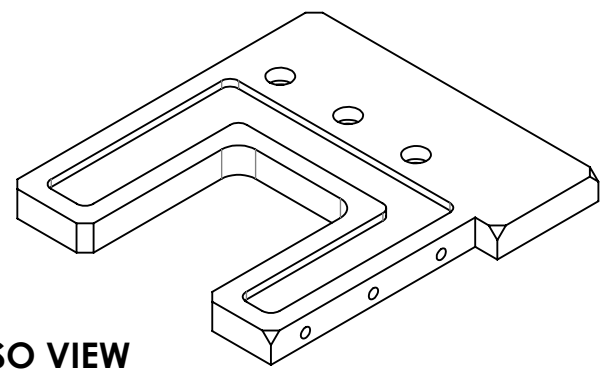

-02 ISO VIEW  
SCALE 1:2

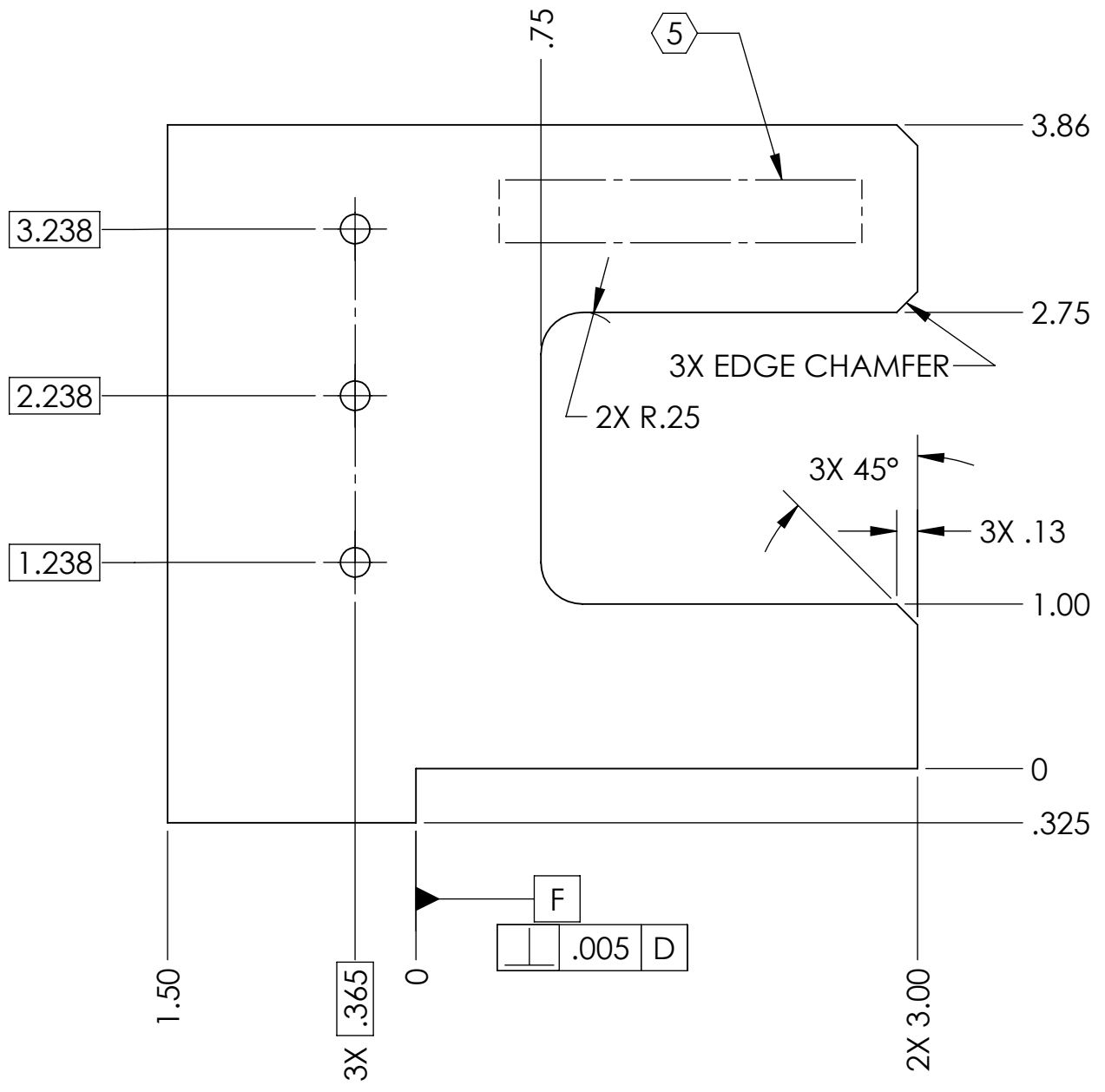

-02 DETAIL

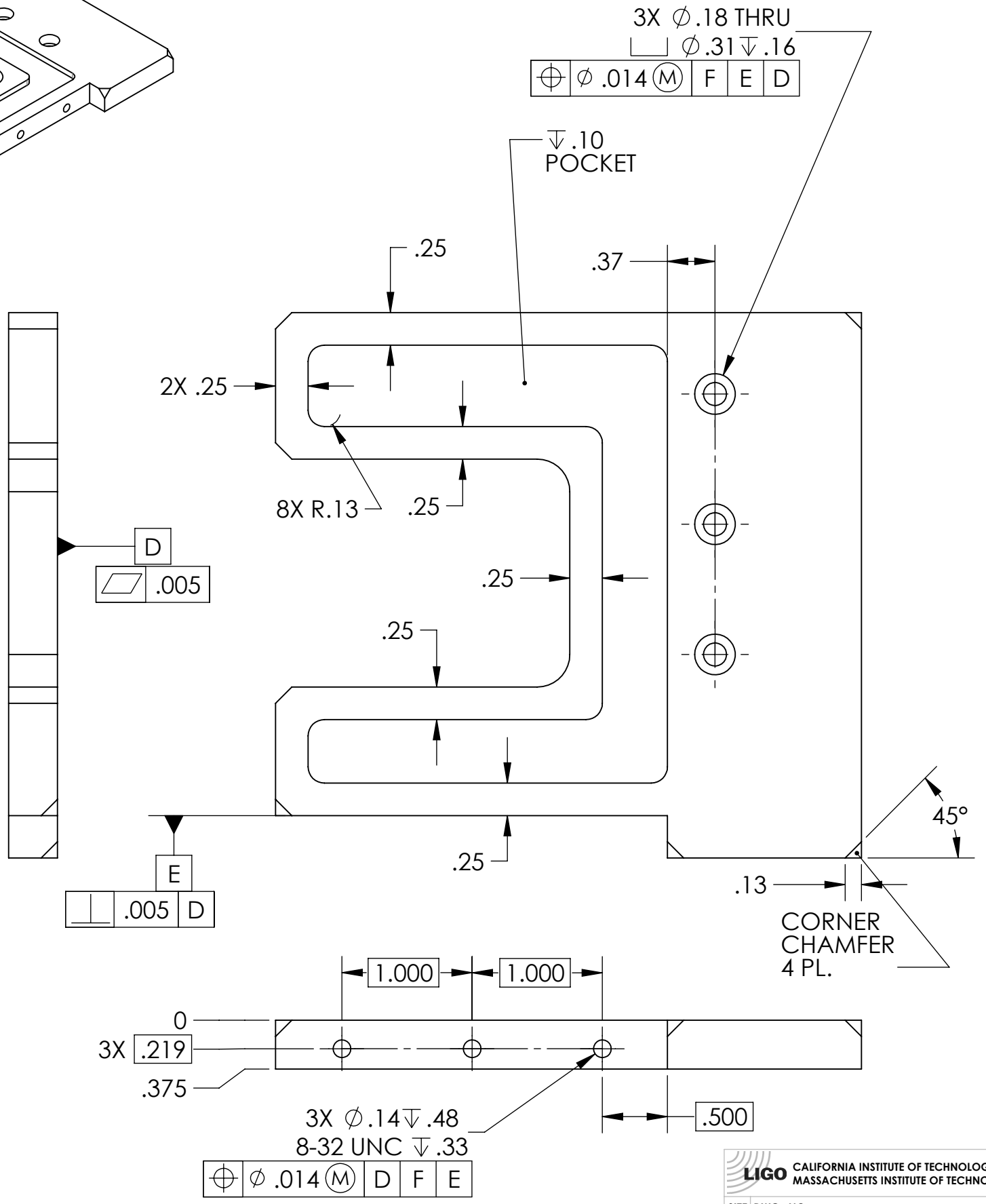

**LIGO** CALIFORNIA INSTITUTE OF TECHNOLOGY  
MASSACHUSETTS INSTITUTE OF TECHNOLOGY

SIZE	DWG. NO.	REV.
B	D1201545-02	v2
SCALE: 1:1	PROJECTION:	SHEET 2 OF 2