

NOTES CONTINUED:
 5 SCRIBE, ENGRAVE (A VIBRATORY TOOL MAY BE USED), LASER MARK OR MECHANICALLY STAMP (NO INKS OR DYES) DRAWING PART NUMBER, REVISION (AND VARIANT OR "TYPE" IF APPLICABLE) ON NOTED SURFACE OF PART FOLLOWED ON THE NEXT LINE WITH A THREE DIGIT SERIAL NUMBER. SERIAL NUMBERS START AT 001 FOR THE FIRST ARTICLE AND PROCEED CONSECUTIVELY. USE MINIMUM 0.12" HIGH CHARACTERS, UNLESS THE SIZE OF THE PART DICTATES SMALLER CHARACTERS. EXAMPLE: DXXXXXX-VY, TYPE-XX, S/N XXX

REV.	DATE	DCN #	BOM #
v1	22 AUG 2012	-	-
-	-	-	-
-	-	-	-

- D 6. WEIGHT: 0.98 LB.
 7 ALL TAPPED HOLES: 0.005 OVERSIZE BOTH DRILL AND TAP.
 8 ALL MACHINED SURFACES (TAP HOLES & THREADS EXCLUDED): 63 μinch MAX ROUGHNESS.

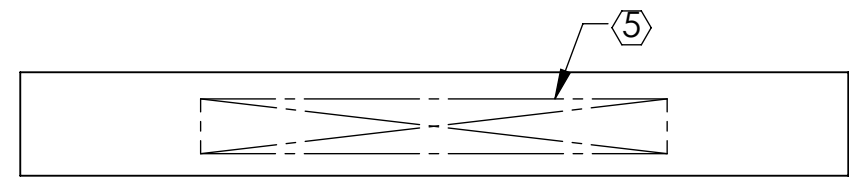

4X TAP DRILL THRU ALL 8-32 UNC - 2B, H11, ∇ .30 MIN (BOTH SIDES)
 \sphericalangle ϕ .21 X 90°±10° (BOTH SIDES)
 7

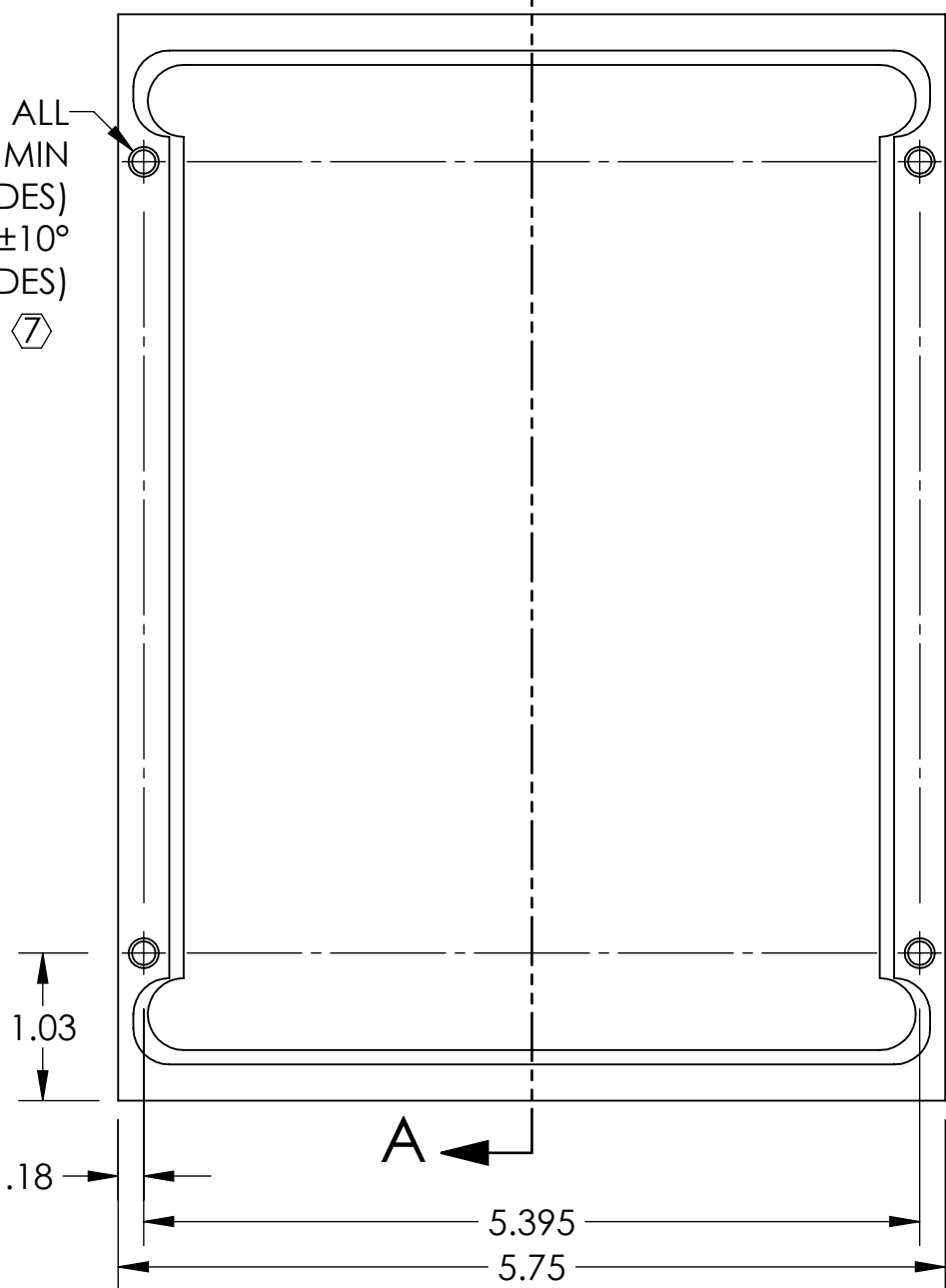

MACHINE

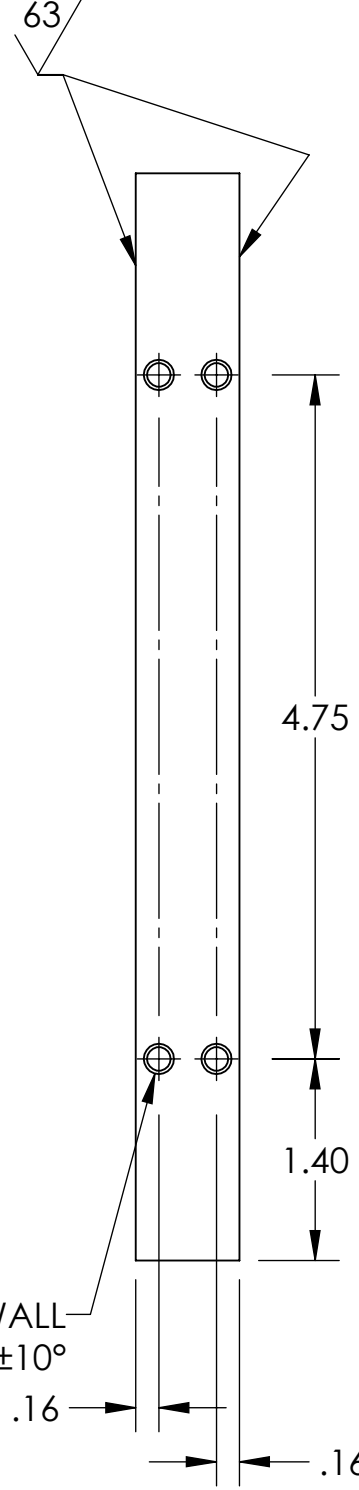

2X .260
 2X .035

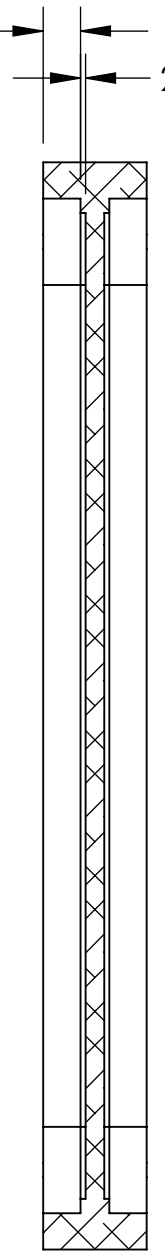

SECTION A-A

HOG-OUT DETAILS:
 SEE SHEET 2

NOTES AND TOLERANCES: (UNLESS OTHERWISE SPECIFIED)				LIGO CALIFORNIA INSTITUTE OF TECHNOLOGY MASSACHUSETTS INSTITUTE OF TECHNOLOGY		PART NAME	
DIMENSIONS ARE IN INCHES				ADVANCED LIGO		aLIGO PCal 5" X 7" MIRROR STORAGE HOLDER	
TOLERANCES: .XX ± .01 .XXX ± .005				SUB-SYSTEM AOS		DESIGNER T. STECKLER 21 JUN 2012	SIZE DWG. NO. B
ANGULAR ± 0.1°				NEXT ASSY D1201175		DRAFTER C. CONLEY 22 AUG 2012	D1201173
MATERIAL 6061-T6 Al FINISH 8				APPROVAL		CHECKER	REV. v1
						CHECKER	SCALE: NONE PROJECTION:
						APPROVAL	SHEET 1 OF 2

D1201173 aLIGO PCal 5in X 7in Mirror Storage Holder, PART PDM REV: X-003, DRAWING PDM REV: X-004

D1201173 aLIGO PCal 5in X 7in Mirror Storage Holder, PART PDM REV: X-003, DRAWING PDM REV: X-004

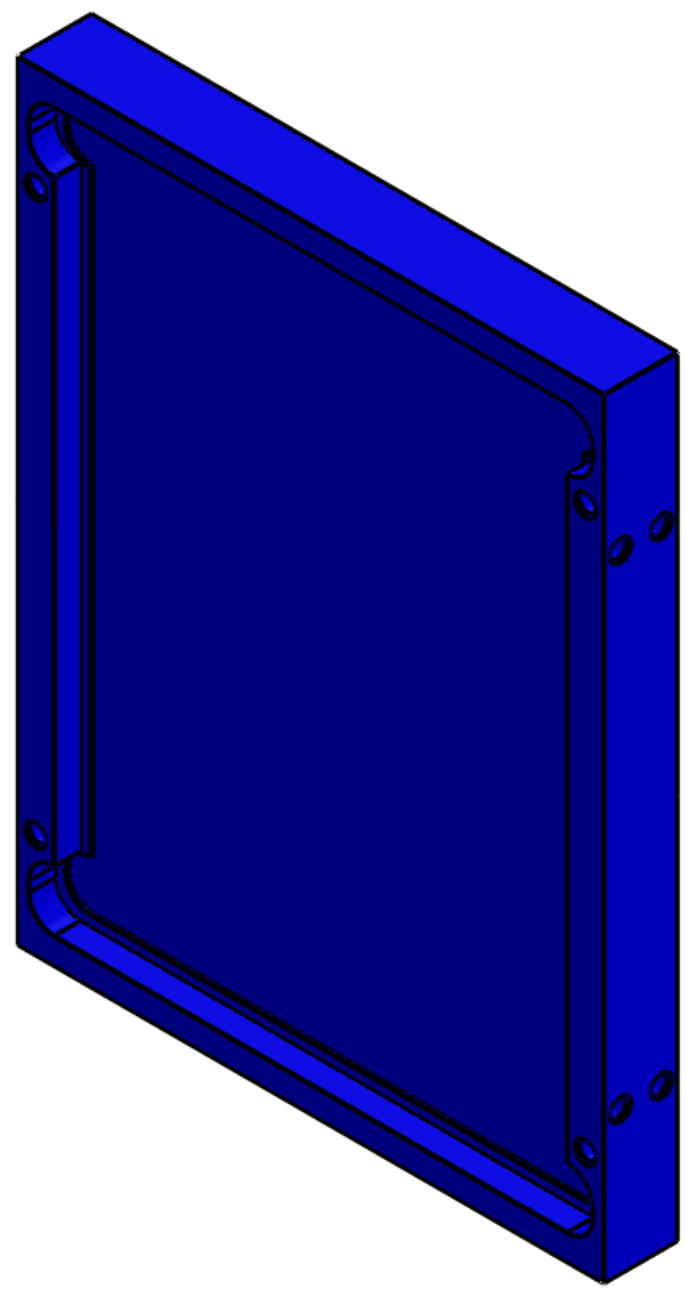
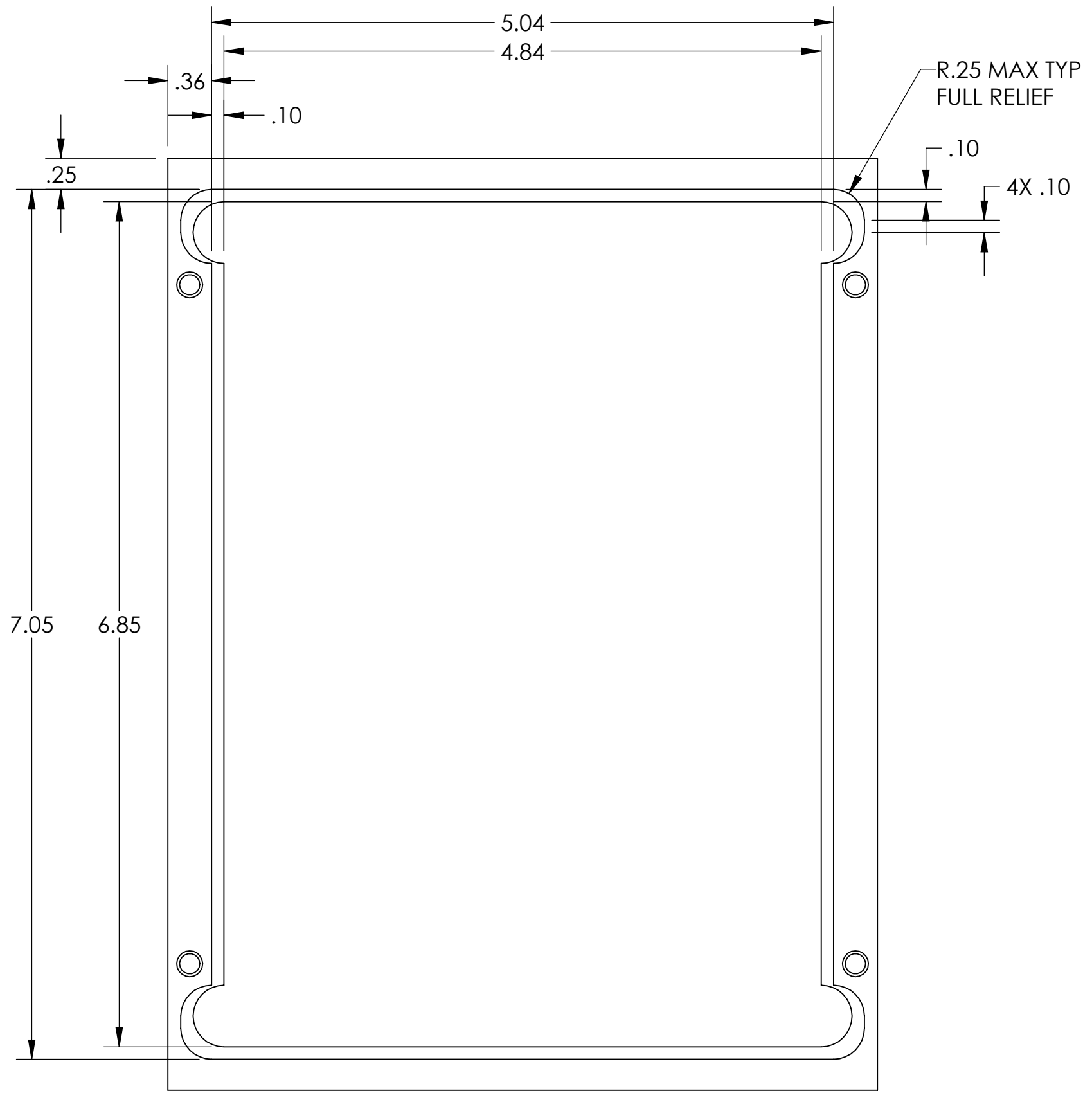

ALL FEATURES THIS VIEW:
REPEAT BOTH SIDES

 CALIFORNIA INSTITUTE OF TECHNOLOGY MASSACHUSETTS INSTITUTE OF TECHNOLOGY		
SIZE B	DWG. NO. D1201173	REV. v1
SCALE: NONE PROJECTION: 		SHEET 2 OF 2