

REV.	DATE	DCN #	DRAWING TREE #
v1	29 MAR 2012	E1200317-x0	-
v2	25 JUL 2012	E1200715-x0	-
v3	10-9-12	to follow	-

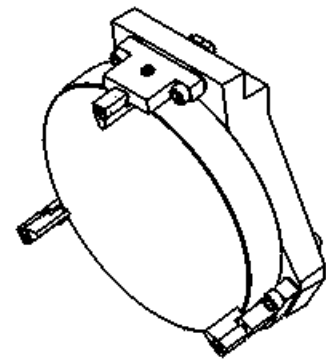

ISO VIEW

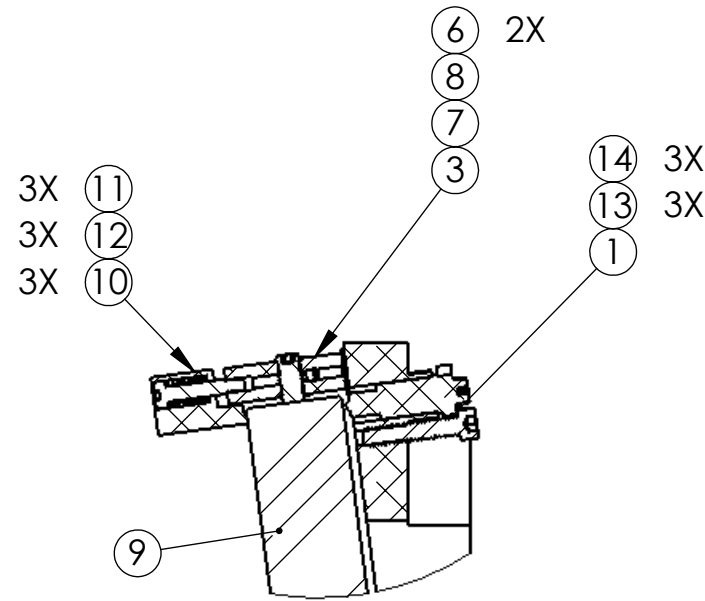

DETAIL B
SCALE 1 : 2

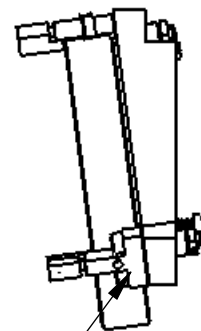
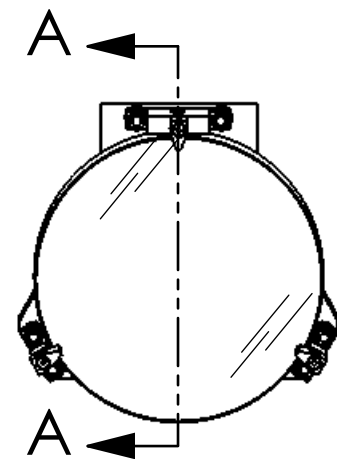

2X (4)
6X (2)
6X (6)

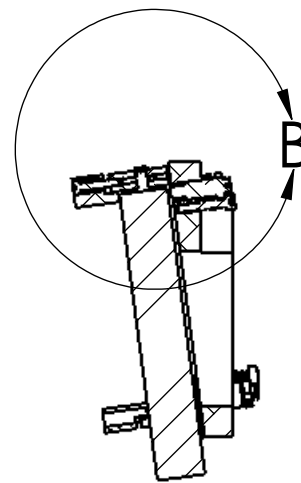

SECTION A-A

ITEM NO.	PART NUMBER	DESCRIPTION	REQ
14	MS16995-40 OR EQ.	SCREW, SHC, 10-24 X 1.0 LG.	3
13	ISC SUPPLIED	SISKIYOU 1" LEFT HAND MIRROR MT. ADJ. SCR. ASSEM	3
12	94035A999 (McM-Carr, special order) or equiv	PRECISION SKT SHLDR SCRW 5/32 O.D., 5/8 L, #6-32 X 3/16 THD	3
11	9435K420 (McM-Carr) or equiv	COMPRESSION SPRING .240 O.D., .032 W.D., .63 L, 23.32#/IN	3
10	D1001136	ALIGO ETM F1 MIRROR CLAMP	3
9	D1102335	ALIGO TMS TELESCOPE FIRST FOLD MIRROR	1
8	99934A330 (McM-Carr) or equiv	SKT SET SCRW, 6-32 X 1/8 L, SILVER TIP	1
7	94355A614 (McM-Carr) or equiv	SKT SET SCRW, FLAT PT, 1/4-28 X 1/2	1
6	-	SCREW, SOCKET HEAD CAP, 1/4-20 UNC-2A X 0.875 LONG	6
5	9529K44 (McM-Carr) or equiv	440C SS BALL 7/32" DIAMETER, GRADE 24	2
4	D1002336	ALIGO ETM F1 MIRROR SIDE CLAMP LOWER	2
3	D1002337	ALIGO ETM F1 MIRROR SIDE CLAMP UPPER	1
2	WFV-25 UC COMP.	.255 ID, .468 OD, .032 TH VENT FL WSHR	6
1	D1200245	ALIGO TMS F1 MIRROR BASE	1
ITEM NO.	PART NUMBER	DESCRIPTION	REQ

NOTES AND TOLERANCES: (UNLESS OTHERWISE SPECIFIED)

MATERIAL N/A FINISH N/A μinch

LIGO CALIFORNIA INSTITUTE OF TECHNOLOGY
MASSACHUSETTS INSTITUTE OF TECHNOLOGY
SYSTEM ADVANCED LIGO SUB-SYSTEM AOS
NEXT ASSY D1102361

PART NAME
ALIGO TMS F1 MIRROR ASSEMBLY
DESIGNER K. MAILAND 08 FEB 2012
DRAFTER E.SANCHEZ 29 MAR 2012
CHECKER SEE DCC
APPROVAL SEE DCC
SIZE DWG. NO. B D1200244
REV. v3
SCALE: 1:4 PROJECTION: SHEET 1 OF 1

D1200244 ALIGO TMS F1 Mirror Assembly, PART PDM REV: X-023, DRAWING PDM REV: X-003