

D1200243 aLIGO TMS F2 Mirror Assembly, PART PDM REV: X-012, DRAWING PDM REV: X-000

REV.	DATE	DCN #	DRAWING TREE #
v1	29 MAR 2012	E1200317-x0	-
-	-	-	-
-	-	-	-

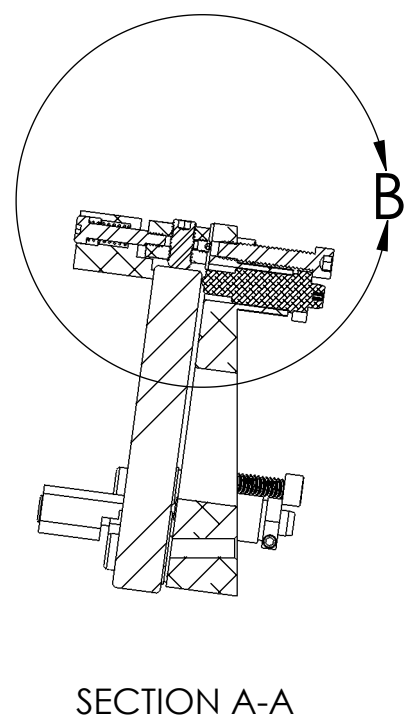
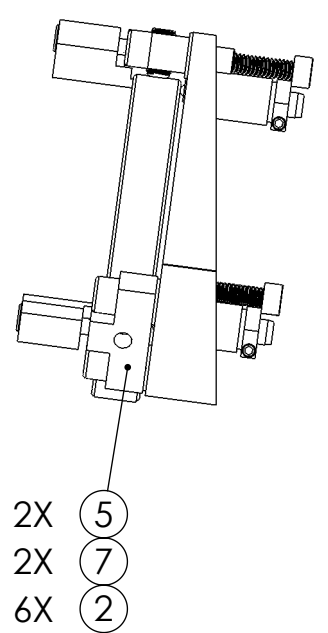
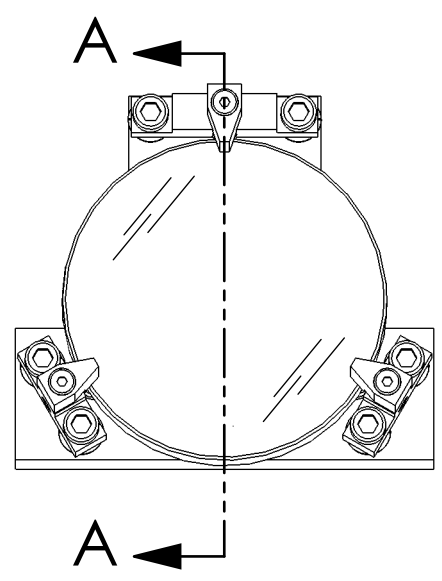
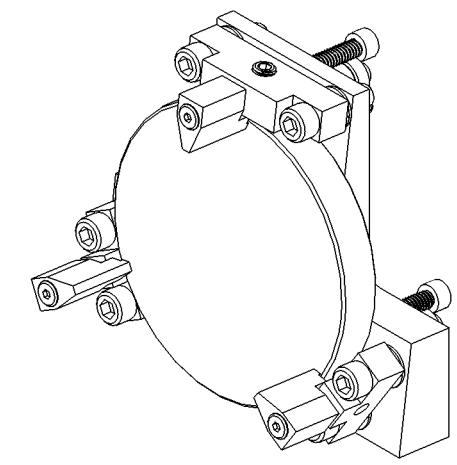
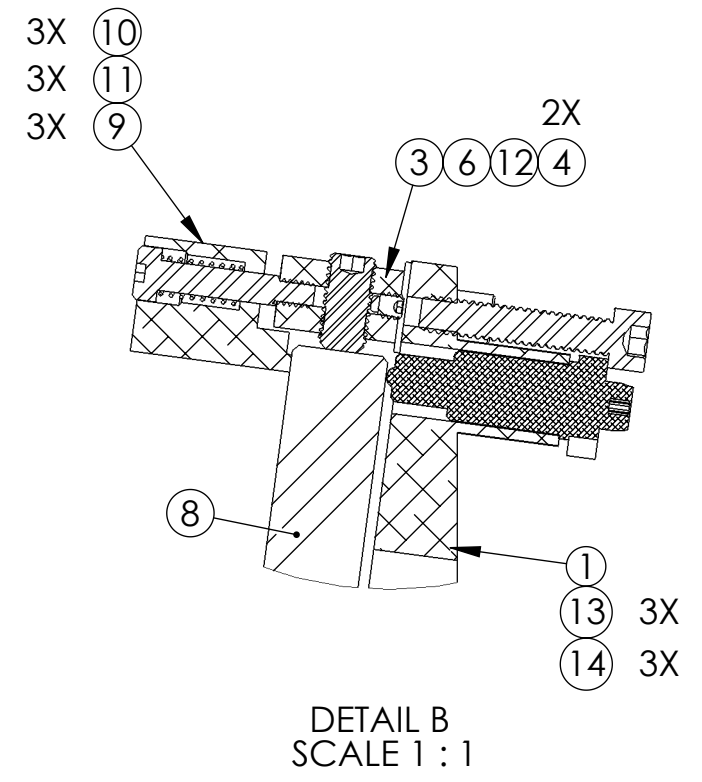

ITEM NO.	PART NUMBER	DESCRIPTION	REQ
14	MS16995-40 OR EQ.	SCREW, SHC, 10-24 X 1.0 LG.	3
13		SISKIYOU 1" LEFT HAND MIRROR MOUNT	3
12	99934A330 (McM-Carr) or equiv	SKT SET SCRW, 6-32 X 1/8 L, SILVER TIP	1
11	94035A999 (McM-Carr, special order) or equiv	PRECISION SKT SHLDR SCRW 5/32 O.D., 5/8 L, #6-32 X 3/16 THD	3
10	70466S (Century Spring) or equiv	COMPRESSION SPRING .210 O.D., .018 W.D., .63 L, 3.4#/IN	3
9	D1002465	aLIGO AOS TRANSMON F2 MIRROR CLAMP	3
8	D1102334	aLIGO TMS TELESCOPE SECOND FOLD MIRROR	1
7	9529K44 (McM-Carr) or equiv	440C SS BALL 7/32" DIAMETER, GRADE 24	2
6	94355A614 (McM-Carr) or equiv	SKT SET SCRW, FLAT PT, 1/4-28 X 1/2	1
5	D1002458	aLIGO AOS TRANSMON F2 MIRROR SIDE CLAMP LOWER	2
4	-	SCREW, SOCKET HEAD CAP, 1/4-20 UNC-2A X 0.875 LONG	6
3	D1002459	aLIGO AOS TRANSMON F2 MIRROR SIDE CLAMP UPPER	1
2	.250 VENT FL WSHR	.255 ID, .468 OD, .032 TH	6
1	D1200249	aLIGO TMS F2 MIRROR BASE	1
ITEM NO.	PART NUMBER	DESCRIPTION	REQ

PARTS LIST

NOTES AND TOLERANCES: (UNLESS OTHERWISE SPECIFIED)				CALIFORNIA INSTITUTE OF TECHNOLOGY MASSACHUSETTS INSTITUTE OF TECHNOLOGY		PART NAME	
MATERIAL		FINISH		NEXT ASSY		aLIGO TMS F2 MIRROR ASSEMBLY DESIGNER C. CONLEY 17 SEP 2010 DRAFTER E.SANCHEZ 29 MAR 2012 CHECKER SEE DCC SEE DCC APPROVAL SEE DCC SEE DCC	
N/A		N/A μinch		D1102361		SIZE DWG. NO. B D1200243 SCALE: 1:2 PROJECTION: SHEET 1 OF 1	