

8

7

6

5

4

3

2

1

NOTES CONTINUED:

5. SCRIBE, ENGRAVE (A VIBRATORY TOOL MAY BE USED), LASER MARK OR MECHANICALLY STAMP (NO INKS OR DYES) DRAWING PART NUMBER, REVISION (AND VARIANT OR "TYPE" IF APPLICABLE) ON NOTED SURFACE OF PART FOLLOWED ON THE NEXT LINE WITH A THREE DIGIT SERIAL NUMBER. SERIAL NUMBERS START AT 001 FOR THE FIRST ARTICLE AND PROCEED CONSECUTIVELY. USE MINIMUM 0.12" HIGH CHARACTERS, UNLESS THE SIZE OF THE PART DICTATES SMALLER CHARACTERS. EXAMPLE: DXXXXXX-VY, TYPE-XX, S/N XXX

- 6. APPROXIMATE WEIGHT = 0.040 LBS.
- 7. MACHINE ALL SURFACES TO REMOVE OXIDES AND MILL FINISH. USE OF ABRASIVE REMOVAL TECHNIQUES IS NOT ALLOWED. REFER TO LIGO-E0900364
- 8. ALL PARTS SHALL BE MANUFACTURED IN ACCORDANCE WITH LIGO SPECIFICATION E0900364.
- 9. ALL MATERIAL IS TO BE VIRGIN MATERIAL (i.e. NO WELD REPAIRS, PLUGS OR RECYCLED MATERIAL). NO REPAIRS SHALL BE MADE UNLESS APPROVED IN ADVANCE, AND IN WRITING, BY LIGO LABORATORY. REFER TO LIGO-E0900364.

REV.	DATE	DCN #	DRAWING TREE #
v1	8 FEB 2012	E1100822-v3	-
-	-	-	-
-	-	-	-

D

C

B

A

D

C

B

A

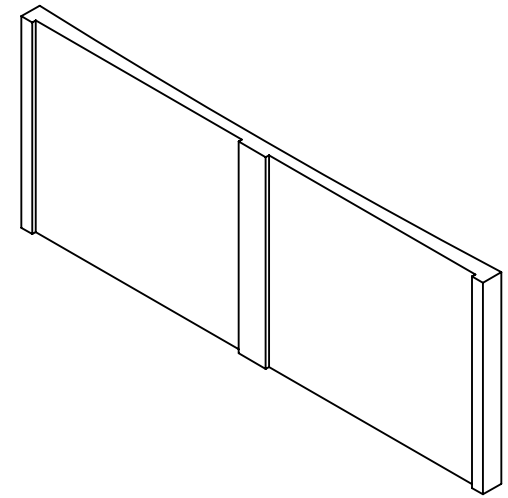
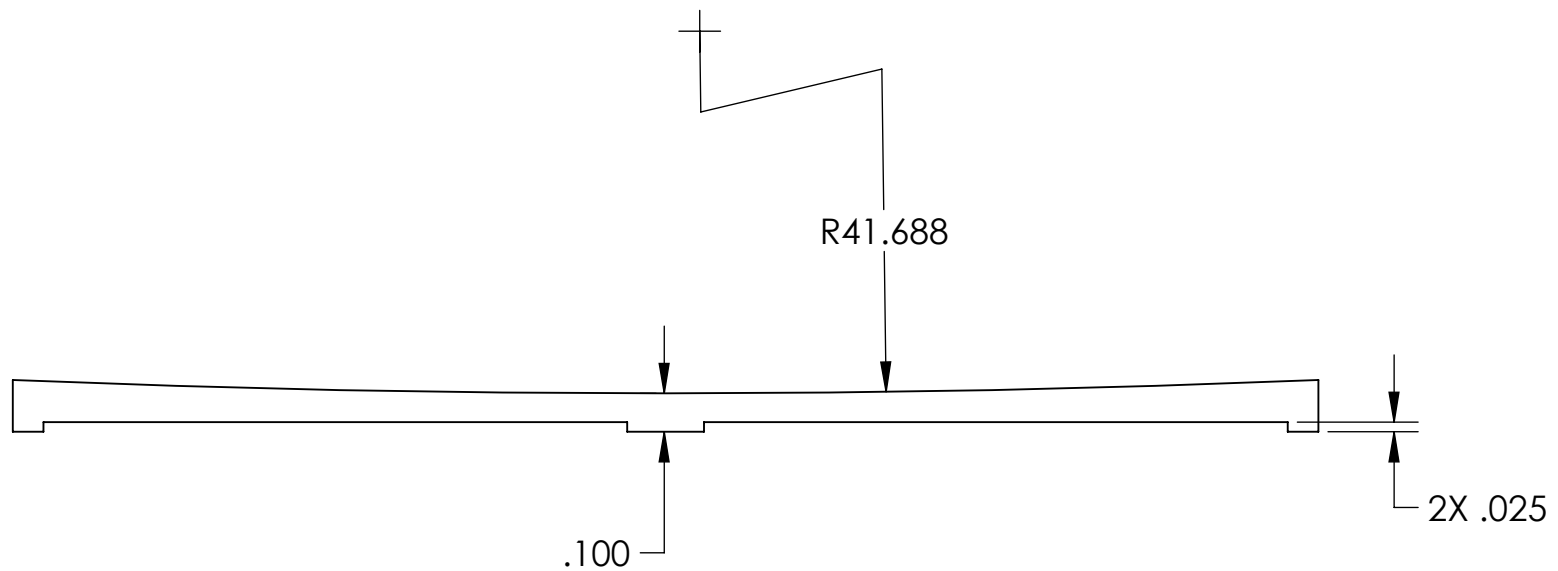

GENERAL VIEW  
FOR REFERENCE ONLY  
NO SCALE

5

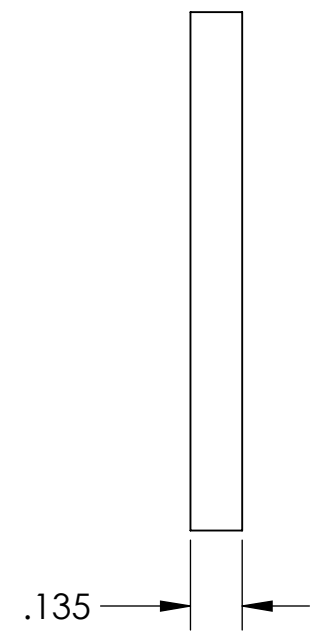
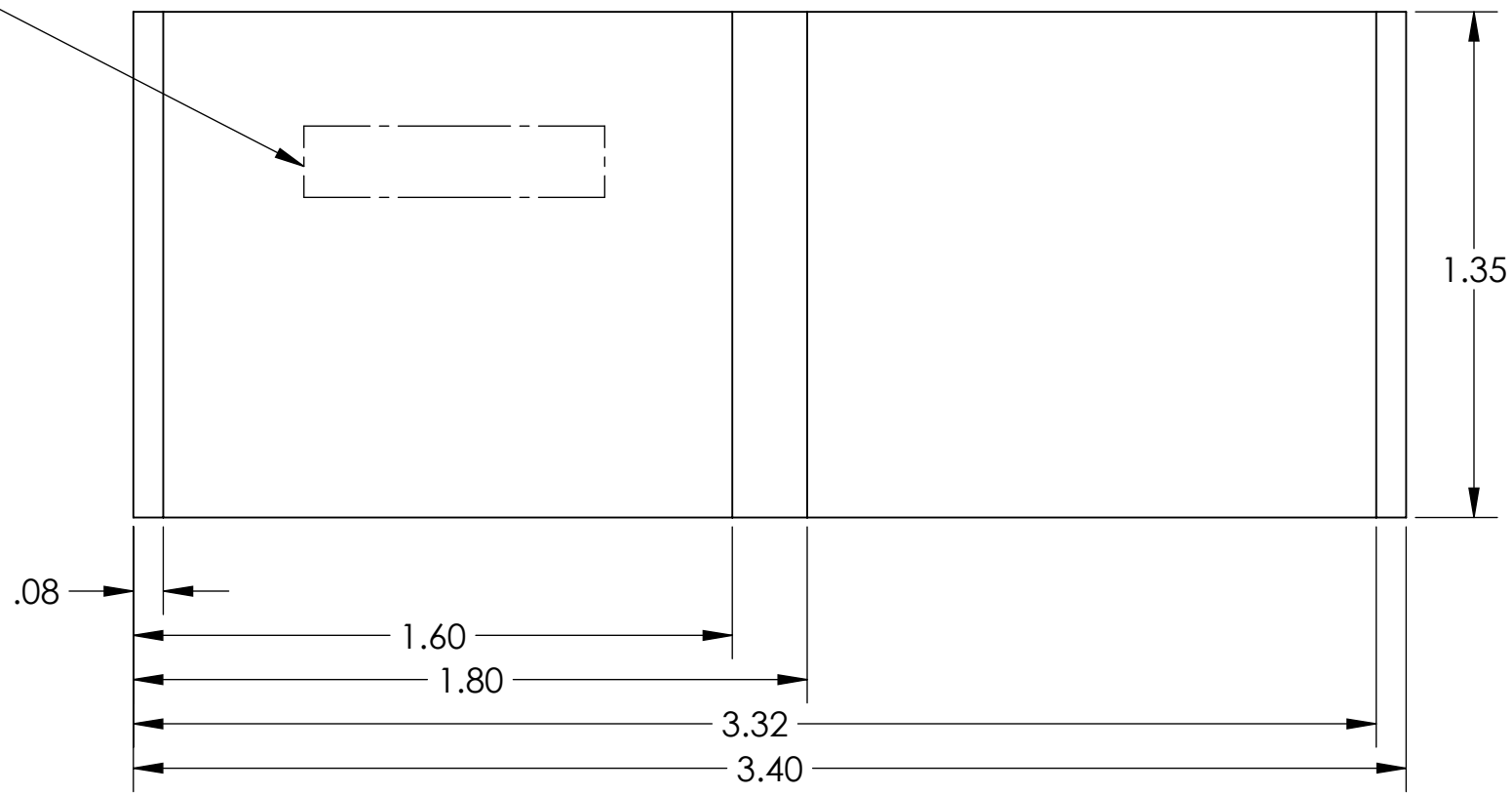

NOTES AND TOLERANCES: (UNLESS OTHERWISE SPECIFIED)				LIGO CALIFORNIA INSTITUTE OF TECHNOLOGY MASSACHUSETTS INSTITUTE OF TECHNOLOGY		PART NAME	
DIMENSIONS ARE IN INCHES				SYSTEM ADVANCED LIGO		SUB-SYSTEM AOS	
TOLERANCES: .XX ± .01 .XXX ± .005				MATERIAL 6061-T6 Al		FINISH 63 μinch	
ANGULAR ± 1.0°				NEXT ASSY D1200118		PART NAME INSERT SPACER 1/10	
				DESIGNER TQ. NGUYEN 8 FEB 2012		SIZE DWG. NO. B D1200240	
				DRAFTER TQ. NGUYEN 8 FEB 2012		REV. v1	
				CHECKER L. AUSTIN		SCALE: 2:1 PROJECTION:	
				APPROVAL M. SMITH		SHEET 1 OF 1	

8

7

6

5

4

3

2

1

D1200240\_alIGO Mode Cleaner Tube Baffle, Insert Spacer .100, PART PDM REV: X-001, DRAWING PDM REV: X-001