

NOTES CONTINUED:
 1. WEIGHT: 2.02 LB [0.92 KG].
 2. SUBSTITUTE ITEMS 4 (SET SCREW) FOR THE MANUFACTURER'S INCLUDED SET SCREWS OF ITEMS 1/2 (MIRROR MOUNTS).

REV.	DATE	DCN #	DRAWING TREE #
-	-	-	
v2	19 JUL 2013	E1300602-x0	
v3	15 JAN 2014	E1400017-x0	

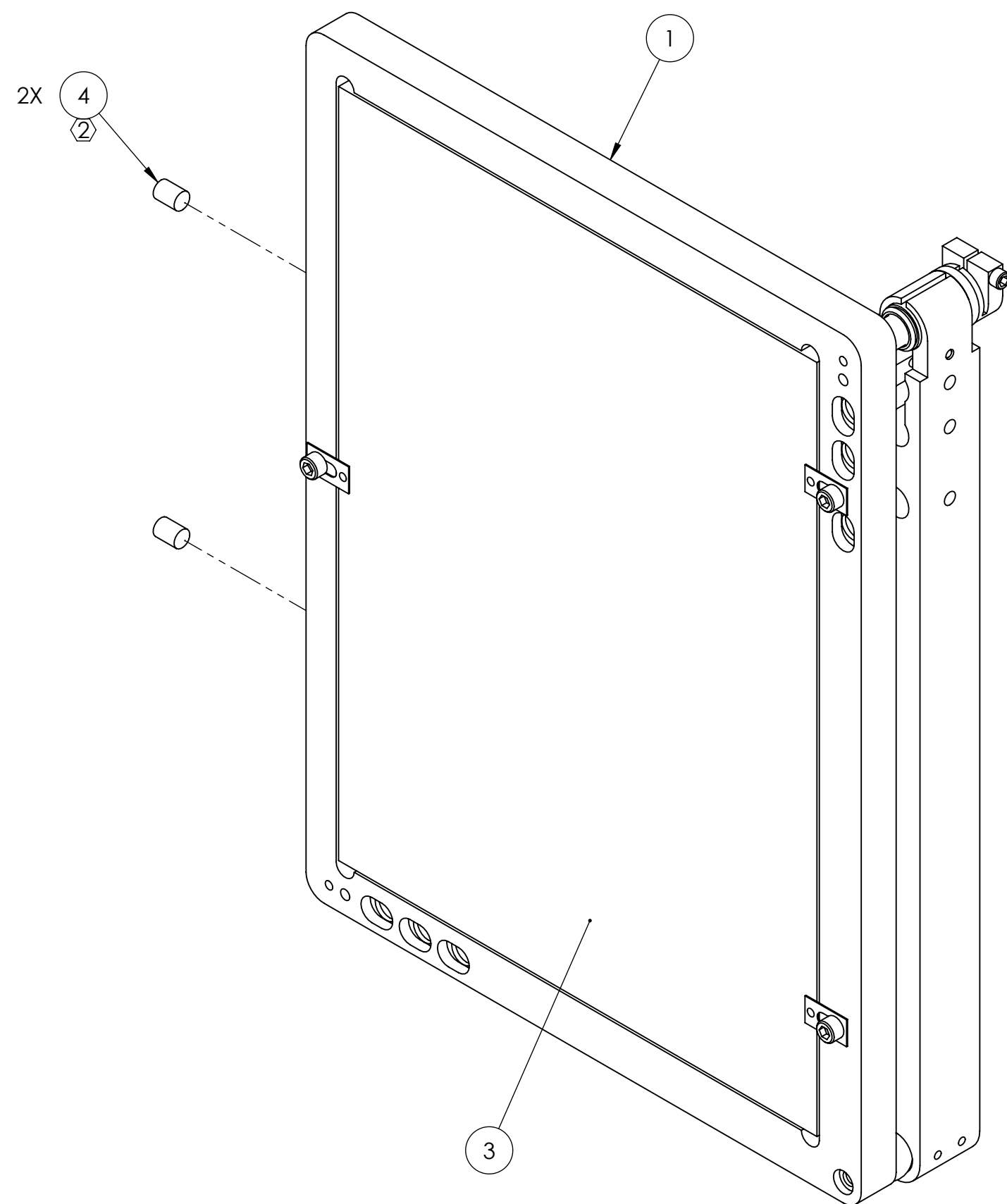

**-01
(RIGHT HANDED)**

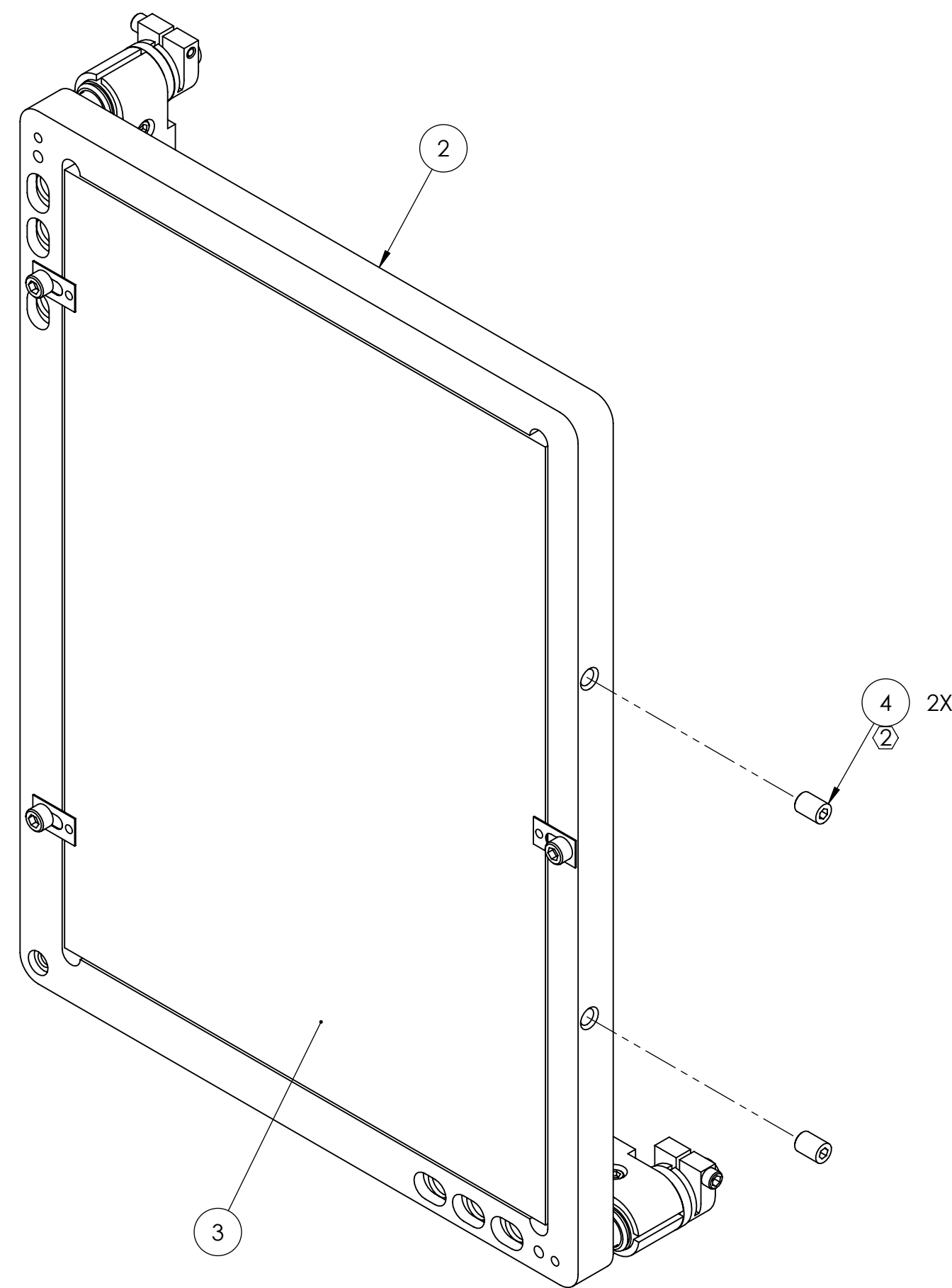

**-02
(LEFT HANDED)**

ITEM NO.	PART NO.	DESCRIPTION	REV.	MATERIAL	-01 QTY.	-02 QTY.
4	92778A113 (McM-Carr) or equiv	SCREW, SOCKET SET, OVAL POINT, #8-32 UNC X 0.25 LONG		18-8 SSSL	2	2
3	NT40-043 (Edmund Optics) (40043)	MIRROR, 1ST SURFACE, 127MM X 178MM X 6MM, 4-6 WAVE, ENHANCED ALU	-	GLASS	1	1
2	0015-0012 (Siskiyou) (IXM127X178L-VC)	TIP-TILT MIRROR MOUNT, 127MM X 178MM, LH	-	N/A	-	1
1	0005-0012 (Siskiyou) (IXM127X178R-VC)	TIP-TILT MIRROR MOUNT, 127MM X 178MM, RH	-	N/A	1	-

PARTS LIST

DIMENSIONS ARE IN INCHES		NOTES AND TOLERANCES: (UNLESS OTHERWISE SPECIFIED)	
TOLERANCES: .XX ± .XXX ±		1. INTERPRET DRAWING PER ASME Y14.5-1994. 2. REMOVE ALL SHARP EDGES, .005-.015. 3. DO NOT SCALE FROM DRAWING. 4. ALL MACHINING FLUIDS MUST BE FULLY SYNTHETIC, FULLY WATER SOLUBLE AND FREE OF SULFUR, SILICONE, AND CHLORINE.	
ANGULAR ± °	MATERIAL	FINISH	
	N/A	N/A μinch	

LIGO CALIFORNIA INSTITUTE OF TECHNOLOGY
 MASSACHUSETTS INSTITUTE OF TECHNOLOGY

PART NAME **aLIGO PCAL MIRROR MOUNT ASSEMBLY, ETM CAMERA VIEW**

SYSTEM	ADVANCED LIGO	SUB-SYSTEM	AOS	DESIGNER	C. CONLEY	12 JUL 2013	SIZE	DWG. NO.	REV.
NEXT ASSY	D1200174	CHECKER		DRAFTER	C. CONLEY	19 JUL 2013	c	D1200175	v3
		APPROVAL		SEE DCN		SEE DCN	SCALE: NONE	PROJECTION:	SHEET 1 OF 1