

DATE	REVISION
9-18-12	EXT SPRING CHANGED TO E0180-026-0620M

22	2	8-32 x 5/16 SOC. SET SCREW S.S.	SS832X516
21	6	4-40 x 7/16 SOC. SET SCREW S.S.	SS440X716
20	2	Ø5/32 STAINLESS STEEL BALL	SS-532BB
19	3	4-40 x 5/16 SOC. HD. CAP SCREW S.S.	SC440X516
18	2	Ø3/32 x 3/16 STAINLESS STEEL ROLL PIN	RP332X316S
17	1	Ø1/16 x 7/16 ROLL PIN S.S.	RP116X716S
16	2	M2.5 x 10 SOC. HD. CAP SCREW S.S.	M2.5X10SC
15	6	EXTENSION SPRING, MUSIC WIRE	E0180-026-0620M
14	6	Ø1/16 x 5/16 DOWEL PIN S.S.	DP116X516S
13	1	Ø1/32 x 3/16 DOWEL PIN S.S.	DP132X316S
12	2	EXT. RETAINING RING S.S. WALDES TRUARC	5103-37H
11	1	IM200.A2 EXTENSION SPRING	6813-07V1
10	1	IM200.A2 3/8 BALL MODIFICATION	6813-0400
9	3	6785 CLIP	6785-09V1
8	2	P100-A 2-56 CLAMP SCREW	6766-04V1
7	2	CARBIDE V-PAD	6721-05V1
6	2	RTC-0.3 WASHER	0937-02V1
5	2	0067-0007 ADJUST SCREW 1/4-100	0066-0007-2
4	2	IXM200.C2-VC CLAMPING NUT ALUM/BRONZE	0017-0010-5
3	2	IXM127X178R-VC LIGO SPACER	0005-0012-3
2	1	IXM127X178R-VC LIGO RH FRONT PLATE	0005-0012-2
1	1	IXM127X178R-VC LIGO BACK	0005-0012-1
ITEM	QTY	DESCRIPTION	ID./DWG.NO.

PARTS LIST

LIGO VACUUM COMPATIBLE ASSEMBLY
NO LUBRICATION

UNLESS OTHERWISE SPECIFIED		SISKIYOU DESIGN, INC.	
DIMENSIONS ARE IN INCHES WITH TOLERANCES OF XX ± .010 XXX ± .003 XXXX ± .0005 ANGLES ± 2° √ 32 OR BETTER		110 S.W. BOOTH STREET GRANTS PASS, OREGON 97526	
SCALE: FULL		TITLE: IXM127X178R-VC LIGO ASSEMBLY	DRAWN BY: JW/DF
			APPROVED BY:
			DATE: 4-25-2012
			REVISION: 9-18-12
		MATERIAL:	DRAWING NO: SHEET 1 OF 2
			0005-0012

LIGO VACUUM COMPATIBLE ASSEMBLY
NO LUBRICATION

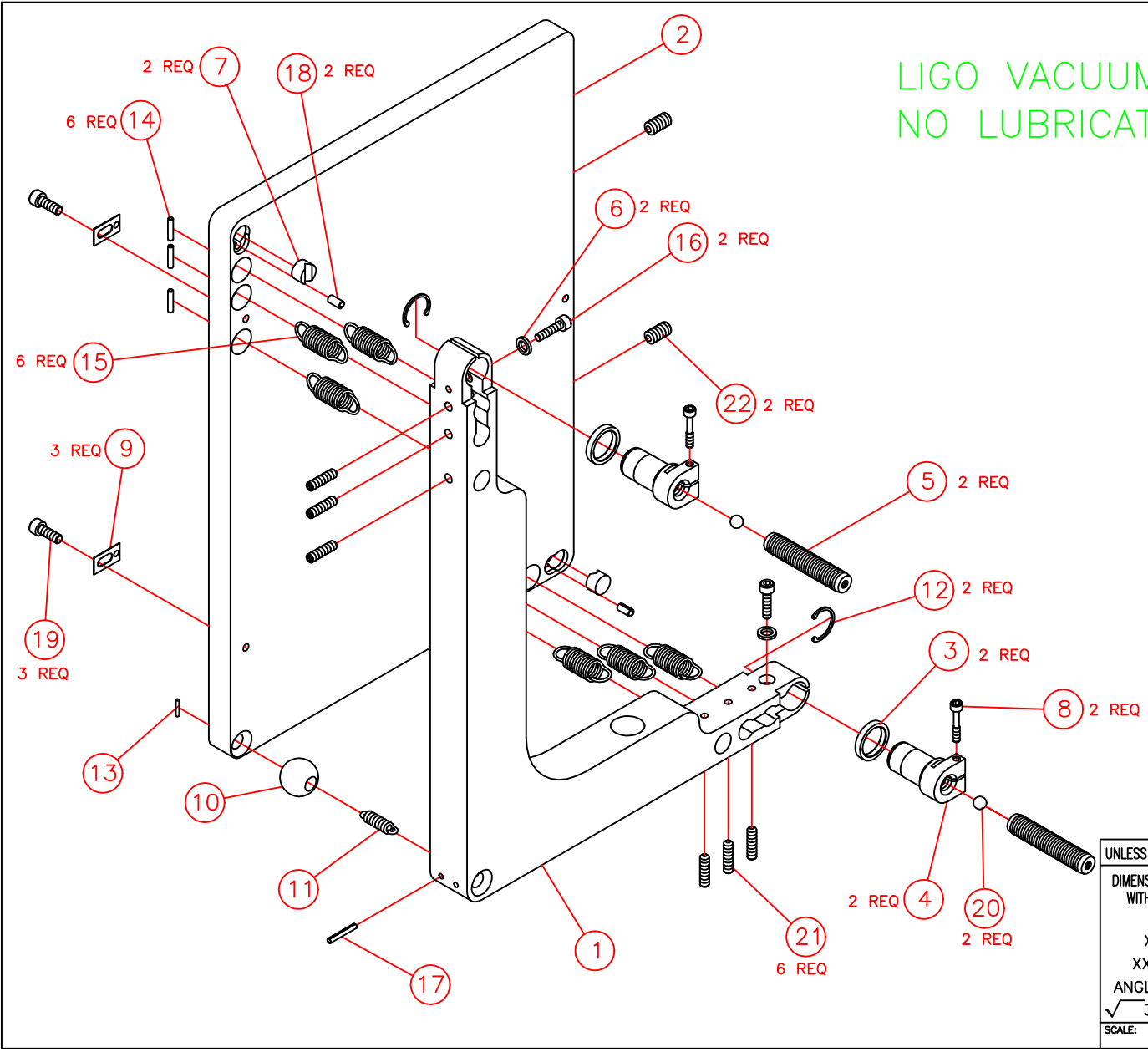

UNLESS OTHERWISE SPECIFIED DIMENSIONS ARE IN INCHES WITH TOLERANCES OF XX ± .010 XXX ± .003 XXXX ± .0005 ANGLES ± 2° $\sqrt{\text{32}}$ OR BETTER SCALE: .8X	SISKIYOU DESIGN, INC. 110 S.W. BOOTH STREET GRANTS PASS, OREGON 97526	
	TITLE: IXM127X178R-VC LIGO ASSEMBLY	DRAWN BY: D.FASZER
	APPROVED BY:	
	DATE: 4-25-2012	
MATERIAL:		REVISION:
		DRAWING NO: SHEET 2 OF 2 0005-0012