

NOTES CONTINUED:
 [5] INTERFACE TO ASSEMBLY D1102088.
 [6] #6-32 TORQUE TO 10 in-lb, MAX.
 [7] #8-32 TORQUE TO 20 in-lb, MAX.

REV.	DATE	DCN #	DRAWING TREE #
v1	08-MAR-12	E1101043-v1	E1101044-v1

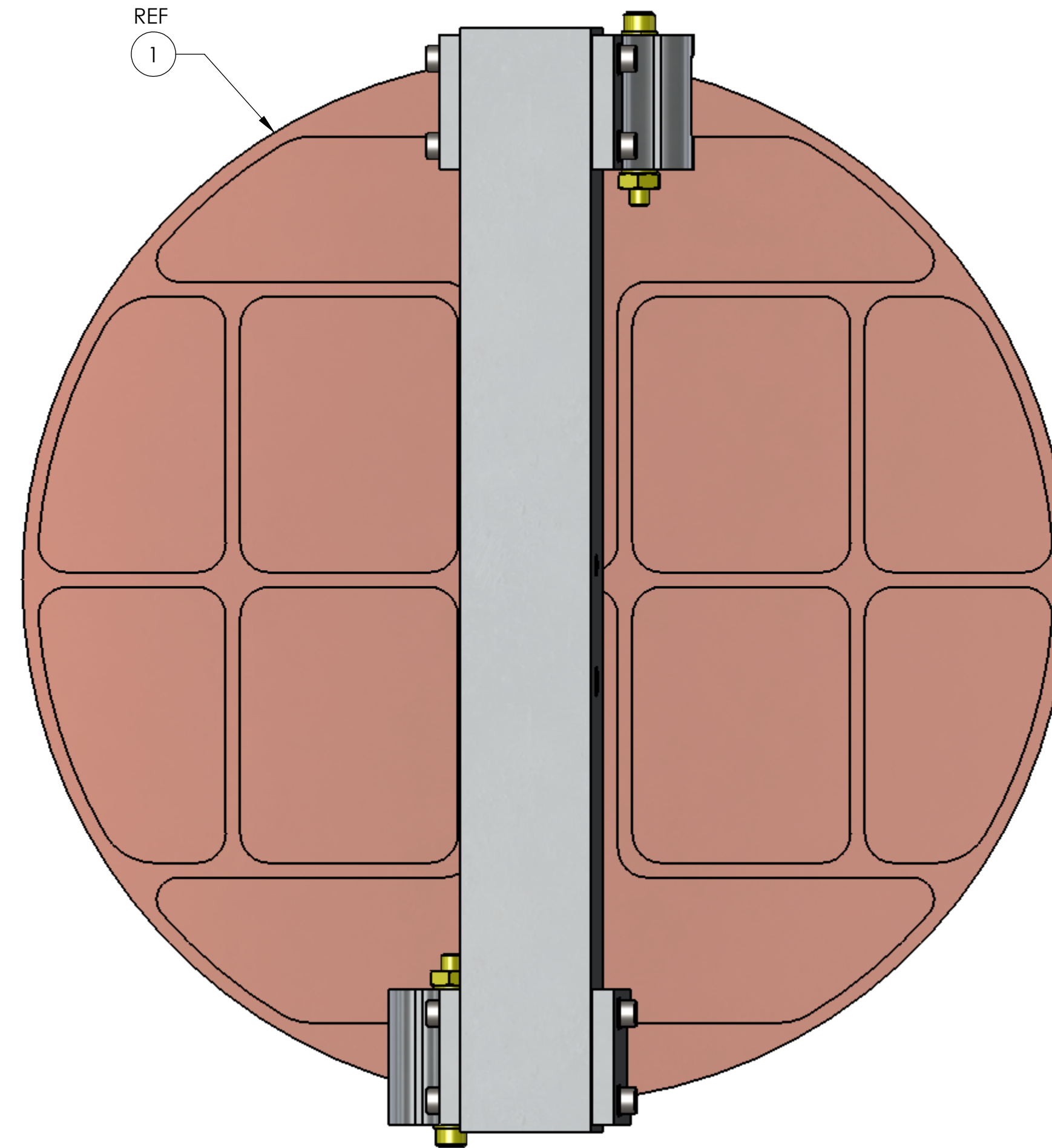
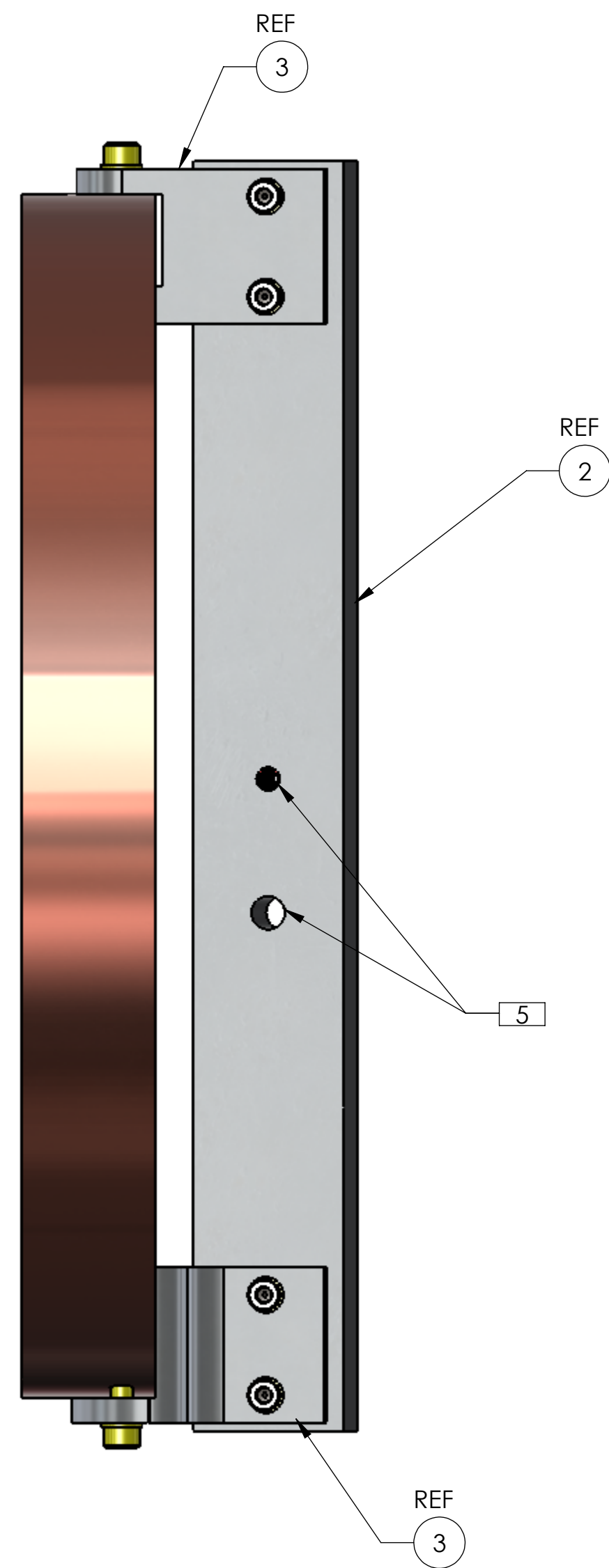
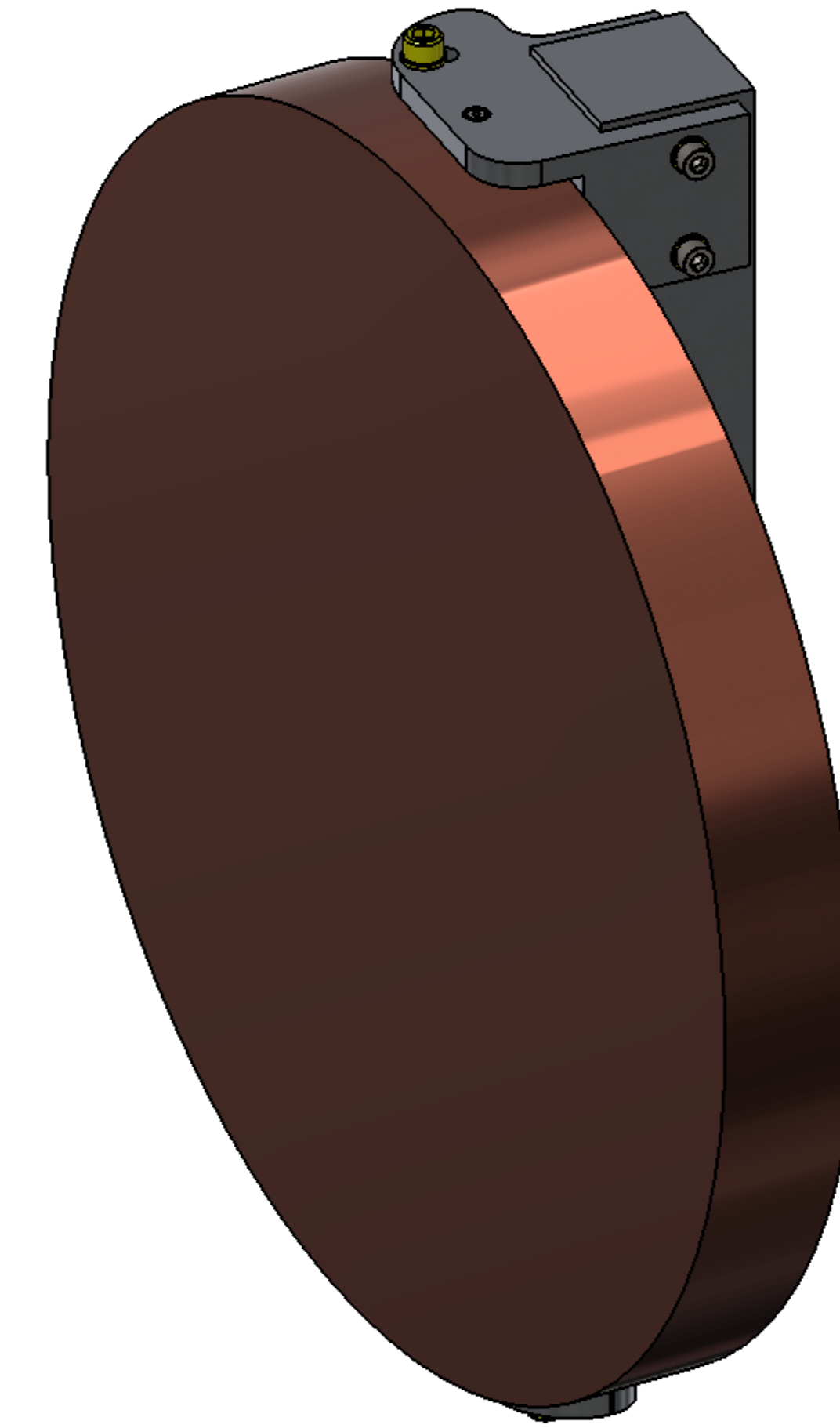
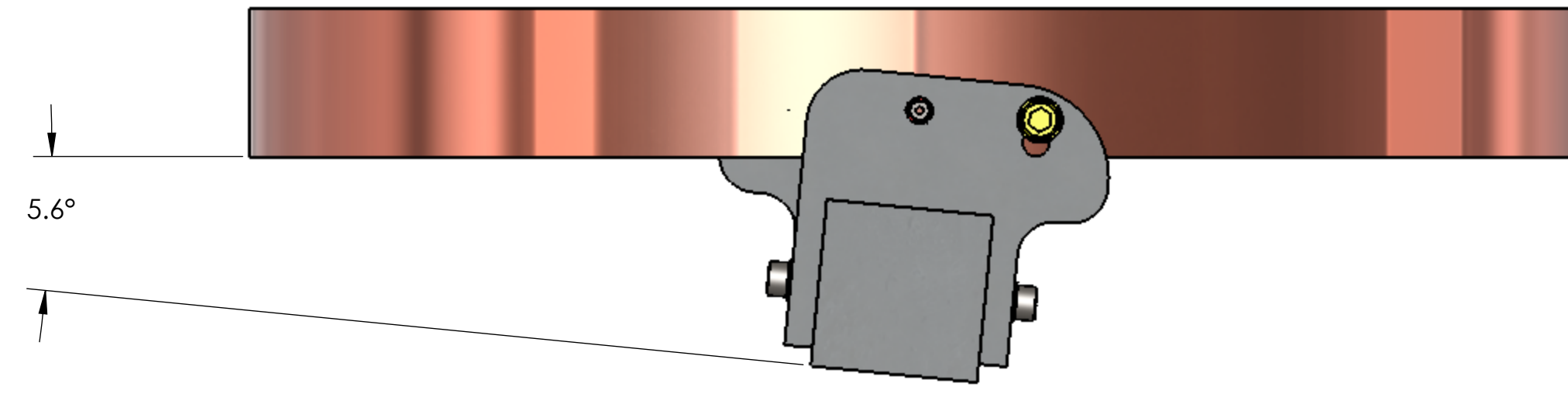

ITEM NO.	PART NUMBER	DESCRIPTION	MATERIAL	REQ	SPARE	TOTAL
10	WFV-10	WASHER, VENTED FLAT, #10, .195 ID X .35 4OD X .032 TK.UC-COMPONENTS	18-8 SS	2	1	3
9	WF-06-A	WASHER, FLAT, #6, .143ID X .267OD X .016TK. UC-COMPONENTS	300 SS, Au PLATED	8	2	10
[6]	8	C-607 SSHC, 6-32 X UNC-3A X 7/16 Lg SS. UC-COMPONENTS	Alloy Steel (SS)	8	2	10
7	WF-08	WASHER, FLAT, #8, .169ID X .304OD X .032TK. UC-COMPONENTS	300 SSSL	4	1	5
[7]	6	N-832-A HEX NUT, #8-32	300 SSSL, Au PLATED	2	2	4
[7]	5	SHCV-4423 SSHD, #8-32UNC-3A X 1 LG, VENTED. UC-COMPONENTS	303 SSSL	2	1	3
[7]	4	C-824-NA SCREW, SOCKET HEAD CAP, #8-32 UNC-2A X 1.5LG. UC-COMPONENTS	300 SSSL	2	2	4
3	D1101294	H1-L1 STEER M1 AZ BRACKET	6061 Alloy	2	0	2
2	D1101295	H1-L1 STEER M1 SUPPORT	6061 Alloy	1	0	1
1	D1101014	αLIGO TCS CO2P STEERING MIRROR 1, H1-L1	Copper	1	0	1

PARTS LIST

NOTES AND TOLERANCES: (UNLESS OTHERWISE SPECIFIED)	
1. INTERPRET DRAWING PER ASME Y14.5-1994.	
2. REMOVE ALL SHARP EDGES, .005-.015, FOR MACHINED PARTS. ROUND ALL EDGES APPROXIMATELY R.02 FOR SHEET METAL PARTS.	
3. DO NOT SCALE FROM DRAWING.	
4. ALL MACHINING FLUIDS MUST BE FULLY SYNTHETIC, FULLY WATER SOLUBLE AND FREE OF SULFUR, SILICONE, AND CHLORINE.	
DIMENSIONS ARE IN INCHES	
TOLERANCES:	
.XX ± .01	
.XXX ± .005	
ANGULAR ± 1.0°	
MATERIAL	N/A
FINISH	N/A μinch

LIGO CALIFORNIA INSTITUTE OF TECHNOLOGY MASSACHUSETTS INSTITUTE OF TECHNOLOGY		PART NAME	
ADVANCED LIGO		αLIGO TCS MIRROR ASSY	
DESIGNER	M.JACOBSON	18-OCT-2011	SIZE DWG. NO.
DRAFTER	A.COLE	19-OCT-2011	D D1102029
CHECKER	J.LEWIS	08-MAR-2012	REV. v1
APPROVAL	A.BROOKS	25-OCT-2011	SCALE: 1:8
NEXT ASSY		PROJECTION:	
D1101013		SHEET 1 OF 2	

D1102029 αLIGO TCS MIRROR ASSY PART PDM REV: X-026 DRAWING PDM REV: X-012

