

D1101860_ALS_End_Lower_Periscope_Assembly, PART PDM REV: X-000, DRAWING PDM REV: X-001

NOTES CONTINUED:

REV.	DATE	DCN #	DRAWING TREE #
-	-	-	-
-	-	-	-
-	-	-	-

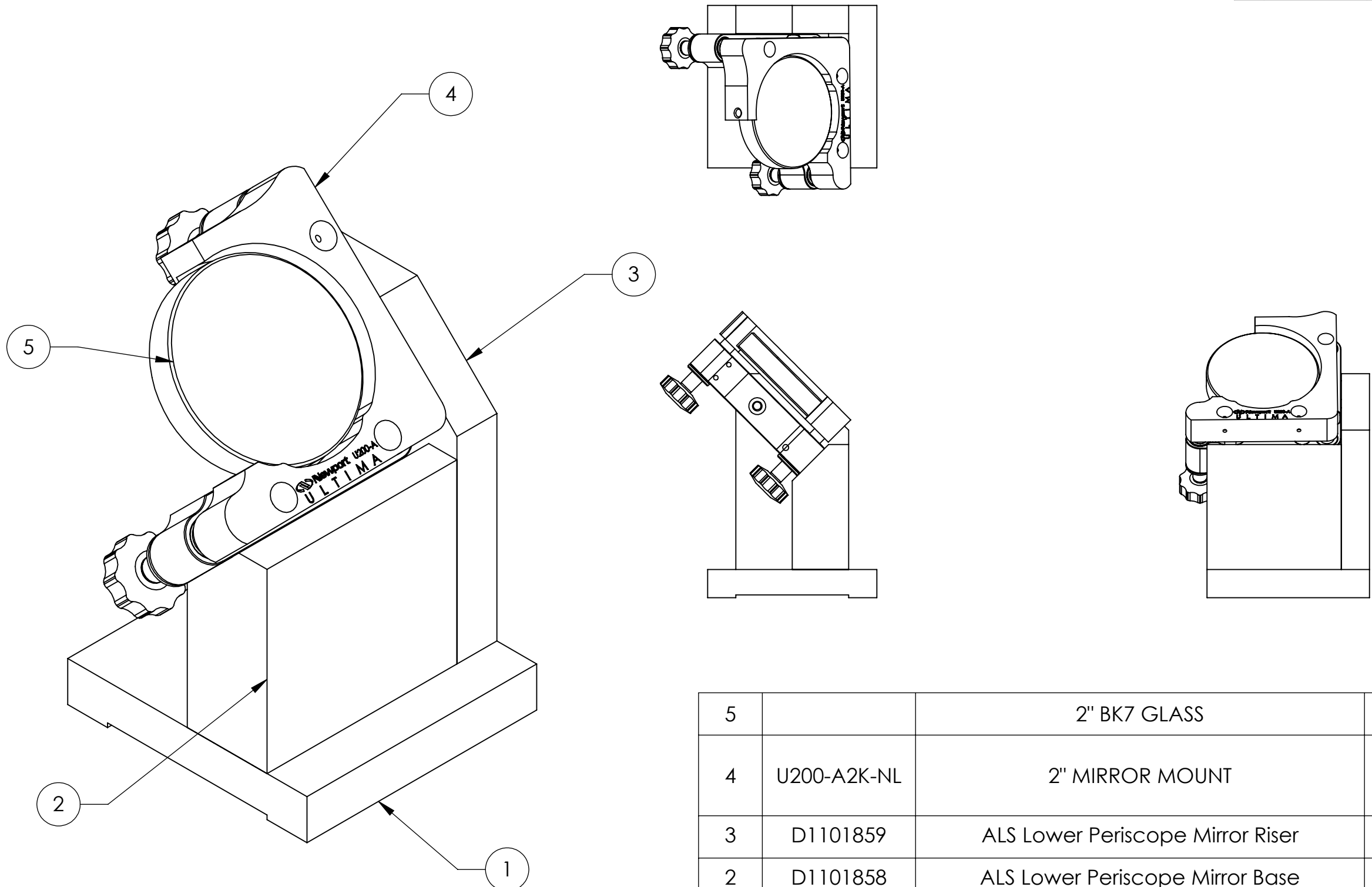

ITEM NO.	PART NUMBER	DESCRIPTION	MATERIAL	RE Q	SPA RE	TOT AL
5		2" BK7 GLASS	BK7 GLASS	1		1
4	U200-A2K-NL	2" MIRROR MOUNT		1		1
3	D1101859	ALS Lower Periscope Mirror Riser	6061-T6 Al	1		1
2	D1101858	ALS Lower Periscope Mirror Base	6061-T6 Al	1		1
1	D1101857	ALS Lower Periscope Baseplate	6061-T6 Al	1		1

PARTS LIST

NOTES AND TOLERANCES: (UNLESS OTHERWISE SPECIFIED)

CALIFORNIA INSTITUTE OF TECHNOLOGY MASSACHUSETTS INSTITUTE OF TECHNOLOGY		PART NAME ALS Y-End Lower Periscope Mirror Assembly	
SYSTEM ADVANCED LIGO	SUB-SYSTEM ISC	DESIGNER BJJ Slagmolen 26 SEP 2011	SIZE DWG. NO. B D1101860
DRAFTER BJJ Slagmolen 26 SEP 2011	CHECKER SBARNUM 1 JUL 2012	APPROVAL PFRITSCH 1 JUL 2012	REV. v2
NEXT ASSY ALS Optics Table		SCALE: 1:2	PROJECTION: SHEET 1 OF 1