

8 7 6 5 4 3 2 1

- NOTES CONTINUED:**
- 1. DO NOT SCALE FROM DRAWING.
 - ② REMOVE 0.005" OF MATERIAL FROM SIDE OF PHOTO DIODE
 - ③ PUNCTURE HOLE IN MIDDLE OF SHAVED FLAT.
 - ④ SCRIBE, ENGRAVE OR LASERMARK (NO DYES OR INKS) A UNIQUE SERIAL NUMBER.

REV.	DATE	DCN #	DRAWING TREE #
v1	26 AUG 2011	E1100335	-
-	-	-	-
-	-	-	-

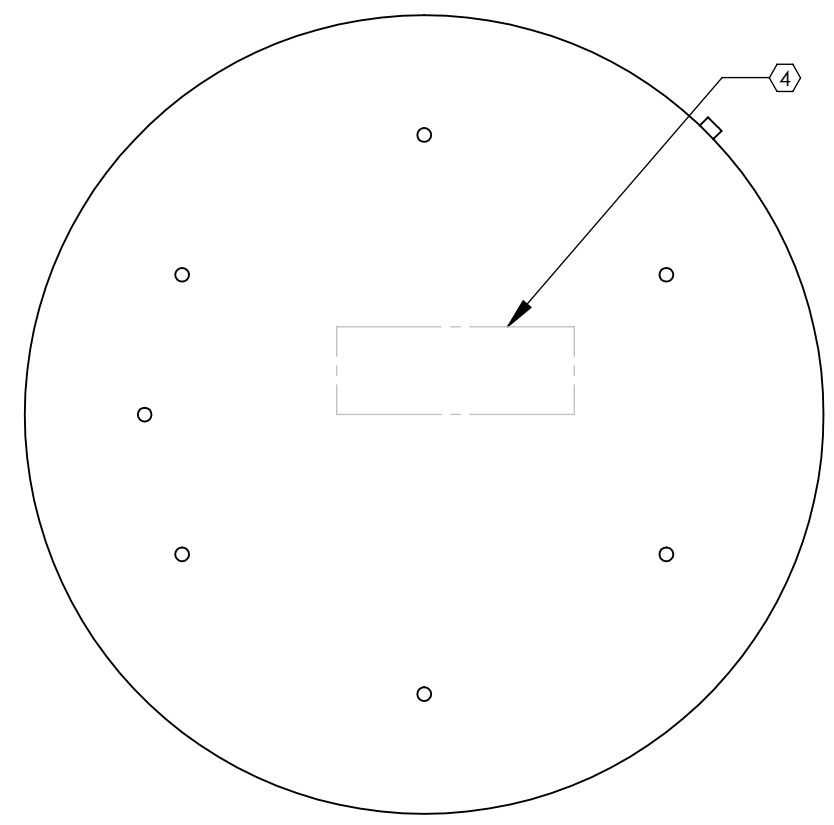
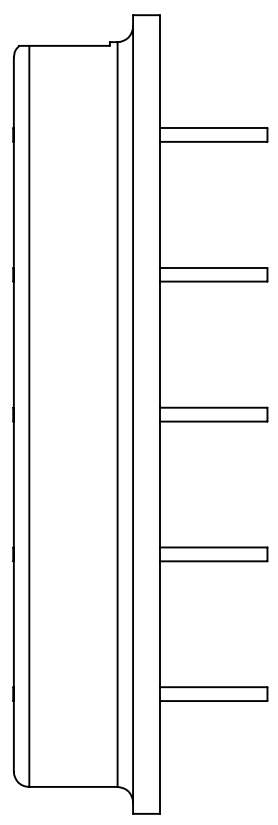
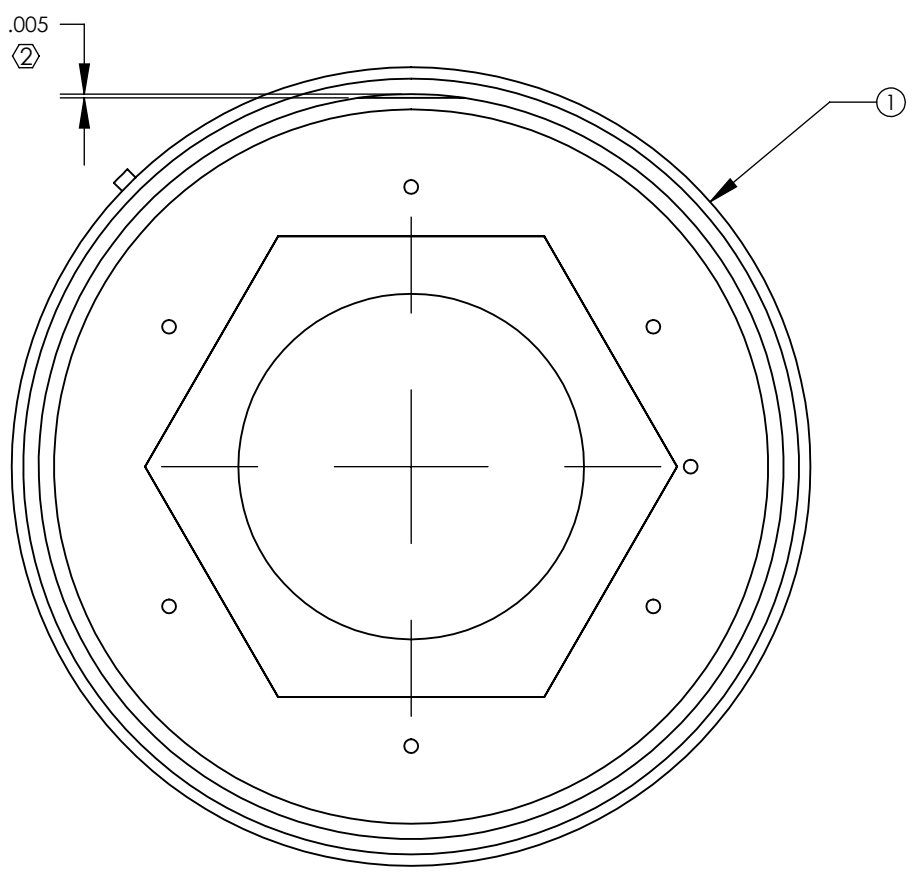
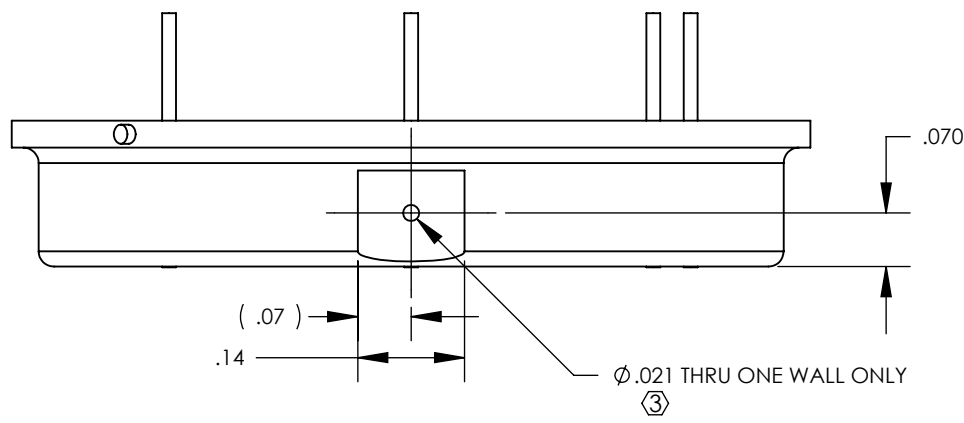

ITEM NO.	PART NUMBER	DESCRIPTION	MATERIAL	REQ	SPARE	TOTAL
1	YAG-444-AH	PIN PHOTODIODE_PERKIN ELMER	VARIOUS	1		1

PARTS LIST

DIMENSIONS ARE IN TOLERANCES: .XX ± .01 .XXX ± .001 ANGULAR ± .5°		NOTES AND TOLERANCES: (UNLESS OTHERWISE SPECIFIED)		LIGO CALIFORNIA INSTITUTE OF TECHNOLOGY MASSACHUSETTS INSTITUTE OF TECHNOLOGY		PART NAME PHOTODIODE, ACB	
MATERIAL	VARIOUS	FINISH	N/A μinch	SYSTEM	ADVANCED LIGO	SUB-SYSTEM	AOS
				DESIGNER		SIZE	DWG. NO.
				DRAFTER	MRUIZ	26 AUG 2011	B
				CHECKER			D1101713
				APPROVAL			REV. v1
				SCALE: 4:1		PROJECTION:	SHEET 1 OF 1

D1101713, PHOTODIODE, ACB, PART PDM REV: X-001, DRAWING PDM REV: X-004

8 7 6 5 4 3 2 1