

NOTES CONTINUED:

- 5. SCRIBE, ENGRAVE (A VIBRATORY TOOL MAY BE USED), LASER MARK OR MECHANICALLY STAMP (NO INKS OR DYES) DRAWING PART NUMBER, REVISION (AND VARIANT OR "TYPE" IF APPLICABLE) ON NOTED SURFACE OF PART FOLLOWED ON THE NEXT LINE WITH A THREE DIGIT SERIAL NUMBER. SERIAL NUMBERS START AT 001 FOR THE FIRST ARTICLE AND PROCEED CONSECUTIVELY. USE MINIMUM 0.12" HIGH CHARACTERS, UNLESS THE SIZE OF THE PART DICTATES SMALLER CHARACTERS. EXAMPLE: DXXXXXX-VY, TYPE-XX, S/N XXX
- 6. MACHINE ALL SURFACES TO REMOVE OXIDES AND MILL FINISH. USE OF ABRASIVE REMOVAL TECHNIQUES IS NOT ALLOWED. REFER TO LIGO-E0900364
- 7. ALL PARTS SHALL BE MANUFACTURED IN ACCORDANCE WITH LIGO SPECIFICATION E0900364.
- 8. ALL MATERIAL IS TO BE VIRGIN MATERIAL (i.e. NO WELD REPAIRS, PLUGS OR RECYCLED MATERIAL). NO REPAIRS SHALL BE MADE UNLESS APPROVED IN ADVANCE, AND IN WRITING, BY LIGO LABORATORY. REFER TO LIGO-E0900364.
- 9. ENGRAVE OR MECHANICALLY STAMP TEXT (NO INK OR DYES) APPROXIMATELY WHERE SHOWN AND LETTERING APPROX .02" DEPTH.

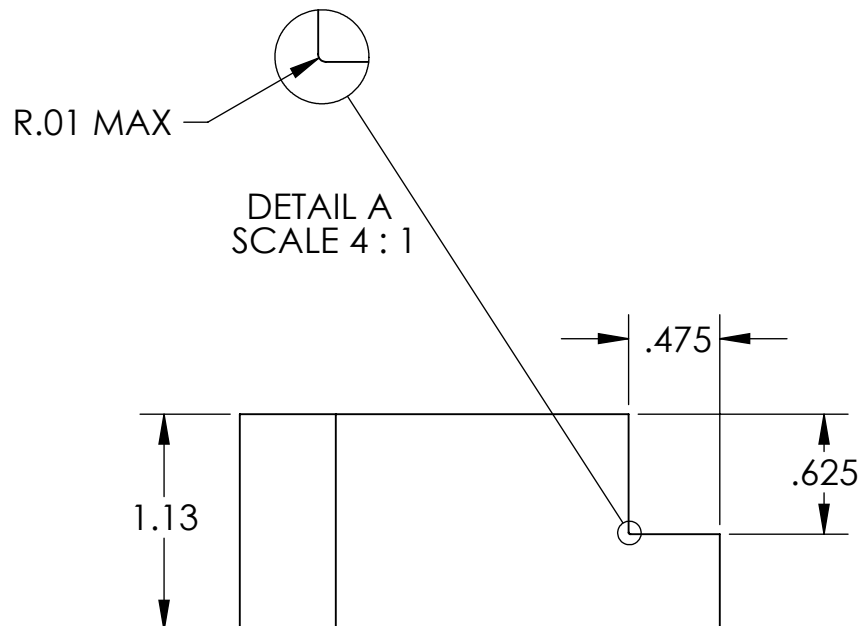

REV.	DATE	DCN #	DRAWING TREE #
v1	17 AUG 2011	E1100335	-
-	-	-	-
-	-	-	-

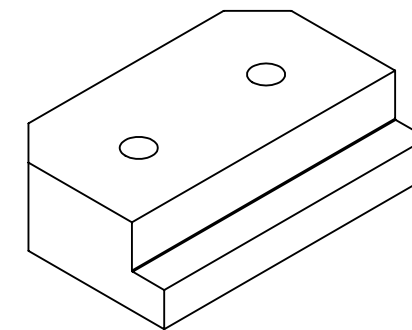

GENERAL VIEW FOR REFERENCE ONLY NO SCALE

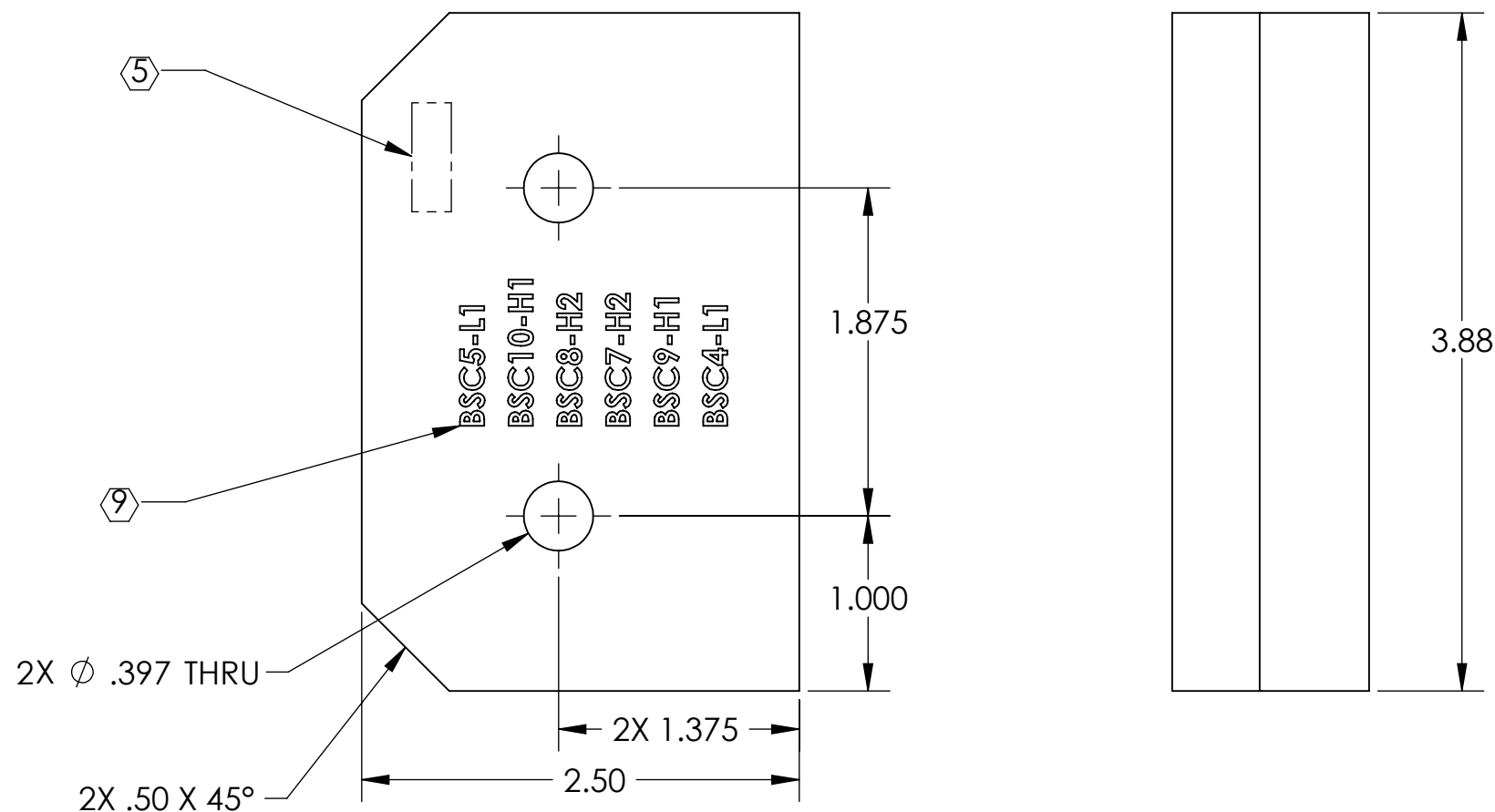

NOTES AND TOLERANCES: (UNLESS OTHERWISE SPECIFIED)				LIGO CALIFORNIA INSTITUTE OF TECHNOLOGY MASSACHUSETTS INSTITUTE OF TECHNOLOGY		PART NAME	
DIMENSIONS ARE IN INCHES				1. INTERPRET DRAWING PER ASME Y14.5-1994.		ACB_STAGE ZERO NARROW-DOG CLAMP, END	
TOLERANCES: .XX ± .01 .XXX ± .005				2. REMOVE ALL SHARP EDGES, .005-.015, FOR MACHINED PARTS. ROUND ALL EDGES APPROXIMATELY R.02 FOR SHEET METAL PARTS.		DESIGNER TQ. NGUYEN 12 AUG 2011	
ANGULAR ± 1.0°				3. DO NOT SCALE FROM DRAWING.		DRFTER TQ. NGUYEN 17 AUG 2011	
MATERIAL 6061-T6 Al				4. ALL MACHINING FLUIDS MUST BE FULLY SYNTHETIC, FULLY WATER SOLUBLE AND FREE OF SULFUR, SILICONE, AND CHLORINE.		SIZE DWG. NO. B D1101613	
FINISH 63 μinch				SYSTEM ADVANCED LIGO		REV. v1	
				SUB-SYSTEM AOS		CHECKER L. AUSTIN	
				NEXT ASSY		APPROVAL C. TORRIE	
						SCALE: 1:1 PROJECTION: SHEET 1 OF 1	