

# D1101253: TCS Ring Heater Replacement Fixture Assembly

## Preparation Sequence for Replacing a Ring Heater Segment

- 1) Install Assembly D1101253 using #8-32 in 6 plcs
- 2) Disconnect Connectors
- 3) Remove Cross Braces
- 4) Remove Lower Earthquake Stops

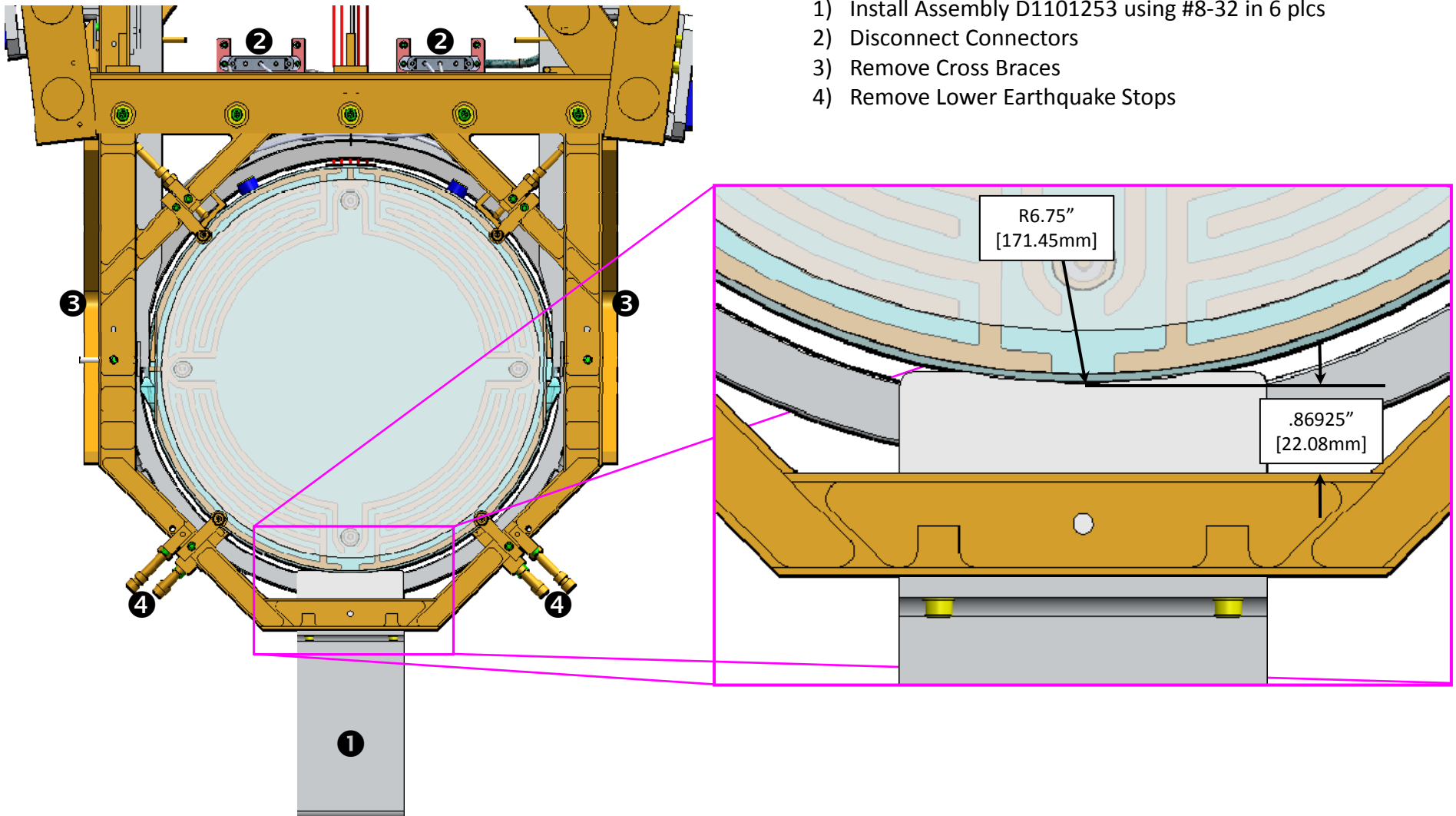

# D1101253: TCS Ring Heater Replacement Fixture Assembly

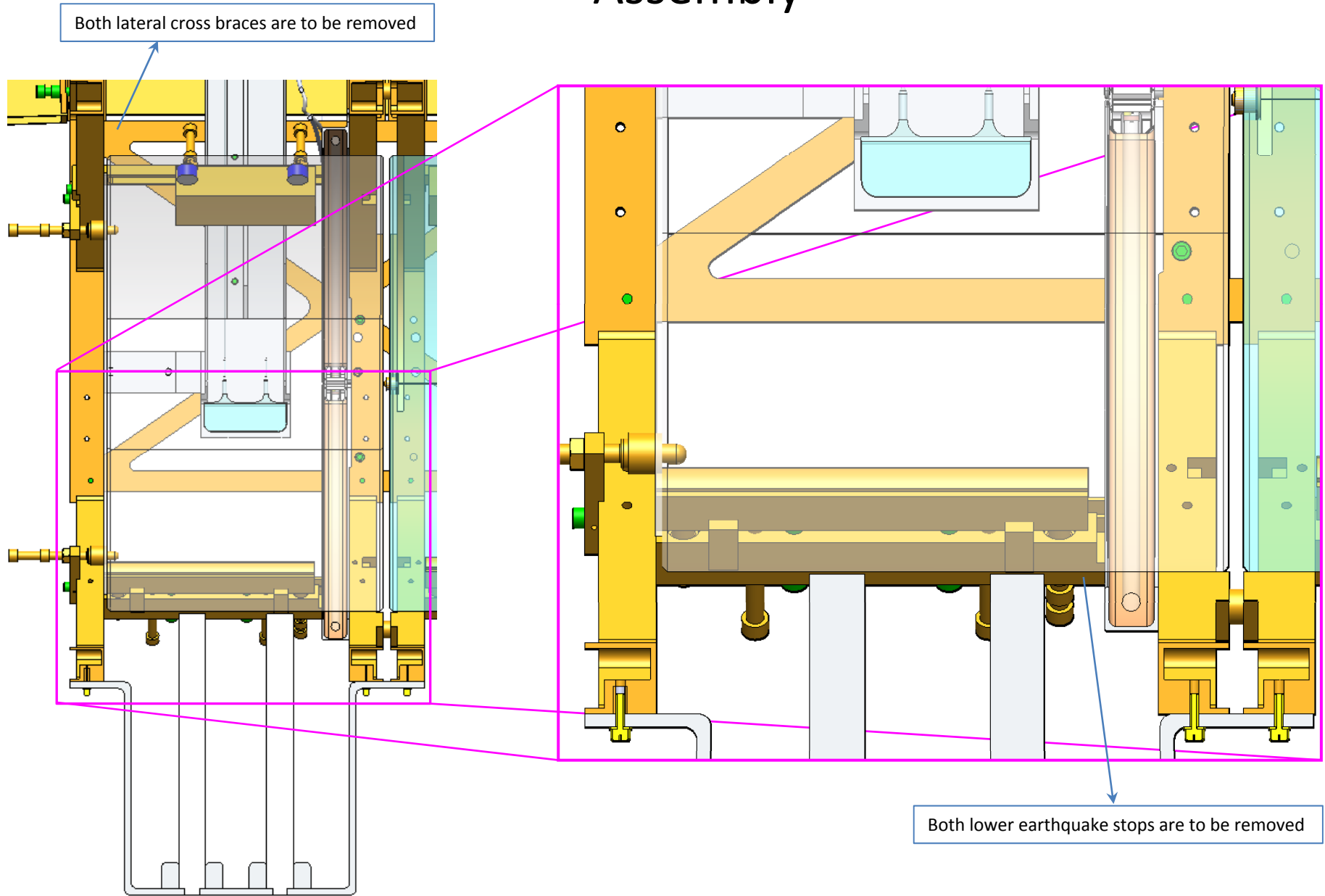

# D1101253: TCS Ring Heater Replacement Fixture Assembly

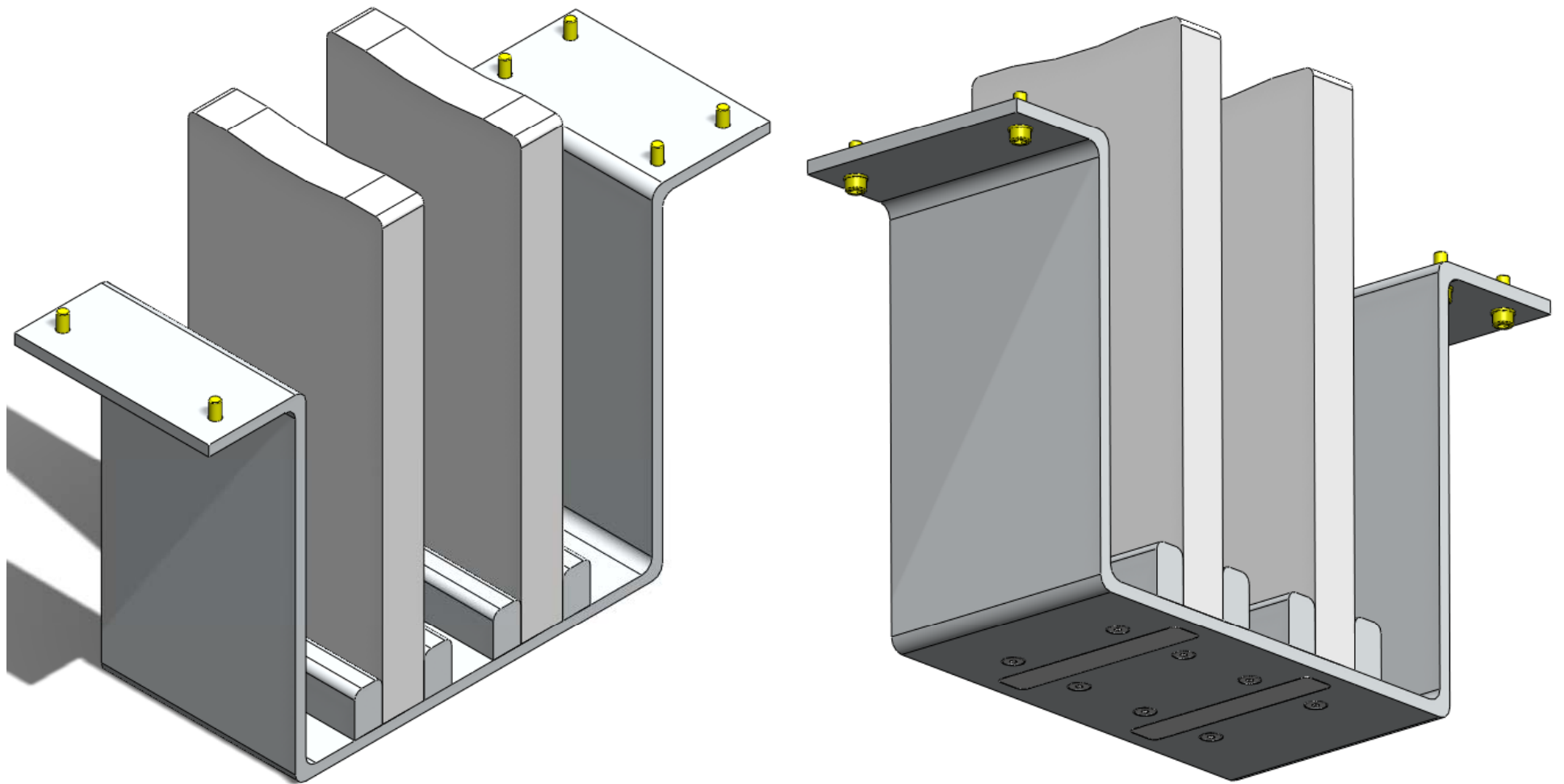

# D1101253: TCS Ring Heater Replacement Fixture Assembly

Teflon Crutches, Al 6061 supporting parts, and 18-8 stainless steel UC Components hardware

