

D1101171_dLIGO_VE_VIEWPORT_GUARD_ASSY., MULTI-PIECE, PART PDM REV: X-003, DRAWING PDM REV: X-001

| REV. | DATE | DCN # | DRAWING TREE # |
|------|-------------|-------------|----------------|
| v1 | 20 JUN 2011 | E1100531-x0 | - |
| - | - | - | - |
| - | - | - | - |

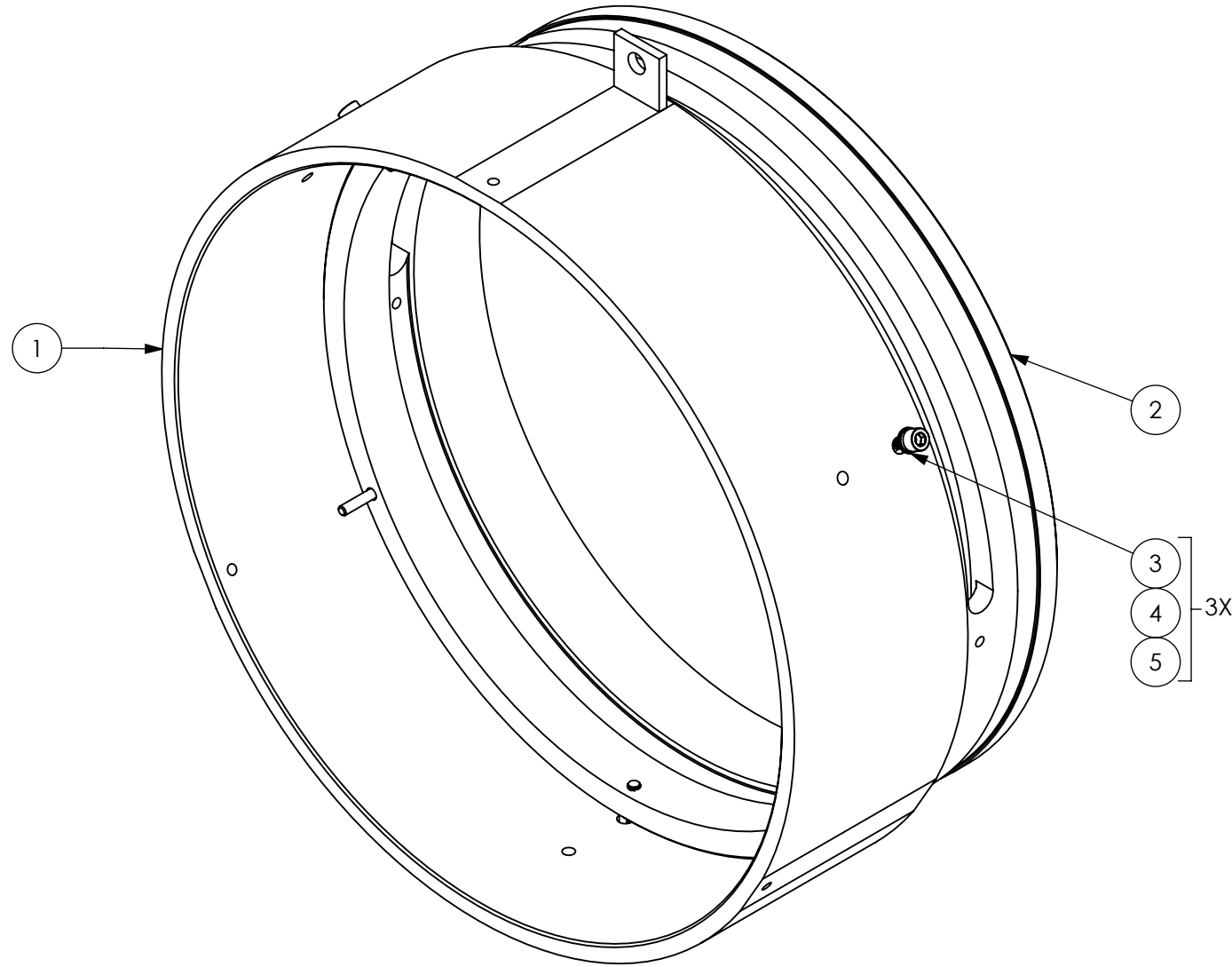

| ITEM NO. | PART NUMBER | DESCRIPTION | MATERIAL | REQ |
|----------|-------------|---|----------|-----|
| 5 | MS16995-28 | SCREW, SHC, 8-32 X .75 LG. | 300 SSSL | 3 |
| 4 | MS35338-137 | WASHER, SPLIT LOCK, NO. 8 | 300 SSSL | 3 |
| 3 | NAS620-C8 | WASHER, FLAT, #8 (NAS 620-C8 OR EQUIVALENT) | 300 SSSL | 3 |
| 2 | D1101170 | VIEWPORT GUARD ASSY., EXTENSION | N/A | 1 |
| 1 | D1101169 | ALIGO, VE, VIEWPORT GUARD ASSY., FLANGE MT. COUPLER | N/A | 1 |

NOTES AND TOLERANCES: (UNLESS OTHERWISE SPECIFIED)

DIMENSIONS ARE IN INCHES

TOLERANCES:
 .XX ± .01
 .XXX ± .005
 ANGULAR ± 0.5°

MATERIAL: N/A
 FINISH: N/A μinch

| | | | |
|---|-----------------------------|--|------------------------------------|
| CALIFORNIA INSTITUTE OF TECHNOLOGY MASSACHUSETTS INSTITUTE OF TECHNOLOGY | | PART NAME ALIGO, VE, VIEWPORT GUARD ASSY., MULTI-PIECE | |
| SYSTEM ADVANCED LIGO | SUB-SYSTEM VE | DESIGNER E.SANCHEZ | DATE 20 JUN 2011 |
| DRAFTER E.SANCHEZ | CHECKER E.SANCHEZ | DATE 20 JUN 2011 | SIZE DWG. NO. B D1101171 |
| APPROVAL | SCALE: 1:4 | PROJECTION: | REV. v1 |

NEXT ASSY D080367 **SHEET 1 OF 1**