

NOTES CONTINUED:

- 5. BAG INDIVIDUALLY AND TAG WITH DRAWING NUMBER, REVISION, QUANTITY (1), AND SERIAL NUMBER. SERIAL NUMBERS START AT 001 AND PROCEED CONSECUTIVELY. EXAMPLE (TAG): DXXXXXX-VY, QTY: 1, S/N 001.
- 6. APPROXIMATE WEIGHT = .40 LB [.18 KG].
- ⑦ NOTED DIMENSION APPLIES AT 146.0 LB [651.6 N] TENSILE LOAD ON WIRE ITEM ③.
- ⑧ APPLY 15.0 LB-FT [20.3 N-M] TORQUE TO EACH SCREW WHEN ASSEMBLING ITEM ① OR ITEM ② TO WIRE ITEM ③.

REV	DATE	DCN #	BOM #
v1	23 NOV 2011	E1100351	E1100629-v1
-	-	-	-
-	-	-	-

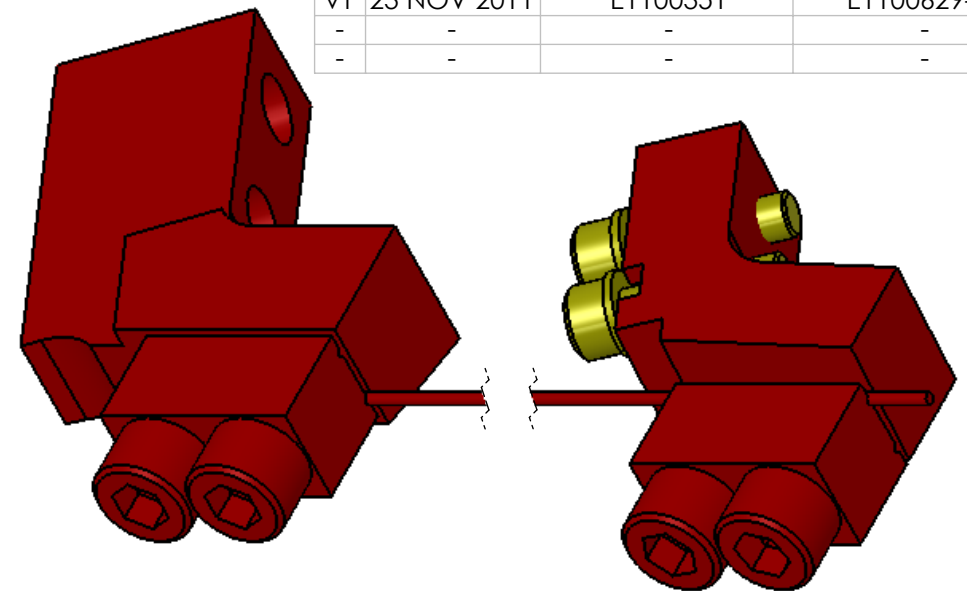
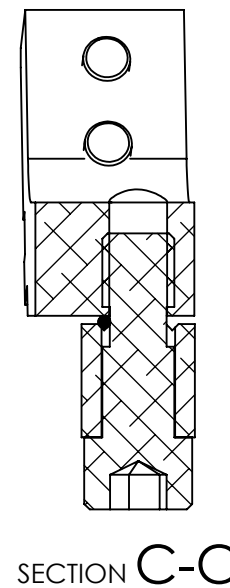
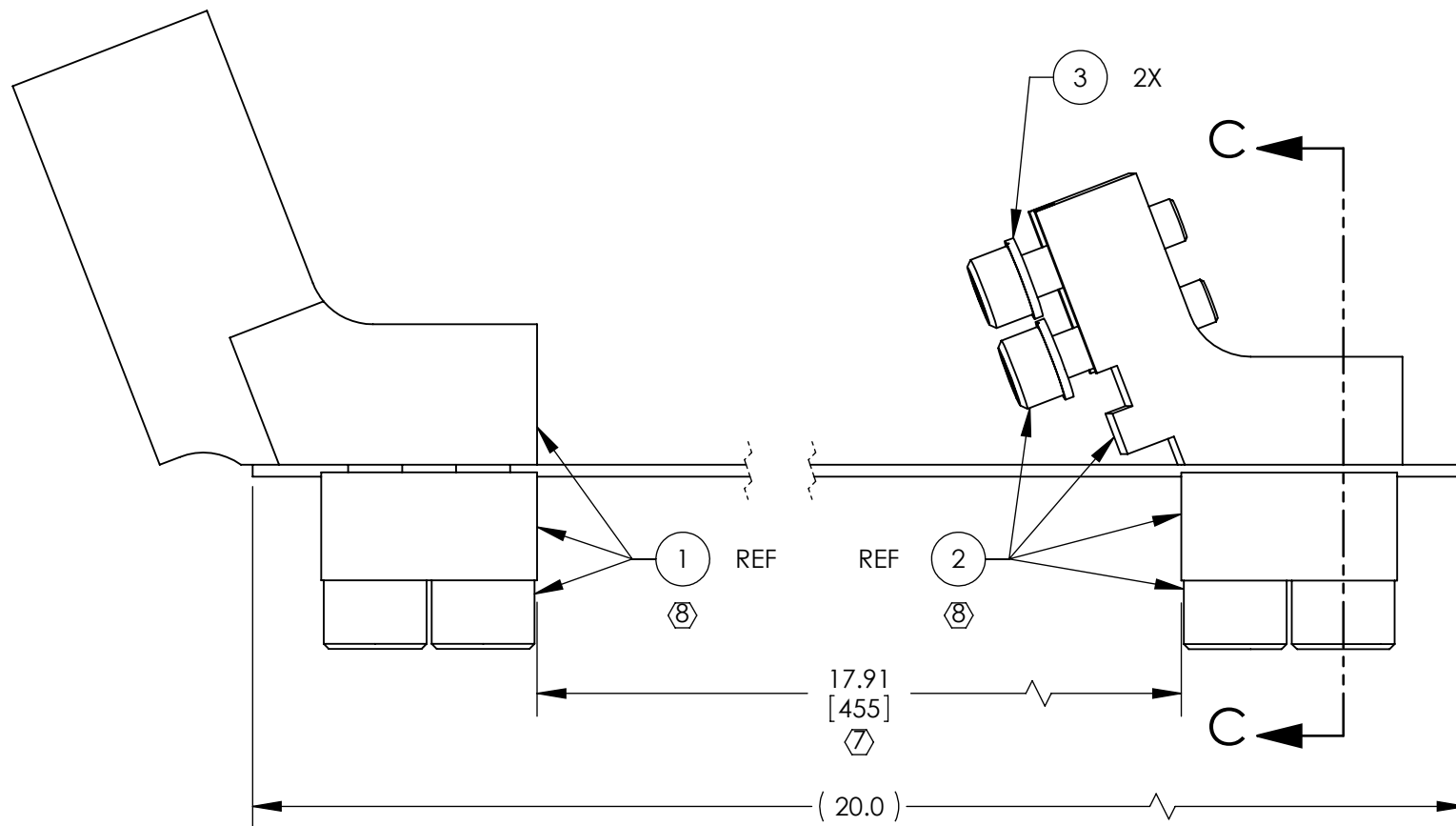

ISO VIEW 1

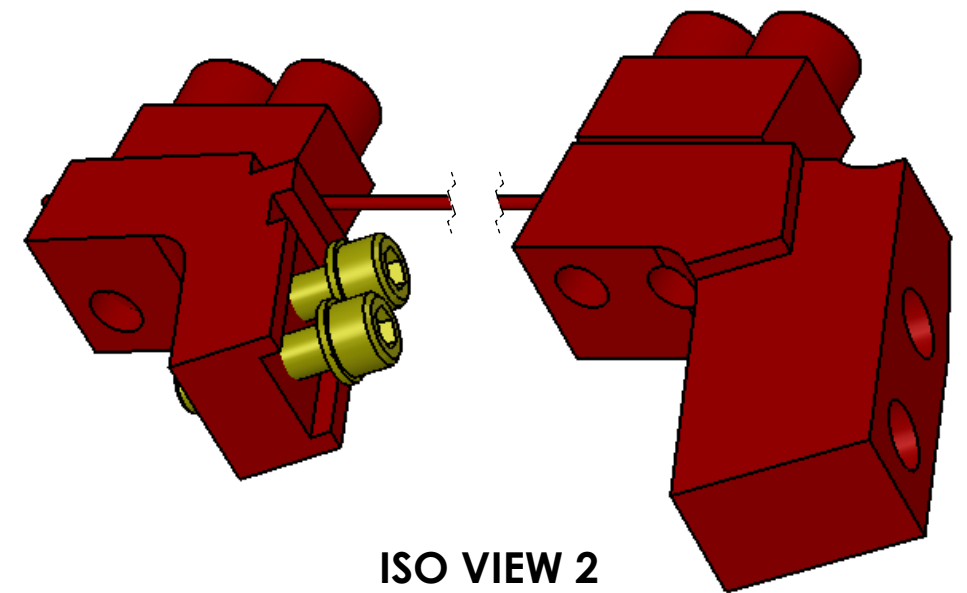

ISO VIEW 2

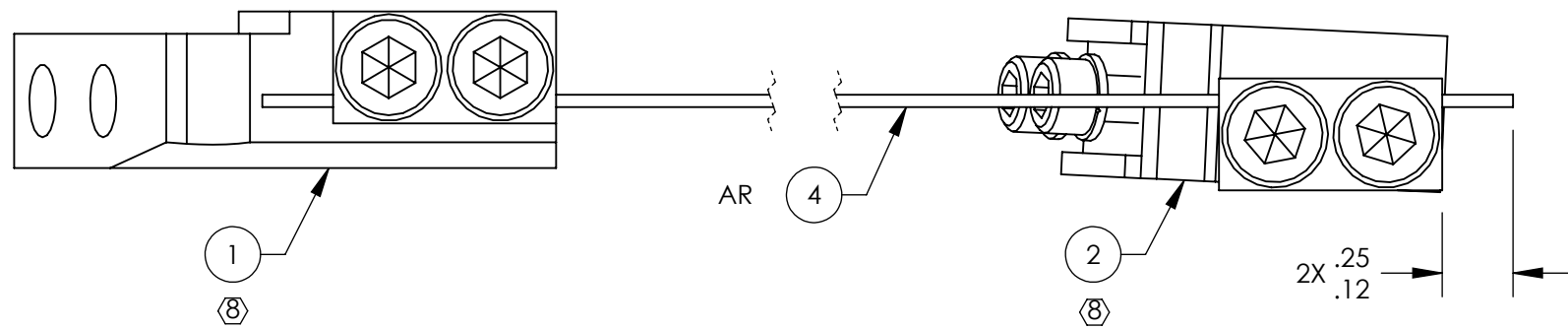

ITEM NO.	PART NUMBER	REV	DESCRIPTION	MATERIAL	REQ	SPARE	TOTAL
4	N/A		WIRE, 1.1 MM DIA. (MUSIC WIRE PER LIGO-E1100159)	STEEL MUSIC WIRE	1		1
3	96861A400 (McM-Carr) or equiv		VENTED FLAT WASHER .169 ID, .304 OD, .032 TH	18-8 SSSL	2	4	6
2	D060332	v2	αLIGO, SUS, QUAD N-PYPE TOP STAGE, WIRE CLAMP TOP STAGE	N/A	1	-	1
1	D1000441	v1	αLIGO INTERMEDIATE WIRE CLAMP ASSY MIDDLE WIRE	N/A	1	-	1

PARTS LIST

NOTES AND TOLERANCES: (UNLESS OTHERWISE SPECIFIED)
 1. INTERPRET DRAWING PER ASME Y14.5-1994.
 2. REMOVE ALL SHARP EDGES, R.02 MIN.
 3. DO NOT SCALE FROM DRAWING.
 4. ALL MACHINING FLUIDS MUST BE FULLY SYNTHETIC, FULLY WATER-SOLUBLE AND FREE OF SULFUR, SILICONE, AND CHLORINE.

DIMENSIONS ARE IN INCHES [MM]
 TOLERANCES:
 .XX ± .01
 .XXX ±
 ANGULAR ± °

LIGO CALIFORNIA INSTITUTE OF TECHNOLOGY
 MASSACHUSETTS INSTITUTE OF TECHNOLOGY

SYSTEM: **ADVANCED LIGO** SUB-SYSTEM: **AOS**

NEXT ASSY: **D1000549**

PART NAME: **αLIGO TMS UPPER SUSPENSION WIRE ASSEMBLY**

DESIGNER: K. MAILAND 17 JUN 2011
 DRAFTER: C. CONLEY 23 NOV 2011

SIZE: **B** DWG. NO.: **D1101166** REV.: **v1**

CHECKER: APPROVAL: SCALE: NONE PROJECTION: SHEET 1 OF 1