

REV.	DATE	DCN #	DRAWING TREE #
v1	5 May 2011	E1100408	E1100409

NOTES CONTINUED:

4. ALL MACHINING FLUIDS MUST BE FULLY SYNTHETIC, FULLY WATER SOLUBLE AND FREE OF SULFUR, SILICONE AND CHLORINE.
5. SCRIBE, ENGRAVE, OR MECHANICALLY STAMP (NO INKS OR DYES) DRAWING PART NUMBER, REVISION (AND VARIANT OR "TYPE" IF APPLICABLE) ON NOTED SURFACE OF PART FOLLOWED ON THE NEXT LINE WITH A THREE DIGIT SERIAL NUMBER. SERIAL NUMBERS START AT 001 FOR THE FIRST ARTICLE AND PROCEED CONSECUTIVELY. USE MINIMUM 0.12 HIGH CHARACTERS, UNLESS THE SIZE OF THE PART DICTATES SMALLER CHARACTERS. A VIBRATORY TOOL MAY BE USED. EXAMPLE DXXXXXXX-VY, TYPE-XX, S/N XXX.
6. APPROXIMATE WEIGHT = 0.4 LB.
7. MACHINE ALL SURFACES TO REMOVE OXIDES AND MILL FINISH, USE OF ABRASIVE REMOVAL TECHNIQUES (INCLUDING SANDING OR SCOURING FOR MATTE FINISH) IS NOT ALLOWED. USE OF SCOTCH-BRITE OR SIMILAR PRODUCTS IS FORBIDDEN.
8. ALL PARTS SHALL BE MANUFACTURED IN ACCORDANCE WITH LIGO SPECIFICATION E0900364.

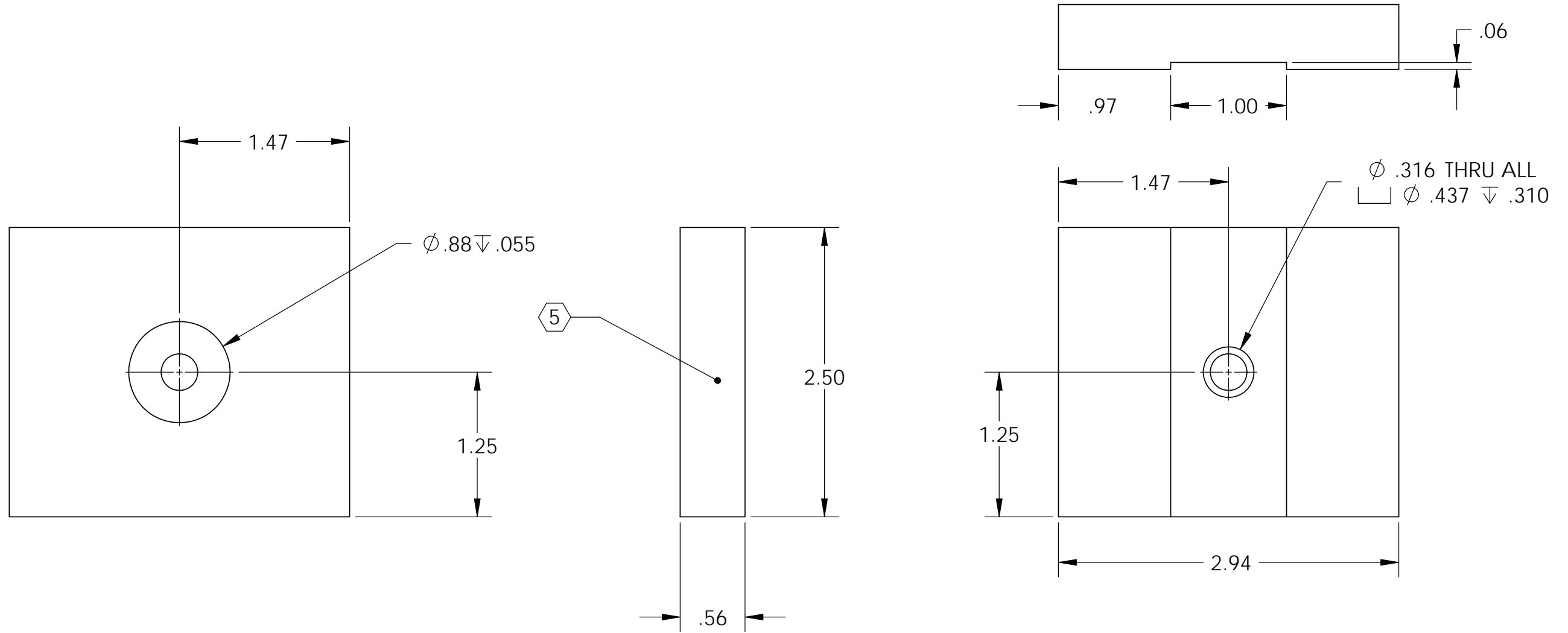

D1100768, PART PDM REV: X-006, DRAWING PDM REV: X-002

NOTES AND TOLERANCES: (UNLESS OTHERWISE SPECIFIED)				CALIFORNIA INSTITUTE OF TECHNOLOGY MASSACHUSETTS INSTITUTE OF TECHNOLOGY		PART NAME								
DIMENSIONS ARE IN INCHES		1. INTERPRET DRAWING PER ASME Y14.5-1994.		LIGO		BOSEM 45 DEG MIRROR JIG PUSHER								
TOLERANCES: .XX ± .015 .XXX ± .005		2. REMOVE ALL SHARP EDGES, .03 x 45°.				DESIGNER	M.HILLARD	21 Apr. 2011	SIZE	DWG. NO.	REV.			
ANGULAR ± .5°		3. DO NOT SCALE FROM DRAWING.		SYSTEM	ADVANCED LIGO	SUB-SYSTEM	SEI	DRAFTER	M.HILLARD	5 May 2011	B	D1100768	v1	
		MATERIAL	6061-T6 Al	FINISH	63 μinch	NEXT ASSY	D1100764	CHECKER	J.LEWIS	5 May 2011	SCALE:	1:1	PROJECTION:	1st Angle
						APPROVAL	C.TORRIE	5 May 2011			SHEET 1 OF 1			