

D1100642_ISC_Rotary_Beam_Diverter, PART PDM REV: X-033, DRAWING PDM REV: X-004

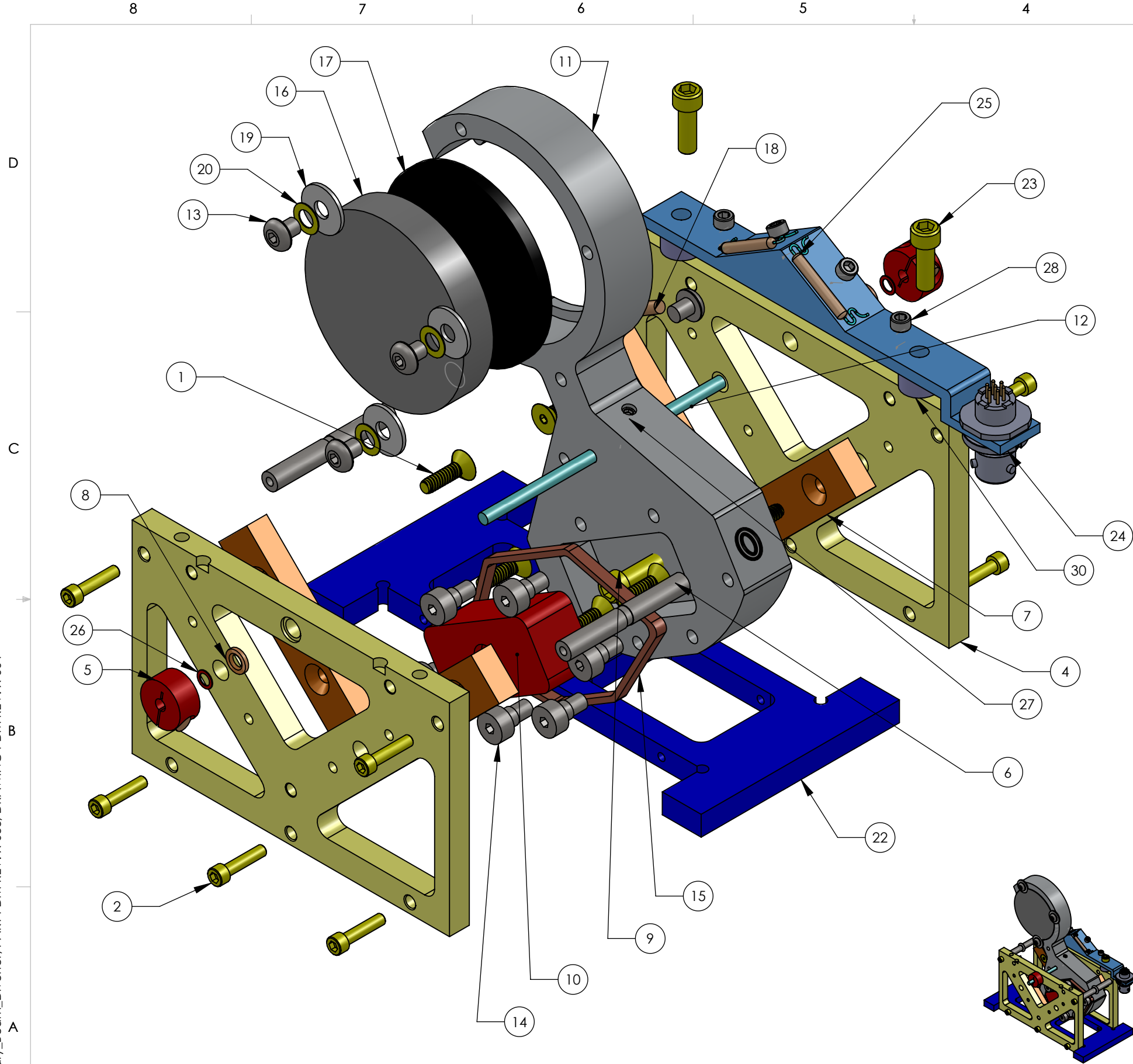

REV.	DATE	DCN #	DRAWING TREE #
-	-	-	-
-	-	-	-
-	-	-	-

ITEM NO.	PART NUMBER	DESCRIPTION	MATERIAL	REQ
31		Glenair_803-003-07M6-7PN-598A	Material <not specified>	1
30	MCMaster_92510A622	Spacer 3/8" OD, 1/4" Length, for #8 Screw, AL	6061-T6 Al	2
29	D1101876	alignment rod for assembly (not shown)	aluminum	
28	92185A105	shcs 4-40		4
27	91979A411	8-32 set screw		1
26	90917A428	McMaster 0.125" Shim Washer	316 SSTL	2
25	Marr-5	Digikey Reed Switch	TRANSPARENT GLASS	2
24	D1100658	ISC Rotary Beam Diverter - REED Plate	6061-T6 Al	1
23	UC Components C-808-NA	SCREW, SOCKET HEAD CAP, #8-32 UNC-2A X 0.5 LONG, FULLY THREADED	300 SSTL	2
22	D1100646	ISC Rotary Beam Diverter - Base Plate	6061-T6 Al	1
20	99842A111	McMaster #8 Wave Washer	18-8 SSTL	3
19	95630A238	McMaster teflon washer		3
18	D26 0p	K&J Magnetics 0.125" Cylinder	NdFeB	1
17	D1100046	ISC - 2" DIAMETER BLACK GLASS OPTIC	TRANSPARENT GLASS	1
16		Rotary Mirror	Glass	1
15		Rotary Coil	Copper	1
14	94035A201	McMaster #8-32 Shoulder Bolt	AISI 304	6
13	92949A189	McMaster #8-32 Button Head	AISI 304	4
12	vermont gage custom rod	.124" x 3" rod	SSTL	1
11	D1100643	ISC Rotary Beam Diverter - Rotary Holder	6061-T6 Al	1
10	D1100656	ISC Rotary Beam Diverter - Counter Weight	304 SSTL	1
9	McMaster 92200A196	SCREW, SOCKET HEAD CAP, #8-32 UNC-2A X 0.625 LONG, FULLY THREADED	300 SSTL	1
8	22589	Bird Rotary Olive Jewel Bearing	Glass	2
7	BY084DCS	K&J Countersunk Bar Magnet	NdFeB	4
6	D1100910	#4-40 Threaded Spacer	AISI 304	2
5	35462480	MSC 1/8" Shaft Collar	304, 316 OR 302 SSTL	2
4	D1100645	ISC Rotary Beam Diverter - Magnet Keeper	416 SSTL	2
3	1201T18	McMaster 3/16" I.D. O-Ring : AS568A Dash Number 008	FLUOROELASTOMER	2
2	McMaster 92196A110	SCREW, SOCKET HEAD CAP, #4-40 UNC-2A X 0.5 LONG, FULLY THREADED	300 SSTL	10
1	9221A148	#6-32 X 0.50" Flat Head Cap Screw	18-8 SSTL	8

NOTES AND TOLERANCES: (UNLESS OTHERWISE SPECIFIED)

MATERIAL		FINISH		PART NAME		REV.			
N/A		N/A		ISC Rotary Beam Diverter		v8			
CALIFORNIA INSTITUTE OF TECHNOLOGY MASSACHUSETTS INSTITUTE OF TECHNOLOGY				SYSTEM: ADVANCED LIGO SUB-SYSTEM: ISC NEXT ASSY: HAMS 1 & 6				DESIGNER: S. WALDMAN DRAFTER: S. FOLEY CHECKER: PFRITSCHEL APPROVAL:	
				DATE: 11 MAR 2011 DATE: 9 NOV 2011		SIZE DWG. NO.: B D1100642			
				SCALE: 1:2		PROJECTION:			
				SHEET 1 OF 1					