

REV.	DATE	DCN #	DRAWING TREE #
v1	13 APR 2010	E1100356-x0	-
-	-	-	-
-	-	-	-

PERISCOPE ASSY. APPLICATION TABLE				
IDENTIFYING NO.	'USED ON'	ASSIGNED VIEWPORT	APPROX. WEIGHT	REFERENCE DOCUMENTATION
D1100625-BSC2L1	BSC2-L1	G2	25.7 LB	D1100833
D1100625-BSC2H1	BSC2-H1	G2	25.7 LB	D1100834
D1100625-BSC4H2	BSC4-H2	G8	24.8 LB	D1100835
D1100625-BSC7H2	BSC7-H2	G11	26.5 LB	D1100836
D1100625-BSC8H2	BSC8-H2	G8	26.5 LB	D1100837

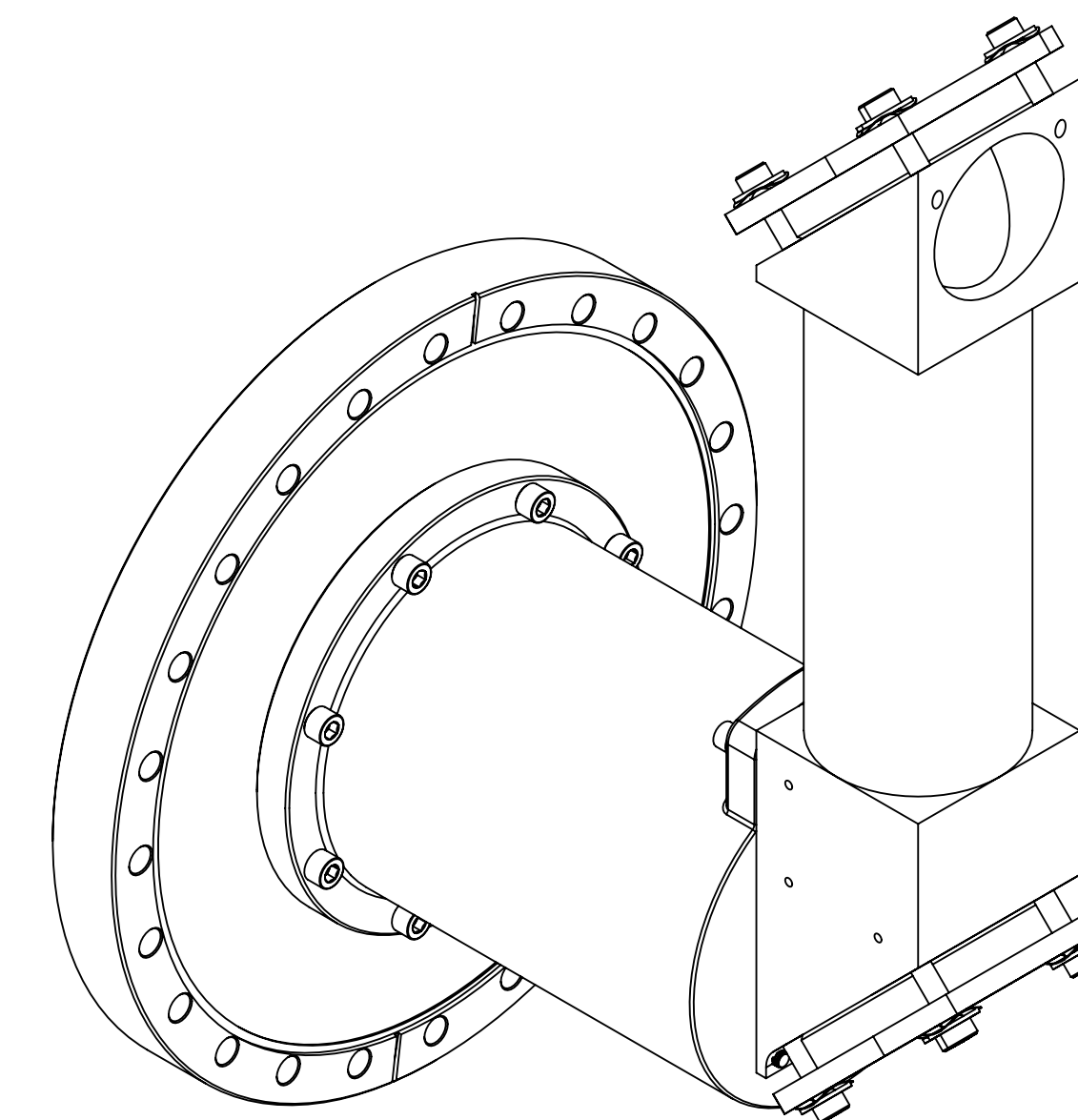
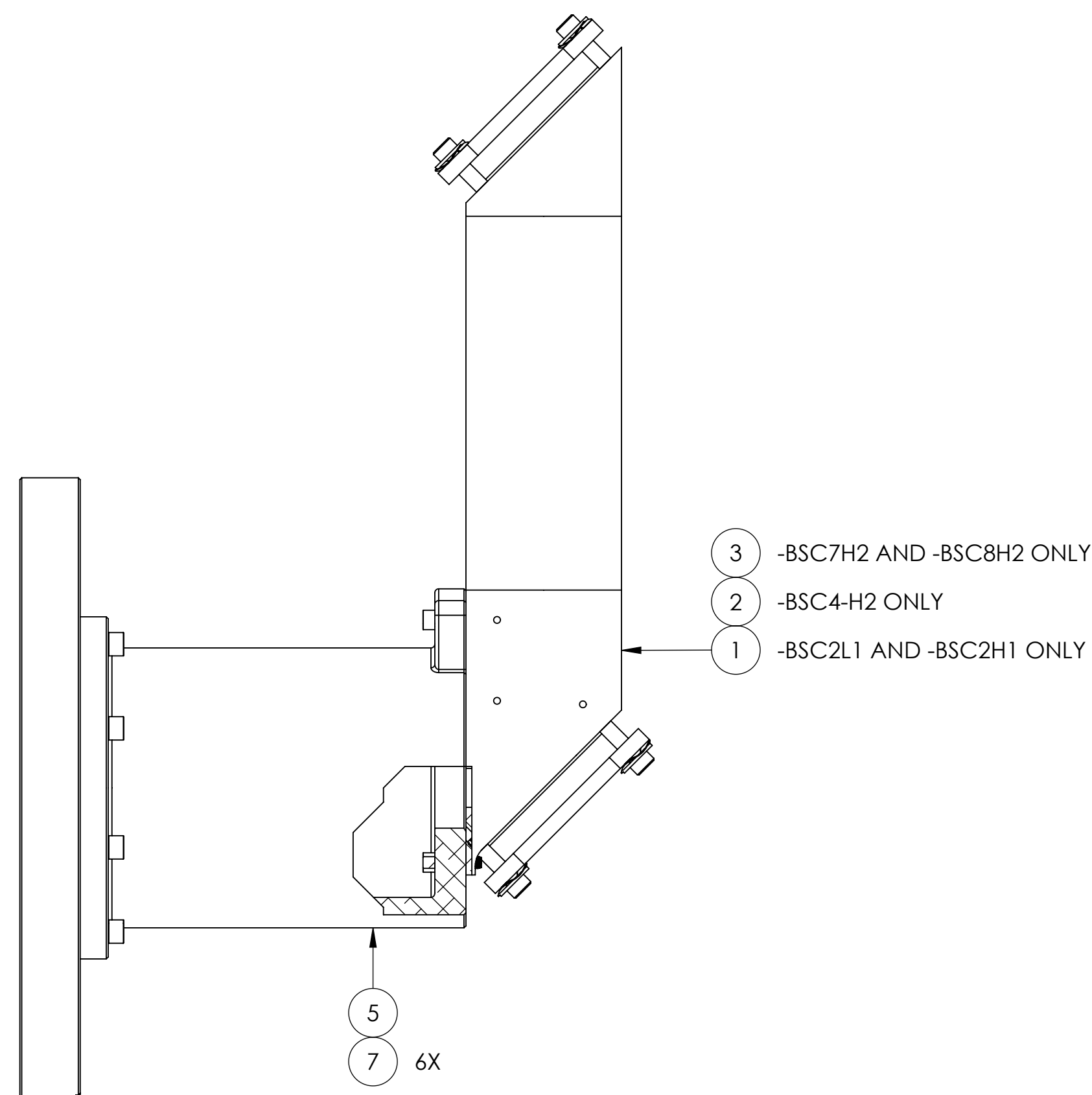
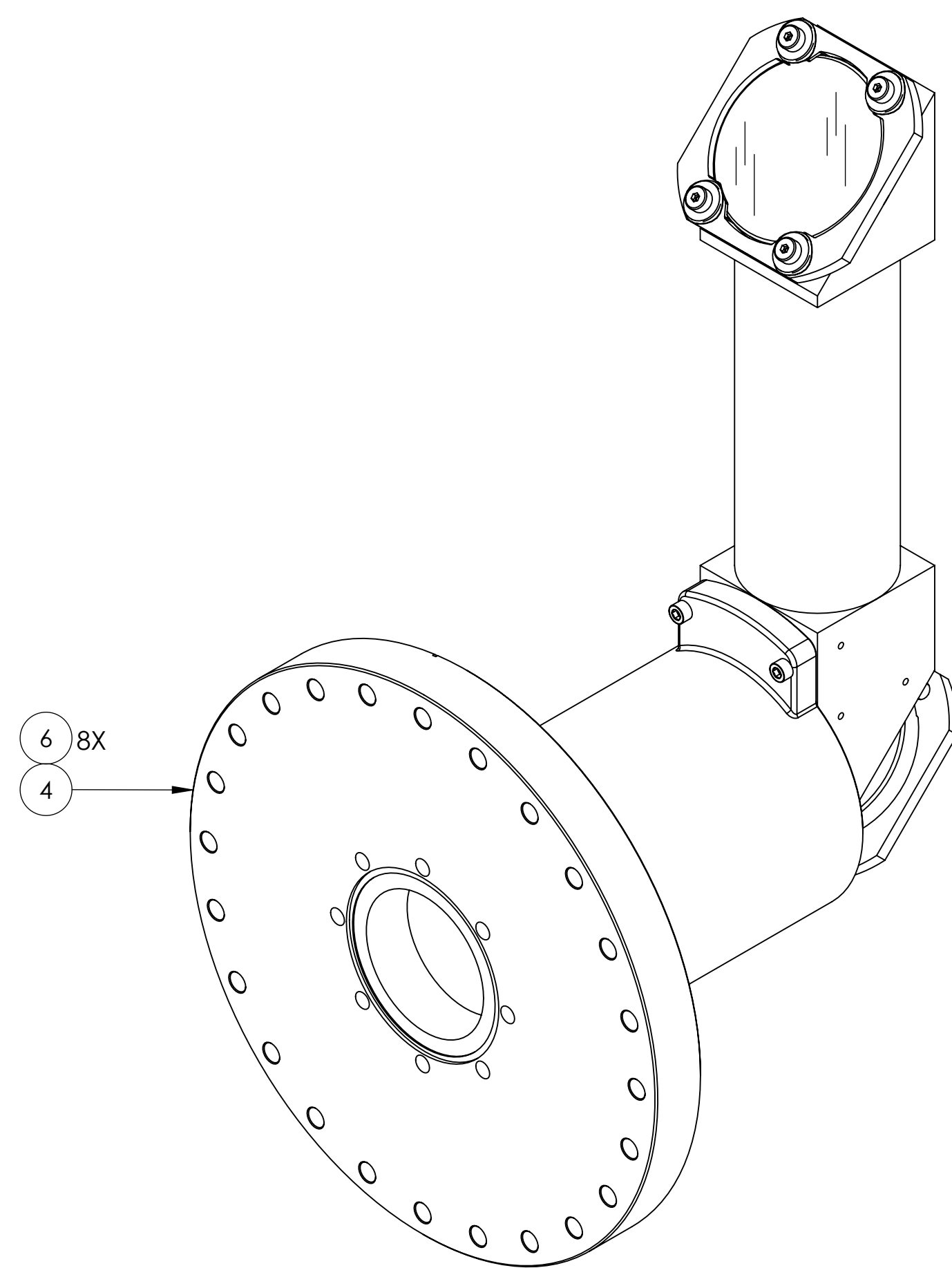

ITEM NO.	PART NUMBER	DESCRIPTION	MATERIAL	D1100625-BSC2L1/REQ	D1100625-BSC2H1/QTY.	D1100625-BSC4H2/QTY.	D1100625-BSC7H2/QTY.	D1100625-BSC8H2/QTY.
7	C-1012-NA	SCREW, SHC, 10-32 X .75 LG.	18-8 SSSL	6	6	6	6	6
6	C-2014-A	SCREW, SHCV, 1/4"-20 X 0.88", SILVER PLATED	18-8 SSSL	8	8	8	8	8
5	D1100898	ALIGO, OPLEV, PERISCOPE, MT. TUBE	6061-T6	1	1	1	1	1
4	D1100626	ALIGO OPLEV PERISCOPE MDC ZL REDUCER (MODIFIED)	N/A	1	1	1	1	1
3	D1002260-2	ALIGO OPLEV PERISCOPE BOX ASSY., BSC7-H2, BSC8-H2	N/A	-	-	-	1	1
2	D1002260-1	ALIGO OPLEV PERISCOPE BOX ASSY., BSC4-H2	N/A	-	-	1	-	-
1	D1002260	ALIGO OPLEV PERISCOPE BOX ASSY., BSC2-L1, H1	N/A	1	1	-	-	-

DIMENSIONS ARE IN INCHES		CALIFORNIA INSTITUTE OF TECHNOLOGY MASSACHUSETTS INSTITUTE OF TECHNOLOGY		PART NAME		ALIGO, OPLEV, PERISCOPE ASSY.									
TOLERANCES: .XX ± .01 .XXX ± .005		SYSTEM <b>ADVANCED LIGO</b>		SUB-SYSTEM <b>OPLEV</b>		DESIGNER	C.WILKERSON	21 FEB 2011	SIZE	D	DWG. NO.	D1100625	REV.	v1	
ANGULAR ± 1.0°		MATERIAL	N/A	FINISH	N/A μinch	CHECKER	J.LEWIS	10 MAY 2011	APPROVAL		SCALE:	1:2	PROJECTION:		SHEET 1 OF 1

D1100625-ALIGO OPLEV PERISCOPE.MT. ASSEMBLY PART PDM REV. X-000 DRAWING PDM REV. X-002