

D1100493_dLIGO TCS .25" Thick ZnSe Window Clam Shell Assy, PART PDM REV: X-027, DRAWING PDM REV: X-007

NOTES CONTINUED:
 5 SCRIBE, ENGRAVE, LASER MARK OR MECHANICALLY STAMP (NO DYES OR INKS) A UNIQUE THREE DIGIT SERIAL NUMBER & REVISION NUMBER ON EACH PART. SERIAL NUMBERS START AT 001 FOR THE FIRST ARTICLE AND PROCEED CONSECUTIVELY. BAG AND TAG PARTS WITH THEIR DRAWING PART NUMBER, REVISION, VARIANT OR "TYPE" (IF APPLICABLE), AND QUANTITY. IF PARTS ARE TOO SMALL TO SCRIBE, BAGGING AND TAGGING ALONE IS SUFFICIENT.
 EXAMPLE (PART): 001-v1
 EXAMPLE (TAG): DXXXXXX-VY, TYPE-XX, QTY: TBD

REV.	DATE	DCN #	DRAWING TREE #
v1	26 JUL 2011	E1100655-v1	E1100656-v1
-	-	-	-
-	-	-	-

- D 6 TORQUE TO 4.5 IN-LB
 7 THERMOCOUPLE JUNCTION MUST BE IN CONTACT WITH ITEM 1 WHEN INSTALLED

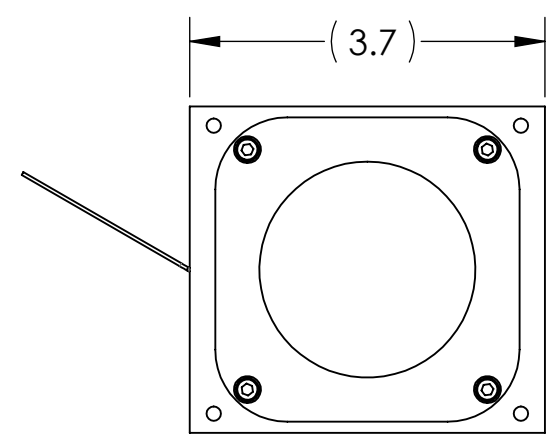
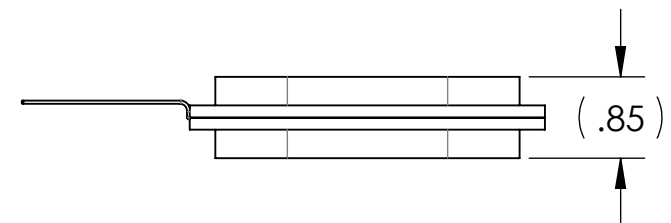
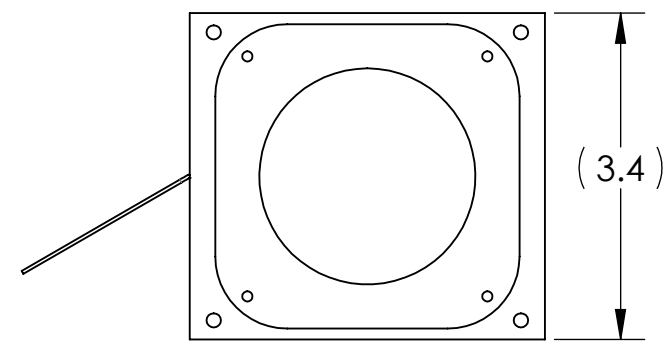
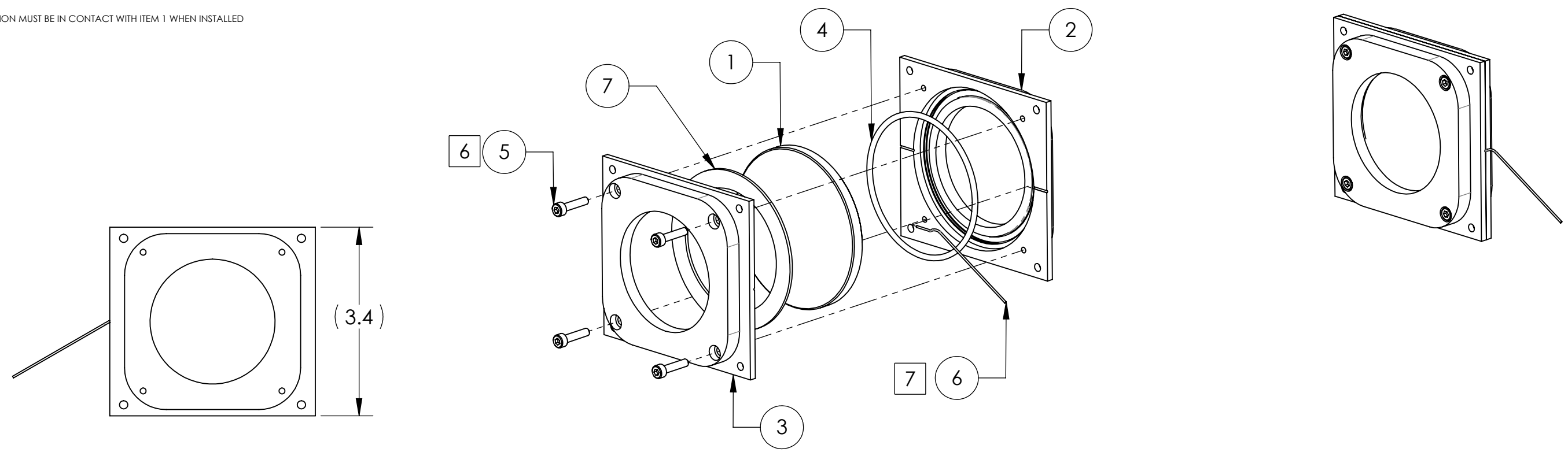

ITEM NO.	PART NUMBER	DESCRIPTION	MATERIAL	Default/REQ	SPARE	TOTAL
7	D1100495	WASHER, CLAMP RING	Polyetheret herketone (PEEK)	1	1	2
6	D1100496	THERMOCOUPLE	N/A	1	1	2
5	C-610-N	SCREW, SOCKET HEAD CAP, #6-32 UNC-2A X 0.625 LONG, FULLY THREADED	18-8 SSSL	4	1	5
4	D080631	O-RING, 3 IN VIEWPORTS	VITON	1	1	2
3	D1100250	REAR MOUNTING PLATE, CO2P VP COVER	6061 Alloy	1		1
2	D1003208	MOUNTING PLATE, CO2P VP COVER	6061 Alloy	1		1
1	D1100485	.25 THICK, 60 MIN WEDGE, ZnSe WINDOW	ZnSe	1		1

NOTES AND TOLERANCES: (UNLESS OTHERWISE SPECIFIED)

DIMENSIONS ARE IN INCHES
 TOLERANCES:
 .XX ± .01
 .XXX ± .005
 ANGULAR ± 1.0°

1. INTERPRET DRAWING PER ASME Y14.5-1994.
 2. REMOVE ALL SHARP EDGES, .005-.015, FOR MACHINED PARTS. ROUND ALL EDGES APPROXIMATELY R.02 FOR SHEET METAL PARTS.
 3. DO NOT SCALE FROM DRAWING.
 4. ALL MACHINING FLUIDS MUST BE FULLY SYNTHETIC, FULLY WATER SOLUBLE AND FREE OF SULFUR, SILICONE, AND CHLORINE.

LIGO CALIFORNIA INSTITUTE OF TECHNOLOGY
 MASSACHUSETTS INSTITUTE OF TECHNOLOGY

ADVANCED LIGO SUB-SYSTEM **AOS**

PART NAME
ZNSE WINDOW CLAM SHELL ASSY

DESIGNER A. LANGLEY 16 MAR 2011
DRAFTER A. LANGLEY 16 MAR 2011
CHECKER M. JACOBSON 26 JUL 2011
APPROVAL P. WILLEMS 30 MAR 2011

SIZE DWG. NO.
B D1100493

REV.
 v1

MATERIAL N/A **FINISH** N/A μinch **NEXT ASSY** D1003204

SCALE: 1:2 **PROJECTION:** **SHEET 1 OF 1**