

REV.	DATE	DCN #	DRAWING TREE #
v1	15 Feb. 2011	E1100119	E1100016

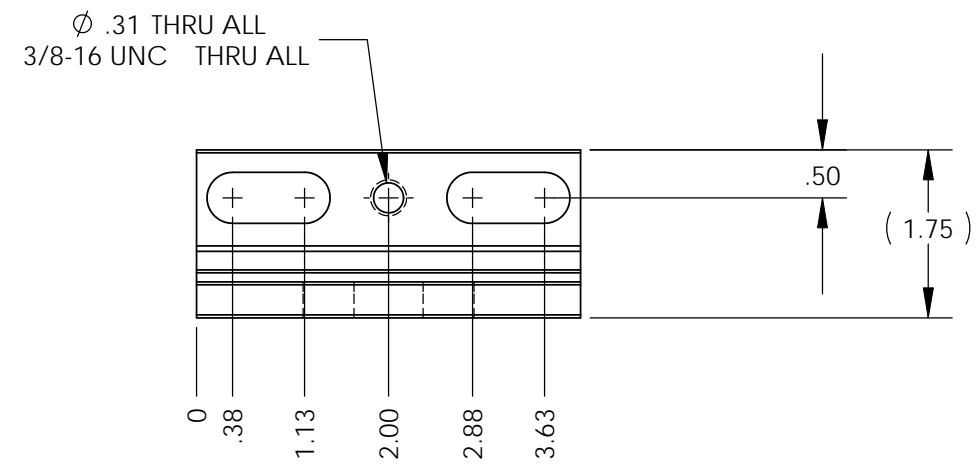
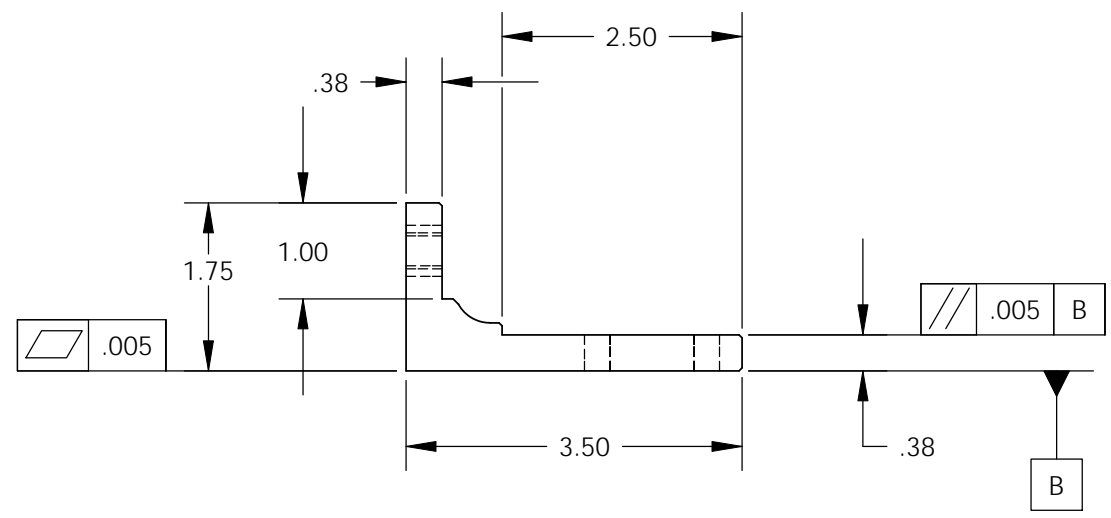
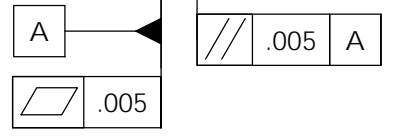
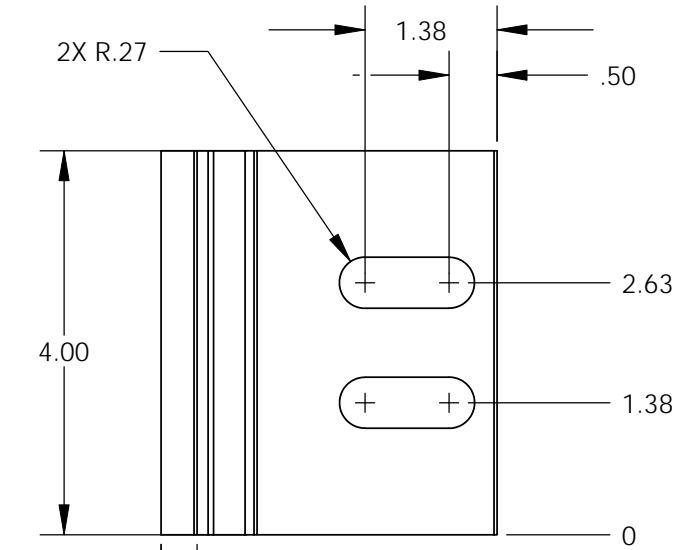

NOTES CONTINUED:

- 4. ALL MACHINING FLUIDS MUST BE FULLY SYNTHETIC, FULLY WATER SOLUBLE AND FREE OF SULFUR, SILICONE AND CHLORINE.
- ⑤ SCRIBE, ENGRAVE, OR MECHANICALLY STAMP (NO INKS OR DYES) DRAWING PART NUMBER, REVISION (AND VARIANT OR "TYPE" IF APPLICABLE ON NOTED SURFACE OF PART FOLLOWED ON THE NEXT LINE WITH A THREE DIGIT SERIAL NUMBER. SERIAL NUMBERS START AT 001 FOR THE FIRST ARTICLE AND PROCEED CONSECUTIVELY. USE MINIMUM 0.12 HIGH CHARACTERS, UNLESS THE SIZE OF THE PART DICTATES SMALLER CHARACTERS. A VIBRATORY TOOL MAY BE USED. EXAMPLE DXXXXXXX-VY, TYPE-XX, S/N XXX.
- 6. APPROXIMATE WEIGHT = 1.9469 LB.
- 7. ALL PARTS SHALL BE MANUFACTURED IN ACCORDANCE WITH LIGO SPECIFICATION E0900364.
- 8. PAINT: ALL VISIBLE SURFACES (exclude fastening hardware) MEDIUM BLUE SHERWIN WILLIAMS (POLANE (R) T-PLUS POLYURETHANE ENAMEL) #SW-F63TX-L-2822-5864 PRIME WITH SHERWIN WILLIAMS INDUSTRIAL WASH PRIMER P60G2
- 9. "OXI SOLV RUST INHIBITOR" TO BE APPLIED PER MFG. INSTRUCTIONS TO ALL UNPAINTED SURFACES. BOTH TAPPED AND THRU HOLES WILL BE PLUGGED DURING APPLICATION.

NOTES AND TOLERANCES: (UNLESS OTHERWISE SPECIFIED)				LIGO CALIFORNIA INSTITUTE OF TECHNOLOGY MASSACHUSETTS INSTITUTE OF TECHNOLOGY		PART NAME	
DIMENSIONS ARE IN INCHES		1. INTERPRET DRAWING PER ASME Y14.5-1994.		ADVANCED LIGO		UNIFIED HYDRAULIC ACTUATOR BRACKET, aLIGO HEPI	
TOLERANCES: .XX ± .01 .XXX ± .005		2. REMOVE ALL SHARP EDGES, .03 x 45°.		SUB-SYSTEM SEI		DESIGNER M.HAMMOND 17 Oct. 2003	SIZE DWG. NO.
ANGULAR ± .5°		3. DO NOT SCALE FROM DRAWING.		MATERIAL AISI 1018 Steel, Cold Rolled		DRAFTER M. HILLARD 15 Feb. 2011	B D1100317
				FINISH 63 μinch		CHECKER M.HAMMOND 17 Oct. 2003	
				NEXT ASSY		APPROVAL K.MASON 15 Feb. 2011	SCALE: 1:2
						PROJECTION: SHEET 1 OF 1	

D1100317, PART PDM REV: X-001, DRAWING PDM REV: X-002