

D1003027 12 Pitch, 20 TOOTH WORM GEAR 57545K513, MODIFIED, PART PDM REV: X-000, DRAWING PDM REV: X-000

**NOTES CONTINUED:**  
 ⑤ SCRIBE, ENGRAVE, OR MECHANICALLY STAMP (NO DYES OR INKS) A UNIQUE THREE DIGIT SERIAL NUMBER & REVISION NUMBER ON EACH PART. SERIAL NUMBERS START AT 001 FOR THE FIRST ARTICLE AND PROCEED CONSECUTIVELY. BAG AND TAG PARTS WITH THEIR DRAWING PART NUMBER, REVISION, VARIANT OR "TYPE" (IF APPLICABLE), AND QUANTITY. IF PARTS ARE TOO SMALL TO SCRIBE, BAGGING AND TAGGING ALONE IS SUFFICIENT.  
 EXAMPLE (PART): 001-v1  
 EXAMPLE (TAG): DXXXXXX-VY, TYPE-XX, QTY: TBD

REV.	DATE	DCN #	DRAWING TREE #
V1	15 NOV 2010	E1000875	-
-	-	-	-
-	-	-	-

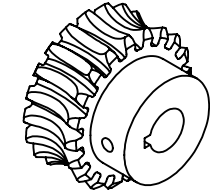
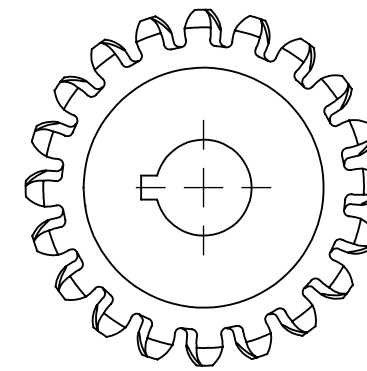
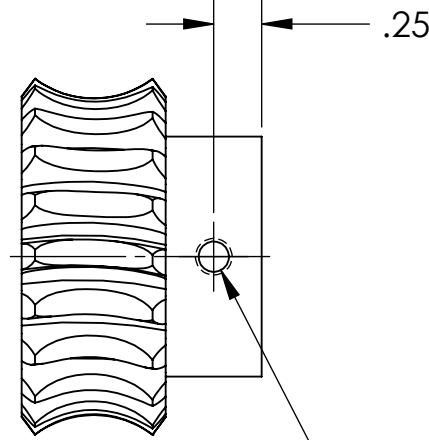
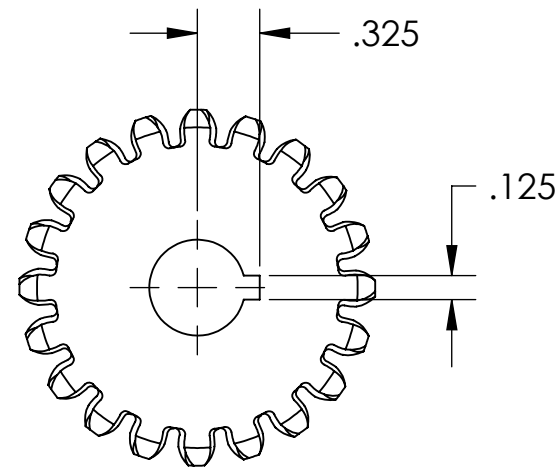

10-32 UNF THRU 1 WALL

NOTES AND TOLERANCES: (UNLESS OTHERWISE SPECIFIED)				LIGO CALIFORNIA INSTITUTE OF TECHNOLOGY MASSACHUSETTS INSTITUTE OF TECHNOLOGY		PART NAME	
DIMENSIONS ARE IN INCHES		1. INTERPRET DRAWING PER ASME Y14.5-1994. 2. REMOVE ALL SHARP EDGES, R.02 MIN. 3. DO NOT SCALE FROM DRAWING. 4. ALL MACHINING FLUIDS MUST BE FULLY SYNTHETIC, FULLY WATER SOLUBLE AND FREE OF SULFUR, SILICONE, AND CHLORINE.		ADVANCED LIGO		12 PITCH, 20 TOOTH WORM GEAR - MODIFIED	
TOLERANCES: .XX ± .01 .XXX ± .005		MATERIAL CAST IRON-MAKE FROM MCMMASTER 57545K513 20 TOOTH WORM GEAR		SUB-SYSTEM SUS		DESIGNER K. BUCKLAND 10 NOV 2010	
ANGULAR ± 0.5°		FINISH N/A μinch		NEXT ASSY D1001664		DRAFTER K. BUCKLAND 15 NOV 2010	
						SIZE DWG. NO. B D1003027	
						CHECKER	
						APPROVAL	
						SCALE: 1:1 PROJECTION:  SHEET 1 OF 1	