

4

3

2

1

REV.	DATE	DCN #	DRAWING TREE #
v1	10 AUG 2010	E1000301	E080191
-	-	-	-
-	-	-	-

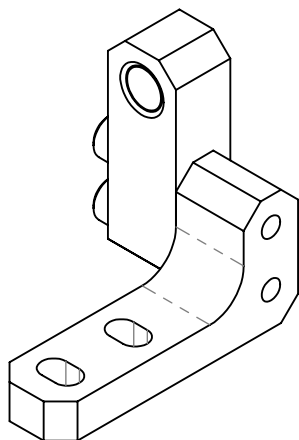

LEFT SIDE CONFIGURATION

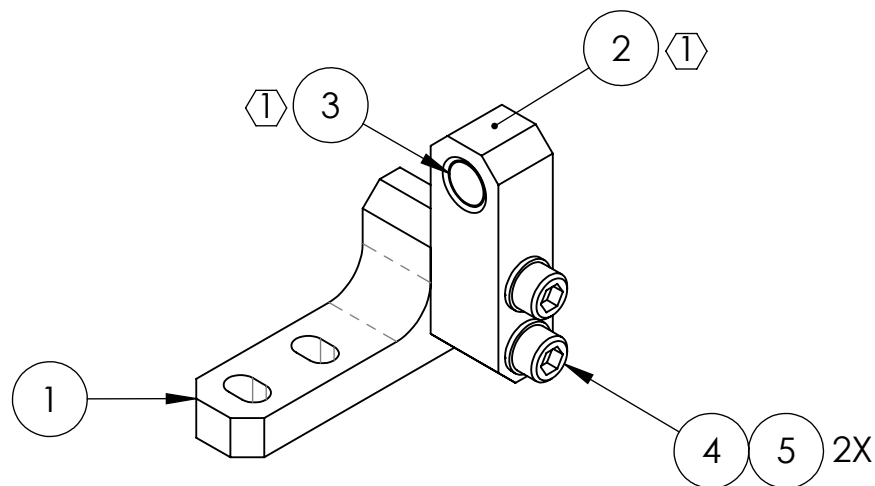

RIGHT SIDE CONFIGURATION

5	-	WASHER, FLAT, VENTED, #8 (U-C COMPONENTS P/N WFV-08 OR EQUIVALENT)	300 SSSL	2	1	3
4	-	SCREW, SOCKET HEAD CAP, #8-32 UNC-2A X 1 LONG	300 SSSL	2	1	3
3	1185-4EN375	HELICOIL, 1/4-20 X 0.375 LONG (T)	NITRONIC 60	1	1	2
2	D1002824	EARTHQUAKE STOP BRACKET SIDE, BOTTOM MASS, LOWER (T)	6061-T6 Al	1	0	0
1	D1002823	EARTHQUAKE STOP BRACKET BACK, BOTTOM MASS, LOWER	6061-T6 Al	1	0	0
ITEM NO.	PART NUMBER	DESCRIPTION	MATERIAL	REQ	SPARE	TOTAL

PARTS LIST

NOTES AND TOLERANCES: (UNLESS OTHERWISE SPECIFIED)

(T) HELICOIL TO BE INSTALLED INTO ITEM NO. 2 BY LIGO PERSONNEL PRIOR TO ASSEMBLY AND AFTER ALL PARTS ARE CLEANED AND BAKED.



CALIFORNIA INSTITUTE OF TECHNOLOGY
MASSACHUSETTS INSTITUTE OF TECHNOLOGY

PART NAME

EARTHQUAKE STOP BRACKET ASSY, LOWER, BOTTOM MASS

SYSTEM

ADVANCED LIGO

SUB-SYSTEM

SUS

DESIGNER D. BRIDGES 25 OCT 2010

DRAFTER D. BRIDGES 27 OCT 2010

CHECKER B. MOORE 28 OCT 2010

APPROVAL

SIZE DWG. NO.

A

D1002822

REV.

v1

MATERIAL

N/A

FINISH

N/A μinch

NEXT ASSY

EARTHQUAKE STOP ASSY,
LOWER, BOTTOM MASS

SCALE: 1:1

PROJECTION:



SHEET 1 OF 1

4

3

2

1