

D1002584 SCREW M10 X 1mm X 35 mm LG, PART PDM REV: X-000, DRAWING PDM REV: X-002

NOTES CONTINUED:
 5. SCRIBE, ENGRAVE, OR MECHANICALLY STAMP (NO INKS OR DYES) DRAWING PART NUMBER, REVISION (AND VARIANT OR "TYPE" IF APPLICABLE) ON NOTED SURFACE OF PART FOLLOWED ON THE NEXT LINE WITH A THREE DIGIT SERIAL NUMBER. SERIAL NUMBERS START AT 001 FOR THE FIRST ARTICLE AND PROCEED CONSECUTIVELY. USE MINIMUM 0.12 HIGH CHARACTERS, UNLESS THE SIZE OF THE PART DICTATES SMALLER CHARACTERS. A VIBRATORY TOOL MAY BE USED.
 EXAMPLE DXXXXXX-VY, TYPE-XX, S/N XXX.
 6. APPROXIMATE WEIGHT = 34.42 LB.

REV.	DATE	DCN #	DRAWING TREE #
v1	5 Oct. 2010	E0900443	E1000025

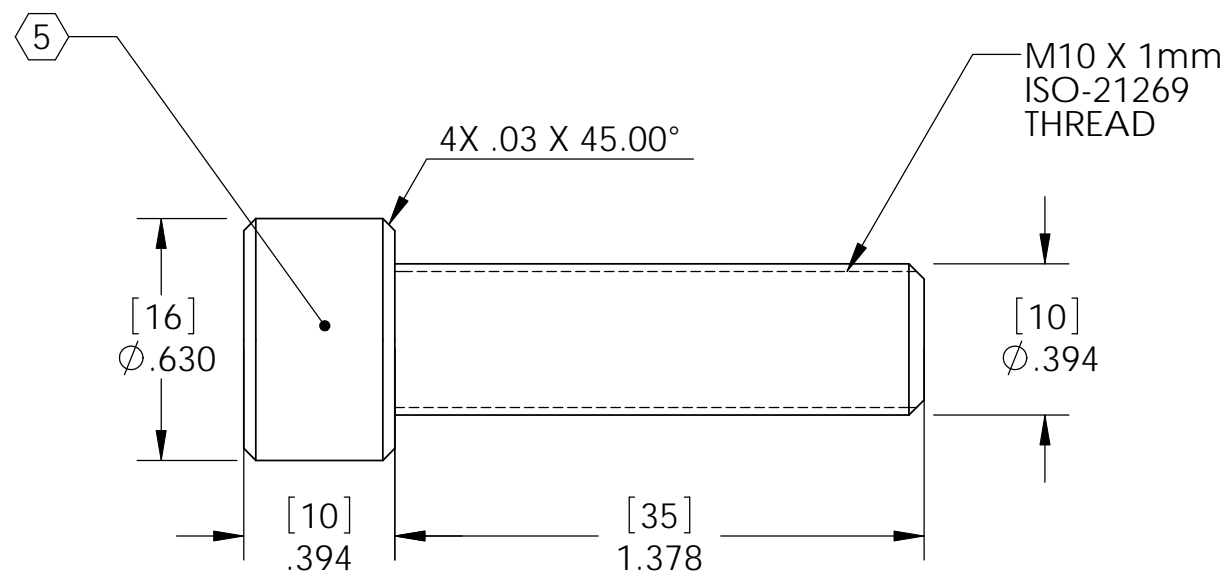
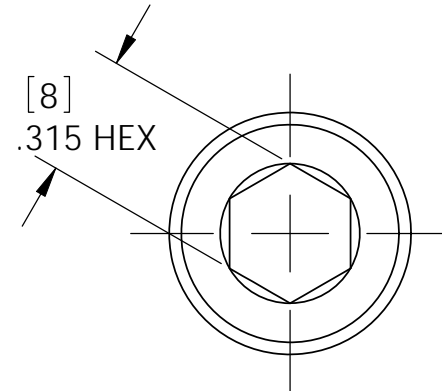

NOTES AND TOLERANCES: (UNLESS OTHERWISE SPECIFIED)				LIGO CALIFORNIA INSTITUTE OF TECHNOLOGY MASSACHUSETTS INSTITUTE OF TECHNOLOGY		PART NAME	
DIMENSIONS ARE IN INCHES (MM) FOR REFERENCE		1. INTERPRET DRAWING PER ASME Y14.5-1994. 2. REMOVE ALL SHARP EDGES, R.02 MIN. 3. DO NOT SCALE FROM DRAWING. 4. ALL MACHINING FLUIDS MUST BE FULLY SYNTHETIC, FULLY WATER SOLUBLE AND FREE OF SULFUR, SILICONE, AND CHLORINE.		SYSTEM ADVANCED LIGO		SUB-SYSTEM SEI	
TOLERANCES: .XX ± .015 .XXX ± .005		MATERIAL 18-8 SSTL, (A2 OR A4 STAINLESS STEEL)	FINISH μinch	NEXT ASSY D0900648		DESIGNER S.BARNUM 5 Oct. 2010	
ANGULAR ± .5°						DRAFTER M.HILLARD 5 Oct. 2010	
						CHECKER F.MATICHARD 5 Oct. 2010	
						APPROVAL K.MASON 5 Oct. 2010	
				SCALE: 2:1		PROJECTION:	
				DWG. NO. B D1002584		REV. v1	
				SHEET 1 OF 1			

8 7 6 5 4 3 2 1

D C B A

D C B A

8 7 6 5 4 3 2 1