

6 5 4 3 2 1

NOTES: (UNLESS OTHERWISE SPECIFIED)

 .01 WIDE X .01 DEEP CROSS HAIRS.

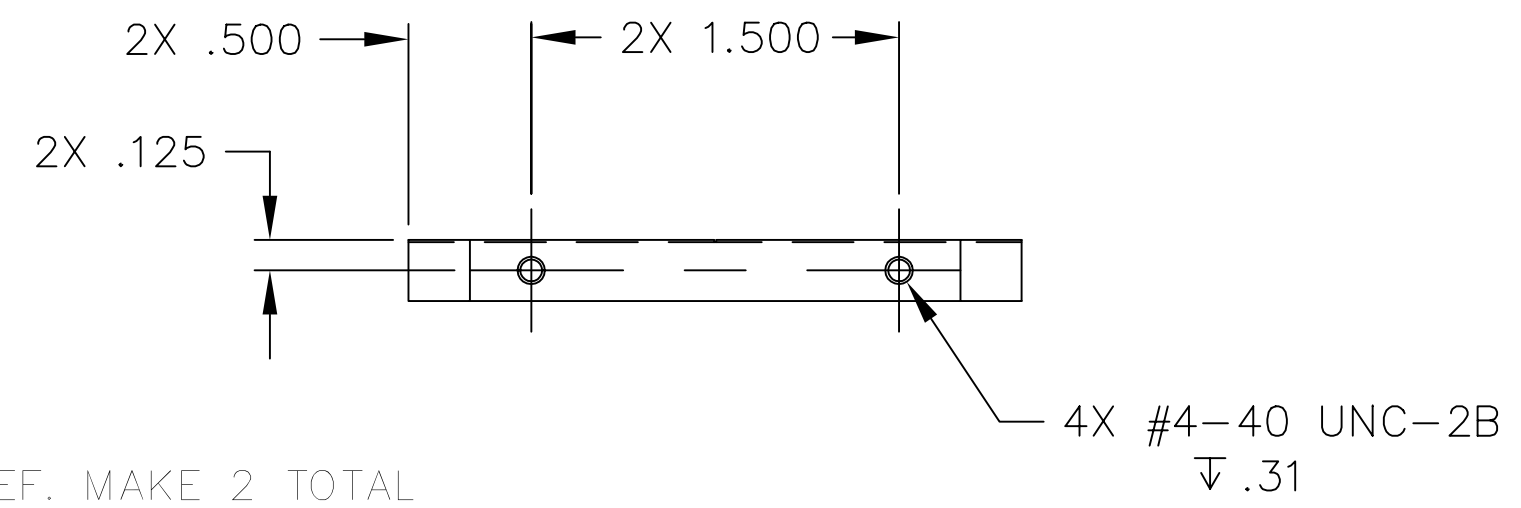
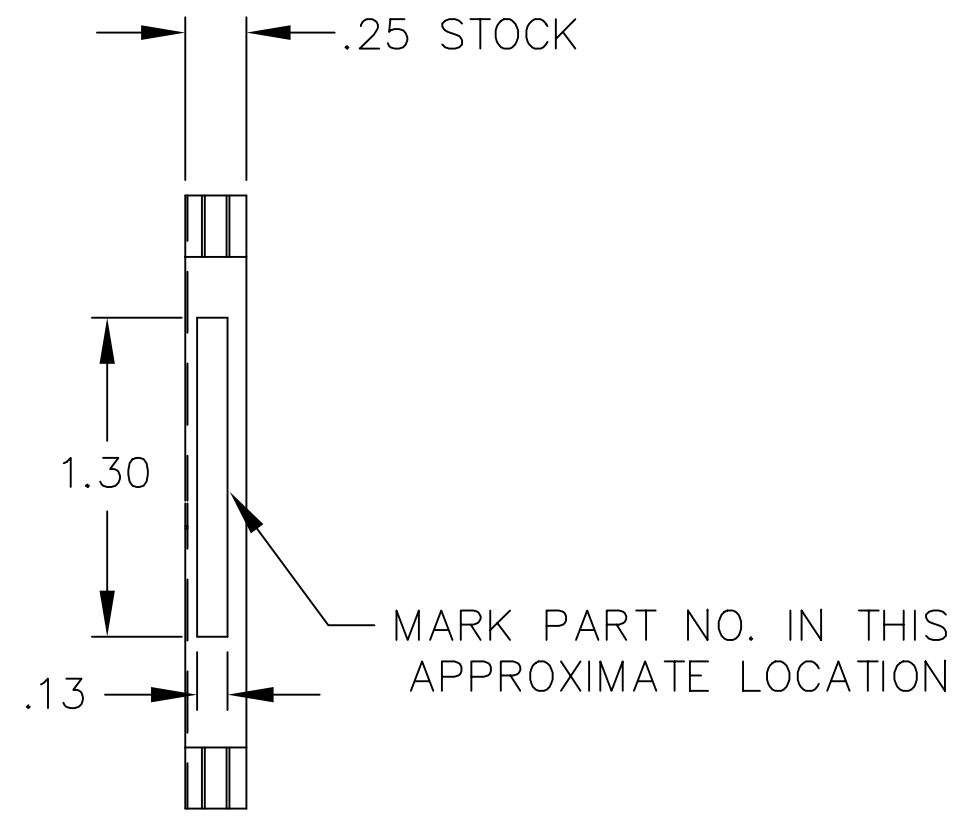
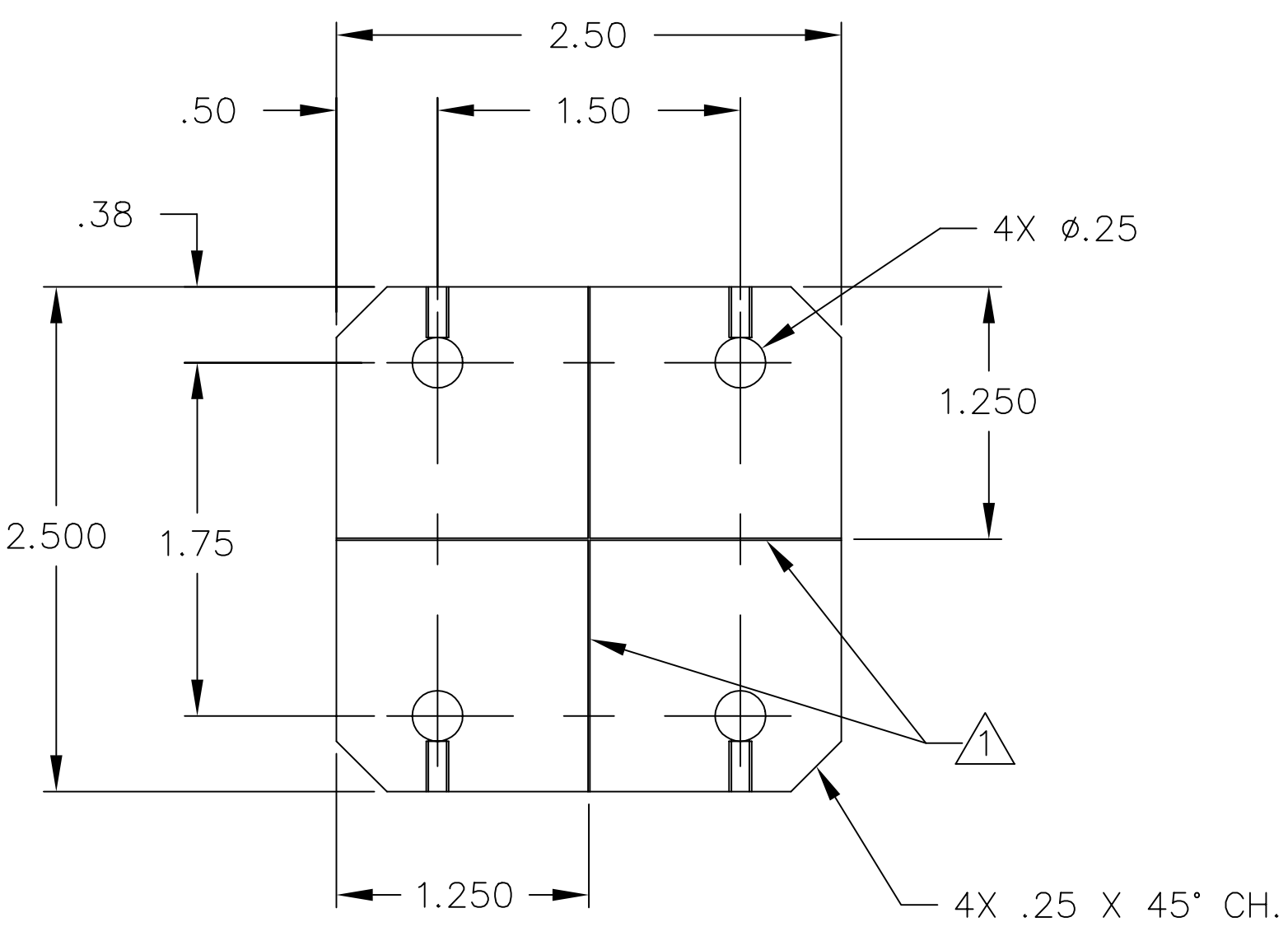

REF. MAKE 2 TOTAL
DOES NOT REMAIN IN VACUUM

~~Liquid contaminants/Machining Lubricants~~
Liquids containing hydrocarbons or other contaminants, other than the machining fluids specified herein, shall not be allowed to come into contact with suspension material at any time. All machining fluids shall be water soluble and free of sulfur, chlorine and silicone; such as Cincinnati Milacron's Cimtech 410 (stainless steel).

Identification_Serial Number
A serial number shall be etched, or scribed on the part see note drawing note.

Serial Number Format
The Serial number shall be of the format: D99xxxx-x-001

Example: D990021-A-001
The drawing number, The revision number, The sequential part number

see D000098

| REF. | QTY. | PART or DRWG No. | NOMENCLATURE or DESCRIPTION | MATERIAL |
|-------------------------|------|------------------|-----------------------------|----------|
| PARTS and MATERIAL LIST | | | | |

| | | | | | | | |
|--------------------|-------------|--|------------------|---|-------------|--|--------------------------------------|
| | | UNLESS OTHERWISE SPECIFIED DIMENSIONS ARE IN INCHES | | | | LIGO CALIFORNIA INSTITUTE OF TECHNOLOGY MASSACHUSETTS INSTITUTE OF TECHNOLOGY | |
| | | TOLERANCES: FRACTIONAL ± 1/16 ANGULAR ± .25° ANGULAR MACH - BEND - TWO PLACE DECIMAL ± .01 | | THREE PLACE DECIMAL ± .005 FINISHED SURFACE RMS 63 BREAK CORNERS IN: .015 OUT: .015 REMOVE ALL BURRS | | P □ Telescope Alignment TARGET | |
| | | MATERIAL: 6061 T-6 ALUM. | HEAT TREAT: / | FINISH: / | B | FDR FABRICATION | kenn 6-8-99 |
| DWG. NO. | DESCRIPTION | USED ON: XXX | NEXT ASS'Y: XXX | REV | DESCRIPTION | DCN NUMBER | DATE |
| REFERENCE DRAWINGS | | | | ISSUE DESCRIPTION | | CHAPUT 11-3-98 | CAD FILE D980575-B |
| | | | | | | SCALE 1:1 | SIZE DWG. NO. D980575-B SHEET 1 OF 1 |

6 5 4 3 2 1