

7 6 5 4 3 2 1

NOTES: (UNLESS OTHERWISE SPECIFIED)

Liquid contaminants/Machining Lubricants
 Liquids containing hydrocarbons or other contaminants, other than the machining fluids specified herein, shall not be allowed to come into contact with suspension material at any time. All machining fluids shall be water soluble and free of sulfur, chlorine and silicone; such as Cincinnati Milacron's Cimtech 410 (stainless steel).

Identification Serial Number

A serial number shall be etched, or scribed on the part see note drawing note.

Serial Number Format

The Serial number shall be of the format: D99xxxx-x-001

Example: D990021-A-001

The drawing number, The revision number, The sequential part number

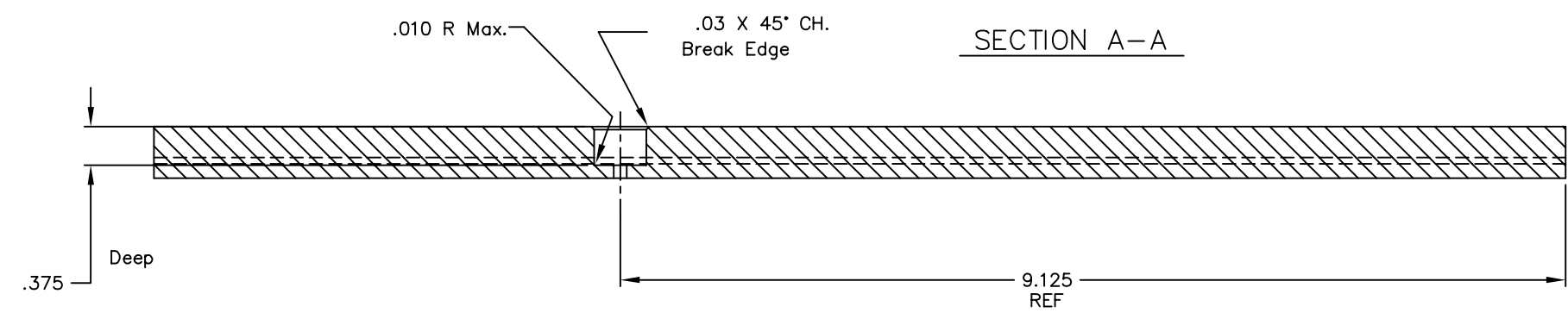
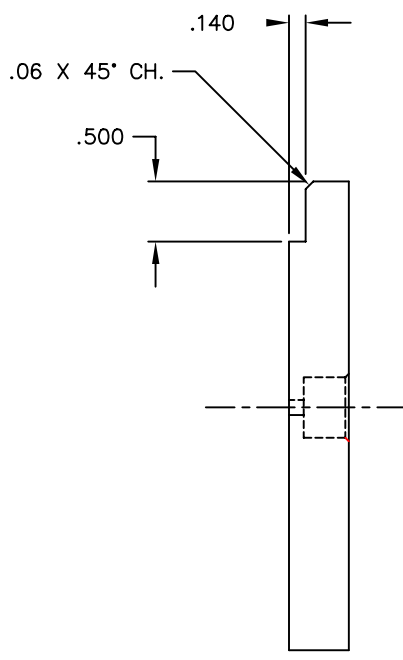
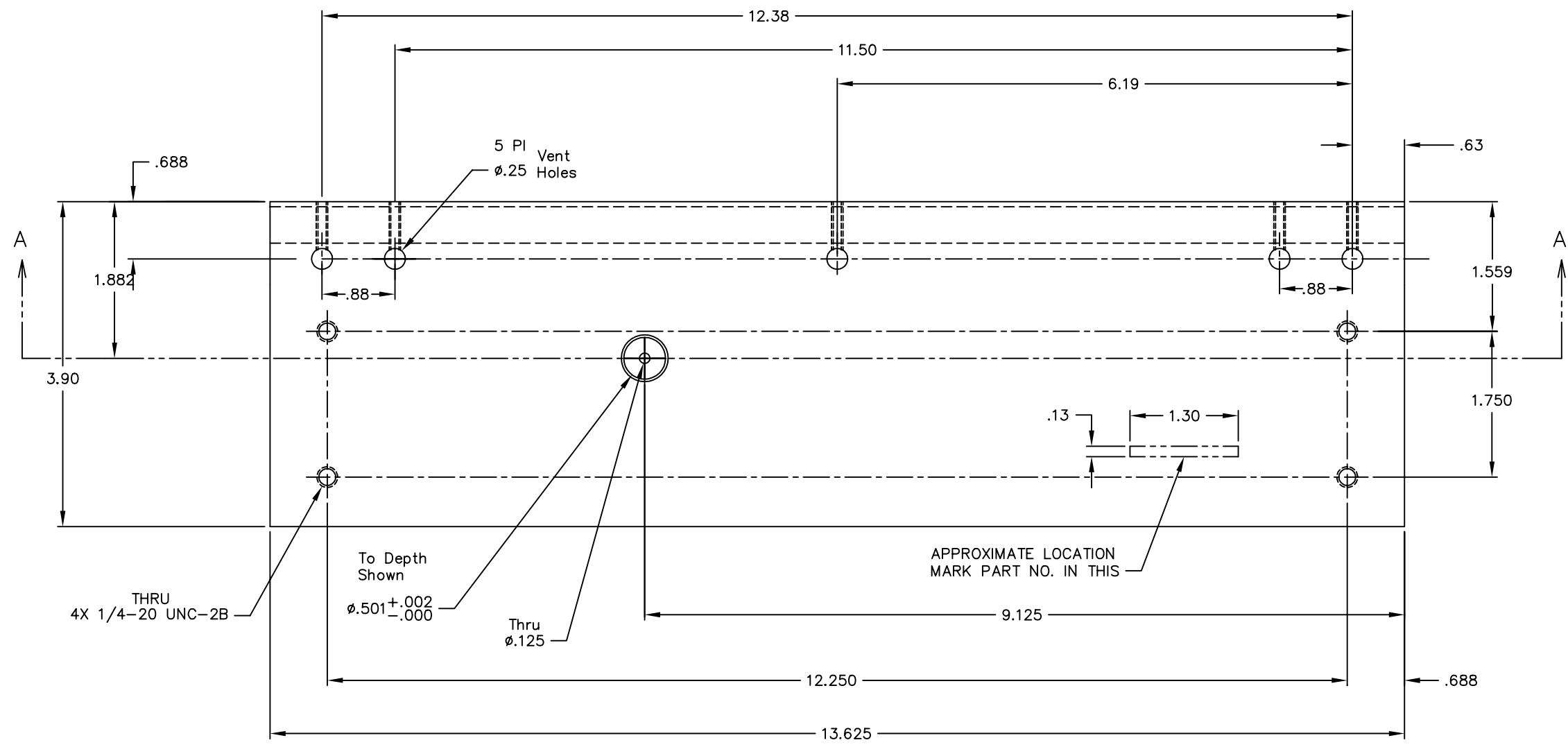
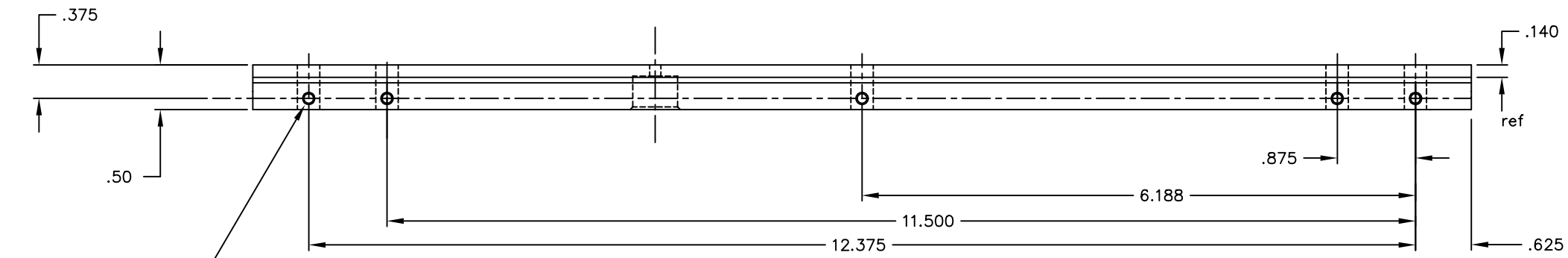

REF. MAKE 1 PER ASSEMBLY

REF		QTY	PART or DRWG No.	DESCRIPTION	MATERIAL
PARTS and MATERIAL LIST					
LIGO CALIFORNIA INSTITUTE OF TECHNOLOGY MASSACHUSETTS INSTITUTE OF TECHNOLOGY					
C				BORED HOLE WAS .75" DIA	kenm 8-4-99
B				FOR FABRICATION	kenm 6-4-99
00				PRE-RELEASE	CHAPUT 11-2-98
REV			DESCRIPTION	DCN NUMBER	APPR'D CHECK DRWN DATE
DWG. NO.		DESCRIPTION		SCALE	SIZE DWG. NO. SHEET
XXX		REFERENCE DRAWINGS		1 : 1	D 1 OF 1
MATERIAL: ALUMINUM TOOLING PLATE		HEAT TREAT: /		FINISH: /	
USED ON: XXX		NEXT ASS'Y: XXX		ISSUE DESCRIPTION	

7 6 5 4 3 2 1