

NOTES: (UNLESS OTHERWISE SPECIFIED)

1. INTERPRET DRAWING PER ANSI  
Y14.5M-1982

 MATERIAL: 6061-T6 ALUMINUM PER  
QQ-A-225/8 OR QQ-A-250/11.

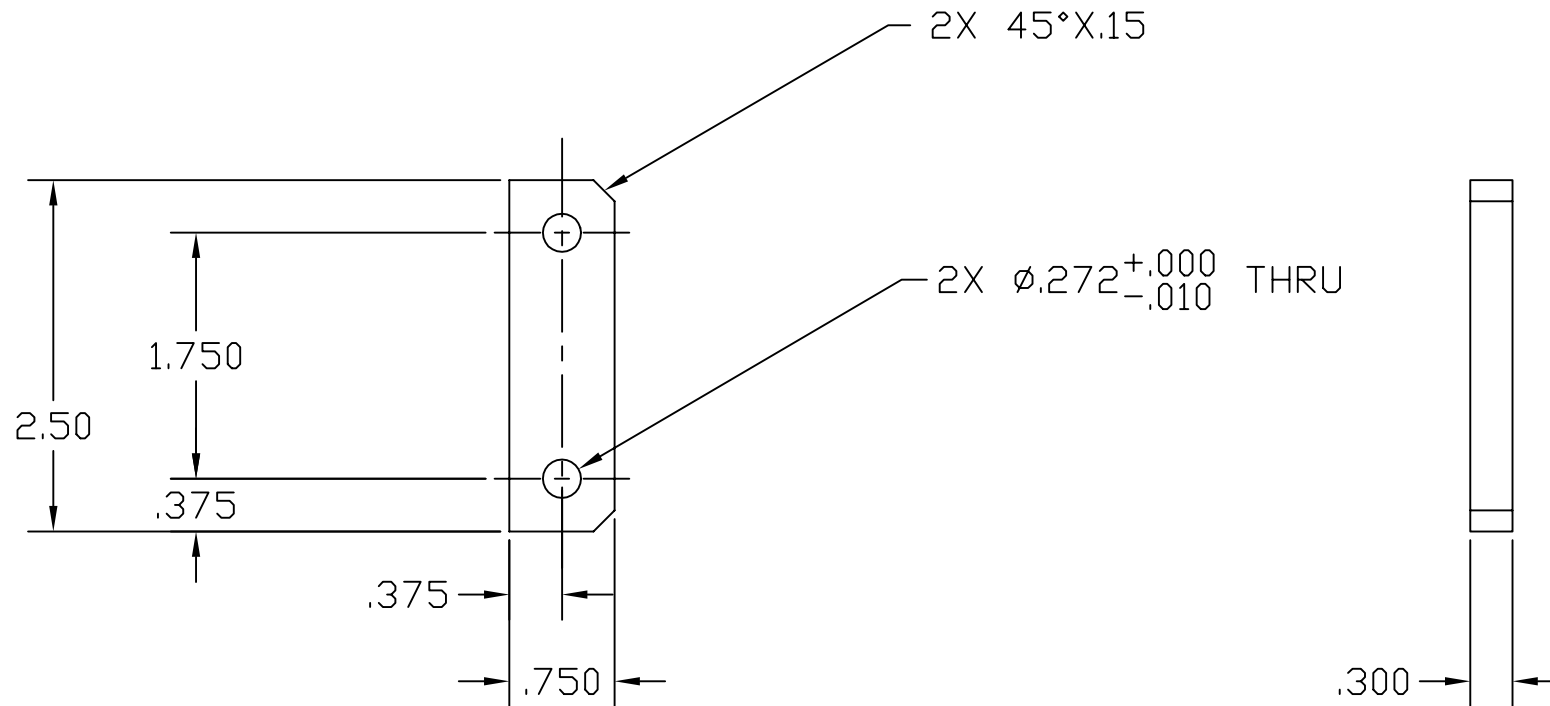

UNLESS OTHERWISE SPECIFIED  
DIMENSIONS ARE IN INCHES

TOLERANCES:  
FRACTIONAL ±  
ANGULAR ± 0.5°  
ANGULAR MACH ± BEND ±  
TWO PLACE DECIMAL ± .03

THREE PLACE DECIMAL ± .005  
FINISHED SURFACE 32 microlinch average  
BREAK CORNERS IN: .005-.010  
REMOVE ALL BURRS

**LIGO** CALIFORNIA INSTITUTE OF TECHNOLOGY  
MASSACHUSETTS INSTITUTE OF TECHNOLOGY

BEAMSPLITTER OPTIC CARRIER  
STANDOFF SPACER 2

|  |                               |         |
|--|-------------------------------|---------|
| MATERIAL:<br> | HEAT TREAT:                   | FINISH: |
| USED ON:   | NEXT ASS'Y: D961450 & D961468 |         |

|     |                |           |         |       |      |
|-----|----------------|-----------|---------|-------|------|
| REV | DESCRIPTION    | DRWN      | DATE    | CHECK | DATE |
| A   | DCN E980214-00 | C. Corley | 9-14-98 |       |      |

|               |        |             |
|---------------|--------|-------------|
| CAD FILE      | SIZE   | DWG. NO.    |
| D980370-A.dwg | A      | D980370-A-D |
| SCALE         | SHEET  |             |
| 1/1           | 1 OF 1 |             |

ISSUE DESCRIPTION