

1. CLEAR ANODIZE PER MIL-A-8625

NOTES:

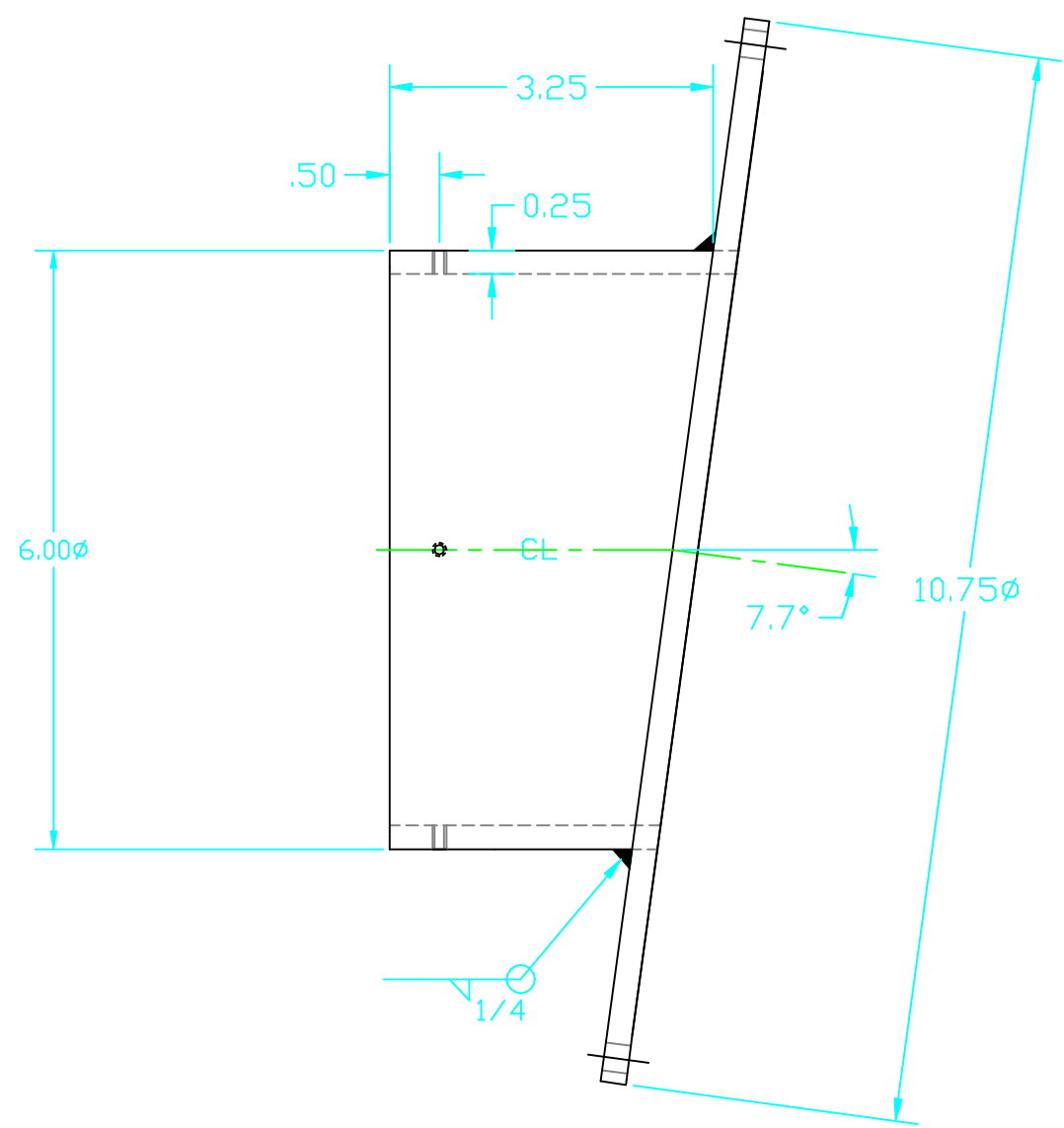
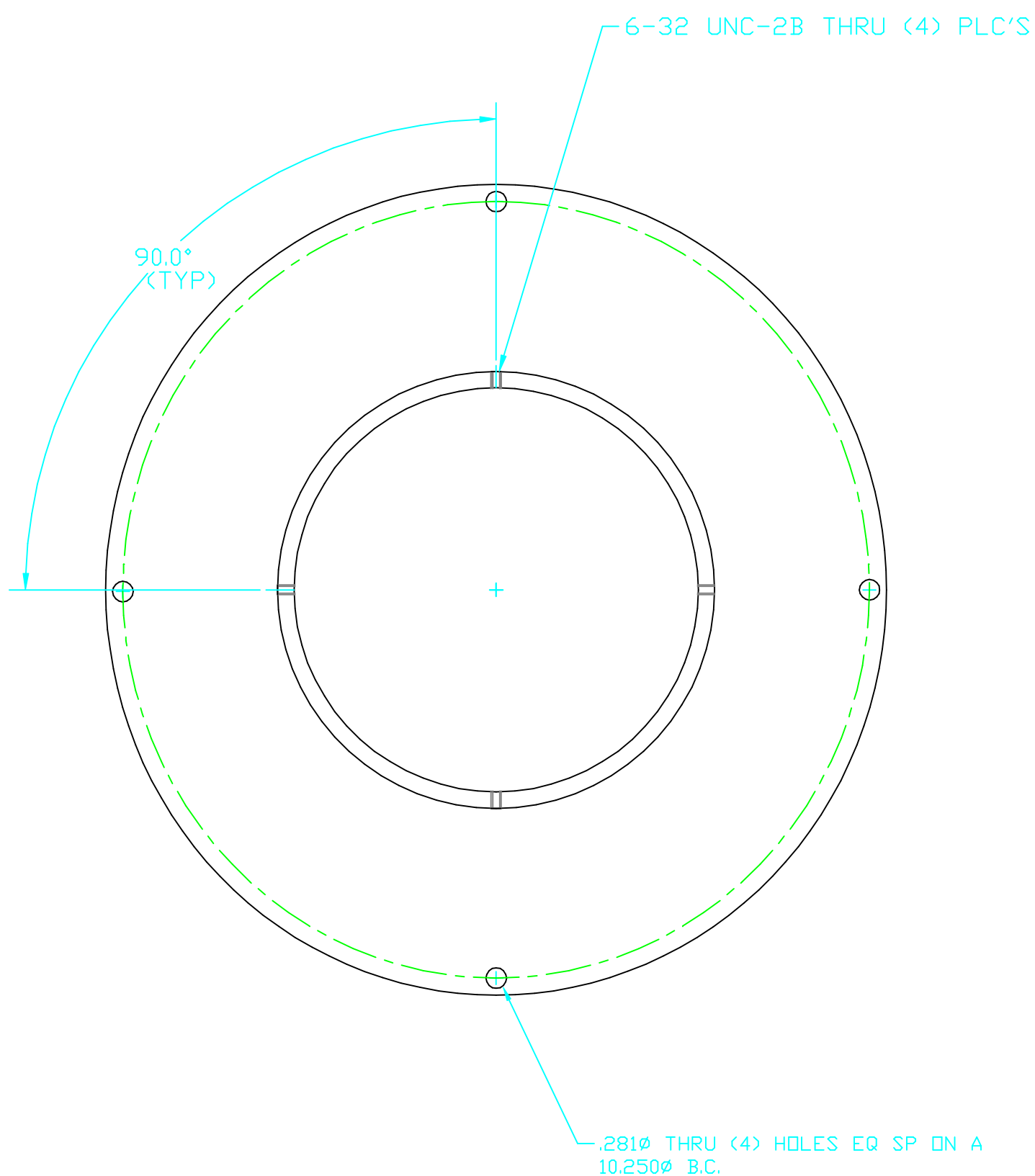

REF	QTY	PART or DRWG No.	CDS										MATERIAL																											
PARTS and MATERIAL LIST																																								
<p>UNLESS OTHERWISE SPECIFIED</p> <p>TOLERANCES: DIMENSIONS ARE IN FEET [cm]</p> <p>FRACTIONAL ± 1/16(.16) FINISHED SURFACE RMS 63</p> <p>ANGULAR ± 1° BREAK CORNERS: .02</p> <p>TWO PLACE DECIMAL ± .01(.025) REMOVE ALL BURRS</p> <p>THREE PLACE DECIMAL ± .005(.013)</p>																																								
MATERIAL: 6061-T6 ALUM			HEAT TREAT: -			FINISH: -			A INITIAL RELEASE				K.MASDN 3/22/00																											
USED ON: -			NEXT ASS'Y: -			PRE-RELEASE			MASDN 6/25/98				MASDN 6/25/98																											
<table border="1"> <thead> <tr> <th>REV</th> <th>DESCRIPTION</th> <th>DCC</th> <th>SYS</th> <th>DET</th> <th>CDS</th> <th>VE</th> <th>CC</th> <th>BT</th> <th>CHECK</th> <th>DRWN</th> <th>DATE</th> <th>SCALE</th> <th>SHEET</th> </tr> </thead> <tbody> <tr> <td>00</td> <td>PRE-RELEASE</td> <td></td> <td></td> <td></td> <td></td> <td></td> <td></td> <td></td> <td></td> <td></td> <td></td> <td>1:2</td> <td>1 of 1</td> </tr> </tbody> </table>													REV	DESCRIPTION	DCC	SYS	DET	CDS	VE	CC	BT	CHECK	DRWN	DATE	SCALE	SHEET	00	PRE-RELEASE											1:2	1 of 1
REV	DESCRIPTION	DCC	SYS	DET	CDS	VE	CC	BT	CHECK	DRWN	DATE	SCALE	SHEET																											
00	PRE-RELEASE											1:2	1 of 1																											
<p>SCALE 1:2</p> <p>SHEET 1 of 1</p>																																								

CALIFORNIA INSTITUTE OF TECHNOLOGY  
 MASSACHUSETTS INSTITUTE OF TECHNOLOGY

VIEWPORT ADAPTER  
 CENTER  
 ISC TABLE ASSEMBLY

CAD FILE: D980338-A.dwg  
 SIZE: C  
 DWG. NO.: D980338-A-D