

- NOTES CONTINUED:
1. APPROXIMATE WEIGHT: 20.212 LBS.
 2. ASSEMBLE IN ACCORDANCE WITH SPECIFICATION E1100484.

REV.	DATE	DCN #	DRAWING TREE #
v1	5 OCT 2010	E1000185	E1000358
v2	12 MAY 2011	E1000360-v2	-
v3	30 DEC 2011	-	-

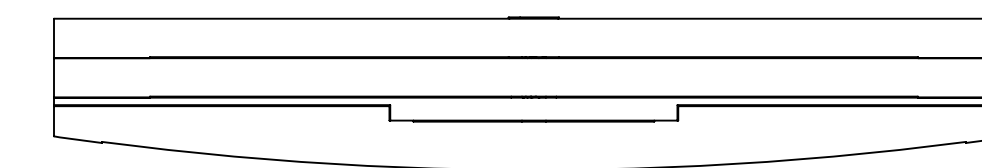
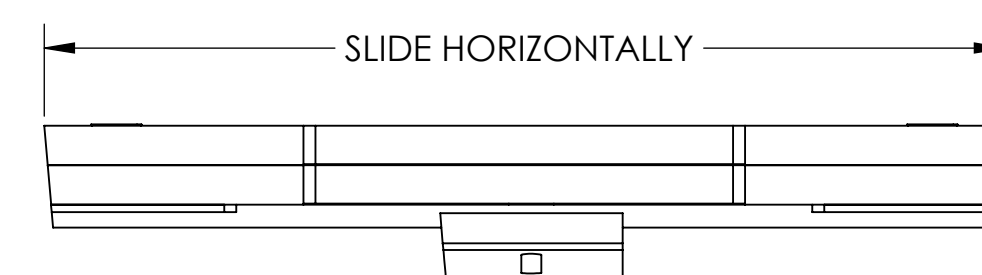
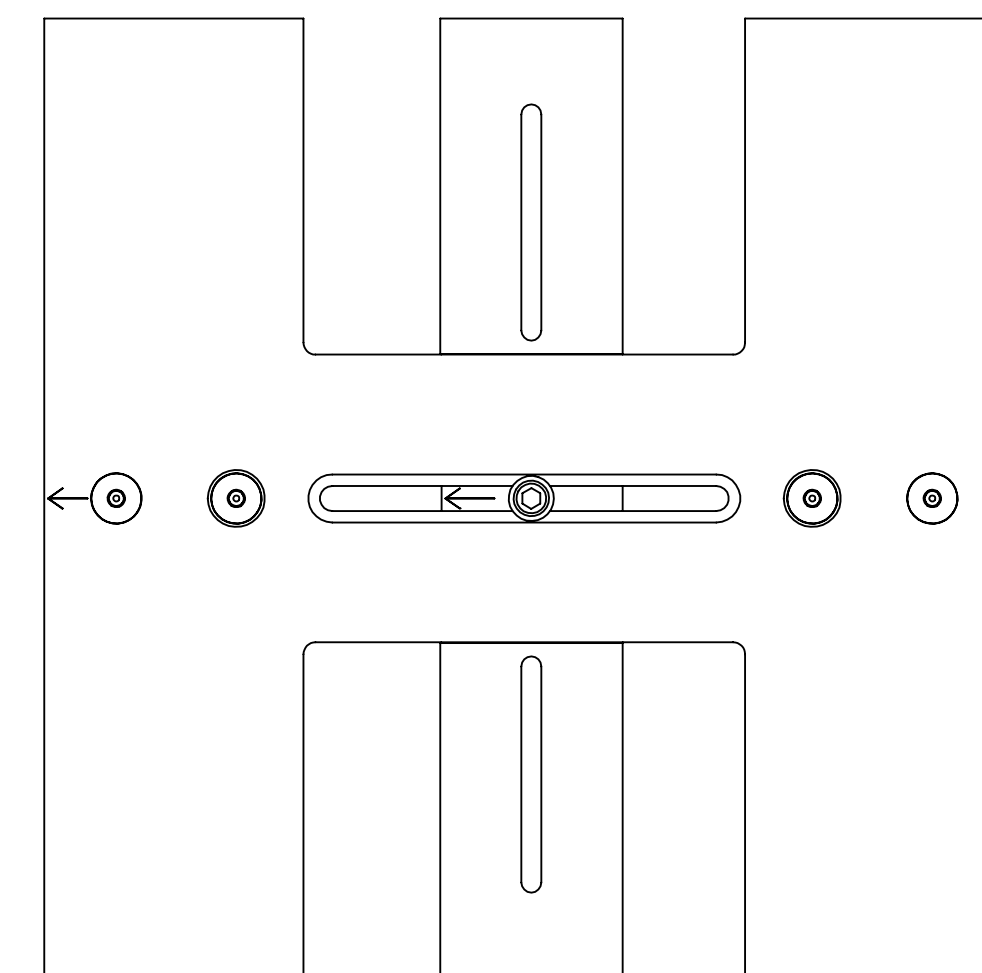
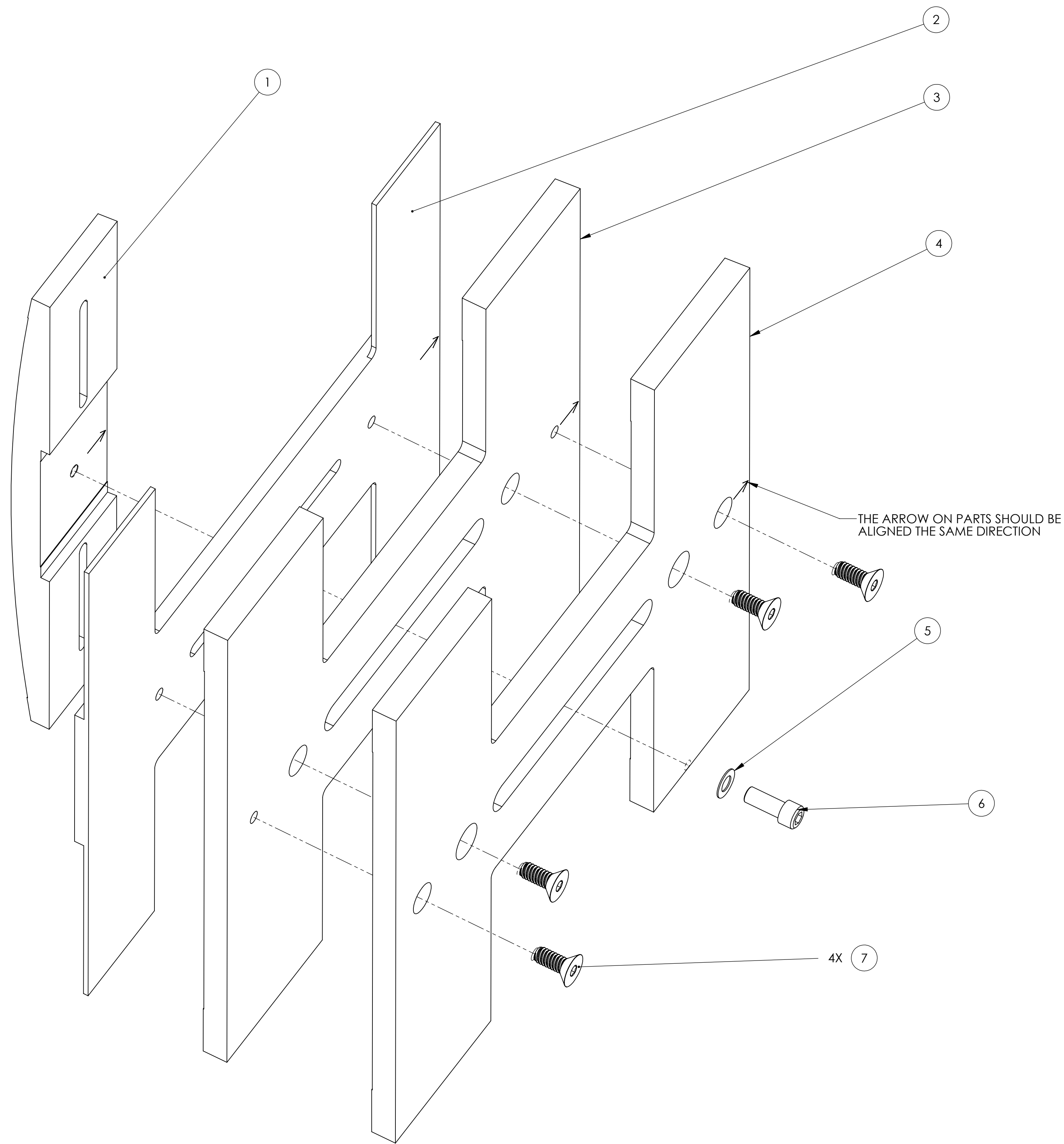

ITEM NO.	PART NUMBER	DESCRIPTION	MATERIAL	QTY.	SPARE	TOTAL
7	FA-2010-NA	FLAT HEAD SOCKET CAP SCREW, 1/4"-20 THRD, 5/8" L	Ag-PLATED 300 SSSL	4		0
6	C-2010-NA	SCREW, SOCKET HEAD CAP, 1/4-20 UNC-2A X 0.625 LONG, FULLY THREADED	Ag-PLATED 300 SSSL	1		0
5	WF-25	FLAT WASHER 1/4" Sz, .47" OD, .02"-.04" Thk, Dash No. C416	300 SSSL	1		0
4	D1002417	UPPER HORIZONTAL WEIGHT	304, 316 OR 302 SSSL	1		0
3	D1002418	MID HORIZONTAL WEIGHT	304, 316 OR 302 SSSL	1		0
2	D1002404	LOWER HORIZONTAL WEIGHT	304, 316 OR 302 SSSL	1		0
1	D1002403	VERTICAL WEIGHT	304, 316 OR 302 SSSL	1		0

DIMENSIONS ARE IN INCHES TOLERANCES: .XX ± .01 .XXX ± .005 ANGULAR ± 0.5°		NOTES AND TOLERANCES: (UNLESS OTHERWISE SPECIFIED) 1. INTERPRET DRAWING PER ASME Y14.5-1994. 2. REMOVE ALL SHARP EDGES, R.02 MIN. 3. DO NOT SCALE FROM DRAWING. 4. ALL MACHINING FLUIDS MUST BE FULLY SYNTHETIC, FULLY WATER SOLUBLE AND FREE OF SULFUR, SILICONE, AND CHLORINE.		CALIFORNIA INSTITUTE OF TECHNOLOGY MASSACHUSETTS INSTITUTE OF TECHNOLOGY		PART NAME BALANCE WEIGHT ASSEMBLY	
MATERIAL N/A		FINISH N/A μinch		NEXT ASSY D0902617		DESIGNER TQ. NGUYEN 15 SEPT 2010 DRAFTER TQ. NGUYEN 21 SEPT 2010 CHECKER M. SMITH 27 SEP 2010 APPROVAL D. COYNE	
SYSTEM ADVANCED LIGO				SUB-SYSTEM AOS		SIZE DWG. NO. D D1002402	
				SCALE: 1:2		PROJECTION:	
						SHEET 1 OF 1	

D:\002402_d\UGO_Monfield_Cryo_Baffle_Balance_Weightl Assy_PART PDM_REV-X.002_DRAWING PDM_REV-X.016