

8 7 6 5 4 3 2 1

REVISIONS			
REV.	DESCRIPTION	DATE	APPROVED

D

D

C

C

B

B

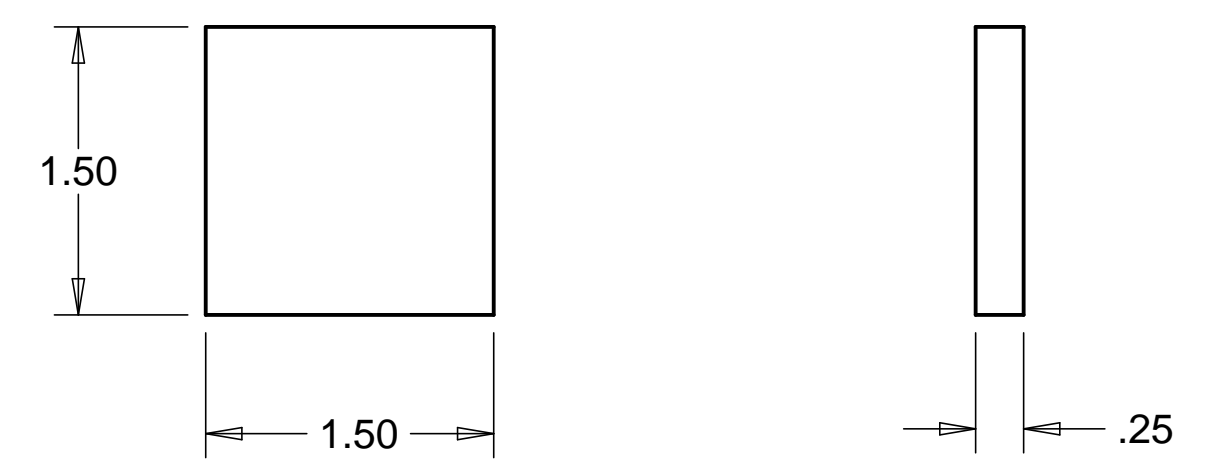

MATL: 303 SST

NOTES: UNLESS OTHERWISE SPECIFIED

- ALL DIMENSIONS IN INCHES
- DIMENSIONS AND TOLERANCING PER ASME Y14.5M-1994
- SURFACE TEXTURE PER ANSI/ASME B 46.1-1985
- REMOVE ALL BURRS AND BREAK SHARP EDGES TO A MAXIMUM OF .015
- ALL INSIDE CORNERS TO BE .015 RADIUS MAX
- COUNTERSINK 82 DEGREES ALL TAPPED HOLES TO MAJOR DIAMETER
- COUNTERSINK 82 DEGREES APPROXIMATELY .015 DEEP ALL DRILLED HOLES
- PARTS TO BE THOROUGHLY CLEANED TO REMOVE ALL OIL, GREASE, DIRT AND CHIPS
- PART NUMBER (DRAWING NO. PLUS DASH NO. PLUS SERIAL NO. ) TO BE CLEARLY MARKED ON THE PART ITSELF.
- PART WEIGHS .16 Lbs.

PARTS LIST

UNLESS OTHERWISE SPECIFIED: DIMENSIONS ARE IN INCHES -TOLERANCES-	CAD GENERATED DRAWING, DO NOT MANUALLY UPDATE DO NOT SCALE DRAWING		<b>HYTEC, INC</b>	
	DECIMALS .XX = +/- .06 .XXX = +/- .010		ANGULAR = +/- 30' SURFACE FINISH = 250	
FINISH	SIGNATURE	DATE	TITLE	
DESIGNED	W. K. MILLER	12/19/97	HAM CROSSBEAM BRACKET SHIM	
DRAWN	W. K. MILLER	12/19/97	DWG. NO.	SIZE SHEET NO.
CHECKED	HARRY SALAZAR	2/6/98	D972927	D 1 of 1
ENGR.	T. THOMPSON	2/6/98	SCALE 1/1	REVISION
APPROVED	T. THOMPSON	2/6/98		
PART NO. <b>D972927-1</b>				

A

A

8 7 6 5 4 3 2 1