

8 7 6 5 4 3 2 1

REVISIONS			
REV.	DESCRIPTION	DATE	APPROVED
A	SEE ECN# D972714-A FOR CHANGE LIST	11-03-97	T. THOMPSON

D

D

C

C

B

B

A

A

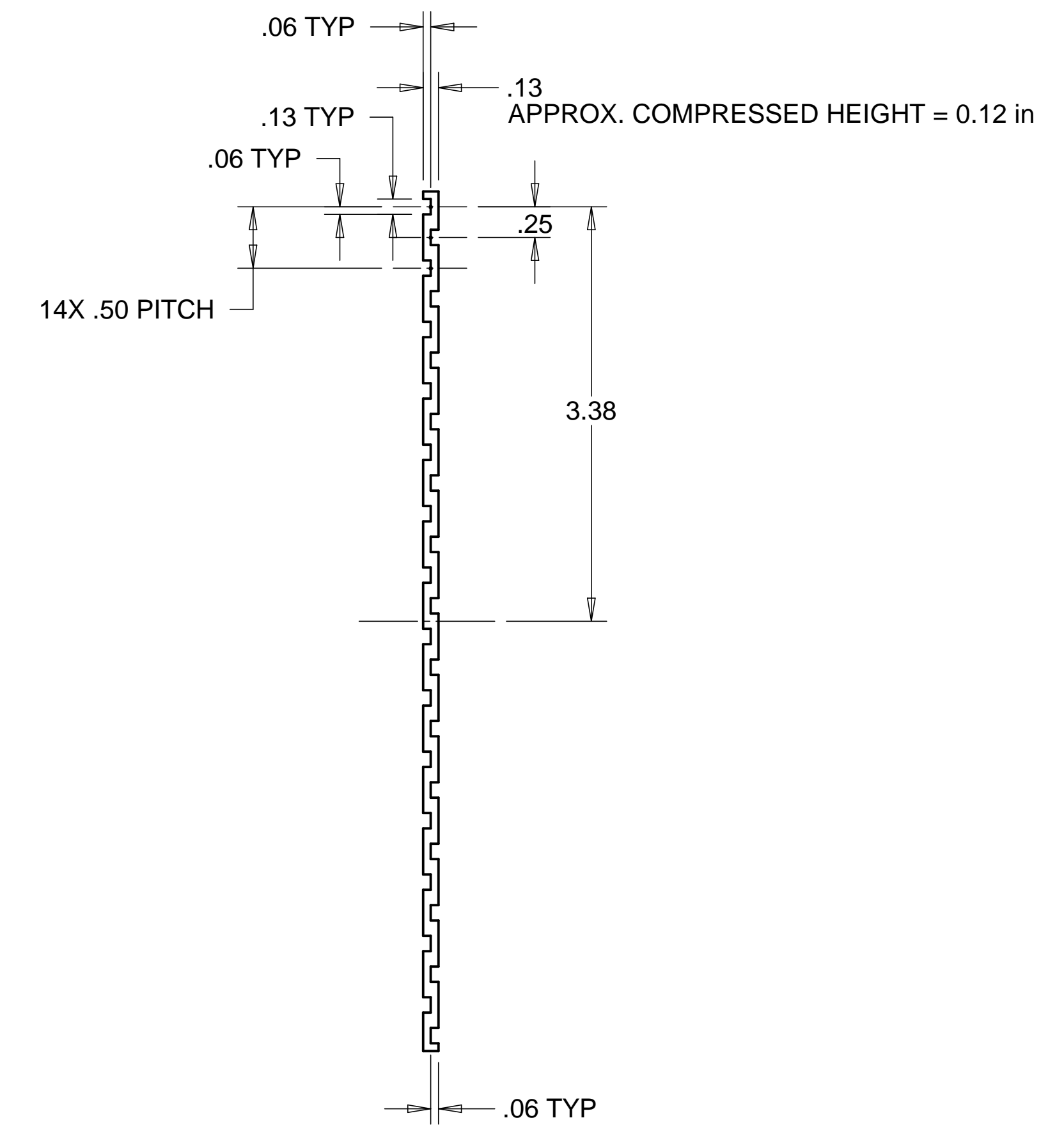
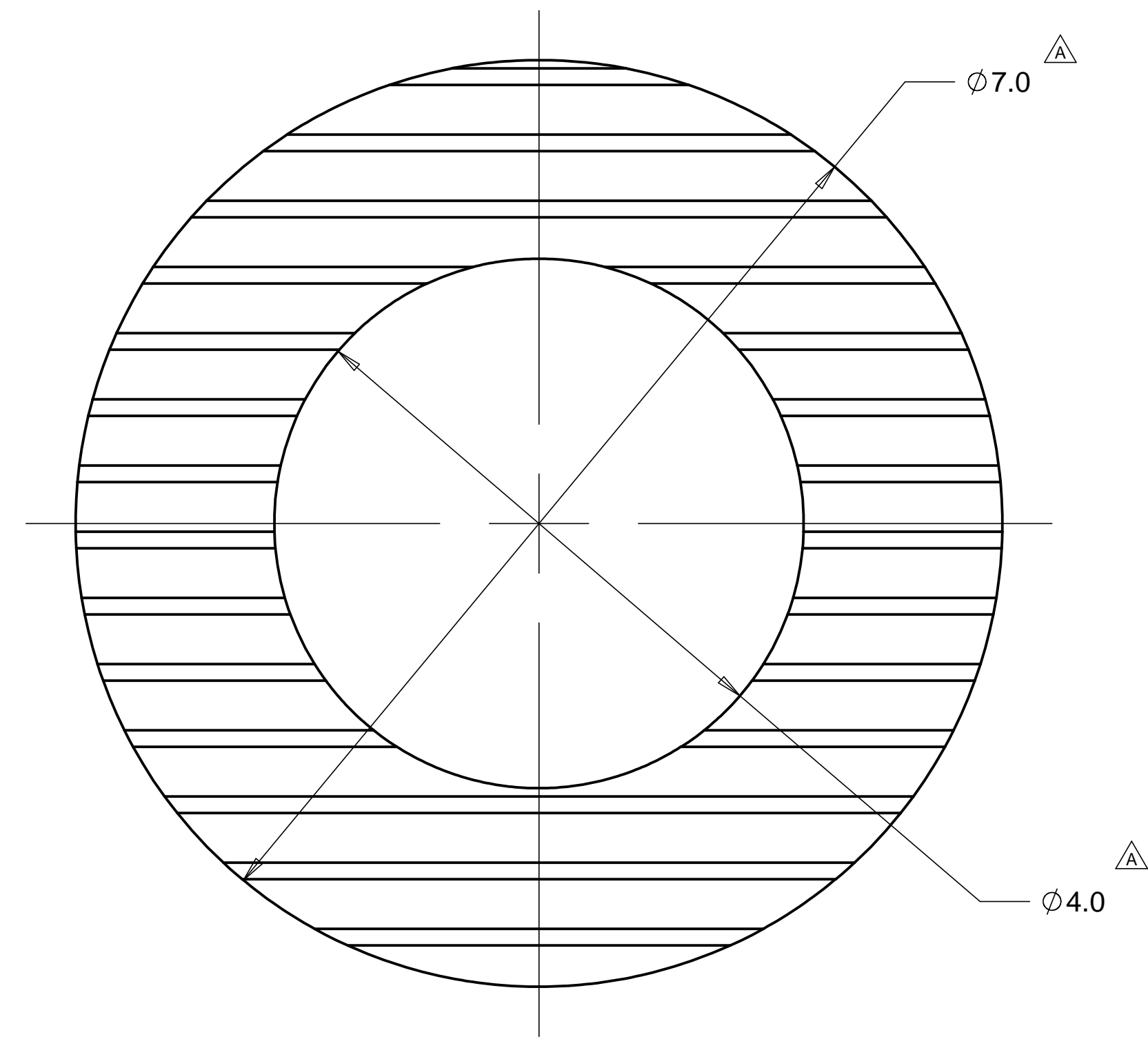

MATL: FLUOREL FORMULATION 2180

△ WEIGHT: 0.17 lbs.

NOTES: UNLESS OTHERWISE SPECIFIED

- ALL DIMENSIONS IN INCHES
- DIMENSIONS AND TOLERANCING PER ASME Y14.5M-1994
- SURFACE TEXTURE PER ANSI/ASME B 46.1-1985
- REMOVE ALL BURRS AND BREAK SHARP EDGES TO A MAXIMUM OF .015
- ALL INSIDE CORNERS TO BE .015 RADIUS MAX
- COUNTERSINK 82 DEGREES ALL TAPPED HOLES TO MAJOR DIAMETER
- COUNTERSINK 82 DEGREES APPROXIMATELY .015 DEEP ALL DRILLED HOLES
- PARTS TO BE THOROUGHLY CLEANED TO REMOVE ALL OIL, GREASE, DIRT AND CHIPS
- ALL FABRICATION, CLEANING, AND HANDLING MAINTAINED TO HYTEC SPECIFICATION: LIGO-TS-03 CATEGORY 1.
- NO SULFUR BASED CUTTING FLUIDS ALLOWED.

PARTS LIST														
UNLESS OTHERWISE SPECIFIED: DIMENSIONS ARE IN INCHES -TOLERANCES- DECIMALS ANGULAR = +/- 30' .X = +/- .1 .XX = +/- .03 .XXX = +/- .010 SURFACE FINISH = 250	CAD GENERATED DRAWING, DO NOT MANUALLY UPDATE DO NOT SCALE DRAWING		HYTEC, INC TITLE LIGO ISOLATION STACK FLUOREL SHIM											
			FINISH PART NO. D972714-1	<table border="1"> <tr> <th>SIGNATURE</th> <th>DATE</th> </tr> <tr> <td>DESIGNED ROGER L. SMITH</td> <td>5-28-97</td> </tr> <tr> <td>DRAWN ROGER L. SMITH</td> <td>5-28-97</td> </tr> <tr> <td>CHECKED HARRY SALAZAR</td> <td>7-14-97</td> </tr> <tr> <td>ENGR. T. THOMPSON</td> <td>7-14-97</td> </tr> <tr> <td>APPROVED T. THOMPSON</td> <td>7-14-97</td> </tr> </table>	SIGNATURE	DATE	DESIGNED ROGER L. SMITH	5-28-97	DRAWN ROGER L. SMITH	5-28-97	CHECKED HARRY SALAZAR	7-14-97	ENGR. T. THOMPSON	7-14-97
SIGNATURE	DATE													
DESIGNED ROGER L. SMITH	5-28-97													
DRAWN ROGER L. SMITH	5-28-97													
CHECKED HARRY SALAZAR	7-14-97													
ENGR. T. THOMPSON	7-14-97													
APPROVED T. THOMPSON	7-14-97													
SCALE 1/1		REVISION A												

8 7 6 5 4 3 2 1