

8 7 6 5 4 3 2 1

REVISIONS			
REV.	DESCRIPTION	DATE	APPROVED
A	SEE ECN# D972135-A FOR CHANGE LIST	11-03-97	T. THOMPSON
B	SEE ECN# D972135-B FOR CHANGE LIST	01-23-98	T. THOMPSON

D

D

C

C

B

B

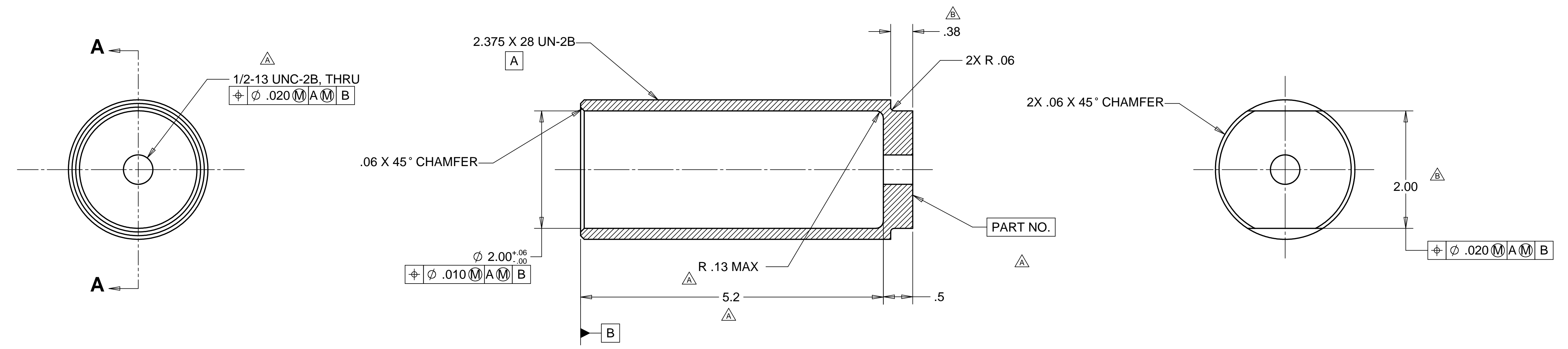

SECTION A-A

MATL: 303 STAINLESS STEEL
WEIGHT: 2.5 lbs.

NOTES: UNLESS OTHERWISE SPECIFIED

- ALL DIMENSIONS IN INCHES
- DIMENSIONS AND TOLERANCING PER ASME Y14.5M-1994
- SURFACE TEXTURE PER ANSI/ASME B 46.1-1985
- REMOVE ALL BURRS AND BREAK SHARP EDGES TO A MAXIMUM OF .015
- ALL INSIDE CORNERS TO BE .015 RADIUS MAX
- COUNTERSINK 82 DEGREES ALL TAPPED HOLES TO MAJOR DIAMETER
- COUNTERSINK 82 DEGREES APPROXIMATELY .015 DEEP ALL DRILLED HOLES
- PARTS TO BE THOROUGHLY CLEANED TO REMOVE ALL OIL, GREASE, DIRT AND CHIPS
- PART NUMBER (DRAWING NO. PLUS DASH NO. PLUS SERIAL NO.) TO BE CLEARLY MARKED ON THE PART.

PARTS LIST			
UNLESS OTHERWISE SPECIFIED: DIMENSIONS ARE IN INCHES -TOLERANCES-	CAD GENERATED DRAWING, DO NOT MANUALLY UPDATE DO NOT SCALE DRAWING		HYTEC, INC TITLE LIGO SCISSOR TABLE SPRING CUP
	DECIMALS .X = +/- .1 .XX = +/- .03 .XXX = +/- .010	ANGULAR = +/- .30' SURFACE FINISH = 250	
FINISH	SIGNATURE	DATE	SIZE SHEET NO.
	ROGER L. SMITH	5-28-97	D 1 of 1
	ROGER L. SMITH	5-28-97	
	HARRY SALAZAR	8-5-97	
	T. THOMPSON	8-6-97	
PART NO. D972135-1	APPROVED T. THOMPSON	8-6-97	SCALE 1/1 REVISION B

8 7 6 5 4 3 2 1

A

A