

REV.	DATE	DCN #	DRAWING TREE #
v1	9 Apr. 2011	E1100015	E1100016

NOTES CONTINUED:

4. ALL MACHINING FLUIDS MUST BE FULLY SYNTHETIC, FULLY WATER SOLUBLE AND FREE OF SULFUR, SILICONE AND CHLORINE.
5. SCRIBE, ENGRAVE, OR MECHANICALLY STAMP (NO INKS OR DYES) DRAWING PART NUMBER, REVISION (AND VARIANT OR "TYPE" IF APPLICABLE ON NOTED SURFACE OF PART FOLLOWED ON THE NEXT LINE WITH A THREE DIGIT SERIAL NUMBER. SERIAL NUMBERS START AT 001 FOR THE FIRST ARTICLE AND PROCEED CONSECUTIVELY. USE MINIMUM 0.12 HIGH CHARACTERS, UNLESS THE SIZE OF THE PART DICTATES SMALLER CHARACTERS. A VIBRATORY TOOL MAY BE USED. EXAMPLE DXXXXXXX-VY, TYPE-XX, S/N XXX.
6. APPROXIMATE WEIGHT = 20.622 LB.
7. ALL PARTS SHALL BE MANUFACTURED IN ACCORDANCE WITH LIGO SPECIFICATION E0900364.
8. ALLOWABLE DRAFT ANGLE 2° MAX. DIMENSIONS FROM MAX DRAFT MATERIAL.

D
C
B
A

D
C
B
A

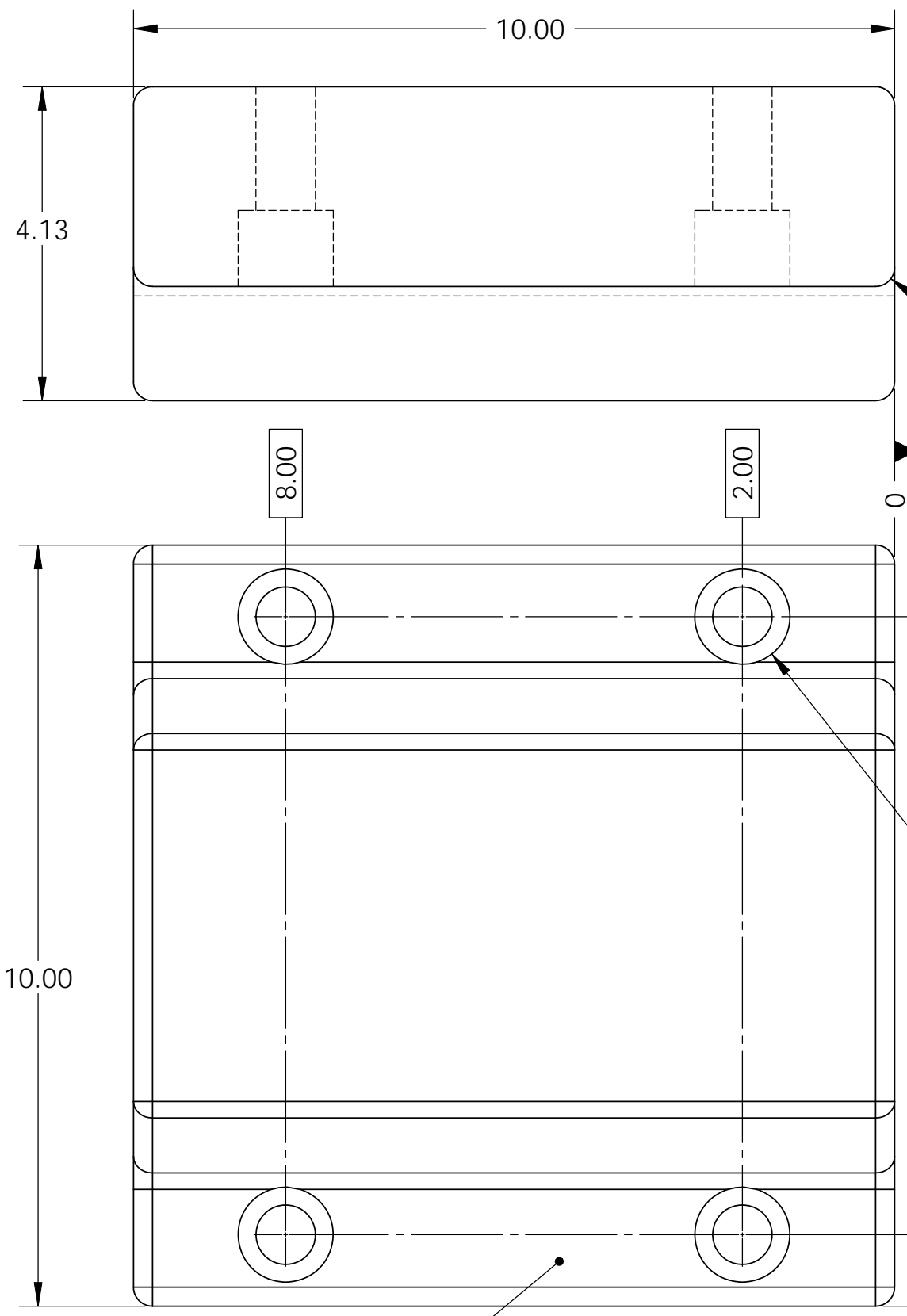
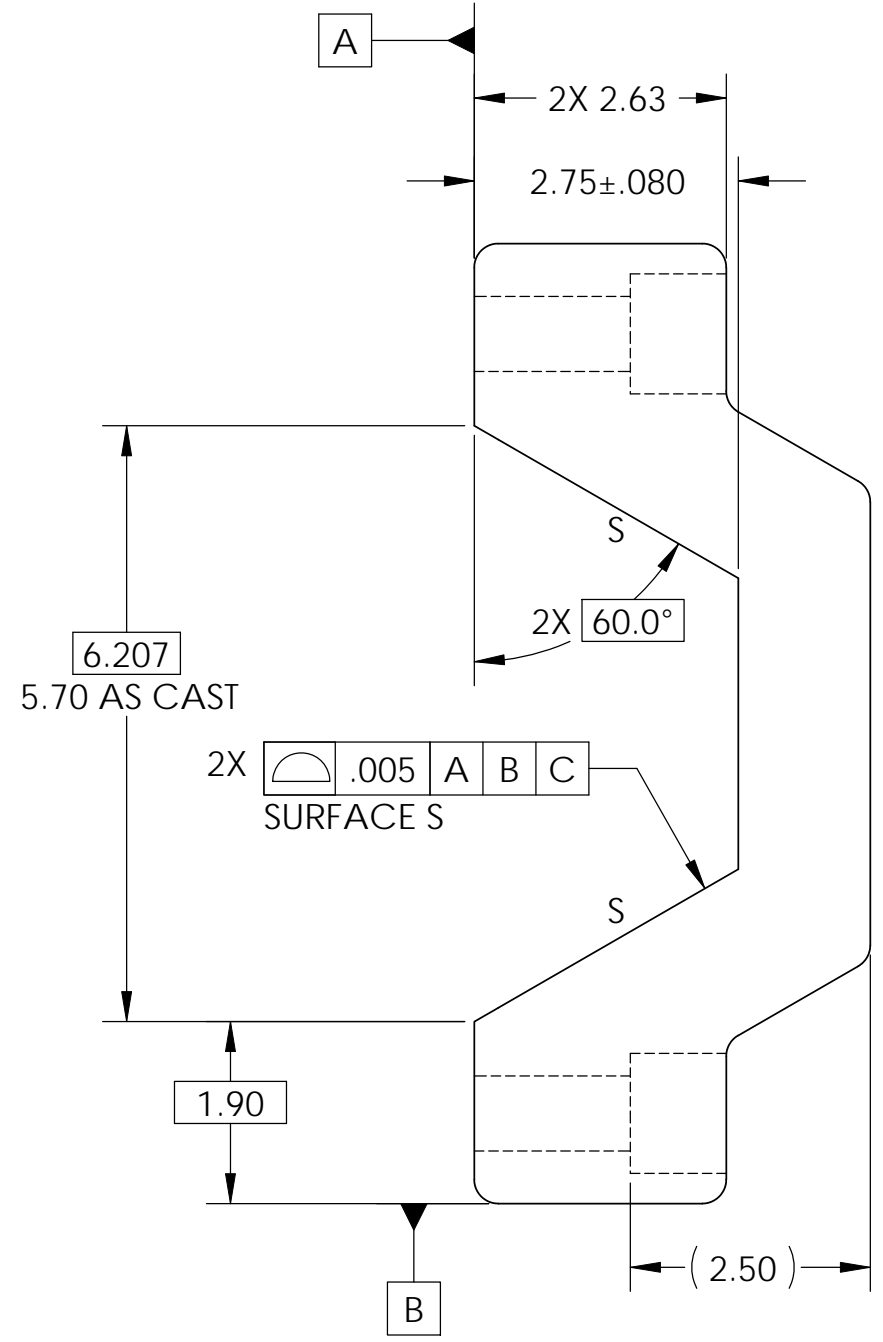

R.3 TYP.

9.060

4X ϕ .781^{+0.005}/_{-.002} THRU ALL

\square ϕ 1.25 ∇ 2.50

ϕ .012 (M) A B C

.940

5

D972124, PART PDM REV: X-005, DRAWING PDM REV: X-000

NOTES AND TOLERANCES: (UNLESS OTHERWISE SPECIFIED)				LIGO CALIFORNIA INSTITUTE OF TECHNOLOGY MASSACHUSETTS INSTITUTE OF TECHNOLOGY				PART NAME			
DIMENSIONS ARE IN INCHES				1. INTERPRET DRAWING PER ASME Y14.5-1994.				Ligo BSC Support Tube Mnt Cap			
TOLERANCES: .XX ± .015 .XXX ± .005				2. REMOVE ALL SHARP EDGES, .03 x 45°.				DESIGNER R.SMITH 29 May 1997			
ANGULAR ± .5°				3. DO NOT SCALE FROM DRAWING.				DRAFTER M.HILLARD			
MATERIAL A356-T6				FINISH 63 μ inch				NEXT ASSY D1100612			
								CHECKER 9 Apr. 2011 10 July 1997			
								APPROVAL K.MASON 9 Apr. 2011			
								SIZE DWG. NO. B D972124			
								REV. v1			
								SCALE: 1:2 PROJECTION: ϕ SHEET 1 OF 1			

8 7 6 5 4 3 2 1