

END STATION, Y-ARM
BSC 5

- NOTES:
1. ANNULUS ION PUMPS ARE NOT SHOWN IN PROPER LOCATIONS (TO BE MOVED TO +Y SIDE OF VACUUM MANIFOLD).
 2. MOVABLE CROSS-DIVER STILE NOT SHOWN.
 3. DETECTOR ASC SUBSYSTEM COMPONENTS NOT SHOWN.
 4. NOT SHOWN YET IN ELEVATION:
 - CLEAN ROOM
 - PIPING UNDER VACUUM MANIFOLD

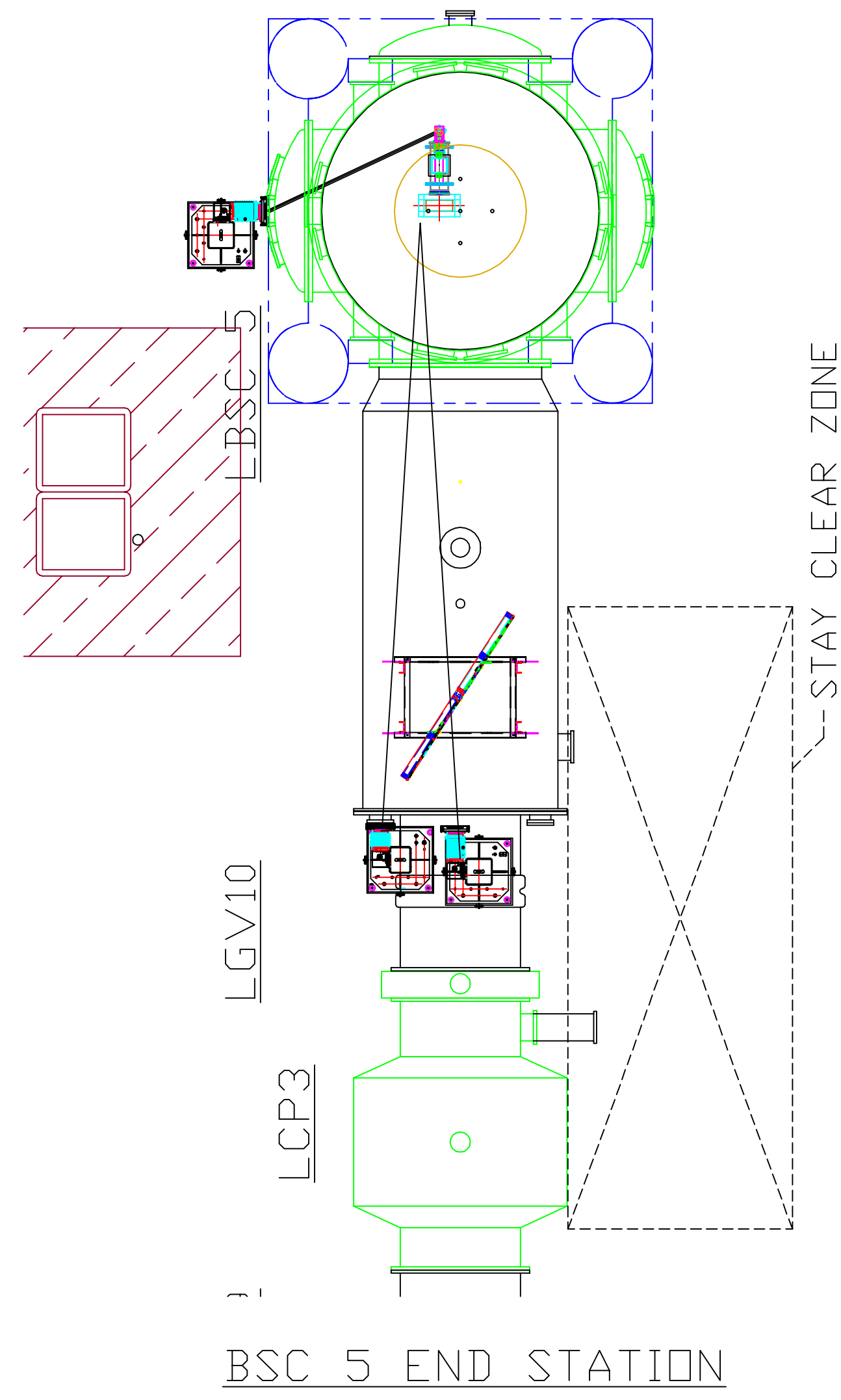

BSC 5 END STATION

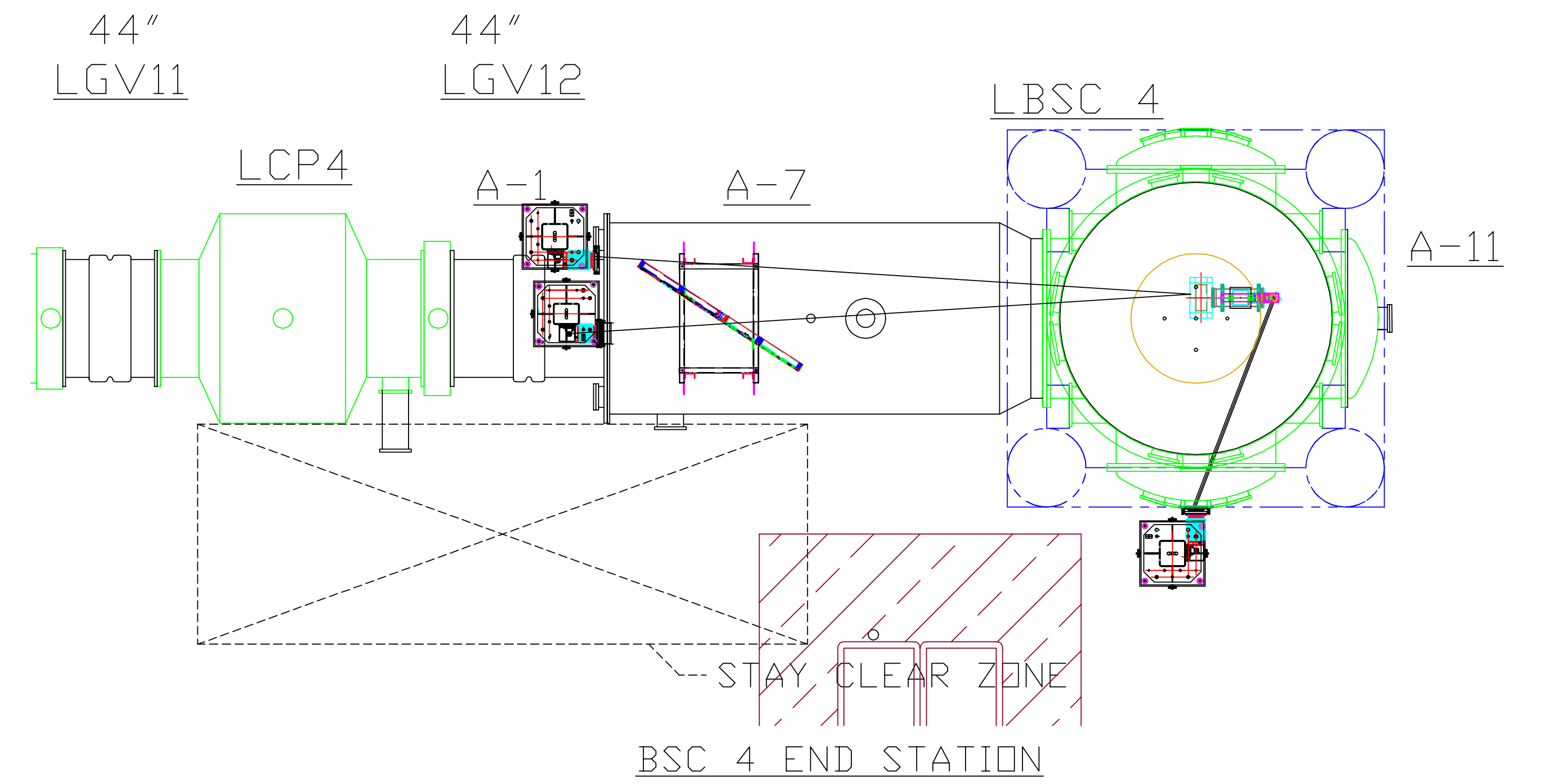

BSC 4 END STATION

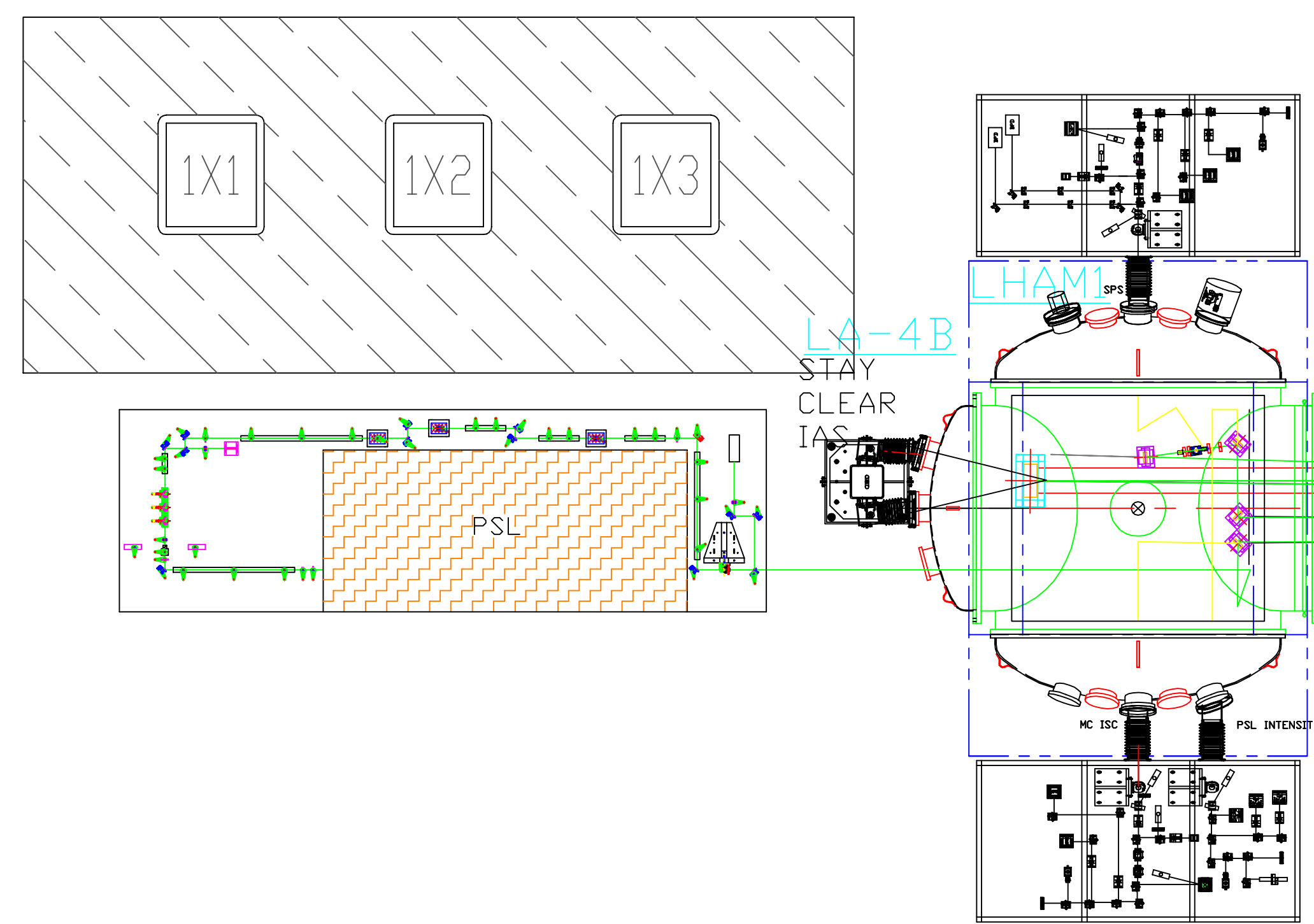

PSL #1, HAM 1
4 K INPUT LASER

CORNER STATION

END STATION, X-ARM
BSC 4

UNLESS OTHERWISE SPECIFIED DIMENSIONS ARE IN FEET (mm)		TOLERANCES:		FRAC TIONAL		ANGULAR		HATCH		TEXT		SCALE	
		± 0.005		± 0.005		± 0.005		± 0.005		± 0.005		± 0.005	
DWG. NO.	DESCRIPTION	DWG. NO.	DESCRIPTION	REV	DESCRIPTION	ISSUE DESCRIPTION	DCN NUMBER	DATE	DRWN	DATE	SCALE	SHEET	1 OF 4

LIGO CALIFORNIA INSTITUTE OF TECHNOLOGY
MASSACHUSETTS INSTITUTE OF TECHNOLOGY

INTERFEROMETER OPTOMECHANICAL LAYOUT
LIVINGSTON SITE-PLAN VIEW
TOTAL VACUUM EQUIPMENT AREA (LVEA & VEA)
CORNER (VERTEX) & END STATIONS

CAD FILE: D970610-A-sl.dwg
SIZE: E
DWG. NO.: D970610-A

- NOTES:
1. NOT SHOWN YET IN ELEVATION:
- CLEAN ROOMS
- PIPING UNDER VACUUM MANIFOLD
 2. ONLY SET EXTERNAL ENVELOPE AND OPTICS TABLES ARE SHOWN AROUND EACH CHAMBER.

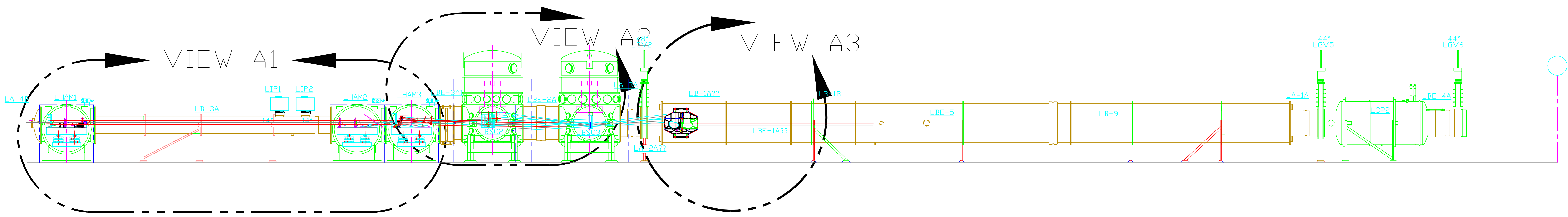

ELEVATION "A-A" SEE D970610, SHEET 1
VERTEX X-BEAM MANIFOLD

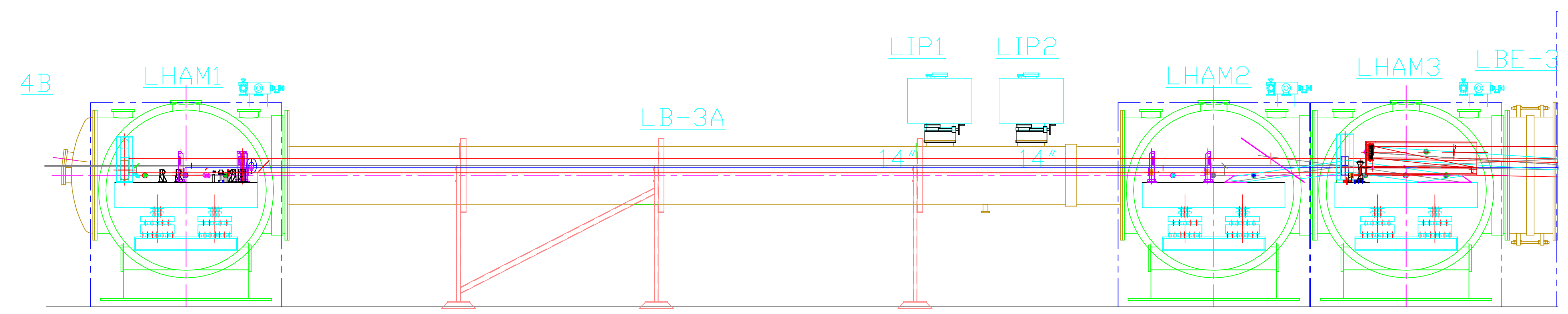

VIEW A1

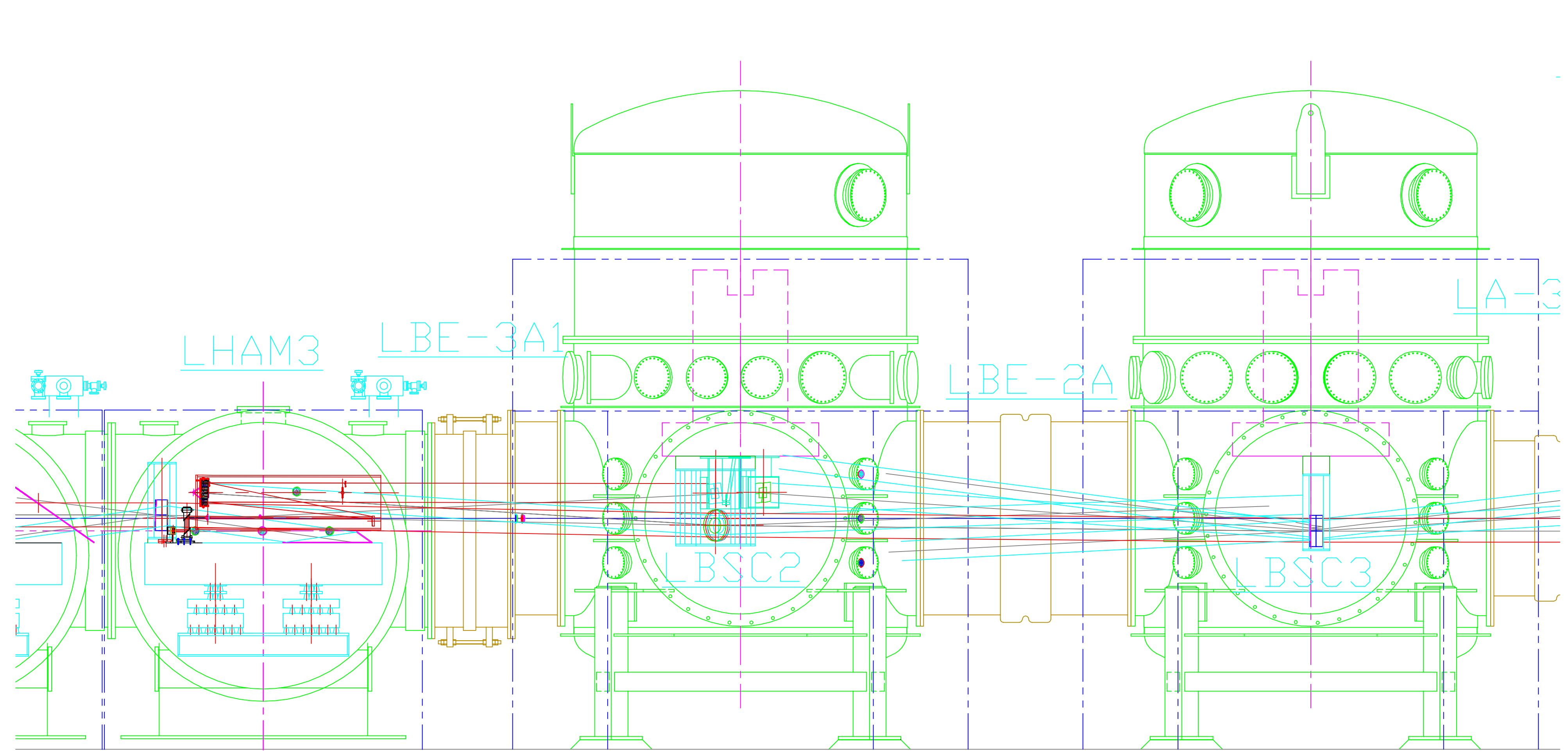

VIEW A2

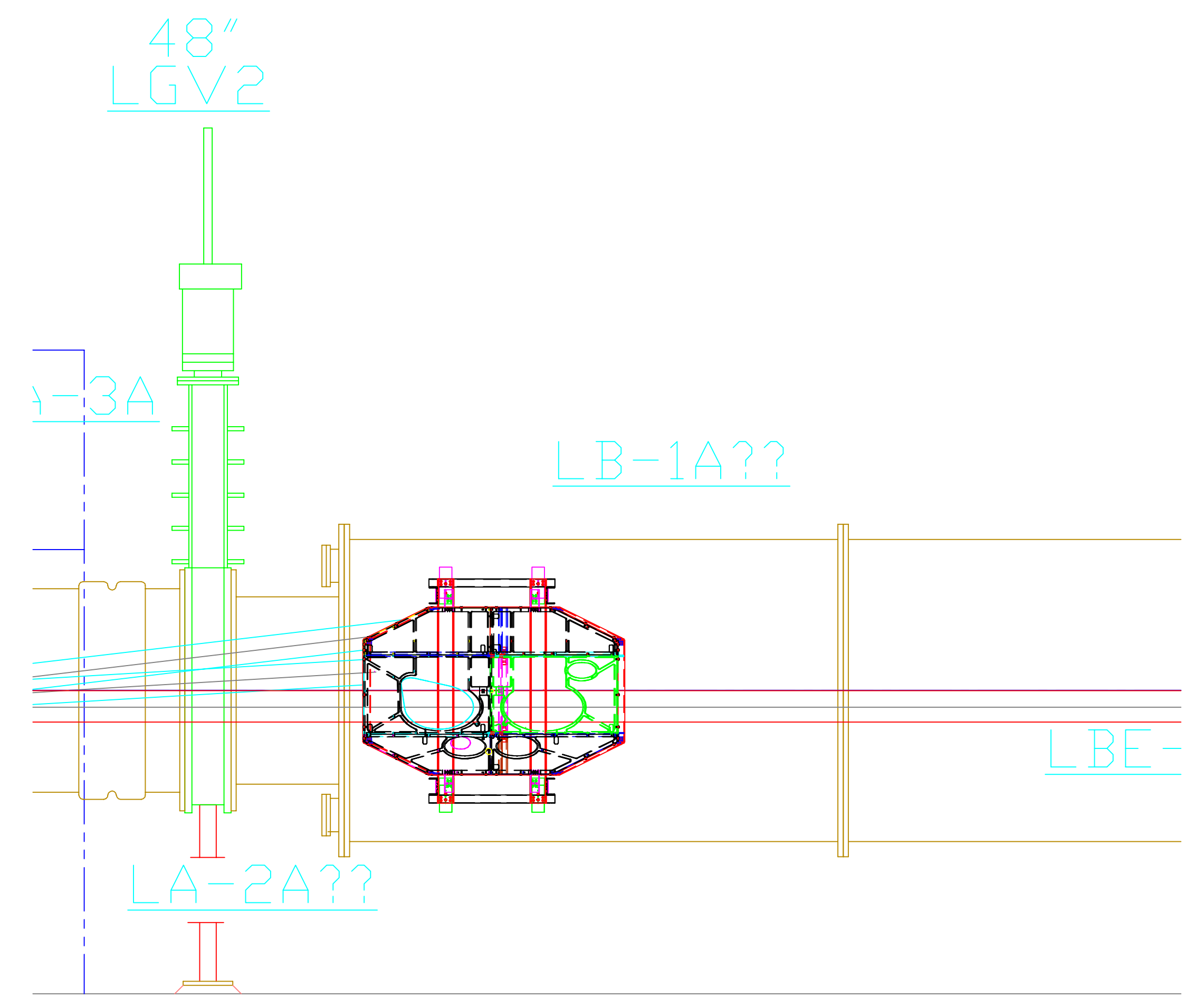

VIEW A3

				UNLESS OTHERWISE SPECIFIED DIMENSIONS ARE IN FEET (in) TOLERANCES: FRACTIONAL # ANGULAR APPROX # BEND # TWO PLACE DECIMAL # THREE PLACE DECIMAL # FINISHED SURFACE RING BREAK CORNERS IN REMOVE ALL BURRS											
DWG. NO.				DESCRIPTION				DWG. NO.				DESCRIPTION			
REFERENCE DRAWINGS								DO NOT SCALE THIS DRAWING				USED ON:			
				NEXT ASS'Y:				REV				A			
								RELEASE				E99011			
								DESCRIPTION				DCN NUMBER			
								ISSUE DESCRIPTION				SCALE			
												NTS			
												SHEET 3 OF 4			
												<p>LIGO CALIFORNIA INSTITUTE OF TECHNOLOGY MASSACHUSETTS INSTITUTE OF TECHNOLOGY</p> <p>INTERFEROMETER OPTOMECHANICAL LAYOUT LIVINGSTON SITE-ELEVATION VIEW LASER VACUUM EQUIPMENT AREA (LVEA) VERTEX X-BEAM MANIFOLD</p> <p>CAD FILE: D970610-A-3.dwg SIZE: E DWG NO: D970610-A SHEET 3 OF 4</p>			

- NOTES:
1. NOT SHOWN YET IN ELEVATION
 - CLEAN ROOMS
 - PIPING UNDER VACUUM MANIFOLD
 2. ONLY SEI EXTERNAL ENVELOPE AND OPTICS TABLES ARE SHOWN AROUND EACH CHAMBER

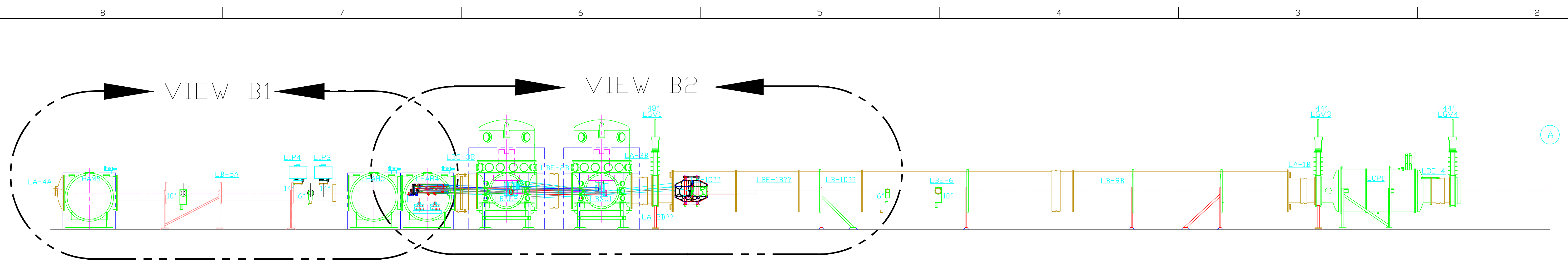

ELEVATION "B-B" SEE D970610 SHEET 1
 VERTEX Y-BEAM MANIFOLD

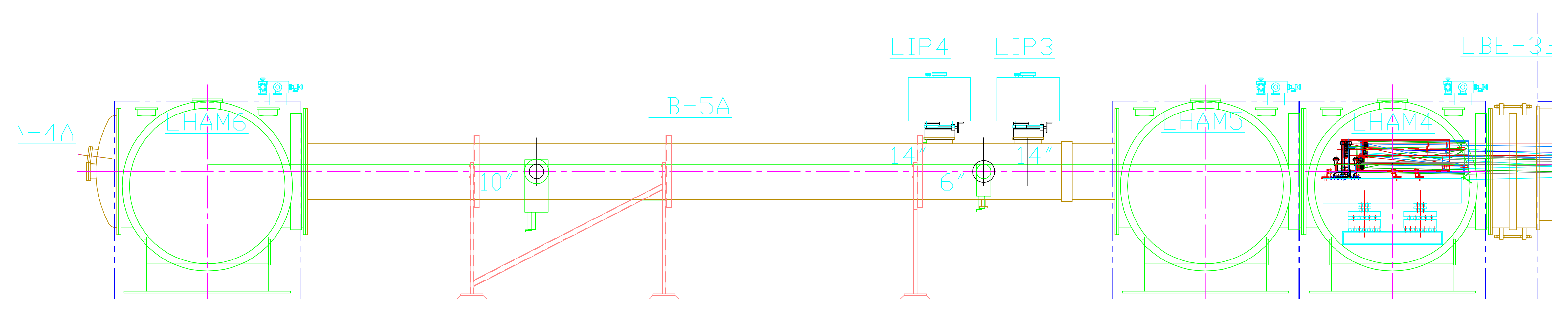

VIEW B1

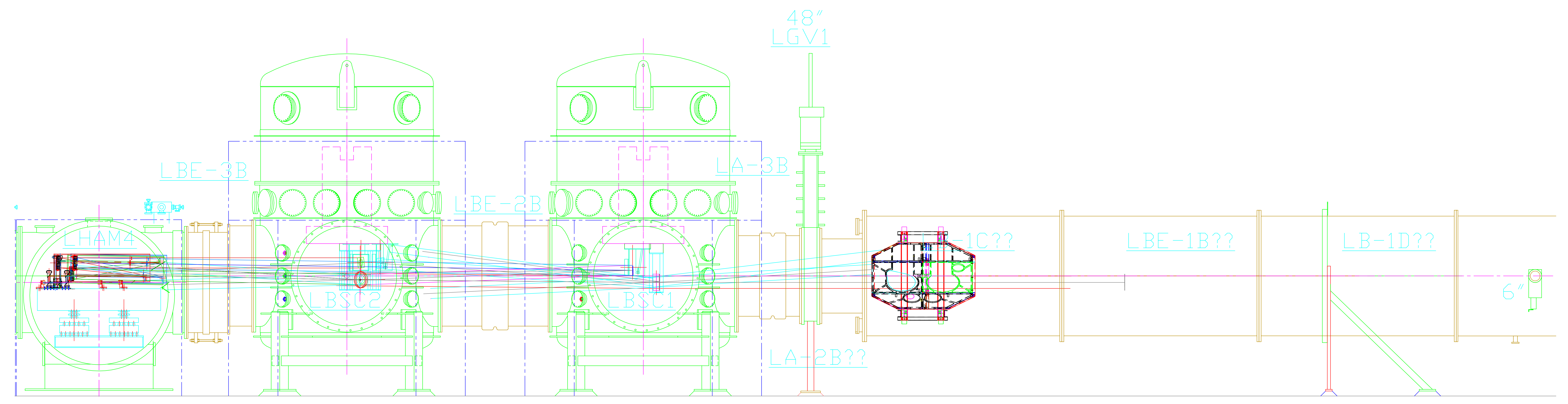

VIEW B2

UNLESS OTHERWISE SPECIFIED DIMENSIONS ARE IN FEET (x=)		E990111		KABOT 2-16-99		LIGO CALIFORNIA INSTITUTE OF TECHNOLOGY MASSACHUSETTS INSTITUTE OF TECHNOLOGY	
TOLERANCES: FRACTIONAL # ANGULAR APPROX # BEND # THREE PLACE DECIMAL # FINISHED SURFACE DIMS BREAK CORNERS IN REMOVE ALL DIMS		DO NOT SCALE THIS DRAWING		A		INTERFEROMETER OPTOMECHANICAL LAYOUT LIVINGSTON SITE-ELEVATION VIEW LASER VACUUM EQUIPMENT AREA (LVEA) VERTEX Y-BEAM MANIFOLD	
USED DN		REV		RELEASE		CAD FILE D970610-A-4.dwg	
NEXT ASS'Y:		DESCRIPTION		ISSUE DESCRIPTION		SIZE E	
DWG. NO.		DESCRIPTION		DCN NUMBER		D970610-A	
REFERENCE DRAWINGS		SCALE		NTS		SHEET 4 OF 4	