

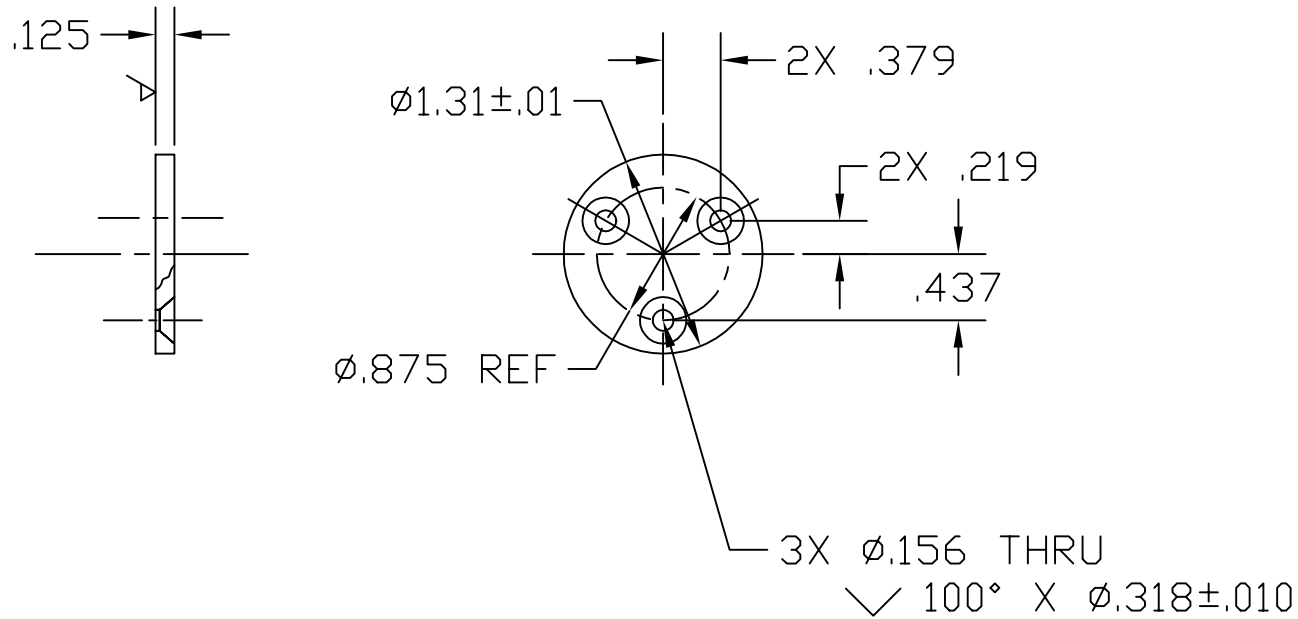

NOTES: (UNLESS OTHERWISE SPECIFIED)
 1. INTERPRET DRAWING PER ANSI Y14.5M-1982
 MATERIAL:
 6061 ALU, .125 PLATE PER QQ-A-250/11
 OR Ø1.312 BAR PER QQ-A-225/8



UNLESS OTHERWISE SPECIFIED
 DIMENSIONS ARE IN INCHES

TOLERANCES:
 FRACTIONAL ±
 ANGULAR ± 0.5°
 ANGULAR MACH ± BEND ±
 TWO PLACE DECIMAL ± .03

THREE PLACE DECIMAL ± .005
 FINISHED SURFACE 32 MICRINCH AVERAGE
 BREAK CORNERS IN: OUT: .005-.010
 REMOVE ALL BURRS

MATERIAL:  HEAT TREAT: T6 PER AMS 2770

FINISH:

USED ON: NEXT ASS'Y: D961460/D961461

REV	DESCRIPTION	DCC	SYS	DET	CDS	VE	CC	BT	CHECK	DRWN	DATE
A	DCN E960157										
00	RELEASE FOR FAB								KABOT		1-27-97

LIGO CALIFORNIA INSTITUTE OF TECHNOLOGY
 MASSACHUSETTS INSTITUTE OF TECHNOLOGY

CORE OPTIC COMPONENT CARRIER
 SEAL PLATE

CAD FILE: D970061-A.dwg SIZE: A DWG. NO.: D970061-A-D

SCALE: NTS SHEET: 1 OF 1

ISSUE DESCRIPTION