

STA 114+00.00

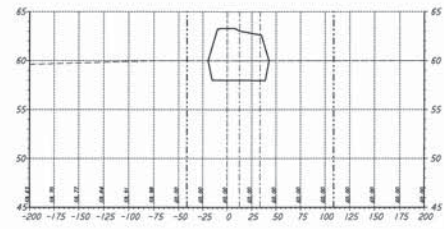

STA 122+00.00

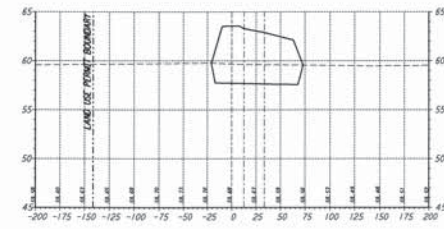

STA 130+00.00

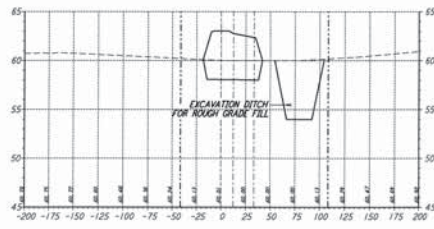

STA 112+00.00

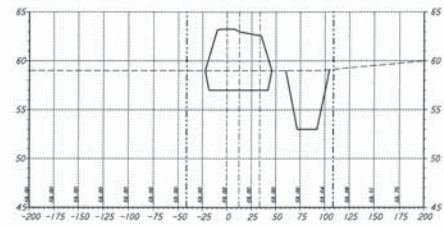

STA 120+00.00

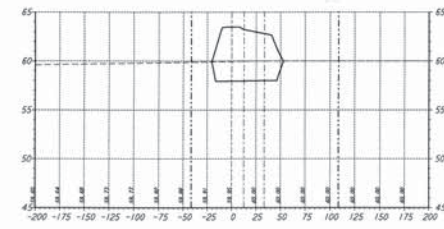

STA 128+00.00

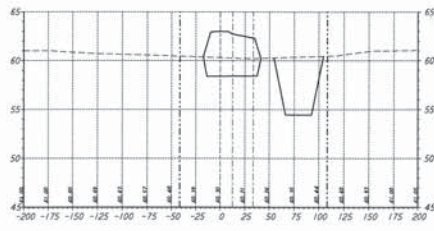

STA 110+00.00

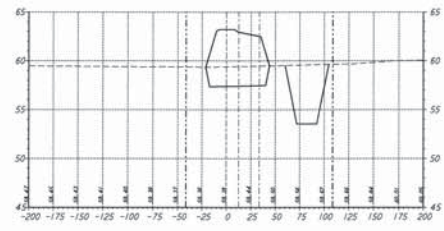

STA 118+00.00

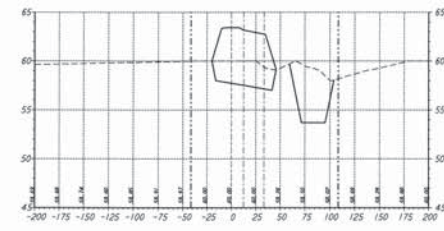

STA 126+00.00

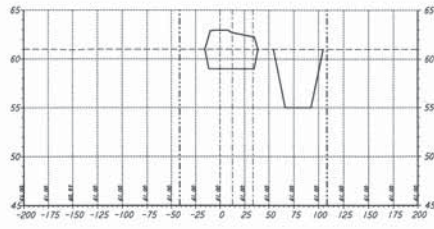

STA 108+00.00

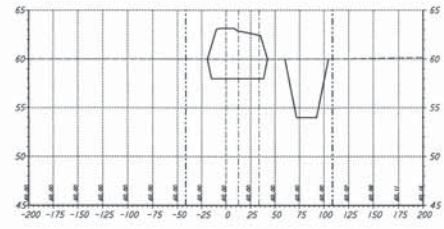

STA 116+00.00

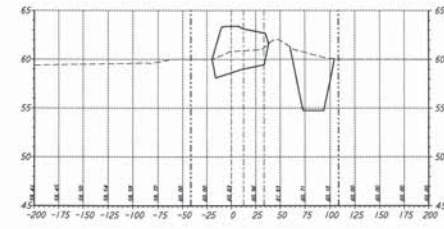

STA 124+00.00

NOTES:
 1. SEE SHEET RG-C-002 FOR GENERAL NOTES, LEGEND AND ABBREVIATIONS.
 2. CALLOUTS TYPICAL FOR ALL SECTIONS UNLESS OTHERWISE NOTED.

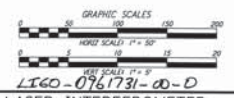

NO.	DATE	APPRO BY	DESCRIPTION OF REVISION	NO.	DATE	APPRO BY	ISSUED FOR
1	8/28/95	Tom	ISSUED FOR BID	1	8/28/95	Tom	ISSUED FOR BID

DATE	8/11/95
DRAWN	WRO 1 8/25
CHECKED	MCP 8/28/95
ENGINEER	8/28/95
PROJ MGR	8/28/95

PARSONS
 100 WEST WALNUT STREET
 PASADENA, CALIFORNIA

LIGO
 CALIFORNIA INSTITUTE OF TECHNOLOGY
 MASSACHUSETTS INSTITUTE OF TECHNOLOGY

**LASER INTERFEROMETER
 GRAVITATIONAL-WAVE OBSERVATORY
 ROUGH GRADING - LIVINGSTON, LA**

TITLE: **ROUGH GRADING
 SOUTHWEST ARM
 SECTIONS**
 STA 108+00 TO STA 130+00

AS NOTED PPI50969 8094
RG-C-025

not be reproduced, copied, loaned, exhibited, or used in any way without the written consent from PARSONS to the borrower.

This document and the design it covers are the property of PARSONS. The borrower agrees that they will not be reproduced, copied, loaned, exhibited, or used in any way without the written consent from PARSONS to the borrower.

Tue Sep 12 08:26:02 1995 83-286b2 J:\PLOTS\VALUES\388A\CE025.PRF

E
 D
 C
 B
 A