

This document and the design it covers are the property of PARSONS. They are loaned only with the borrower's expressed written agreement that they will not be reproduced, copied, loaned, exhibited, or used in any other way, except by written consent from PARSONS to the borrower.

Tue Sep 12 08:40:00 1995 s3-v36b2 J:\PLOTS\QUEUES\36B2\CE021.PRF

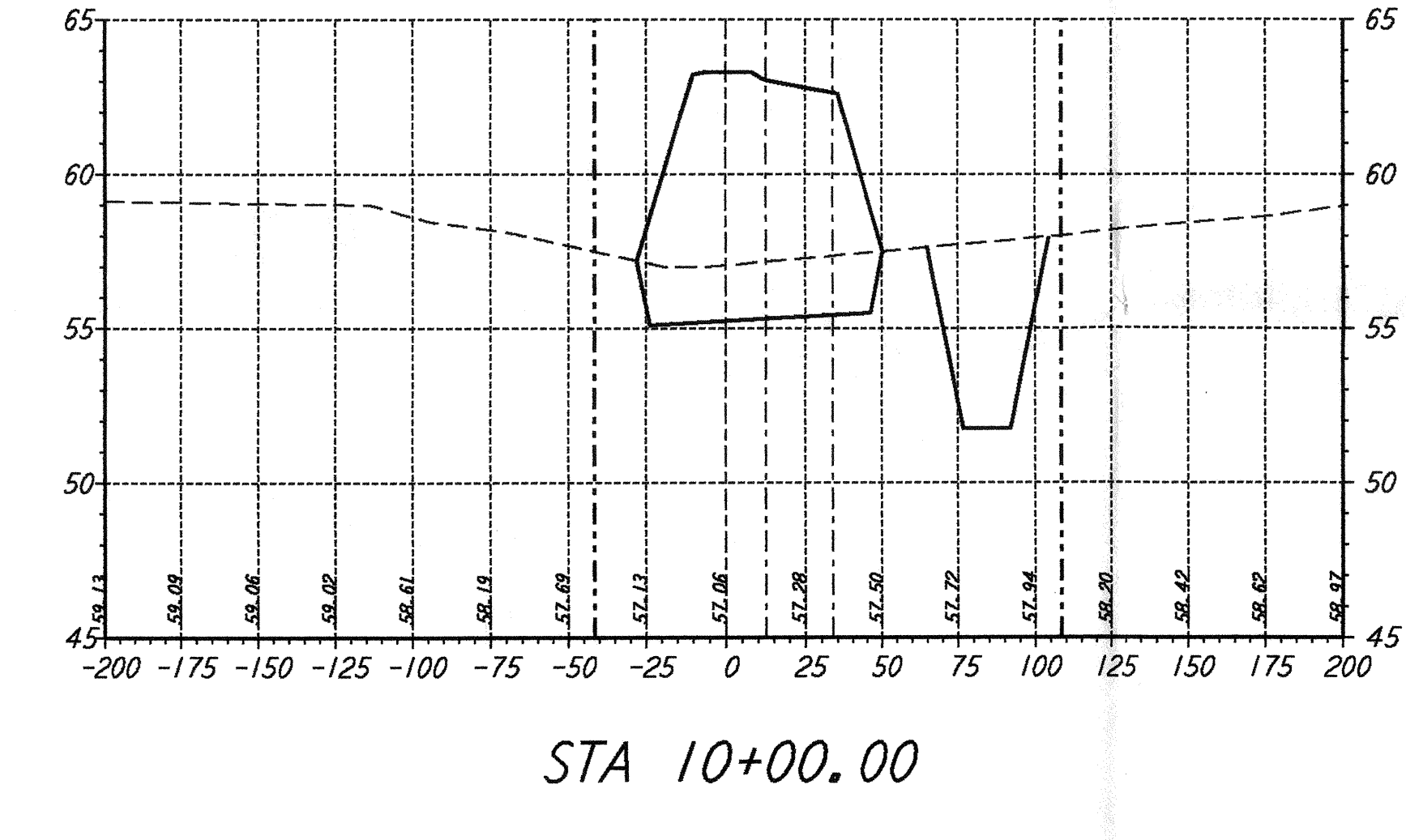

- NOTES:**
- SEE SHEET RG-C-002 FOR GENERAL NOTES, LEGEND AND ABBREVIATIONS.
 - CALLOUTS TYPICAL FOR ALL SECTIONS UNLESS OTHERWISE NOTED.

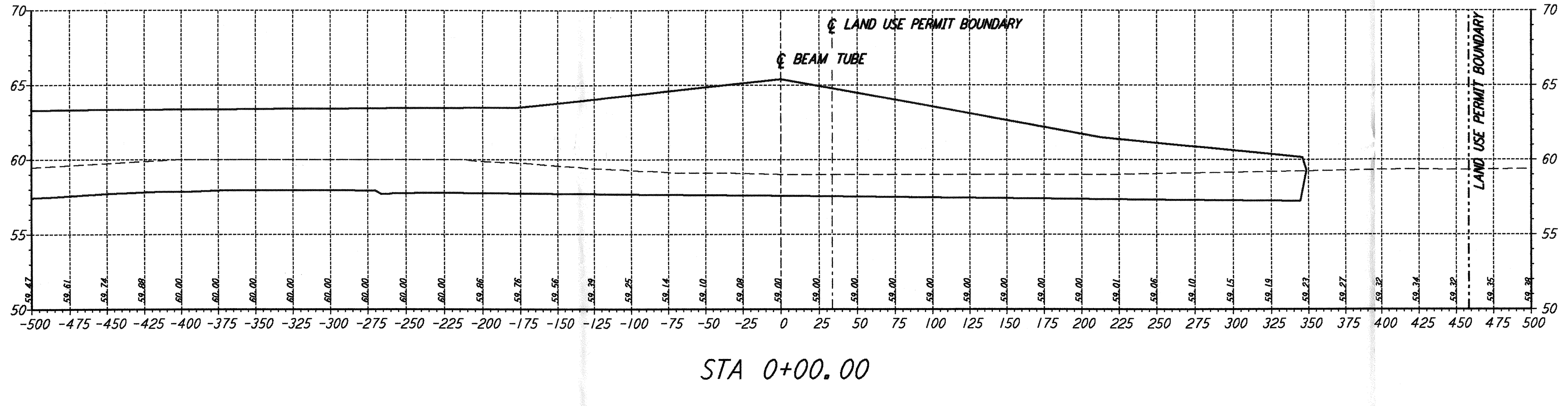
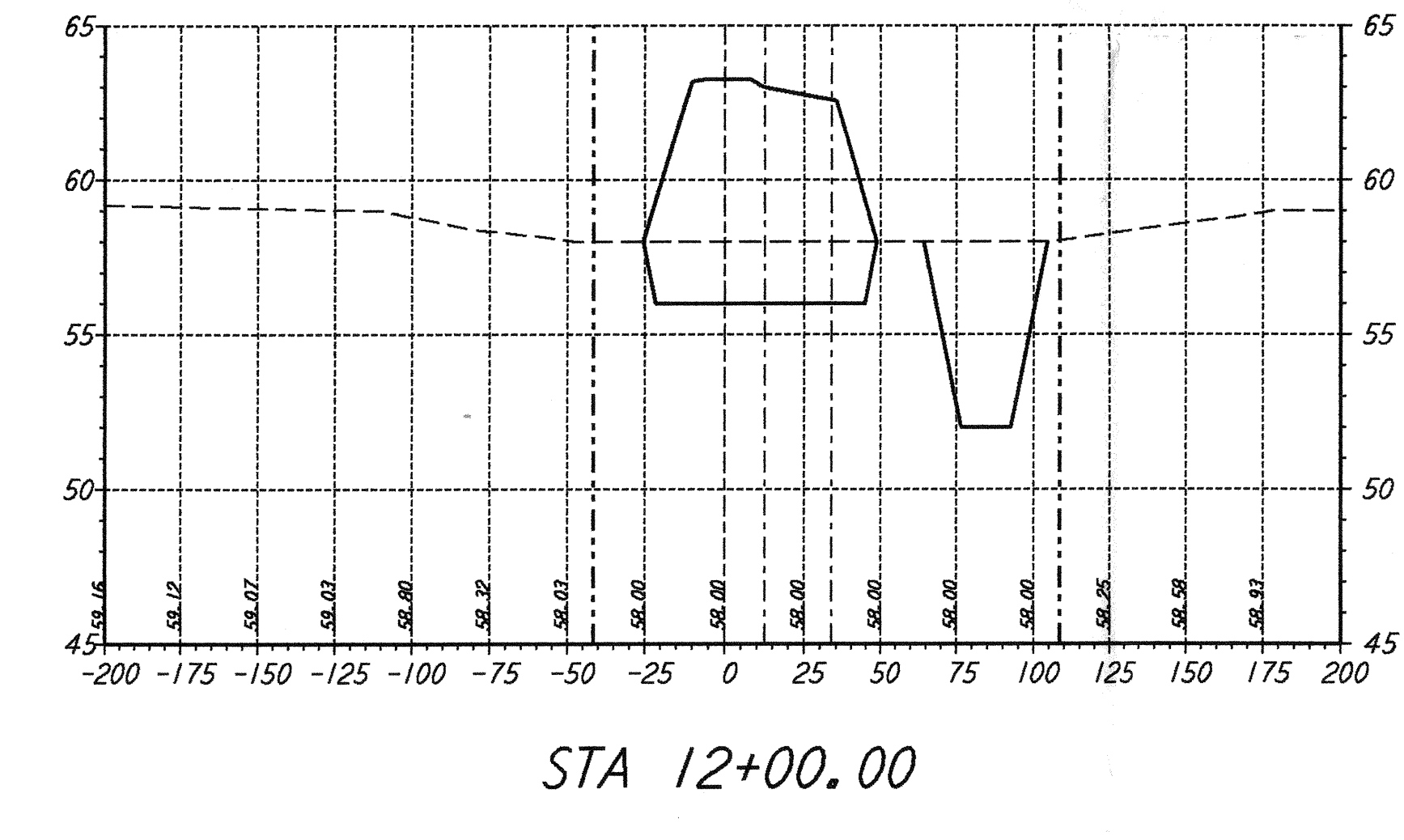
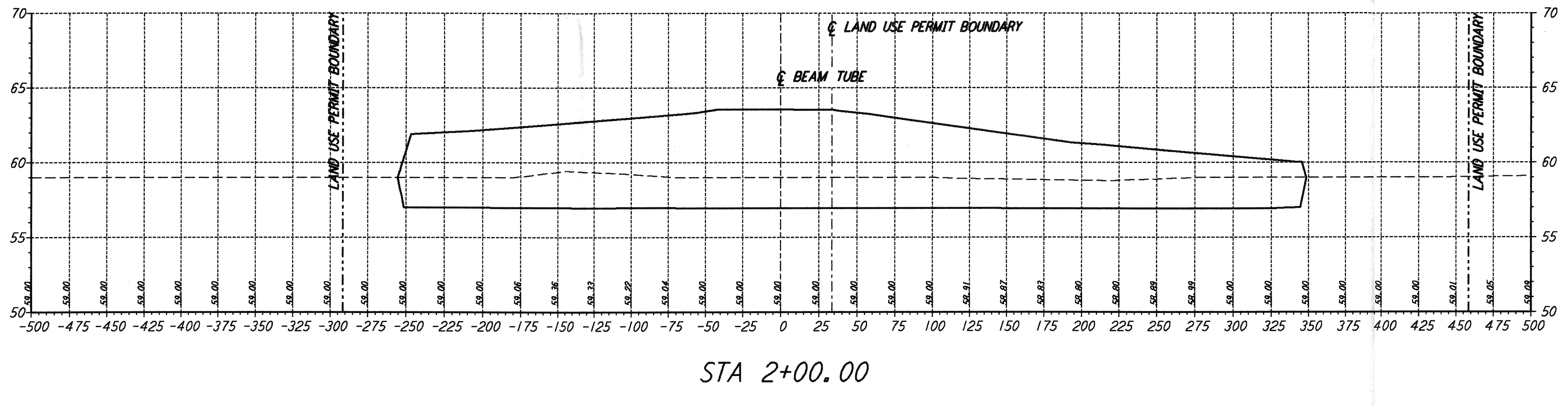
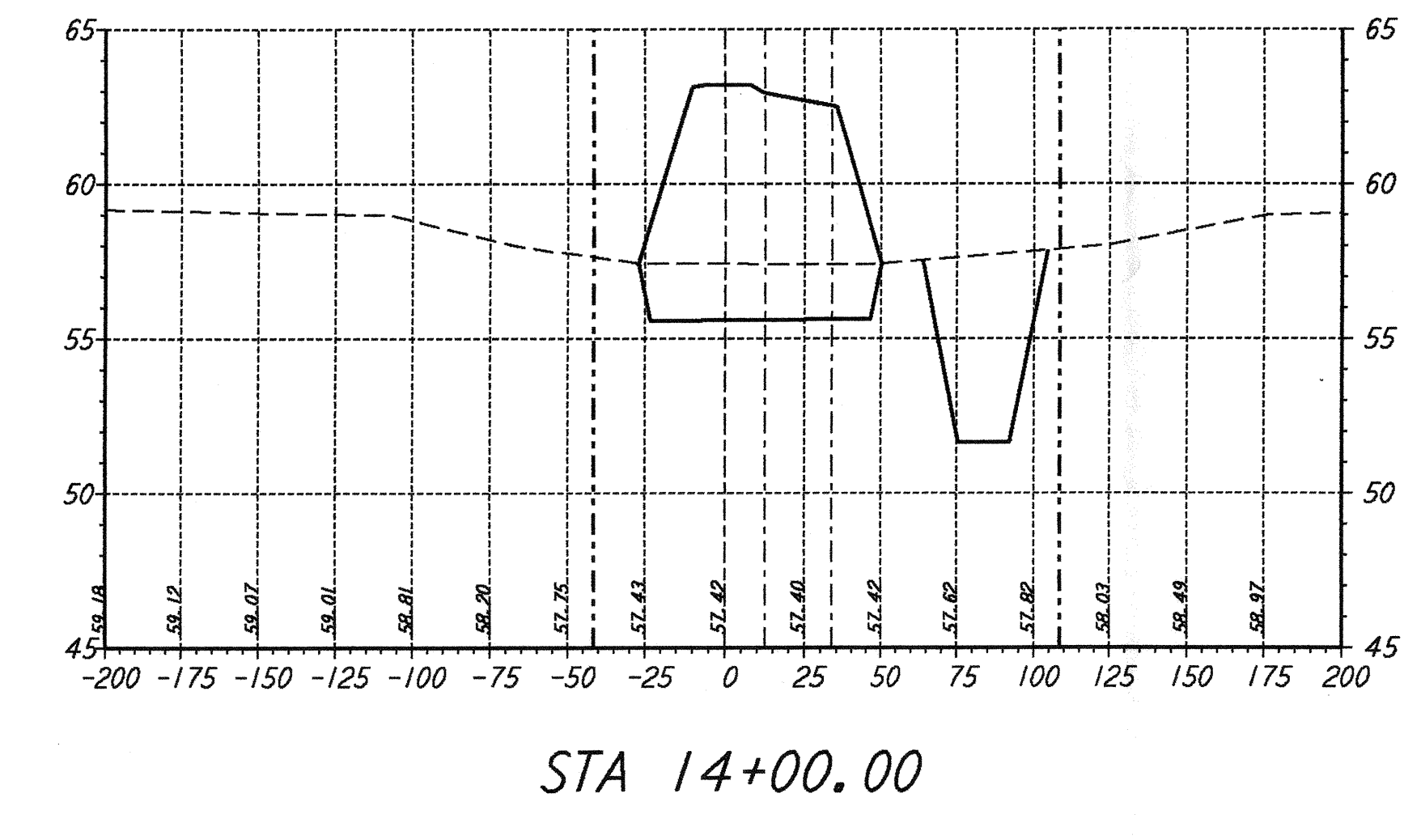
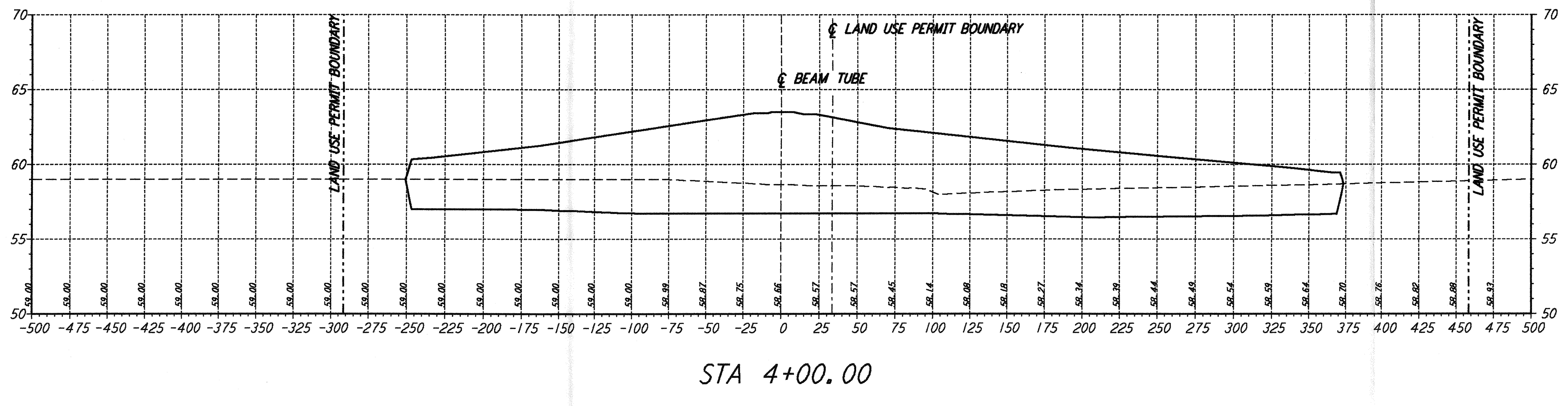
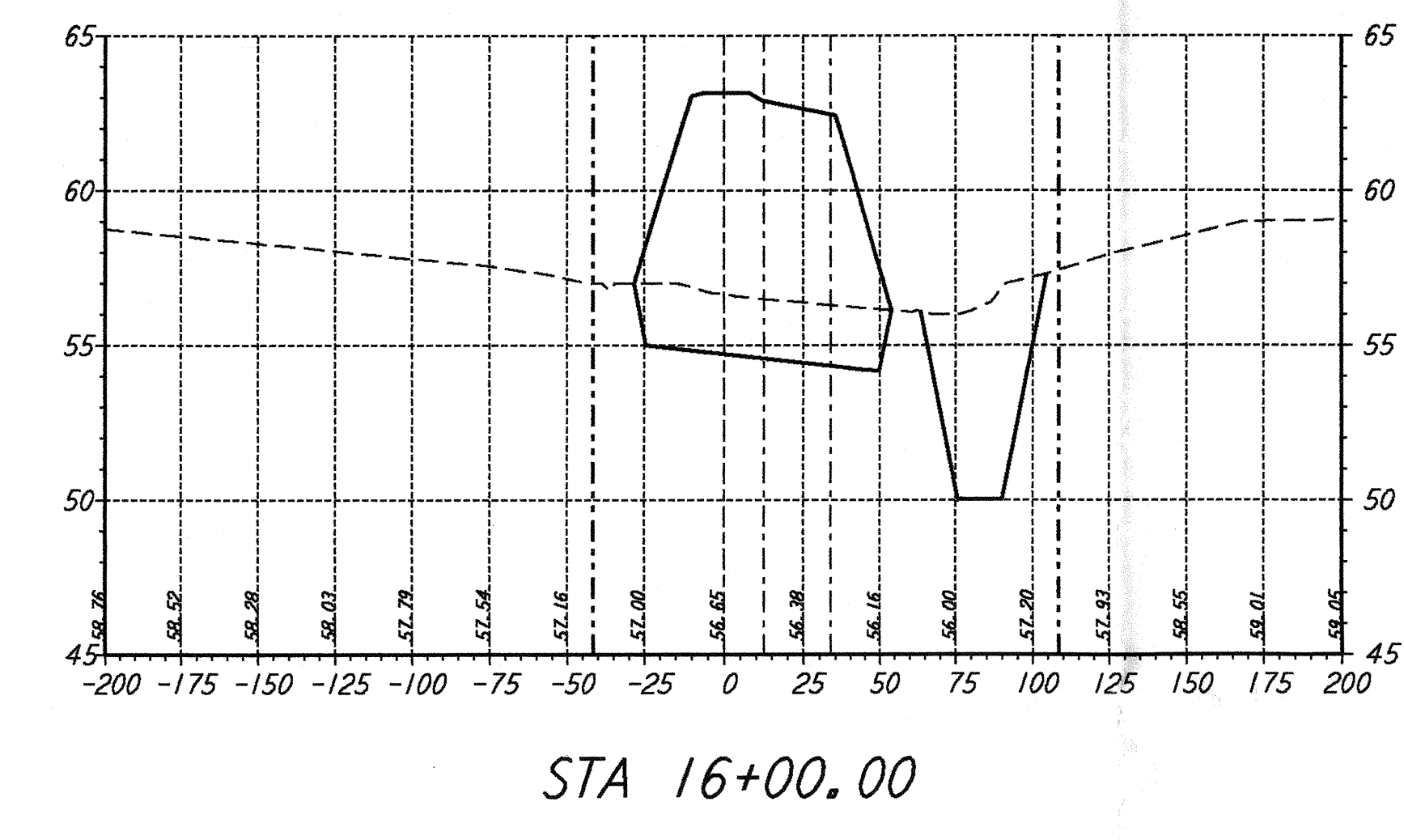
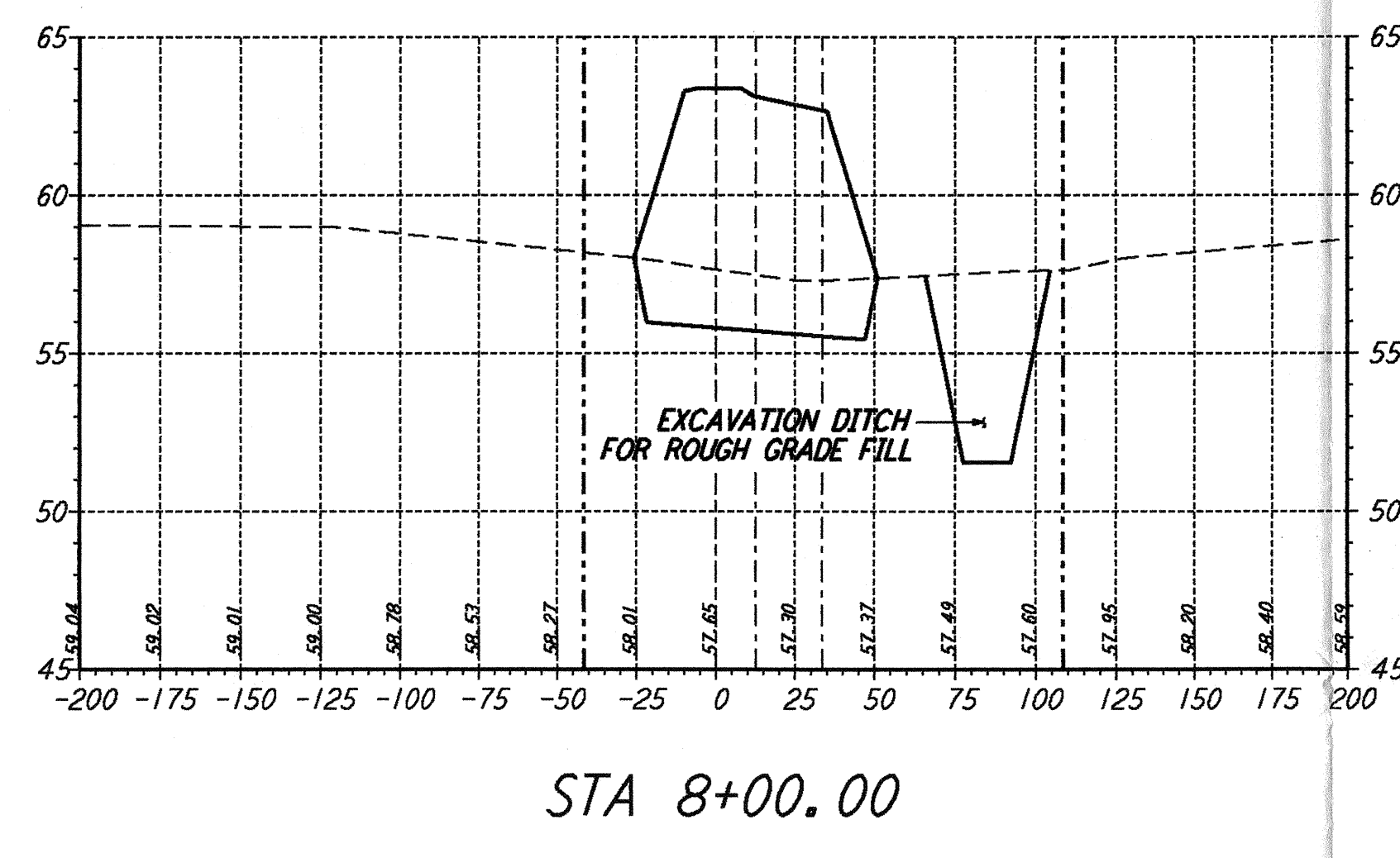
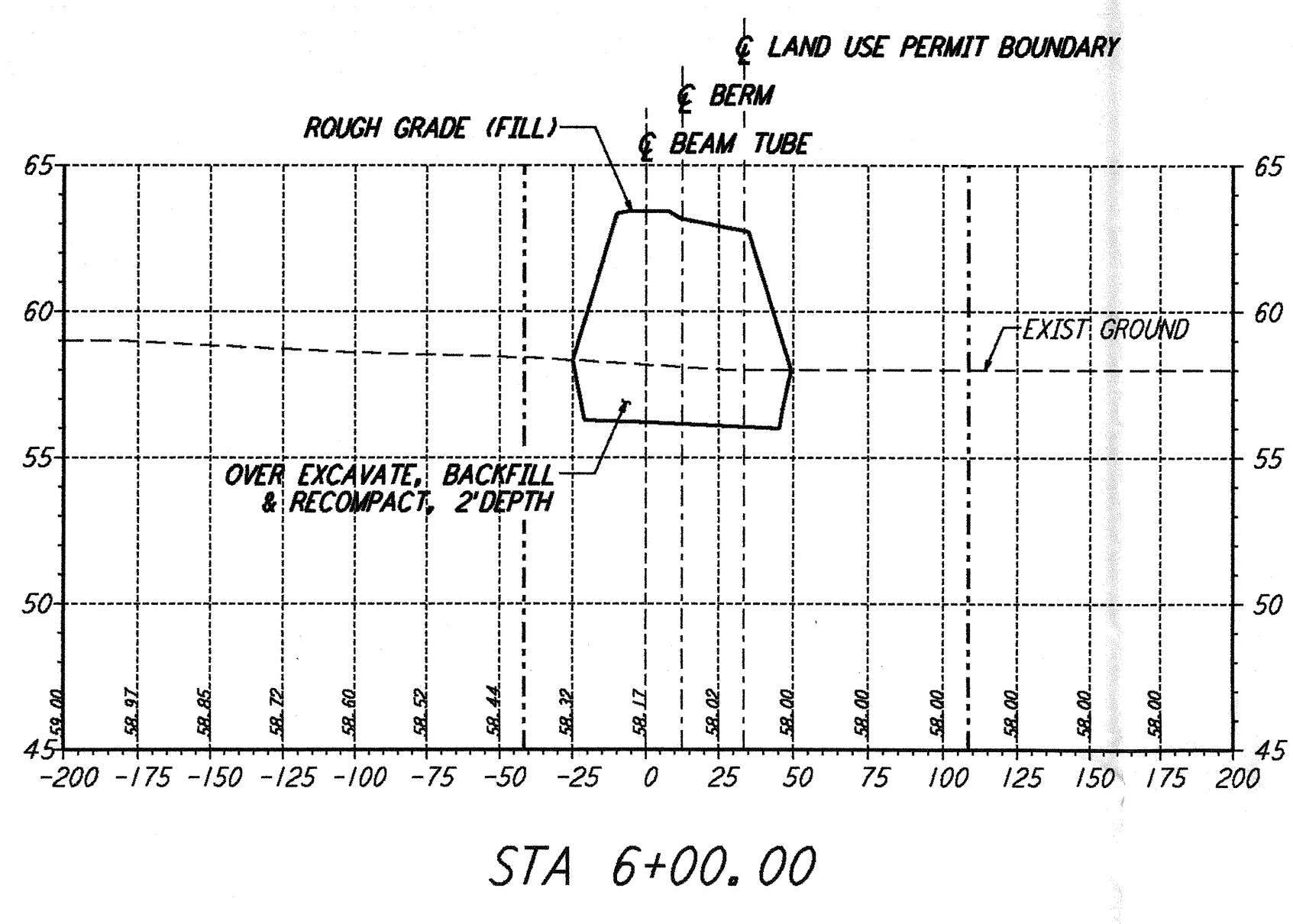
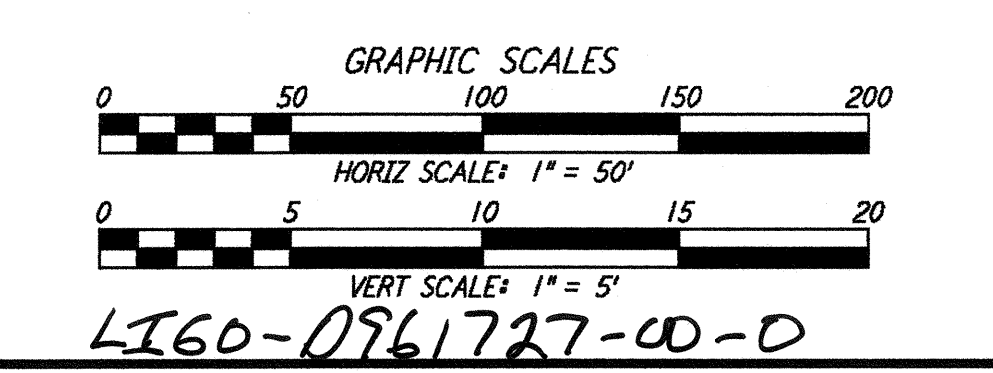

LIG0-0961727-00-D

NO.	DATE	APRD BY	DESCRIPTION OF REVISION
9			
8			
7			
6			
5			
4			
3			
2			
1	8/28/95	Tom	ISSUED FOR BID

NO.	DATE	APRD BY	ISSUED FOR
9	8/11/95		
8	8/9/95	WRB	
7	8/8/95	MGP	
6	8/28/95		
5	8/28/95		
4			
3			
2			
1			

PARSONS
100 WEST WALNUT STREET
PASADENA, CALIFORNIA

LIGO
CALIFORNIA INSTITUTE OF TECHNOLOGY
MASSACHUSETTS INSTITUTE OF TECHNOLOGY

ROUGH GRADING - LIVINGSTON, LA

AS NOTED PPI50969 8094

ROUGH GRADING
SOUTHWEST ARM
SECTIONS
STA 0+00 TO STA 16+00

RG-C-021