

NOTES: (UNLESS OTHERWISE SPECIFIED)
 1. INTERPRET DRAWING PER ANSI Y14.5M-1982.

△ MATERIAL:
 MAKE FROM McM-CARR #88915K49 ϕ .3750
 STAINLESS STEEL ROUNDS. FOR VENDOR
 INFORMATION SEE TOP ASSEMBLY
 MATERIALS LIST D970006 OR D970007.

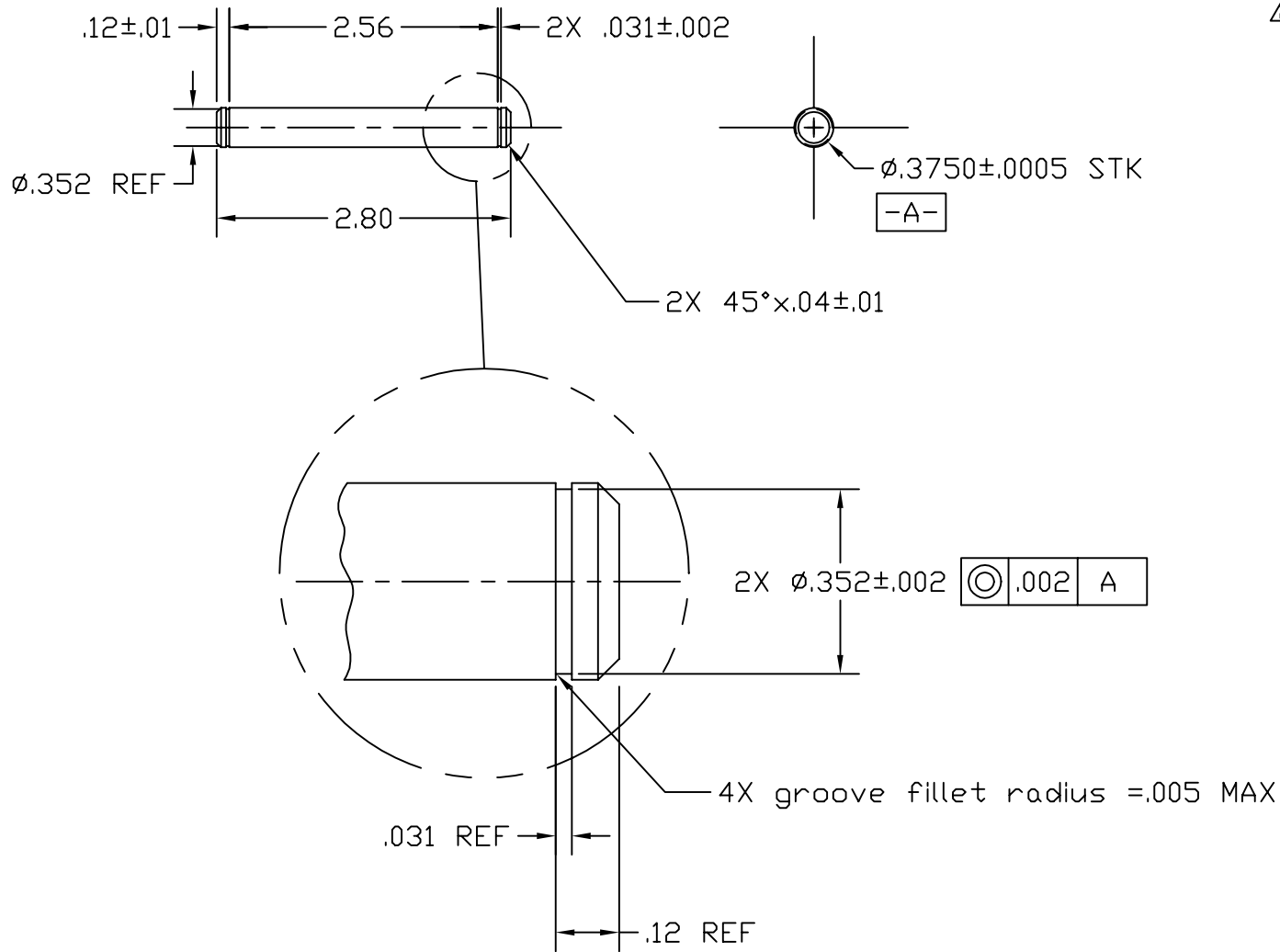

UNLESS OTHERWISE SPECIFIED
 DIMENSIONS ARE IN INCHES

TOLERANCES:
 FRACTIONAL ±
 ANGULAR ± 0.5°
 ANGULARMACH ± BEND ±
 TWO PLACE DECIMAL ± .03

THREE PLACE DECIMAL ± .005
 FINISHED SURFACE 32 MICRINCH AVERAGE
 BREAK CORNERS IN: OUT: .005-.015
 REMOVE ALL BURRS

MATERIAL: △	HEAT TREAT:	FINISH:
USED ON:	NEXT ASS'Y: D961444 & D961445	

A	DCN E960157																	
01	RELEASE FOR FAB																	
pA	PRELIMINARY RELEASE																	
00	PRE-RELEASE																	
REV	DESCRIPTION	DCC	SYS	DET	CDS	VE	CC	BT	CHECK	DRWN	DATE							

LIGO CALIFORNIA INSTITUTE OF TECHNOLOGY
 MASSACHUSETTS INSTITUTE OF TECHNOLOGY

CORE OPTIC COMPONENT CARRIER
 STANDOFF CLEVIS PIN

CAD FILE D961473-A.dwg	SIZE A	DWG. NO. D961473-A-D
SCALE NTS	SHEET 1 OF 1	