

NOTES:

1. SEE CIVIL DRAWING LA-C-541 FOR ACTUAL LOCATION OF ELECTRICAL VAULT.
2. SEE SPECIFICATION SECTION 16670 FOR LIGHTNING PROTECTION AND GROUNDING MATERIAL.
3. LARGE DIAMETER PVC CONDUIT ELBOW SHALL ACCOMMODATE 15 KV TERMINATION ELBOW (TERMINATOR BY OTHERS)
4. CONDUIT ELBOW STUB-UPS AT ELECTRICAL VAULT ARE BEING PROVIDED TO ACCOMMODATE FUTURE BAKE-OUT TRANSFORMERS BY OTHERS.
5. PROVIDE PULLROPS AND CONDUIT CAPS FOR ALL CONDUIT STUB-UPS.

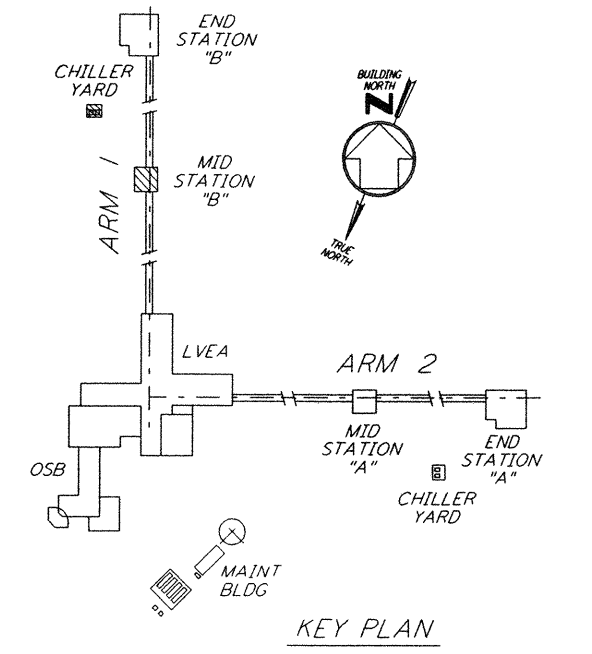

GROUNDING & UNDERGROUND PLAN

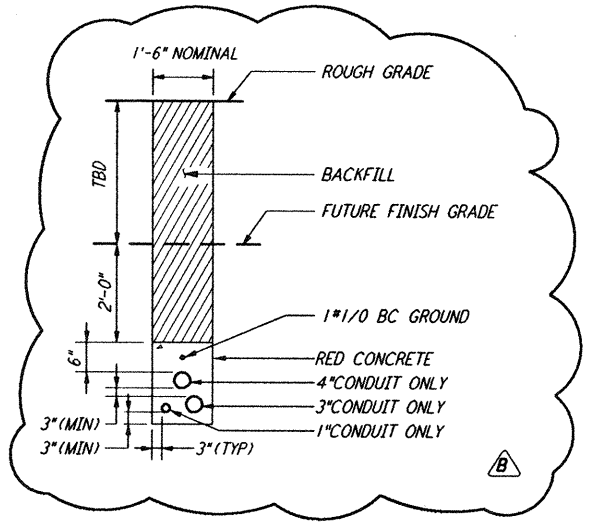
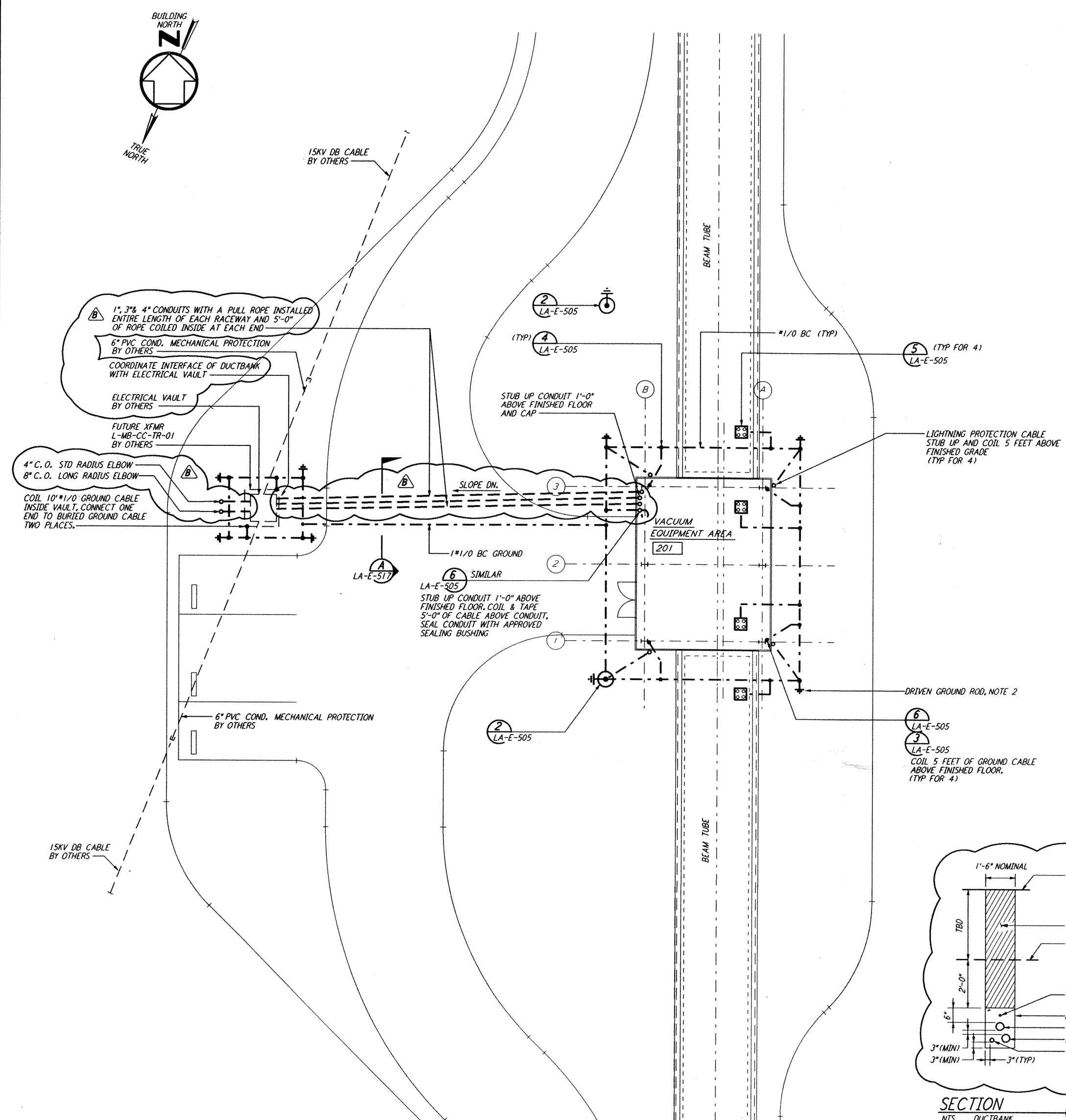
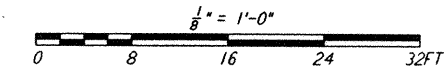

NO.	DATE	BY	CHKD	ENGR	PROJ	DESCRIPTION
B	9-10-96	MM	JCL	TDM		BID ADDENDUM #2
A	6-14-96	MM	JCL	KR	TDM	FINAL DESIGN REVIEW

DRAWN	M. M.
CHECKED	
ENGINEER	
PROJ	

PARSONS
 100 WEST WALNUT STREET
 PASADENA, CALIFORNIA

LIGO
 CALIFORNIA INSTITUTE OF TECHNOLOGY
 MASSACHUSETTS INSTITUTE OF TECHNOLOGY

LASER INTERFEROMETER
 GRAVITATIONAL-WAVE OBSERVATORY
 BEAM TUBE ENCLOSURE - LIVINGSTON, LA

TITLE	ELECTRICAL MID STATION B GROUNDING & UNDERGROUND PLAN	SCALE	AS NOTED	CONTRACT NUMBER	PP150969	PROJECT NUMBER	8094
SHEET NUMBER	LA-E-517	REVISIONS					

LIGO-D961245-B-0

Thu Sep 12 06:50:22 1996 s3-v18b2 J:\PLOTS\QUEUES\18B2\EE517B.PRF
 This document and the design it covers are the property of PARSONS. They are loaned only with the borrower's expressed written agreement that they will not be reproduced, copied, loaned, exhibited, or used in any other way, except by written consent from PARSONS to the borrower.