

**ITEM 1**  
 MAT'L: 12" X 8" X 1" THK. A36 STL. PLATE  
 QTY: 2 REQ'D

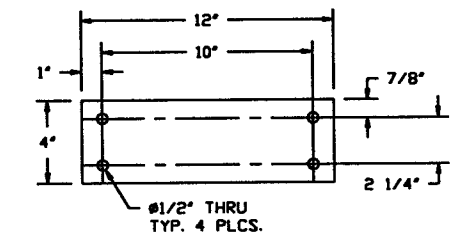

**ITEM 2**  
 MAT'L: 12" X 4" X 1/2" THK. SILICON PAD,  
 40 DUREMETER  
 QTY: 2 REQ'D

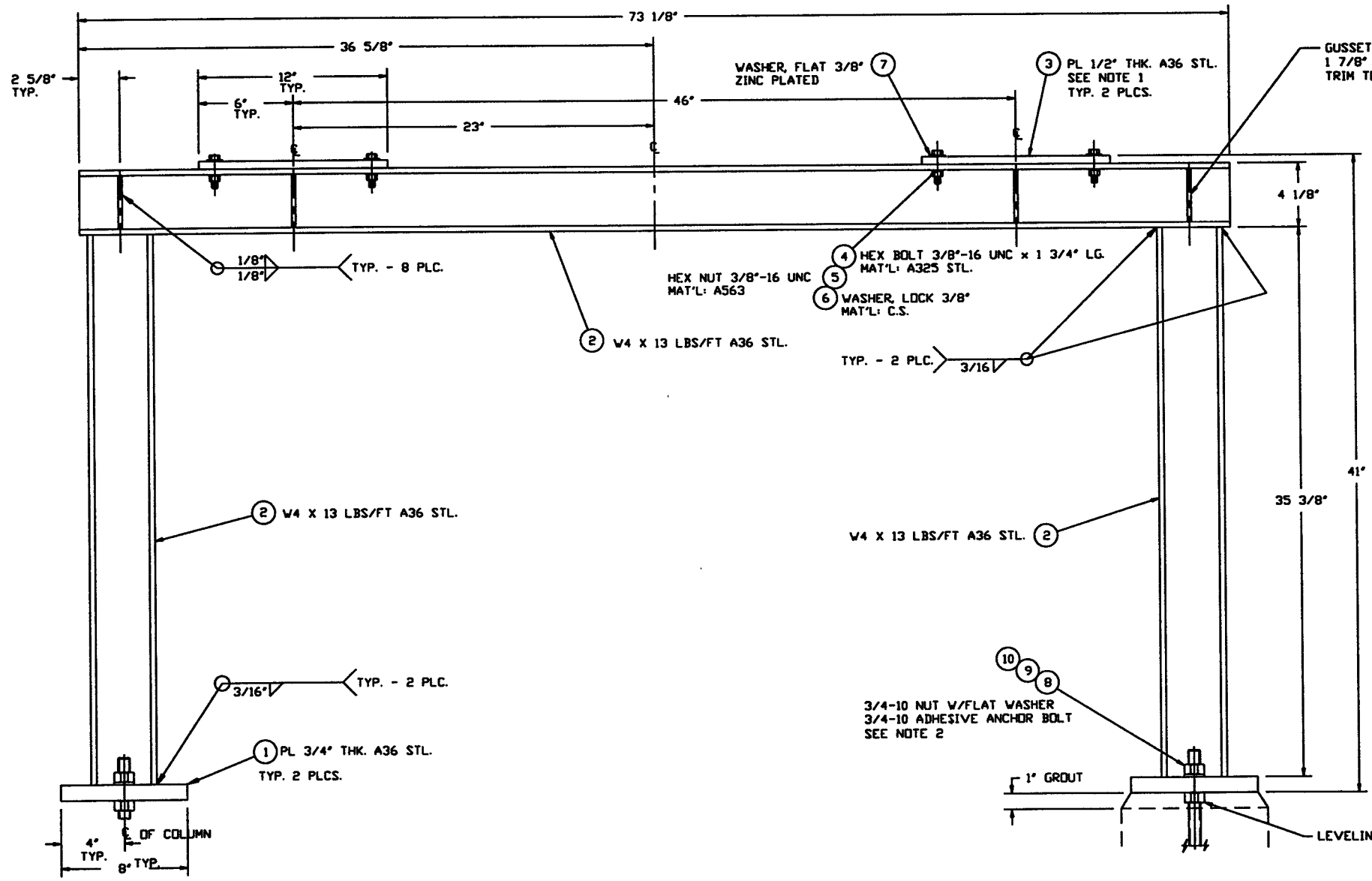

**NOT FOR CONSTRUCTION**

4-REQUIRED WASHINGTON SITE  
 2-REQUIRED LOUISIANA SITE

NOTES:  
 1.) PAINT PER PSI SPEC. V049-2-077.  
 2.) MIN EMBEDMENT = 6 5/8"

*Raymond P. Carro, P.E.*  
 5/6/96

NO.	DATE	DESCRIPTION	BY	CHKD	DRWN	DATE	DEDR
0		ISSUED FOR DR					
1							
2							
3							
4							
5							
6							
7							
8							

**PROCESS SYSTEMS INTERNATIONAL, INC.**  
 20 WALUP DR. WESTBOROUGH, MASSACHUSETTS 01581 USA

**48" GATE VALVE SUPPORT FRAME**  
**LIGO VACUUM EQUIPMENT**

CAD FILE: V0494034  
 SHEET: 1 OF 1  
 SCALE: 1/4" = 1"

LIGO D961114-00-V