

PLAN VIEW

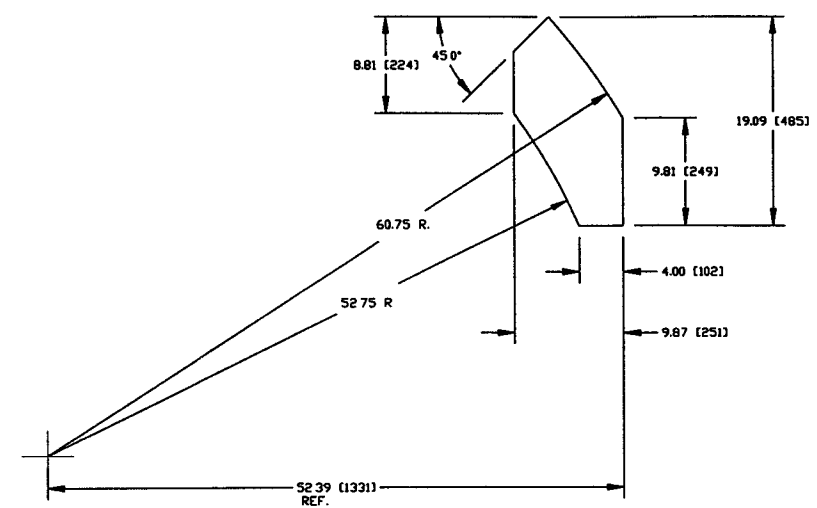

DETAIL "A"  
SCALE: 1 1/2"=1'-0"  
QTY (8)

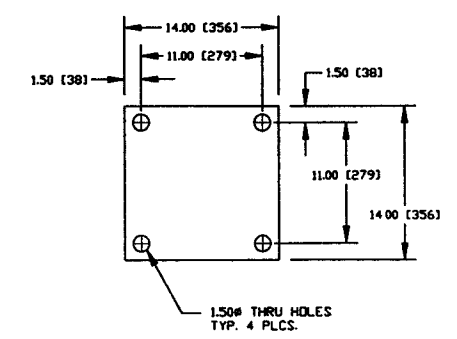

DETAIL "B"  
SCALE: 1 1/2"=1'-0"  
QTY (4)

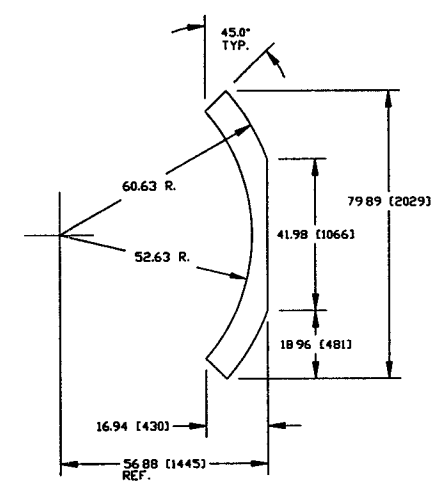

DETAIL "D"  
SCALE: 1 1/2"=1'-0"  
QTY (4)

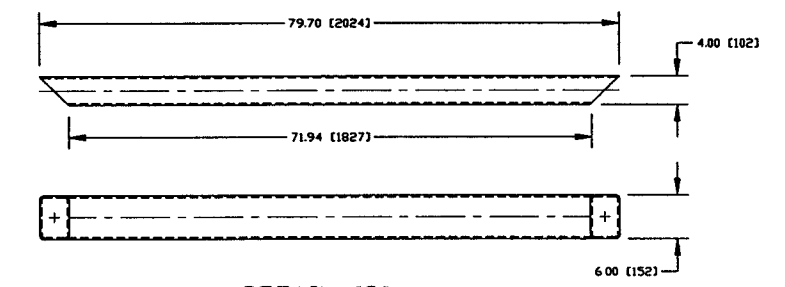

DETAIL "C"  
SCALE: 1"=1'-0"  
QTY (4)

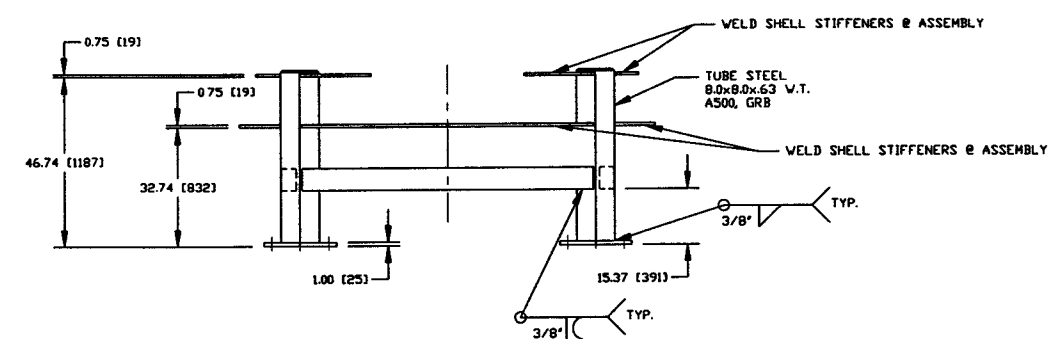

ELEVATION VIEW  
SCALE: 1/2"=1'-0"

APR 30 1996

LIGO-D961107-P1-V

<p>PROPRIETARY AND CONFIDENTIAL</p> <p>THIS DOCUMENT CONTAINS PROPRIETARY INFORMATION BELONGING TO PROCESS SYSTEMS INTERNATIONAL, INC. OR ITS AFFILIATED COMPANIES AND SHALL BE USED ONLY FOR THE PURPOSE FOR WHICH IT WAS SUPPLIED. IT SHALL NOT BE COPIED, REPRODUCED OR OTHERWISE USED, NOR SHALL SUCH INFORMATION BE FURNISHED IN WHOLE OR IN PART TO OTHERS EXCEPT IN ACCORDANCE WITH THE TERMS OF ANY AGREEMENT UNDER WHICH IT WAS SUPPLIED OR WITH THE PRIOR WRITTEN CONSENT OF PROCESS SYSTEMS INTERNATIONAL, INC. AND SHALL BE RETURNED UPON REQUEST.</p>				<p>UNLESS OTHERWISE SPECIFIED DIMENSIONS ARE IN INCHES</p> <p>TOLERANCES: FRACTIONAL: ANGULAR: ± .005" TWO PLACE DECIMAL: ± .005" THREE PLACE DECIMAL: ± .005" FINISHED SURFACE: ± .005" BREAK CORNERS: ± .005" REMOVE ALL BURRS</p>				<p>PROCESS SYSTEMS INTERNATIONAL, INC. 20 WALKUP DR. WESTBOROUGH, MASSACHUSETTS 01581 USA</p>						
<p>DO NOT SCALE THIS DRAWING</p>				PI	PRELIMINARY FOR QUOTES			PV	12/12/95	028	<p>CHAMBER SUPPORT ASSEMBLY BSC LIGO VACUUM EQUIPMENT</p>			
DWG. NO.	DESCRIPTION	DWG. NO.	DESCRIPTION	USED ON:	REV	DESCRIPTION	CHKD	DRWN	DATE	DESR	CAD FILE	SIZE	DWG. NO.	REV
				NEXT ASS'Y:							V0494023	D	V049-4-023	PI
											SCALE	1/2"=1'-0"	SHEET	1 OF 1

REV. 1/1995