

- NOTES:**
- FOR GENERAL NOTES SEE DWG. LA-E-101.
 - GROUNDING MAT FOR PERSONNEL PROTECTION SHALL BE PREFABRICATED 4' X 6', SIZE 6" X 6" APART, WIRE NO. 6 AWG, 40X CONDUCTIVITY COPPERWELD, WITH CENTER WIRE # 1/0 AWG, ERICO MFR. CABLE TO MESH TYPE FT, MOLD PTC-1G2C, WELD METAL #6S.
 - GROUNDING MAT SHALL BE INSTALLED 12" DEEP MIN. ADJACENT TO HIGH VOLTAGE PRIMARY SIDE.
 - FOR STANDARD SYMBOLS, ABBREVIATIONS AND ACRONYMS SEE DWG. LA-E-001.
 - FOR INSTALLATION DETAILS SEE DWG. LA-E-405 THRU 408.
 - ALL U/G CONDUIT RUNS ARE SHOWN DIAGRAMMATICALLY ONLY. CONTRACTOR SHALL COORDINATE WITH OTHER DISCIPLINES TO AVOID CONFLICT AND ROUTE THE DUCTBANK WITH OTHER UTILITY PIPES IN COMMON TRENCH AS FEASIBLE.

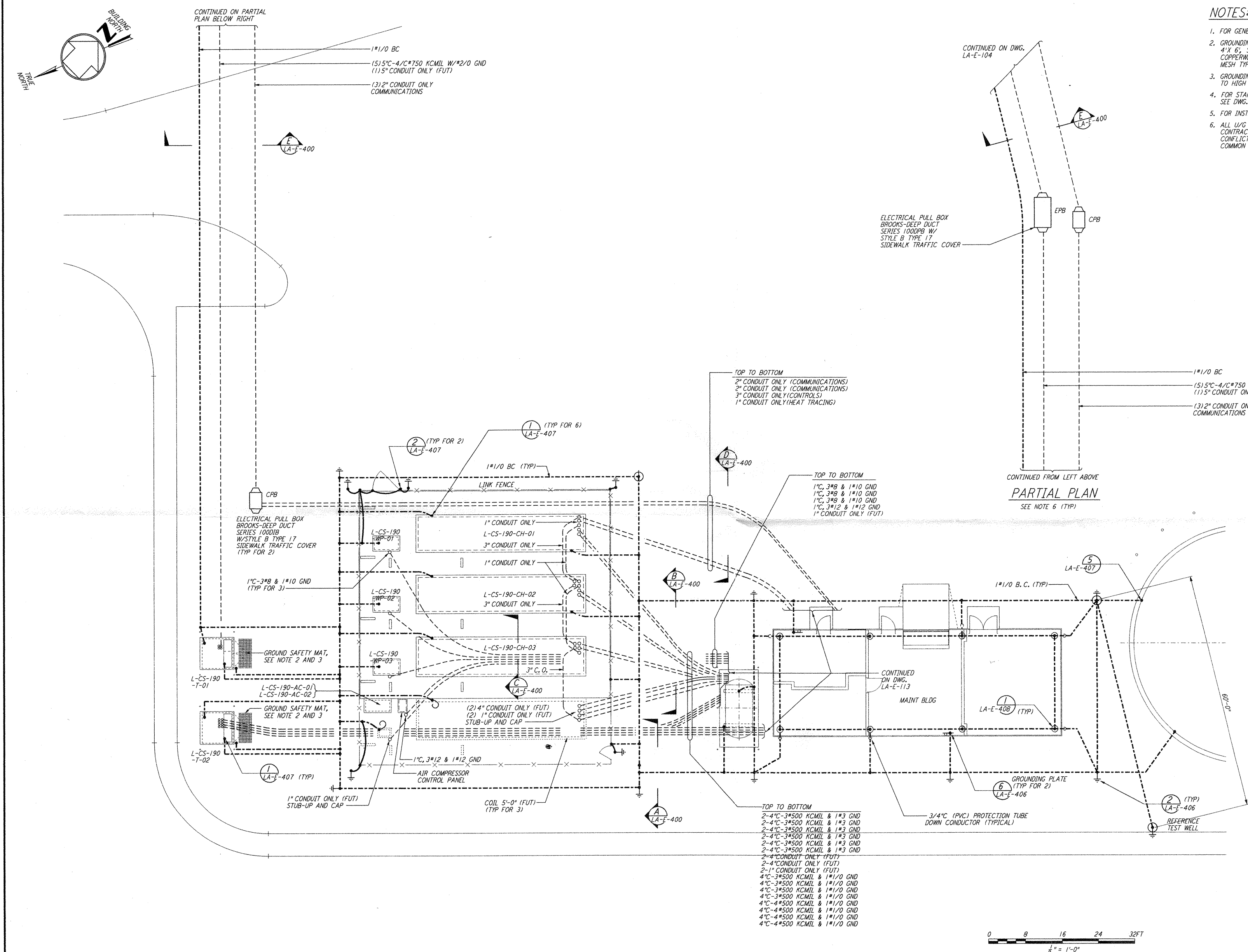

This document and the design it covers are the property of PARSONS. They are loaned only with the borrower's expressed written agreement that they will not be reproduced, copied, loaned, exhibited, or used in any other way, except by written consent from PARSONS to the borrower.

NO.	DATE	BY	CHKD	ENGR	PROJ	DESCRIPTION
2	5-21-99	AO	AK	AK	MDW	ISSUED AS REVISED AS-BUILT
1	8-7-98	JE	AK	AG	MDW	ISSUED FOR AS-BUILT

ISSUED FOR CONSTRUCTION
DRAWN M. M. 11-15-96
CHECKED JCL 7-24-96
ENGINEER KCR 10-25-96
PROJ T. D. M. 11-15-96

AS-BUILT DRAWINGS

100 WEST WALNUT STREET
PASADENA, CALIFORNIA

CALIFORNIA INSTITUTE OF TECHNOLOGY
MASSACHUSETTS INSTITUTE OF TECHNOLOGY

LIGO-D961014-02-0

LASER INTERFEROMETER
GRAVITATIONAL-WAVE OBSERVATORY
SITE NO. 2 - LIVINGSTON, LOUISIANA

TITLE	SCALE	CONTRACT NUMBER	PROJECT NUMBER
ELECTRICAL CORNER STATION CHILLER PLANT & MAINT BLDG GROUNDING PLAN	AS NOTED	PP150969	8094
SHEET NUMBER	REVISIONS		
LA-E-112			

5/21/99 3:24:02 PM C:\PILOT\GVE\33-13682.dwg 52885 KAT3682.wel2a.plt