

NOTES: (UNLESS OTHERWISE SPECIFIED)

1. ALL DIMENSIONS ARE IN MILLIMETERS AND DEGREES-MINUTES.
2. DRAWING TO BE INTERPRETED PER ANSI Y14.5M-1982.
3. POLISH ALL FACES, EDGES AND CHAMFERS PER LIGO-E960093-D.
4. REGISTRATION MARK IS LOCATED COINCIDENT WITH THE REGISTRATION MARK DRAWN ON THE BLANK ±5mm.

| REV | DATE | DRAWN BY | CHECKED | DCC | DCN/DESCRIPTION |
|-----|---------|----------|---------|-----|-------------------------|
| A | 9-8-96 | C CONLEY | D COYNE | | E960113/INITIAL RELEASE |
| B | 10-9-97 | C CONLEY | | | E970065 |

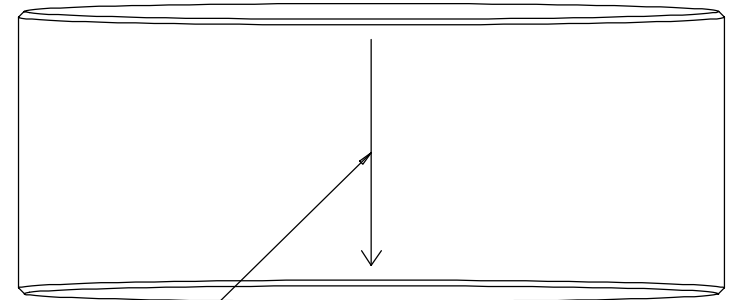
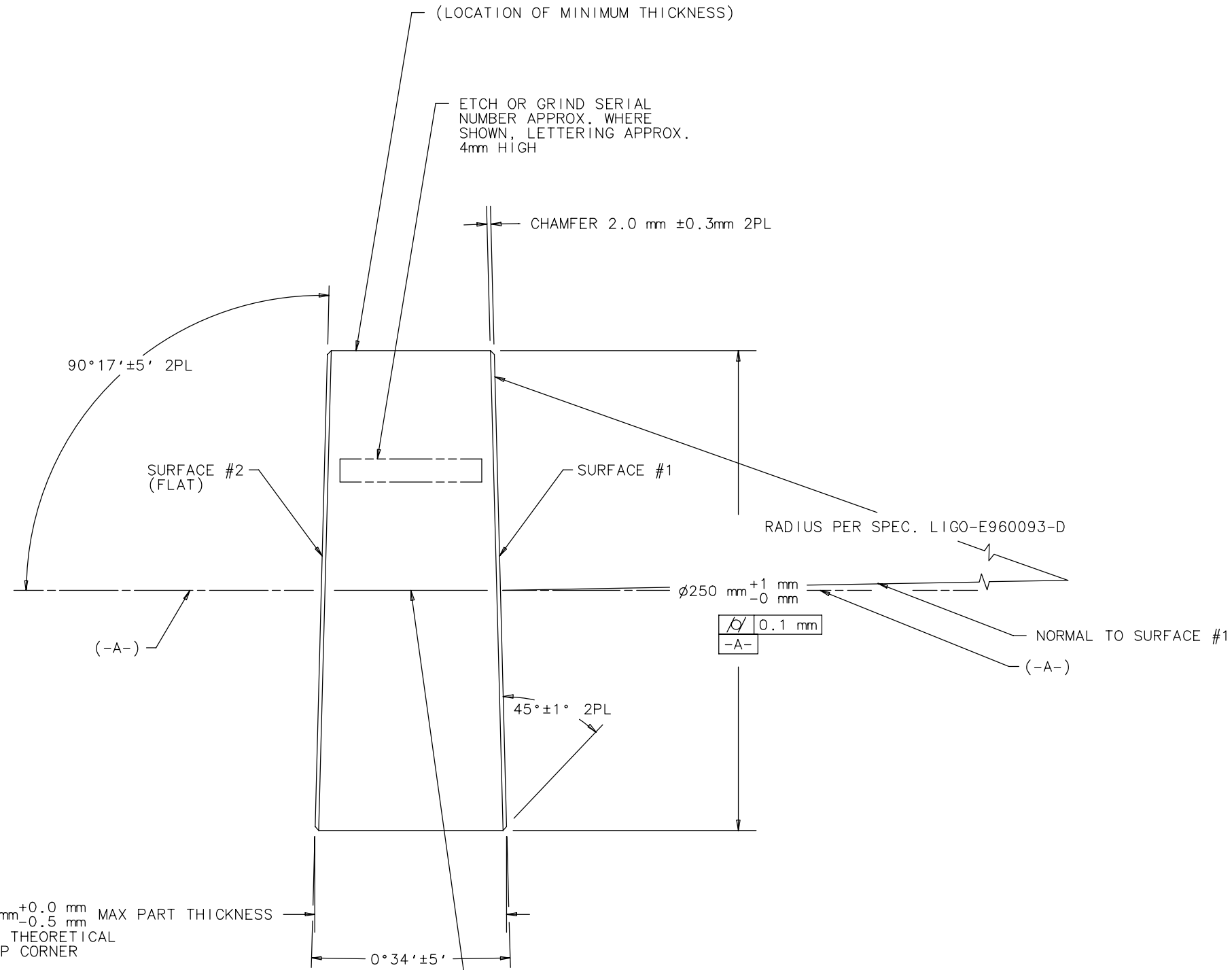

ETCH OR GRIND 0.25mm ±0.05mm WIDE X 80mm ±5mm LONG LINE WITH ARROW POINTING TOWARD SURFACE #1, PARALLEL TO -A- WITHIN ±0.10mm, CENTERED BETWEEN SURFACES #1 AND #2, AND AT LOCATION OF MINIMUM PART THICKNESS ±1°0'.

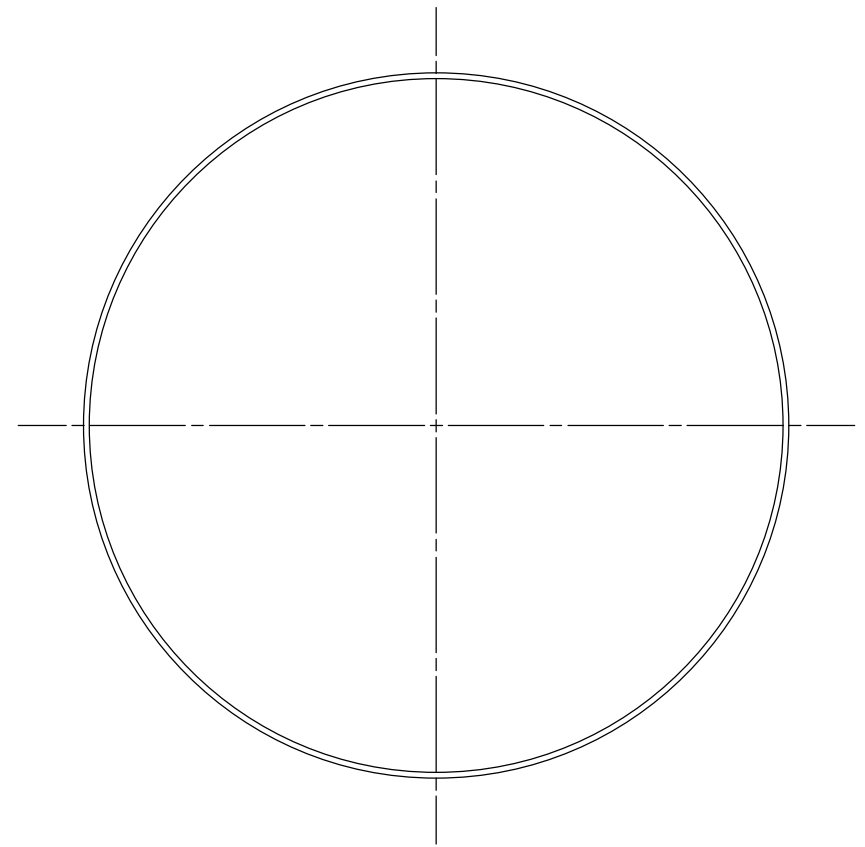

100 mm^{+0.0 mm}_{-0.5 mm} MAX PART THICKNESS FROM THEORETICAL SHARP CORNER

ETCH OR GRIND 0.25mm ±0.05mm WIDE X 80mm ±5mm LONG 3X 90°±15' APART FROM LINE WITH ARROW (SEE TOP VIEW) PARALLEL TO -A- WITHIN ±0.10mm, CENTERED BETWEEN SURFACES #1 AND #2.

| CALIFORNIA INSTITUTE OF TECHNOLOGY | | LIGO PROJECT | |
|--|----------|--|---|
| DRWN | C CONLEY | DATE | 9-8-96 |
| CHKD | | CAD FILE: D960803_B.asc | |
| ENGR | | dcc file: /home/dcc/docs/D960803-B.pdf | |
| APPD | | | |
| MATERIAL: FUSED SILICA PER LIGO-E960095-D | | INPUT TEST MASS SUBSTRATE, 2K | |
| DO NOT SCALE DRAWING | | SCALE: NTS | SIZE DRAWING NUMBER SHEET B D960803-B-D 1 OF 1 |