

NOTES: (UNLESS OTHERWISE SPECIFIED)

1. ALL DIMENSIONS ARE IN MILLIMETERS AND DEGREE-MINUTES.
2. DRAWING TO BE INTERPRETED PER ANSI Y14.5M-1982.
3. POLISH ALL FACES, EDGES AND CHAMFERS PER SPECIFICATION LIGO-E960102-D.
4. REGISTRATION MARK IS LOCATED COINCIDENT WITH THE REGISTRATION MARK DRAWN ON THE BLANK $\pm 5\text{mm}$.
5. $2^{\circ}0' \pm 5'$ WEDGE.

REV	DATE	DRAWN BY	CHECKED	DCC	DCN/DESCRIPTION
A	9-8-96	C CONLEY			E960113/INITIAL RELEASE
B	2-22-00	C CONLEY			E000102

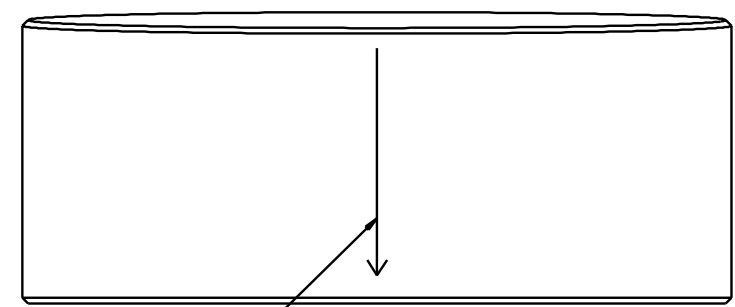
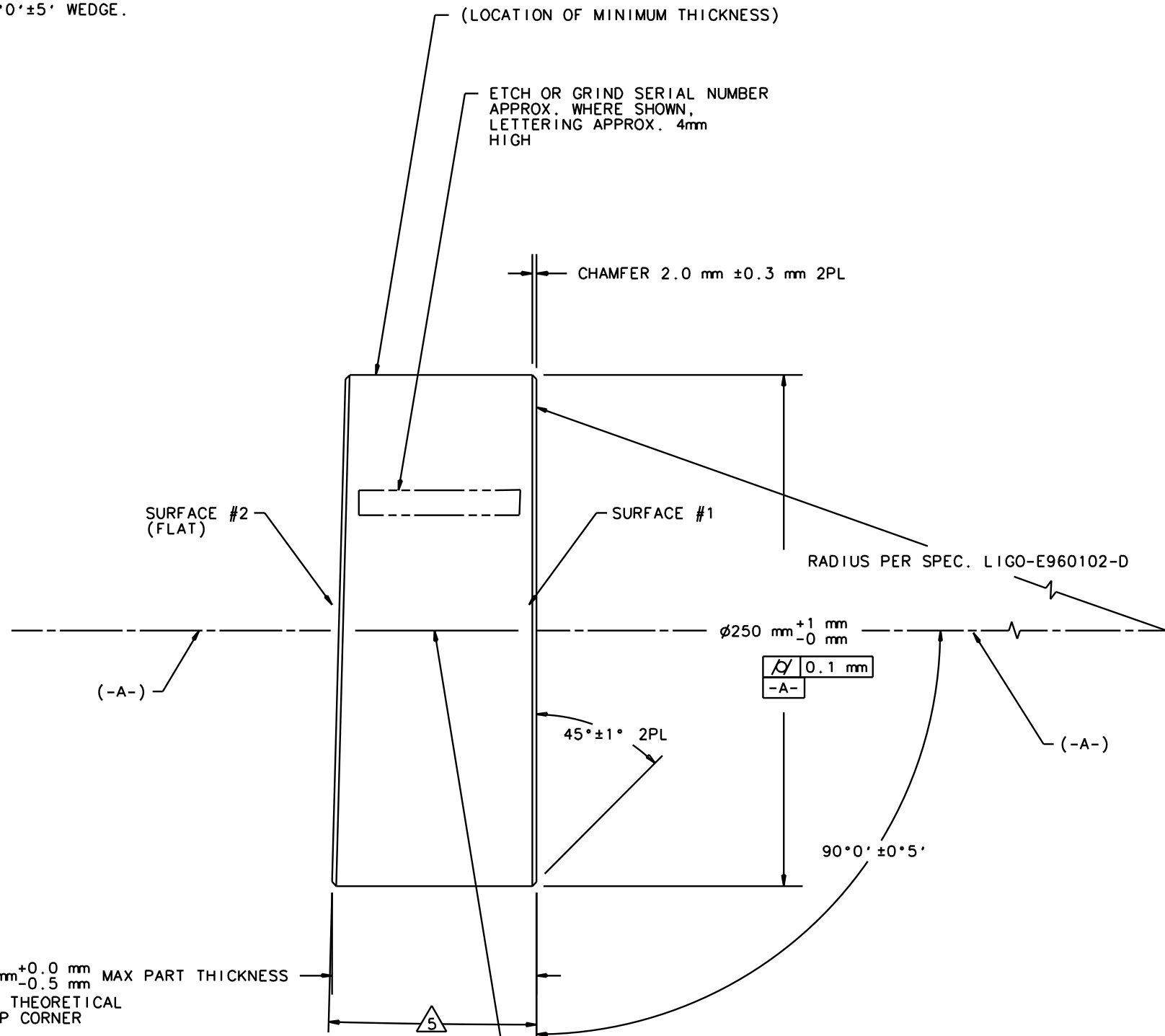

ETCH OR GRIND 0.25mm $\pm 0.05\text{mm}$ WIDE X 80mm $\pm 5\text{mm}$ LONG LINE WITH ARROW POINTING TOWARD SURFACE #1, PARALLEL TO -A- WITHIN $\pm 0.10\text{mm}$, CENTERED BETWEEN SURFACES #1 AND #2, AND AT LOCATION OF MINIMUM PART THICKNESS $\pm 0^{\circ}15'$.

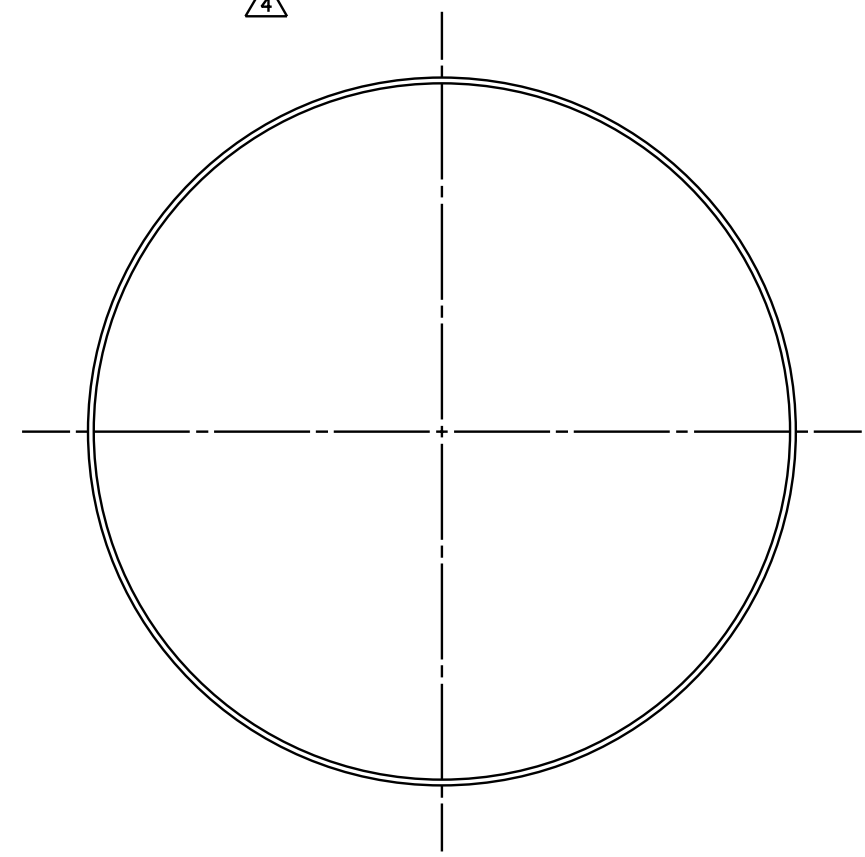

ETCH OR GRIND 0.25mm $\pm 0.05\text{mm}$ WIDE X 80mm $\pm 5\text{mm}$ LONG 3X $90^{\circ} \pm 15'$ APART FROM LINE WITH ARROW (SEE TOP VIEW) PARALLEL TO -A- WITHIN $\pm 0.10\text{mm}$, CENTERED BETWEEN SURFACES #1 AND #2

DRWN	C CONLEY	DATE	9-8-96	CALIFORNIA INSTITUTE OF TECHNOLOGY	
CHKD				MASSACHUSETTS INSTITUTE OF TECHNOLOGY	
ENGR				LIGO PROJECT	
APPD				CAD FILE: D960791-B.osc	
MATERIAL:				END TEST MASS	
FUSED SILICA PER				SUBSTRATE	
LIGO-E960097-D					
DO NOT SCALE DRAWING		SCALE: NTS	SIZE	DRAWING NUMBER	SHEET
			B	D960791-B-D	1 OF 1